

DAVID Y. IGE  
GOVERNOR

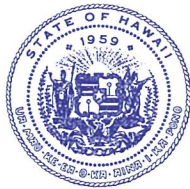

STATE OF HAWAII  
DEPARTMENT OF TRANSPORTATION  
869 PUNCHBOWL STREET  
HONOLULU, HAWAII 96813-5097

JADE T. BUTAY  
DIRECTOR

Deputy Directors  
ROY CATALANI  
ROSS M. HIGASHI  
EDWIN H. SNIFFEN  
DARRELL T. YOUNG

IN REPLY REFER TO:

Board of Land and  
Natural Resources  
State of Hawai'i  
Honolulu, Hawai'i

ISSUANCE OF A REVOCABLE PERMIT FOR  
EXCLUSIVE USE OF RESTROOM  
TM DESIGNERS, INC.  
DANIEL K. INOUE INTERNATIONAL AIRPORT  
TAX MAP KEY: (1) 1-1-003: 001 (PORTION)

O'AHU

LEGAL REFERENCE:

Section 171-55, Hawai'i Revised Statutes (HRS).

APPLICANT:

TM Designers, Inc. (TM Designers), whose mailing address is 300 Rodgers Boulevard,  
Box 61, Honolulu, Hawai'i 96819.

LOCATION:

Building No. 360, Ewa Concourse, Ground Level, at Daniel K. Inouye International  
Airport, identified by Tax Map Keys: 1<sup>st</sup> Division, 1-1-003: 001 (Portion).

AREA:

Ewa Concourse:  
Bldg/Room No. 360-127B, containing an area of approximately 131 square feet, and  
delineated on the attached map labeled Exhibit "A".

ZONING:

State Land Use District: Urban  
City and County of Honolulu LUO: Industrial (I-2)

**ITEM M-6**

BLNR- ISSUANCE OF A REVOCABLE PERMIT FOR EXCLUSIVE USE OF RESTROOM,  
TM DESIGNERS, INC.

Page 2

LAND TITLE STATUS:

Non-ceded - Section 5(a) lands of the Hawai'i Admission Act  
DHHL 30% entitlement lands pursuant to Hawai'i Admission Act    YES \_\_\_    NO X

CURRENT USE STATUS:

Land presently encumbered by Governor's Executive Order No. 3201, dated June 8, 1983, setting aside 3,152.177 acres designated as Daniel K. Inouye International Airport under the control and management of the State of Hawai'i, Department of Transportation, Airports Division (DOTA) for Airport Purposes.

CHARACTER OF USE:

TM Designers will use the space as an exclusive restroom for their administrative office at Daniel K. Inouye International Airport.

COMMENCEMENT DATE:

To be determined by the Director of Transportation at a later date.

MONTHLY RENTAL:

\$313.09 (\$262.00 as determined from the DOTA schedule of rates and charges established by appraisal of Airports property statewide plus \$51.09 for electricity and water).

SECURITY DEPOSIT:

Three (3) times the monthly rental in effect

DCCA VERIFICATION:

|   |              |        |
|---|--------------|--------|
| Place of business registration confirmed: | YES <u>X</u> | NO ___ |
| Registered business name confirmed:       | YES <u>X</u> | NO ___ |
| Good standing confirmed:                  | YES <u>X</u> | NO ___ |

CHAPTER 343, HRS - ENVIRONMENTAL ASSESSMENT:

Pursuant to Section 11-200-8(a), Environmental Impact Statement Rules of the Department of Health, State of Hawai'i, this disposition is exempt from requirements regarding preparation of an environmental assessment, negative declaration, or environmental impact statement as required by Chapter 343, Hawai'i Revised Statutes, as amended, relating to Environmental Impact Statements, because the proposed action falls within Exemption Class #1, Comprehensive Exemption List for the State of Hawai'i,

BLNR- ISSUANCE OF A REVOCABLE PERMIT FOR EXCLUSIVE USE OF RESTROOM,  
TM DESIGNERS, INC.

Page 3

Department of Transportation, dated November 15, 2000, as approved by the Environmental Quality Council. Exemption Class #1 covers operations, repairs, or maintenance of existing structures, facilities, equipment, or topographical features involving negligible or no expansion or change of use beyond that previously existing.

The DOTA consulted with the U.S. Federal Aviation Administration as to the appropriateness of the citation of the Environmental Exemption Class from the Comprehensive list for the Department of Transportation dated November 15, 2000. The FAA concurred on the appropriateness.

REMARKS:

In accordance with Section 171-55, HRS, relating to Permits, the Department of Transportation proposes to issue a month-to-month revocable permit to TM Designers for exclusive use of the restroom for their administrative office at Daniel K. Inouye International Airport.

RECOMMENDATION:

That the Board authorize the Department of Transportation to issue a month-to-month revocable permit to TM Designers, Inc., subject to: (1) terms and conditions herein outlined, which are by reference incorporated herein; and (2) such additional terms and conditions as may be prescribed by the Director of Transportation to best serve the interests of the State.

Respectfully submitted



JADE T. BUTAY  
Director of Transportation

APPROVED FOR SUBMITTAL:

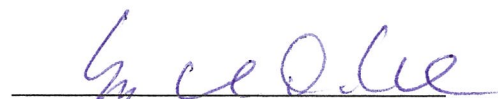

SUZANNE D. CASE  
Chairperson and Member



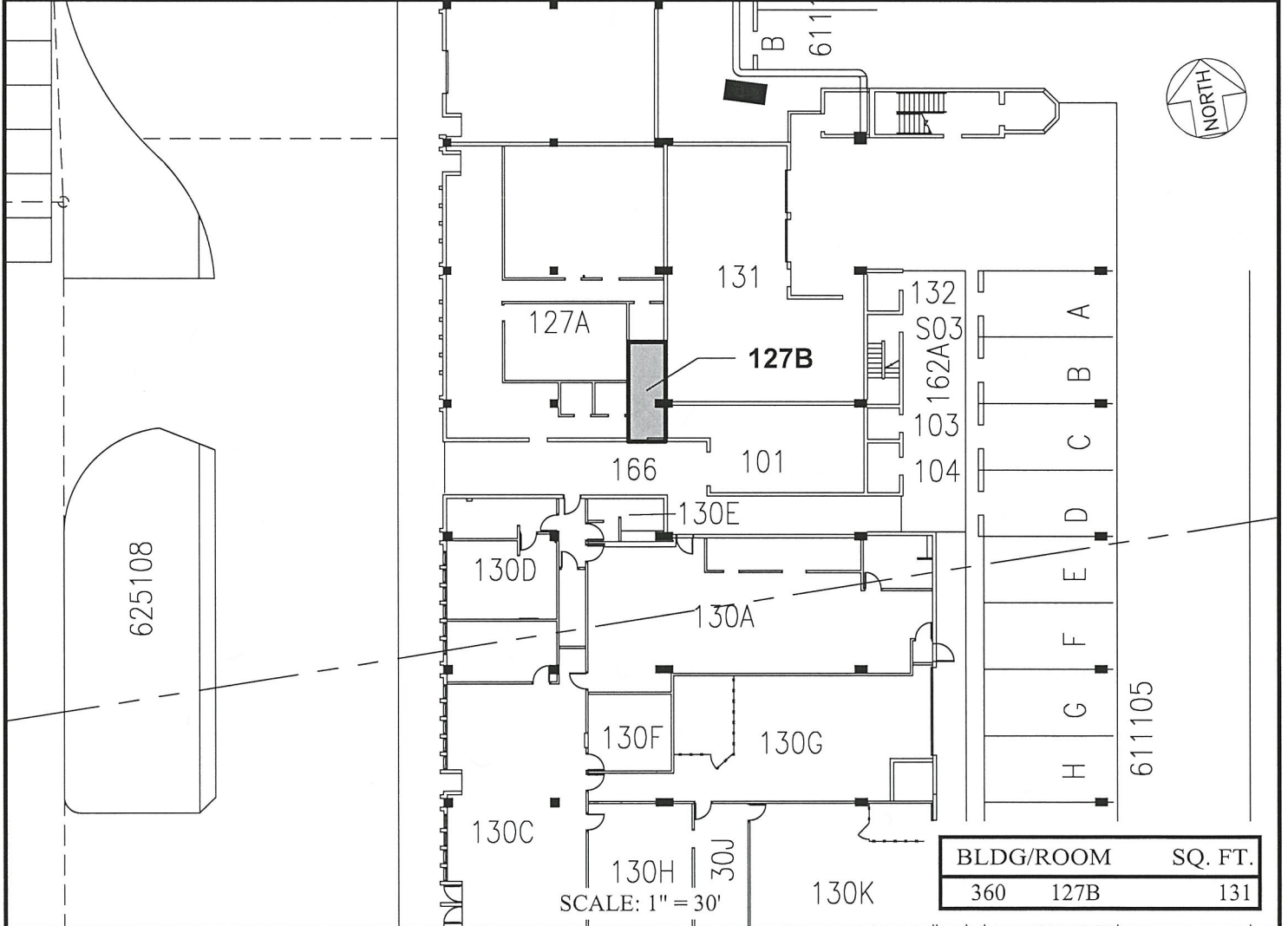
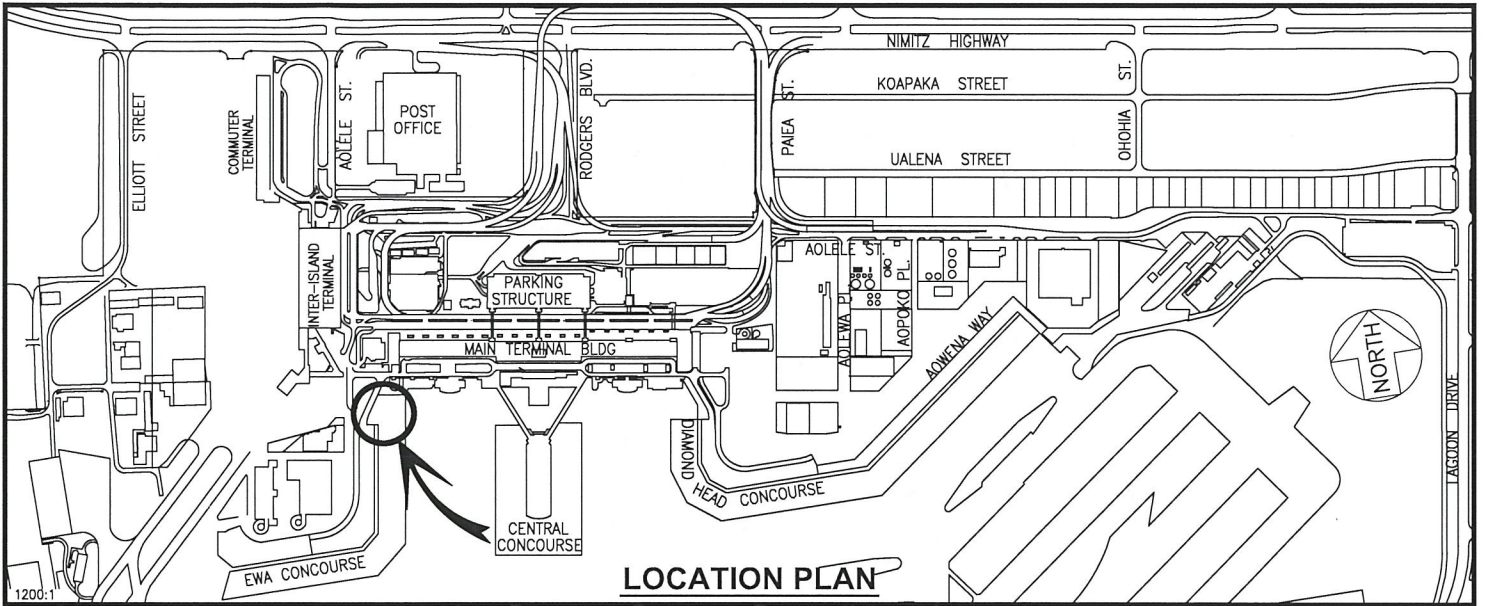

RP-8738

DATE : JANUARY 2018

EXHIBIT: **A**



Airports Division

TM DESIGNERS, INC.

BUILDING 360  
EWA CONCOURSE  
GROUND LEVEL

360127B

PLAT A1

**DANIEL K. INOUE INTERNATIONAL AIRPORT**

N:\AIRPORTS\HNL\_HONOLULU\CAD\PM\HNL\_360127B-01.DWG