



**STATE OF HAWAII**  
**DEPARTMENT OF TRANSPORTATION**  
869 PUNCHBOWL STREET  
HONOLULU, HAWAII 96813-5097

IN REPLY REFER TO:

Board of Land and  
Natural Resources  
State of Hawai'i  
Honolulu, Hawai'i

ISSUANCE OF A REVOCABLE PERMIT FOR SPACES  
IN THE MAIN TERMINAL FOR AIRLINE OPERATIONS  
ALASKA AIRLINES, INC.  
KAHULUI AIRPORT  
TAX MAP KEY: (2) 3-8-01: PORTION OF 19

MAUI

LEGAL REFERENCE:

Sections 171-11 and 171-55, Hawai'i Revised Statutes.

APPLICANT:

ALASKA AIRLINES, INC. ("ASA"), whose business address is P.O. Box 68900-  
SEAPZ, Seattle, Washington, 98168-0900.

LOCATION AND TAX MAP KEY:

Portion of Kahului Airport, Kahului, Island of Maui, identified by  
Tax Map Key: 2nd Division, 3-8-01: Portion of 19.

AREAS:

Bldg/Room No. 325-108A, containing an area of approximately 539 square feet,  
Bldg/Room No. 325-108B, containing an area of approximately 541 square feet, and  
Bldg/Room No. 322-103, containing an area of approximately 336 square feet, as shown on  
the attached Exhibits A and B.

ZONING:

State Land Use District:	Urban
County of Maui:	Airport

BLNR – ISSUANCE OF A REVOCABLE PERMIT FOR SPACES IN THE MAIN  
TERMINAL FOR AIRLINE OPERATIONS, ALASKA AIRLINES, INC.

Page 2

LAND TITLE STATUS:

Section 5(a) lands of the Hawai'i Admission Act: Non-Ceded  
DHHL 30% entitlement lands pursuant to Hawai'i Admission Act YES \_\_\_ NO X

CURRENT USE STATUS:

Airport and aeronautical purposes.

CHARACTER OF USE:

Space for airline operations.

COMMENCEMENT DATE:

Upon complete execution of the revocable permit.

MONTHLY RENTAL:

\$11,777.58 (as determined from the Airports Division Signatory Rates and Charges  
Hawai'i Airports system, effective July 1, 2018, which rate is \$99.81 per square foot per  
annum).

SECURITY DEPOSIT:

\$35,33274, or three times the monthly rent in effect

HOLDOVER TENANCY:

\$ 392.59

DCCA VERIFICATION:

Place of business registration confirmed:	YES <u>X</u>	NO _____
Registered business name confirmed:	YES <u>X</u>	NO _____
Good standing confirmed:	YES <u>X</u>	NO _____

CHAPTER 343, HRS - ENVIRONMENTAL ASSESSMENT:

Pursuant to Section 11-200-8(a), Environmental Impact Statement Rules of the  
Department of Health, State of Hawai'i, this disposition is exempt from requirements  
regarding preparation of an environmental assessment, negative declaration, or

BLNR – ISSUANCE OF A REVOCABLE PERMIT FOR SPACES IN THE MAIN  
TERMINAL FOR AIRLINE OPERATIONS, ALASKA AIRLINES, INC.

Page 3

environmental impact statement as required by Chapter 343, Hawai‘i Revised Statutes, as amended, relating to Environmental Impact Statements, because the proposed action falls within Exemption Class #1, Comprehensive Exemption List for the State of Hawai‘i, Department of Transportation, dated November 15, 2000, as approved by the Environmental Quality Council. Exemption Class #1 covers operations, repairs, or maintenance of existing structures, facilities, equipment, or topographical features involving negligible or no expansion or change of use beyond that previously existing.

The DOTA consulted with the U.S. Federal Aviation Administration as to the appropriateness of the citation of the Environmental Exemption Class from the Comprehensive list for the Department of Transportation dated November 15, 2000. In this case, the FAA concurred on the appropriateness.

REMARKS:

The Department of Transportation (DOT) has no objections to ASA’s request and therefore, in accordance with Sections 171-11 and 171-55, HRS, relating to Public Purposes and Permits, respectively and therefore, the DOT proposes to issue a month-to-month revocable permit to ASA for spaces in the Main Terminal for its airline operation.

RECOMMENDATION:

That the Board authorize the Department of Transportation to issue a month-to-month revocable permit to ASA, subject to: (1) terms and conditions herein outlined, which are by reference incorporated herein; and (2) such additional terms and conditions as may be prescribed by the Director of Transportation to best serve the interests of the State.

Respectfully submitted,

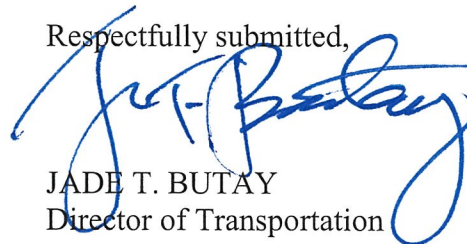

JADE T. BUTAY  
Director of Transportation

APPROVED FOR SUBMITTAL:

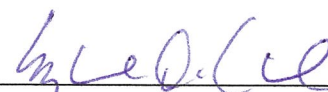
  
\_\_\_\_\_  
SUZANNE D. CASE  
Chairperson and Member

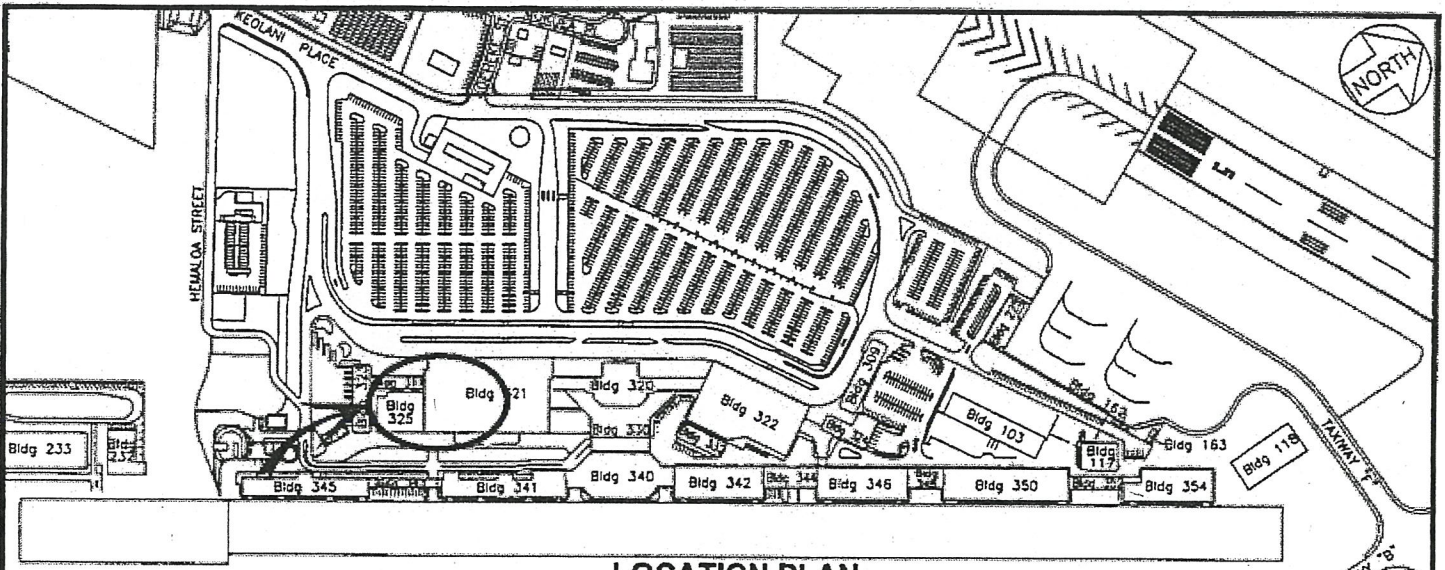

**LOCATION PLAN**

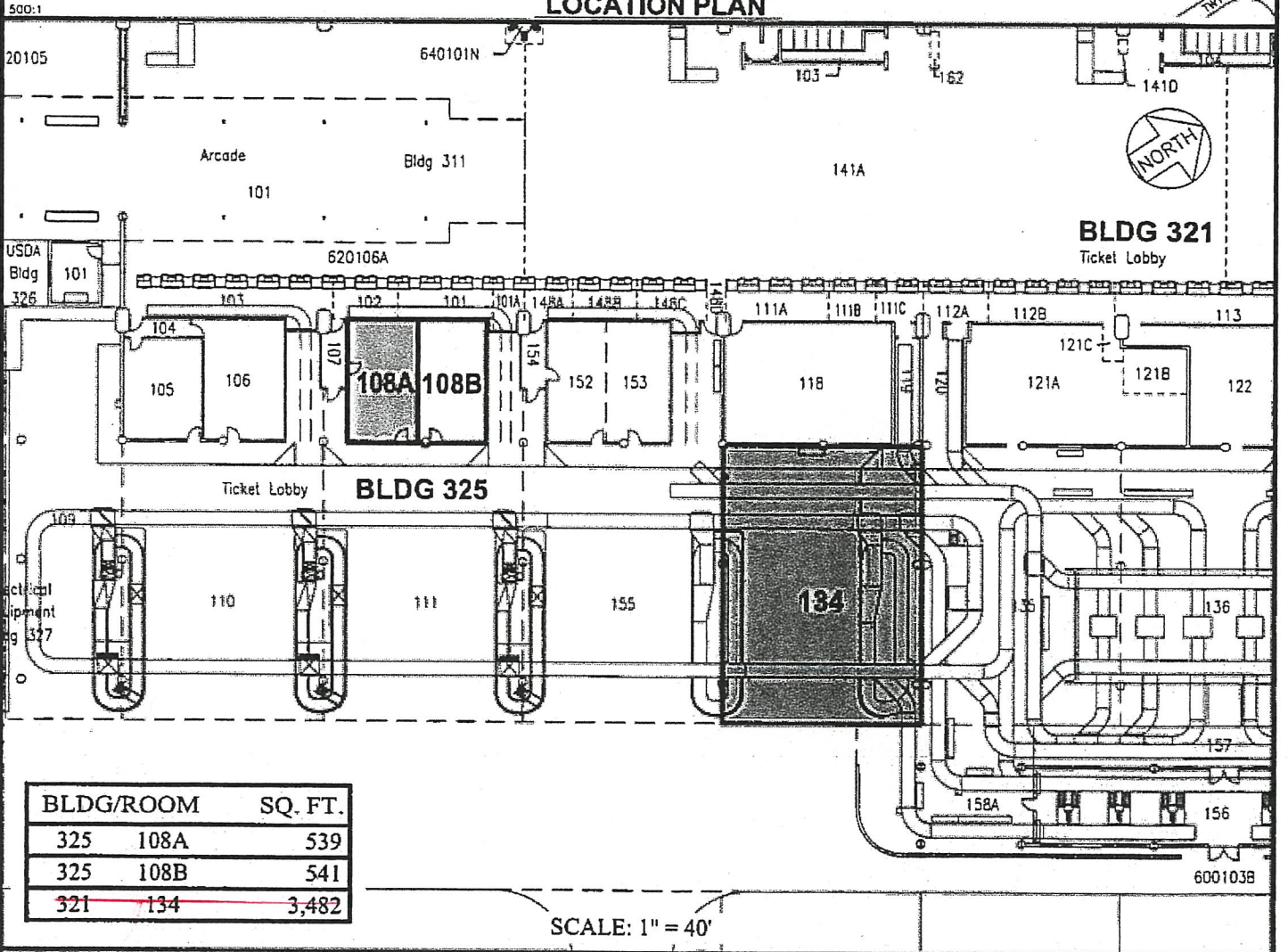

**BLDG 321**  
Ticket Lobby

**BLDG 325**

BLDG/ROOM	SQ. FT.
325 108A	539
325 108B	541
321 134	3,482

SCALE: 1" = 40'

DATE : MARCH 2018

EXHIBIT: **A**



Airports Division

ALASKA AIRLINES INC.

**BUILDING 325 & 321**  
**TICKET LOBBY**  
**GROUND LEVEL**

**325108A&B**  
**321134**

PLATS H1, 35

**KAHULUI AIRPORT**

N:\AIRPORTS\OGG\_Kahului\CAD\PM\ogg\_325108A-01.dwg

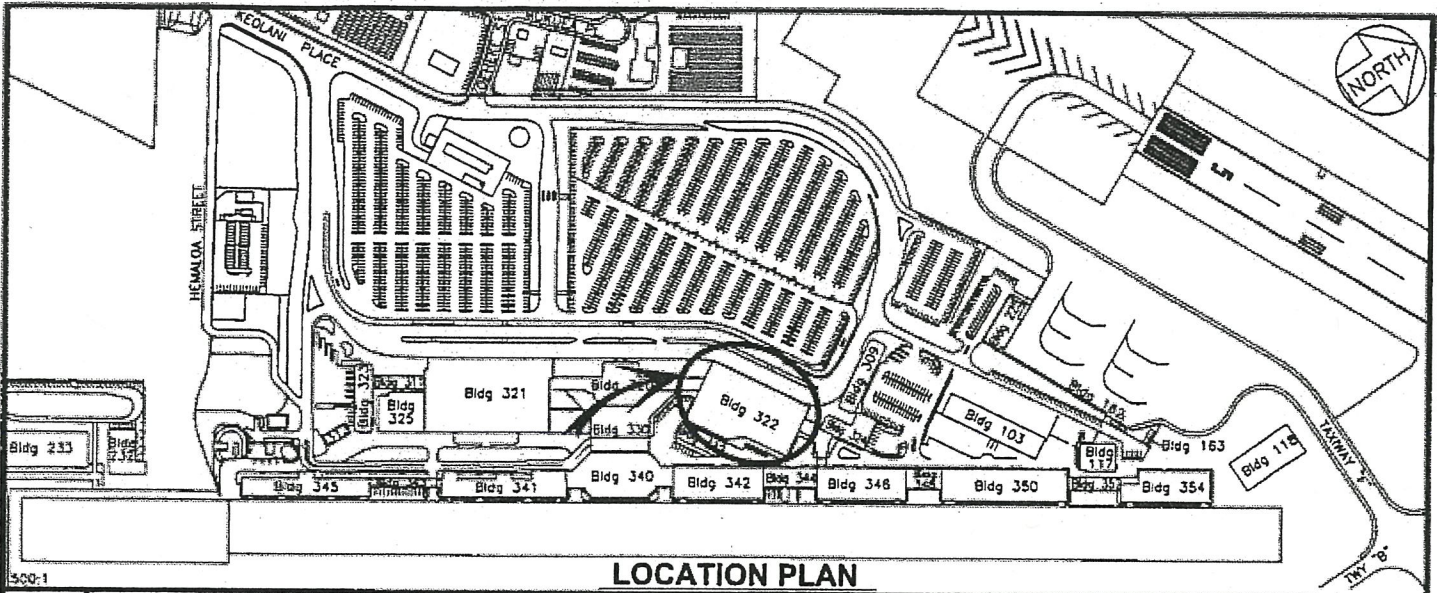

**LOCATION PLAN**

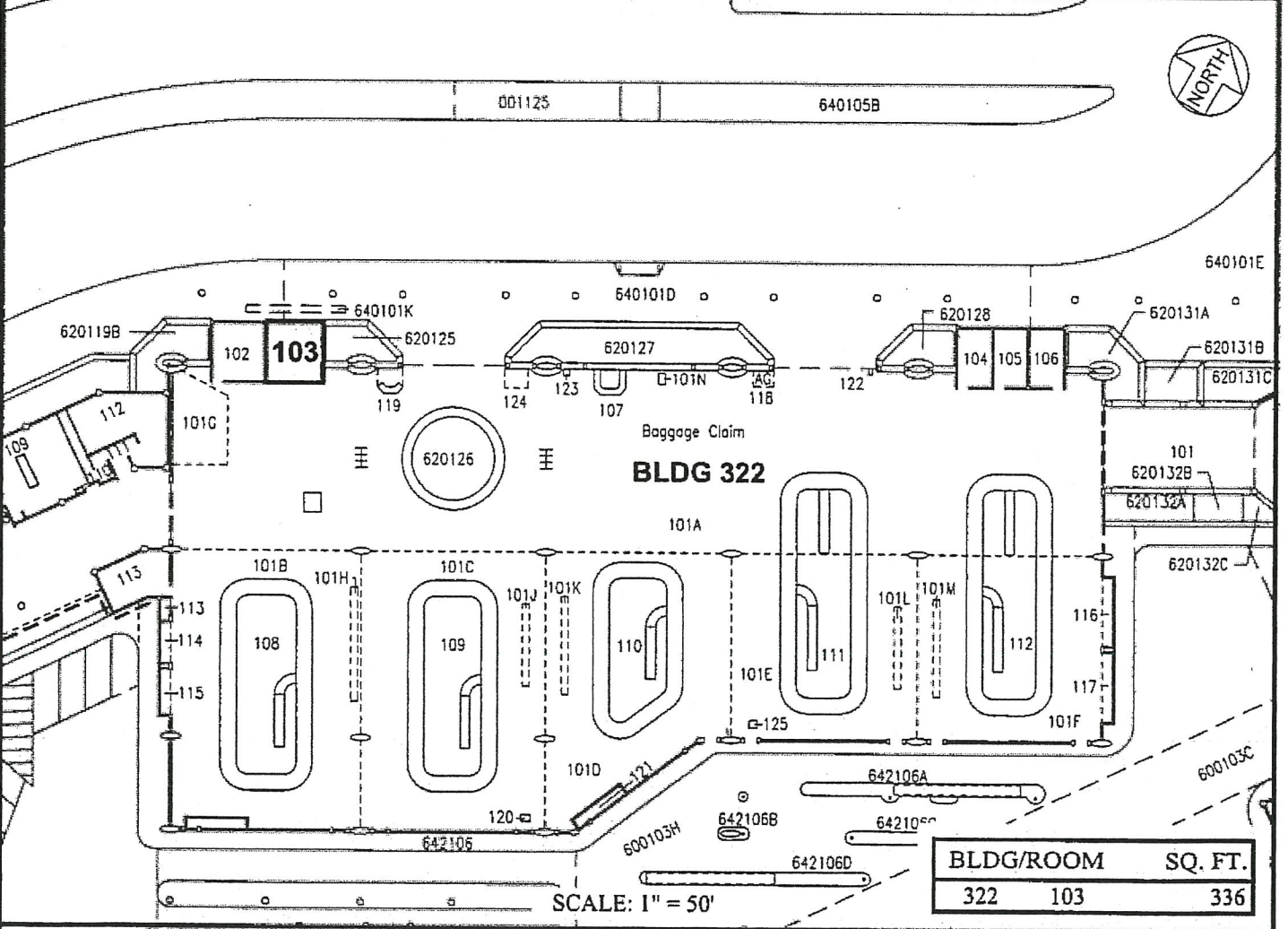

SCALE: 1" = 50'

BLDG/ROOM	SQ. FT.
322 103	336

DATE : MARCH 2018

EXHIBIT: **B**



**ALASKA AIRLINES INC.**

**BUILDING 322  
BAGGAGE CLAIM  
GROUND LEVEL**

**322103  
PLATS A1, 35**