

STATE OF HAWAII
DEPARTMENT OF TRANSPORTATION
869 PUNCHBOWL STREET
HONOLULU, HAWAII 96813-5097

JADE T. BUTAY
DIRECTOR

Deputy Directors
ROY CATALANI
ROSS M. HIGASHI
EDWIN H. SNIFFIN
DARRELL T. YOUNG

IN REPLY REFER TO:

Board of Land and
Natural Resources
State of Hawai'i
Honolulu, Hawai'i

AMENDMENT TO PRIOR BOARD ACTION OF JUNE 8, 2018, ITEM M-2
REQUEST AMENDMENT TO AREA
ISSUANCE OF A REVOCABLE PERMIT
STATE OF HAWAII, DEPARTMENT OF AGRICULTURE,
ANIMAL QUARANTINE BRANCH
DANIEL K. INOUE INTERNATIONAL AIRPORT
TAX MAP KEY: (1) 1-1-003: 066 (PORTION)

O'AHU

On June 8, 2018, under agenda Item M-2, and pursuant to Section 171-55, Hawai'i Revised Statutes, as amended relating specifically to Permits, the Land Board authorized the Department of Transportation (DOT) to issue a month-to-month Revocable Permit to the State of Hawaii, Department of Agriculture, Animal Quarantine Branch, for the use of Building/Room Nos. 360-160B and 360-160L, to use as an Airport Animal Quarantine Holding Facility at Daniel K. Inouye International Airport.

PURPOSE:

The DOT requests certain changes to the AREA, as written on said submittal previously approved by the Land Board (attached).

The changes should read as follows:

AREA:

Original:

Bldg/Room No. 360-130B, containing an area of approximately 3,912 square feet; and
Bldg/Room No. 360-130L, containing an area of approximately 690 square feet,
as shown and delineated on the attached map labeled Exhibit "A".

ITEM M-4

BLNR – AMENDMENT TO PRIOR BOARD ACTION OF JUNE 8, 2018, ITEM M-2
ISSUANCE OF A REVOCABLE PERMIT, REQUEST AMENDMENT TO AREA
STATE OF HAWAII, DEPARTMENT OF AGRICULTURE,
ANIMAL QUARANTINE BRANCH

Page 2

Amended:

Bldg/Room No. 360-130B, containing an area of approximately 3,912 square feet;
Bldg/Room No. 360-130K, containing an area of approximately 164 square feet;
Bldg/Room No. 360-130L, containing an area of approximately 690 square feet;
Bldg/Room No. 360-148B, containing an area of approximately 487 square feet;
Bldg/Room No. 360-148C, containing an area of approximately 1,598 square feet; and
Bldg/Room No. 360-148E, containing an area of approximately 164 square feet,
as shown and delineated on the attached map labeled Exhibit "A".

REMARKS:

All other terms as outlined in the submittal previously approved by the Land Board remain unchanged.

RECOMMENDATION:

The Land Board amends its prior action of June 8, 2018, under agenda Item M-2, by approving the changes to the Area, for the issuance of a month-to-month Revocable Permit to the State of Hawaii, Department of Agriculture, Animal Quarantine Branch, as herein outlined, which are by reference incorporated herein and subject to such other terms and conditions as may be prescribed by the Director of Transportation to best serve the interests of the State.

Respectfully submitted,

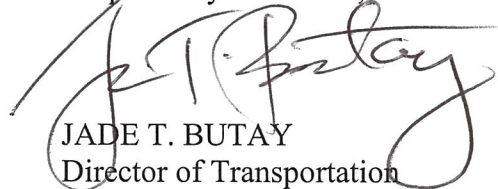

JADE T. BUTAY
Director of Transportation

APPROVED FOR SUBMITTAL:



SUZANNE D. CASE
Chairperson and Member

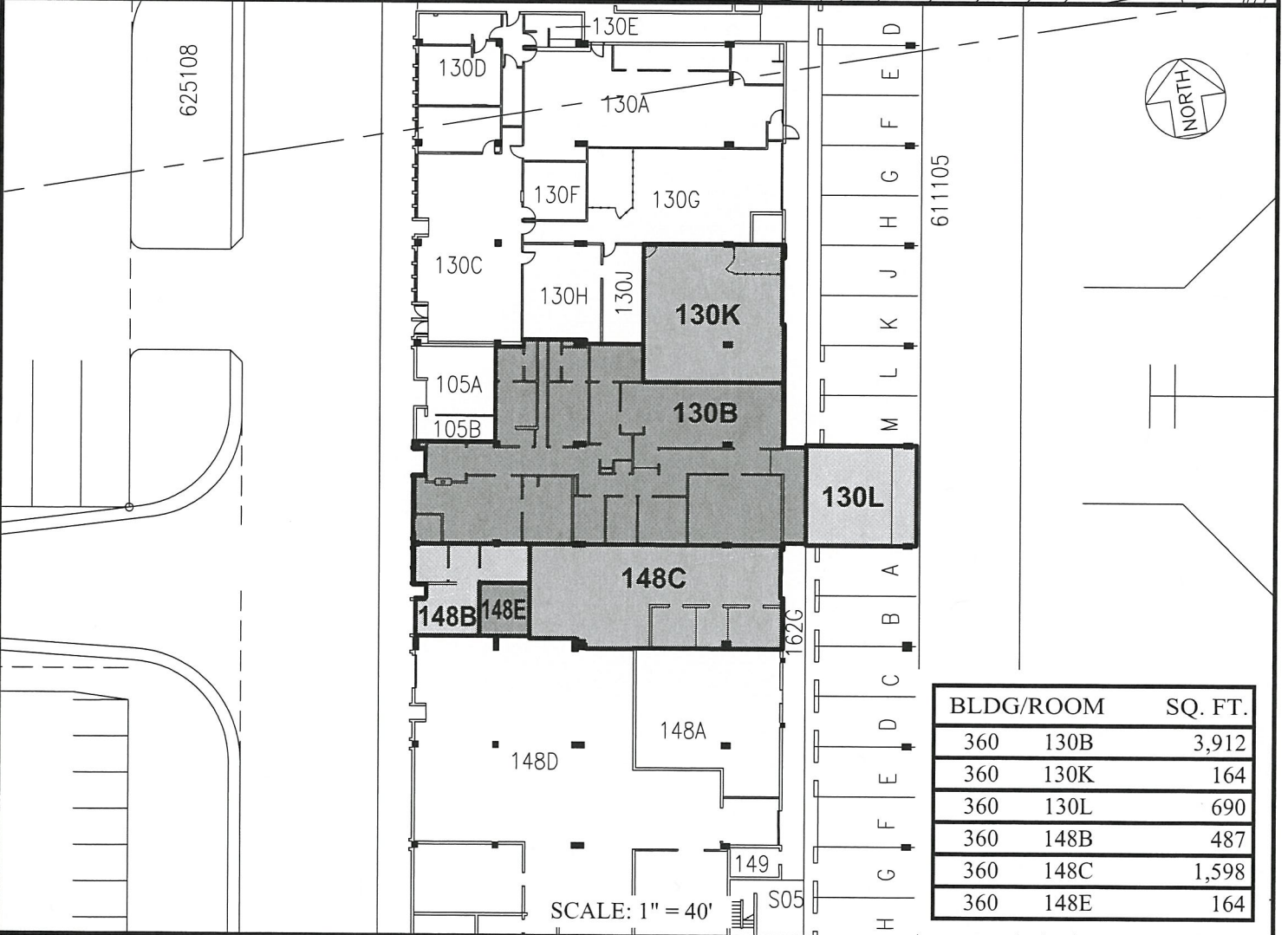
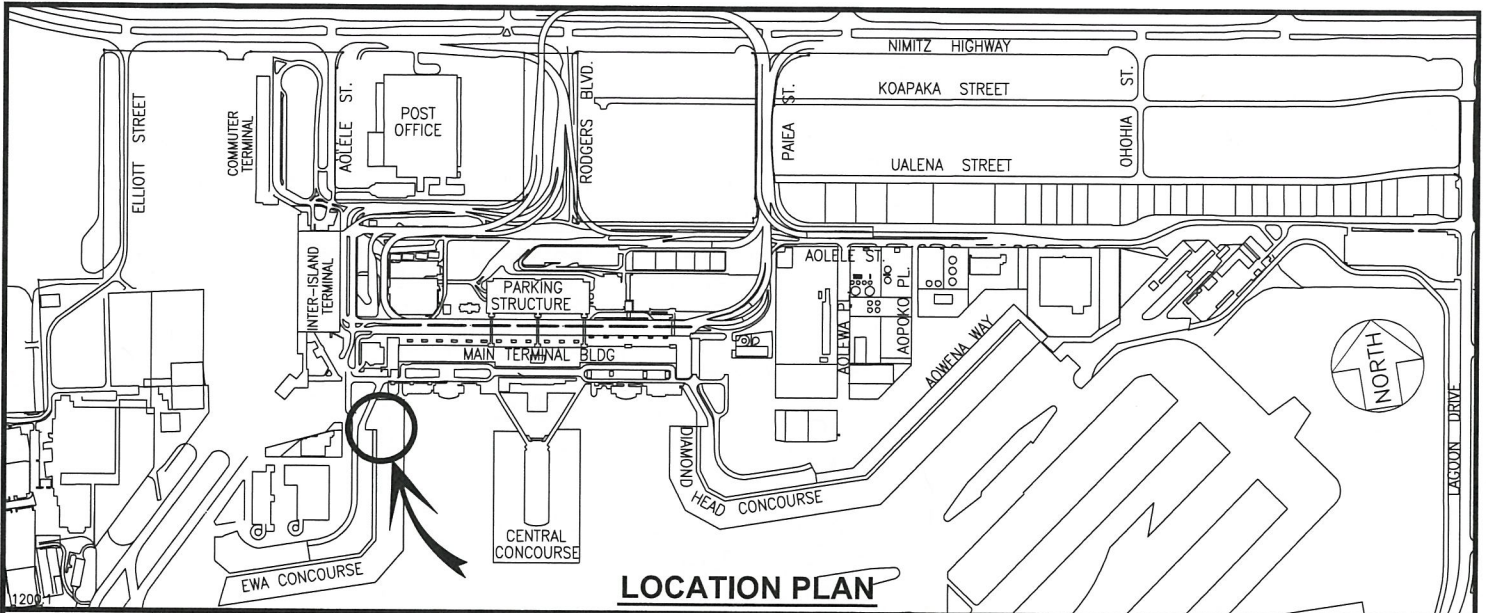

BLDG/ROOM	SQ. FT.
360 130B	3,912
360 130K	164
360 130L	690
360 148B	487
360 148C	1,598
360 148E	164

RP-8741

DATE : JULY 2018

EXHIBIT: **A**



STATE OF HAWAII,
DEPT. OF AGRICULTURE,
ANIMAL QUARANTINE BRANCH

BUILDING 360
EWA CONCOURSE
GROUND LEVEL

360130B
360130K&L
360148B,C,&E
PLAT A1

DAVID Y. IGE
GOVERNOR



STATE OF HAWAII
DEPARTMENT OF TRANSPORTATION
869 PUNCHBOWL STREET
HONOLULU, HAWAII 96813-5097

JUN 8 2018

JADE T. BUTAY
DIRECTOR

Deputy Directors
ROY CATALANI
ROSS M. HIGASHI
EDWIN H. SNIFFIN
DARRELL T. YOUNG

IN REPLY REFER TO:

Board of Land and
Natural Resources
State of Hawai'i
Honolulu, Hawai'i

ISSUANCE OF A REVOCABLE PERMIT
FOR AN AIRPORT ANIMAL QUARANTINE HOLDING FACILITY
STATE OF HAWAII, DEPARTMENT OF AGRICULTURE,
ANIMAL QUARANTINE BRANCH
DANIEL K. INOUE INTERNATIONAL AIRPORT
TAX MAP KEY: (1) 1-1-003: 066 (PORTION)

O'AHU

APPLICANT:

State of Hawai'i, Department of Agriculture, Animal Quarantine Branch (AQB), whose business address is 99-951 Halawa Valley Street, Aiea, Hawai'i 96701.

LEGAL REFERENCE:

Section 171-55, Hawai'i Revised Statutes.

LOCATION:

Building No. 360, Ewa Concourse, Ground Level, at Daniel K. Inouye International Airport, identified by Tax Map Key: 1st Division, 1-1-003: 066 (Portion).

AREA:

Bldg/Room No. 360-130B, containing an area of approximately 3,912 square feet; and Bldg/Room No. 360-130L, containing an area of approximately 690 square feet, as shown and delineated on the attached map labeled Exhibit "A".

ZONING:

State Land Use District: Urban
City and County of Honolulu LUO: Industrial (I-2)

ITEM M-2
JUN 8 2018

BLNR – ISSUANCE OF A REVOCABLE PERMIT FOR AN AIRPORT ANIMAL
QUARANTINE HOLDING FACILITY STATE OF HAWAII, DEPARTMENT OF
AGRICULTURE, ANIMAL QUARANTINE BRANCH

Page 2

LAND TITLE STATUS:

Non-ceded - Section 5(a) lands of the Hawai'i Admission Act
DHHL 30% entitlement lands pursuant to Hawai'i Admission Act YES ___ NO X

CURRENT USE STATUS:

Land presently encumbered by Governor's Executive Order No. 3201, dated June 8,
1983, setting aside 3,152.177 acres designated as Honolulu International Airport under
the control and management of the State of Hawai'i, Department of Transportation,
Airports Division for Airport Purposes.

CHARACTER OF USE:

Airport Animal Quarantine Holding Facility.

COMMENCEMENT DATE:

To be determined by the Director of Transportation at a later date.

MONTHLY RENTAL:

Not applicable (NA)

SECURITY DEPOSIT:

NA

CHAPTER 343, HRS - ENVIRONMENTAL ASSESSMENT:

Pursuant to Section 11-200-8(a), Environmental Impact Statement Rules of the
Department of Health, State of Hawai'i, this disposition is exempt from requirements
regarding preparation of an environmental assessment, negative declaration, or
environmental impact statement as required by Chapter 343, Hawai'i Revised Statutes, as
amended, relating to Environmental Impact Statements, because the proposed action falls
within Exemption Class #1, Comprehensive Exemption List for the State of Hawai'i,
Department of Transportation, dated November 15, 2000, as approved by the
Environmental Quality Council. Exemption Class #1 covers operations, repairs, or
maintenance of existing structures, facilities, equipment, or topographical features
involving negligible or no expansion or change of use beyond that previously existing.

BLNR – ISSUANCE OF A REVOCABLE PERMIT FOR AN AIRPORT ANIMAL
QUARANTINE HOLDING FACILITY STATE OF HAWAII, DEPARTMENT OF
AGRICULTURE, ANIMAL QUARANTINE BRANCH

Page 3

The DOTA consulted with the U.S. Federal Aviation Administration as to the appropriateness of the citation of the Environmental Exemption Class from the Comprehensive list for the Department of Transportation dated November 15, 2000. The FAA concurred on the appropriateness.

REMARKS:

In accordance with Section 171-55, relating to Permits, the Department of Transportation proposes to issue a month-to-month revocable permit to AQB for their Airport animal quarantine holding facility at Daniel K. Inouye International Airport.

RECOMMENDATION:

That the Board authorize the Department of Transportation to issue a month-to-month revocable permit to AQB, subject to: (1) terms and conditions herein outlined, which are by reference incorporated herein; and (2) such additional terms and conditions as may be prescribed by the Director of Transportation to best serve the interests of the State.

Respectfully submitted,

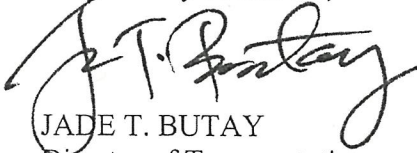
JADE T. BUTAY
Director of Transportation

APPROVED FOR SUBMITTAL:

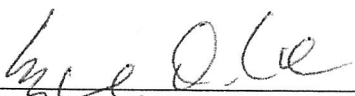
SUZANNE D. CASE
Chairperson and Member

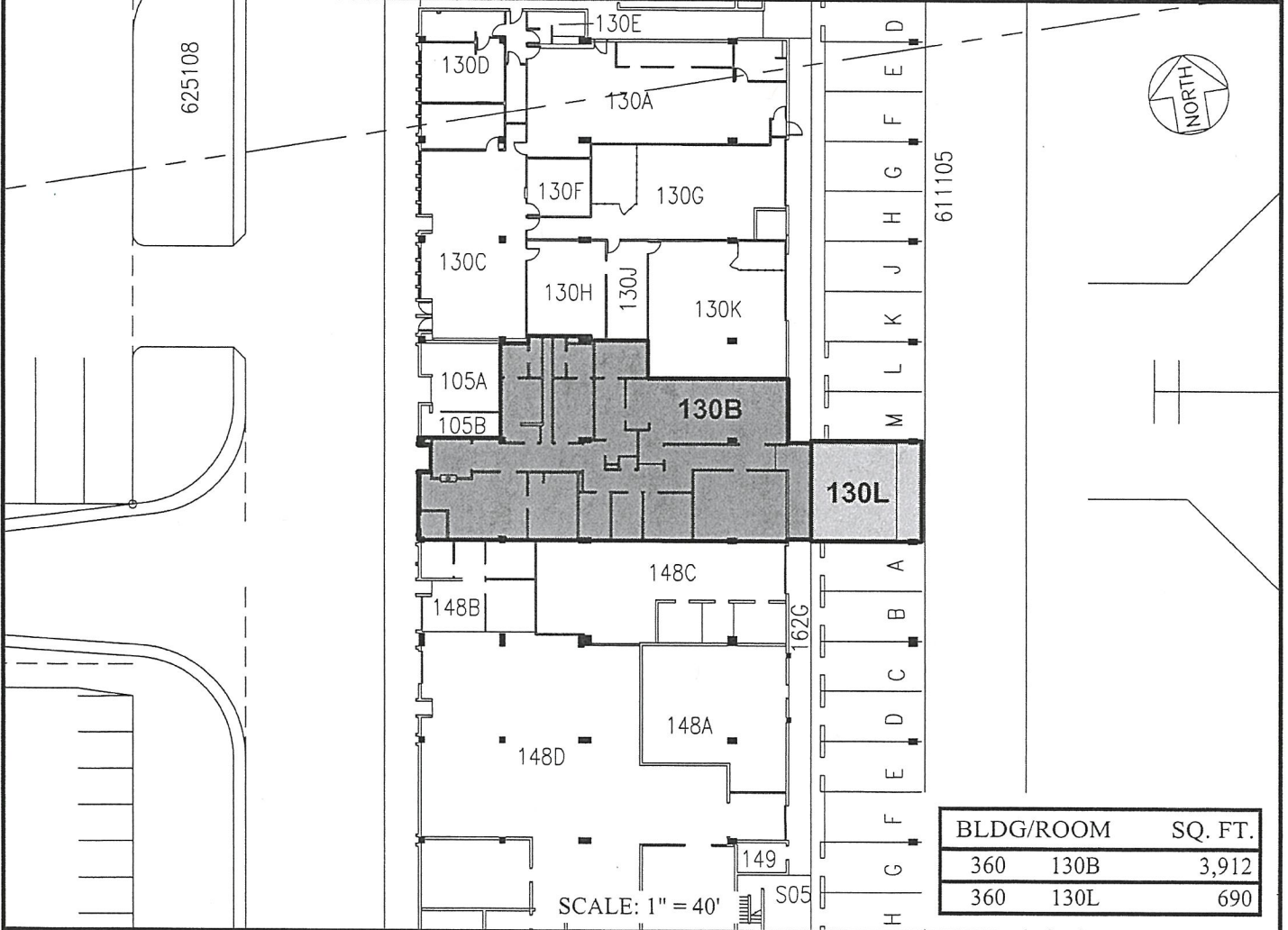
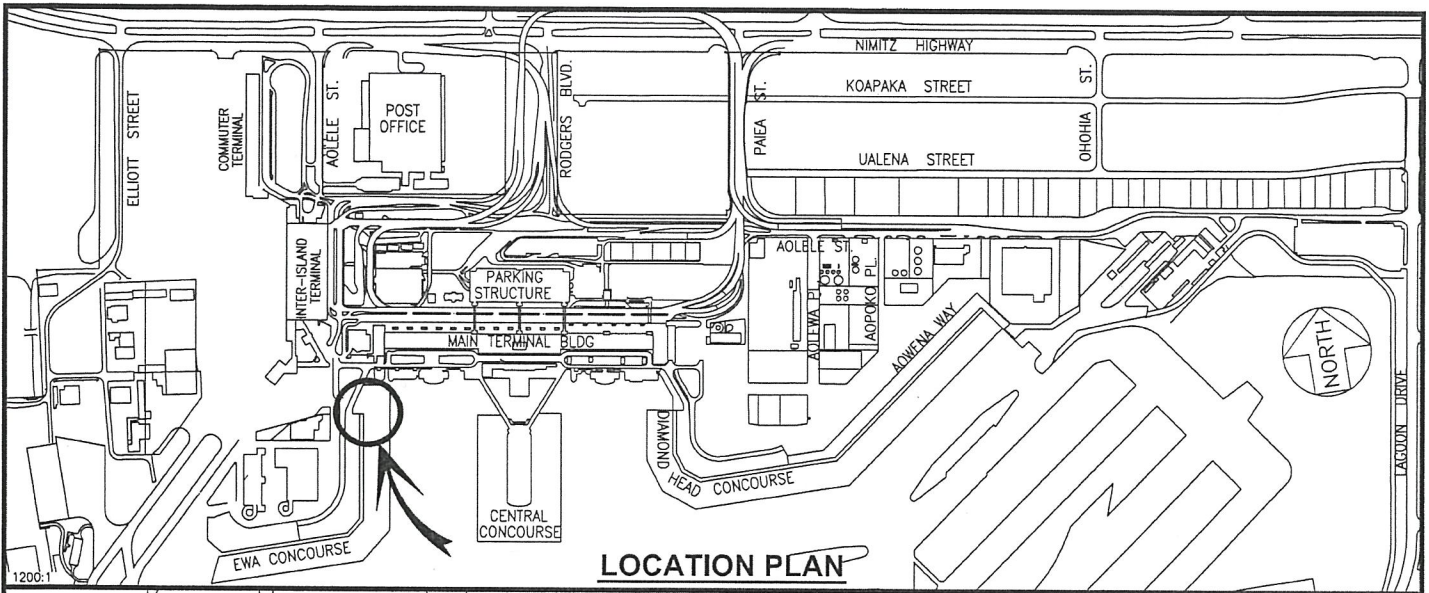

DATE : MAY 2018

EXHIBIT: **A**



Airports Division

STATE OF HAWAII,
DEPT. OF AGRICULTURE,
ANIMAL QUARANTINE BRANCH

BUILDING 360
EWA CONCOURSE
GROUND LEVEL

360130B
360130L
PLAT A1