

DAVID Y. IGE  
GOVERNOR



STATE OF HAWAII  
DEPARTMENT OF TRANSPORTATION  
869 PUNCHBOWL STREET  
HONOLULU, HAWAII 96813-5097

JADE T. BUTAY  
DIRECTOR

Deputy Directors  
ROY CATALANI  
ROSS M. HIGASHI  
EDWIN H. SNIFFEN  
DARRELL T. YOUNG

IN REPLY REFER TO:

Board of Land and  
Natural Resources  
State of Hawai'i  
Honolulu, Hawai'i

ISSUANCE OF A REVOCABLE PERMIT FOR  
CONSTRUCTION MATERIAL STORAGE AND EQUIPMENT STAGING  
RALPH S. INOUE CO., LTD.  
DANIEL K. INOUE INTERNATIONAL AIRPORT  
TAX MAP KEY: (1) 1-1-003: 001 (PORTION)

O'AHU

APPLICANT:

Ralph S. Inouye Co., Ltd. (RSIC), whose mailing address is 500 Alakawa Street,  
Room 220E, Honolulu, Hawai'i 96817.

LEGAL REFERENCE:

Section 171-55, Hawai'i Revised Statutes.

LOCATION:

A portion of Daniel K. Inouye International Airport, Island of O'ahu, State of Hawai'i,  
identified by Tax Map Key: 1st Division, 1-1-003: 001 (Portion).

AREA:

Area/Space No. 640-163, containing an area of approximately 5,181 square feet,  
as shown and delineated on the attached map labeled Exhibit "A".

ZONING:

State Land Use District: Urban  
City and County of Honolulu LUO: Industrial (I-2)

LAND TITLE STATUS:

Non-ceded - Section 5(a) lands of the Hawai'i Admission Act  
DHHL 30% entitlement lands pursuant to Hawai'i Admission Act YES \_\_\_ NO X

**ITEM M-13**

BLNR – ISSUANCE OF A REVOCABLE PERMIT FOR  
CONSTRUCTION MATERIAL STORAGE AND EQUIPMENT STAGING  
RALPH S. INOUE CO., LTD.

Page 2

CURRENT USE STATUS:

Land presently encumbered by Governor’s Executive Order No. 3201, dated June 8, 1983, setting aside 3,152.177 acres designated as Daniel K. Inouye International Airport under the control and management of the State of Hawai‘i, Department of Transportation, Airports Division (DOTA) for Airport Purposes.

CHARACTER OF USE:

RSIC will use the space for construction material storage and equipment staging, at no charge, as specifically stated under Contract No. 63317, State Project No. AO1043-28, Overseas Terminal Metal Roof Replacement at Honolulu International Airport.

COMMENCEMENT DATE:

To be determined by the Director of Transportation at a later date.

MONTHLY RENTAL:

Not applicable (NA)

SECURITY DEPOSIT:

NA

DCCA VERIFICATION:

Place of business registration confirmed:	YES <u>X</u>	NO _____
Registered business name confirmed:	YES <u>X</u>	NO _____
Good standing confirmed:	YES <u>X</u>	NO _____

CHAPTER 343, HRS - ENVIRONMENTAL ASSESSMENT:

Pursuant to Section 11-200-8(a), Environmental Impact Statement Rules of the Department of Health, State of Hawai‘i, this disposition is exempt from requirements regarding preparation of an environmental assessment, negative declaration, or environmental impact statement as required by Chapter 343, Hawai‘i Revised Statutes, as amended, relating to Environmental Impact Statements, because the proposed action falls within Exemption Class #1, Comprehensive Exemption List for the State of Hawai‘i, Department of Transportation, dated November 15, 2000, as approved by the Environmental Quality Council. Exemption Class #1 covers operations, repairs, or maintenance of existing structures, facilities, equipment, or topographical features involving negligible or no expansion or change of use beyond that previously existing.

BLNR – ISSUANCE OF A REVOCABLE PERMIT FOR  
CONSTRUCTION MATERIAL STORAGE AND EQUIPMENT STAGING  
RALPH S. INOUYE CO., LTD.

Page 3

The DOTA consulted with the U.S. Federal Aviation Administration as to the appropriateness of the citation of the Environmental Exemption Class from the Comprehensive list for the Department of Transportation dated November 15, 2000. The FAA concurred on the appropriateness.

REMARKS:

The Department of Transportation proposes to issue a permit to RSIC for the use of the space for construction material storage and equipment staging, free of rent, as specifically stated under Contract No. 63317, State Project No. AO1043-28, Overseas Terminal Metal Roof Replacement at Honolulu International Airport, Section 1.04, Provisions for Field Office/Storage Space: “Pending the availability of space on airport property, the State will issue a permit to the Contractor for the use of the space, at no charge, to be used specifically for a field office and/or storage of materials and equipment....”

RECOMMENDATION:

That the Board authorize the Department of Transportation to issue a month-to-month revocable permit to RSIC, subject to: (1) terms and conditions herein outlined, which are by reference incorporated herein; and (2) such additional terms and conditions as may be prescribed by the Director of Transportation to best serve the interests of the State.

Respectfully submitted,

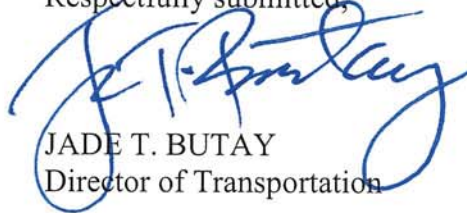

JADE T. BUTAY  
Director of Transportation

APPROVED FOR SUBMITTAL:

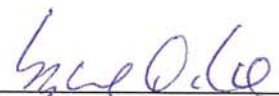

---

SUZANNE D. CASE  
Chairperson and Member

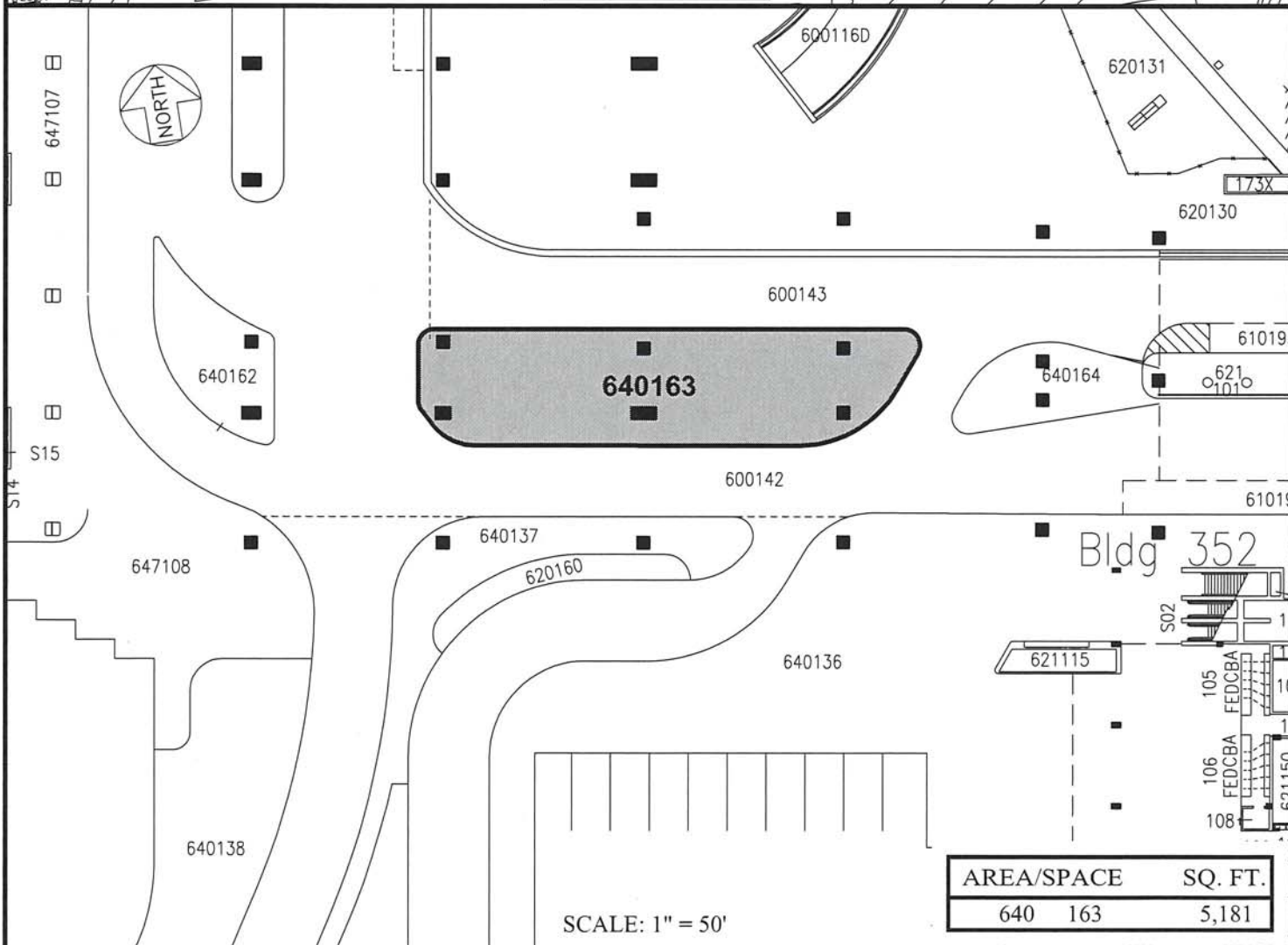
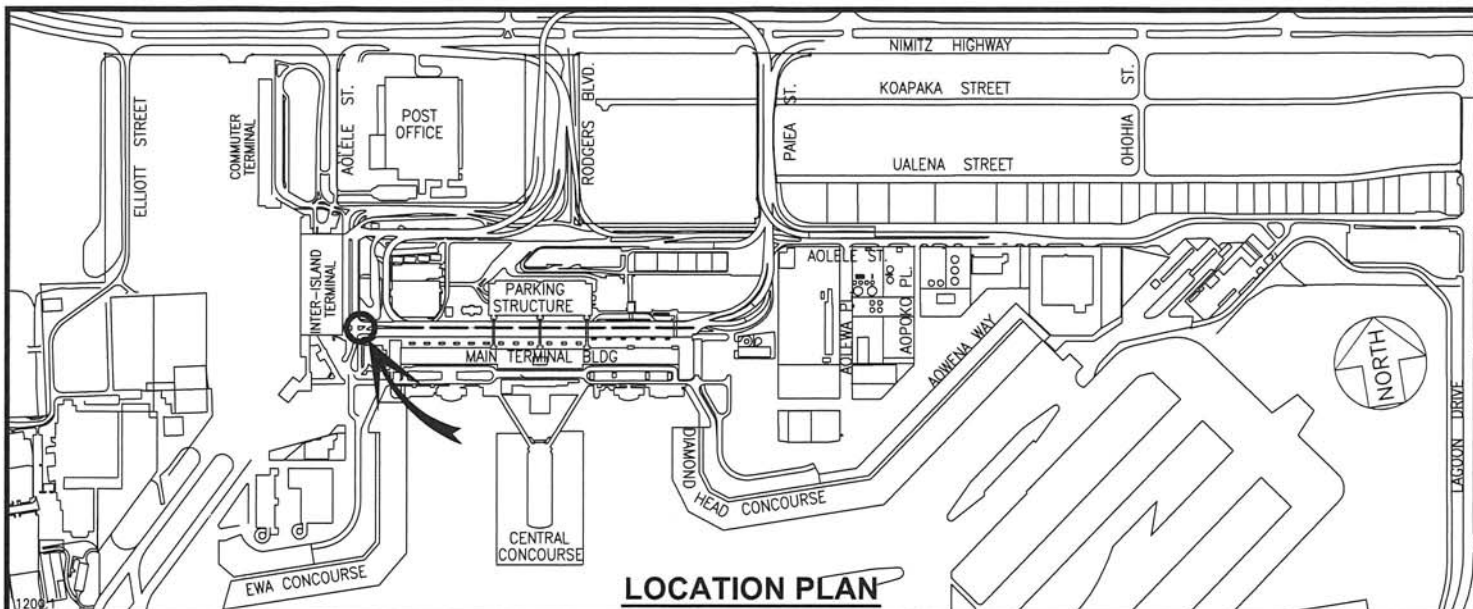

DATE : JULY 2018

EXHIBIT: **A**



Airports Division

RALPH S. INOUE CO., LTD.

PUBLIC WALKWAYS & SIDEWALKS  
 MAIN TERMINAL AREA  
 GROUND LEVEL

640163

PLAT E1