

DAVID Y. IGE
GOVERNOR

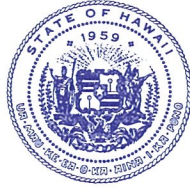

STATE OF HAWAII
DEPARTMENT OF TRANSPORTATION
869 PUNCHBOWL STREET
HONOLULU, HAWAII 96813-5097

JADE T. BUTAY
DIRECTOR

Deputy Directors
ROY CATALANI
ROSS M. HIGASHI
EDWIN H. SNIFFEN
DARRELL T. YOUNG

IN REPLY REFER TO:

Board of Land and
Natural Resources
State of Hawai'i
Honolulu, Hawai'i

ISSUANCE OF A REVOCABLE PERMIT
FOR FLORIST CONCESSION OFFICE SPACE
GREETERS OF HAWAII, LTD.
DANIEL K. INOUE INTERNATIONAL AIRPORT
TAX MAP KEY: (1) 1-1-03: 42 (PORTION)

O'AHU

APPLICANT:

Greeters of Hawaii, Ltd., whose business address is P.O. Box 29638, Honolulu,
Hawai'i 96820.

LEGAL REFERENCE:

Section 171-55, Hawai'i Revised Statutes.

LOCATION AND TAX MAP KEY:

Daniel K. Inouye International Airport (HNL)
Tax Map Key: 1st Division, 1-1-003: 42 (Portion)

AREA:

Building 341, Space No. 224C, containing an area of approximately 72
square feet, as delineated on the attached map labeled Exhibit A dated August 2018.

ZONING:

State Land Use District: Urban
City and County of Honolulu: Industrial (I-2)

ITEM M-2

LAND TITLE STATUS:

Section 5(a) lands of the Hawai'i Admissions Act: Ceded
DHHL 30% entitlement lands pursuant to the Hawai'i State Constitution: No

CURRENT USE STATUS:

Land presently encumbered by Governor's Executive Order No. 3201, dated June 8, 1983, setting aside 3,152,177 acres designated as Honolulu International Airport under the control and management of the State of Hawai'i, Department of Transportation Airports Division (DOTA) for Airports purposes.

CHARACTER OF USE:

Florist concession office space.

COMMENCEMENT DATE:

Upon execution of the document.

MONTHLY RENTAL:

\$ 172.80 (as determined from the DOTA schedule of rates and charges established by appraisal of Airports property statewide).

SECURITY DEPOSIT:

\$ 518.40 (three [3] times the monthly rental in effect).

HOLDOVER TENANCY:

\$ 5.76

DCCA VERIFICATION:

Place of business registration confirmed:	YES <u>X</u>	NO _____
Registered business name confirmed:	YES <u>X</u>	NO _____
Good standing confirmed:	YES <u>X</u>	NO _____

CHAPTER 343, HRS – ENVIRONMENTAL ASSESSMENT:

Pursuant to Section 11-200-8 (a), Environmental Impact Statement Rules of the Department of Health, State of Hawaii, this disposition is exempt from requirements regarding preparation of an environmental assessment, negative declaration, or

environmental impact statement as required by Chapter 343, Hawaii Revised Statutes, as amended, relating to Environmental Impact Statements because the proposed action falls within Exemption Class #1, Comprehensive Exemption List for the State of Hawaii, Department of Transportation Amended November 15, 2000, as approved by the Environmental Quality Council. Exemption Class #1 covers operations, repairs, or maintenance of existing structures, facilities, equipment, or topographical features involving negligible or no expansion or change of use beyond that previously existing.

The DOTA consulted with the U.S. Federal Aviation Administration as to the appropriateness of the citation of the Environmental Exemption Class from the Comprehensive list for the Department of Transportation dated November 15, 2000. The FAA concurred on the appropriateness.

REMARKS:

In accordance with Section 171-55, HRS, relating to Permits, the Department of Transportation proposes to issue a month-to-month revocable permit to Greeters of Hawaii, Ltd., for additional office space at HNL.

RECOMMENDATION:

That the Board authorize the Department of Transportation to issue a month-to-month revocable permit to Greeters of Hawaii, Ltd., subject to: (1) terms and conditions herein outlined, which are by reference incorporated herein; and (2) such additional terms and conditions as may be prescribed by the Director of Transportation to best serve the interests of the State.

Respectfully submitted,

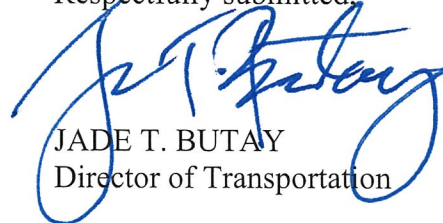
JADE T. BUTAY
Director of Transportation

APPROVAL FOR SUBMITTAL:

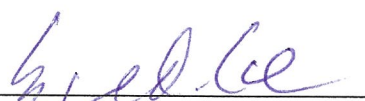
SUZANNE D. CASE
Chairperson and Member

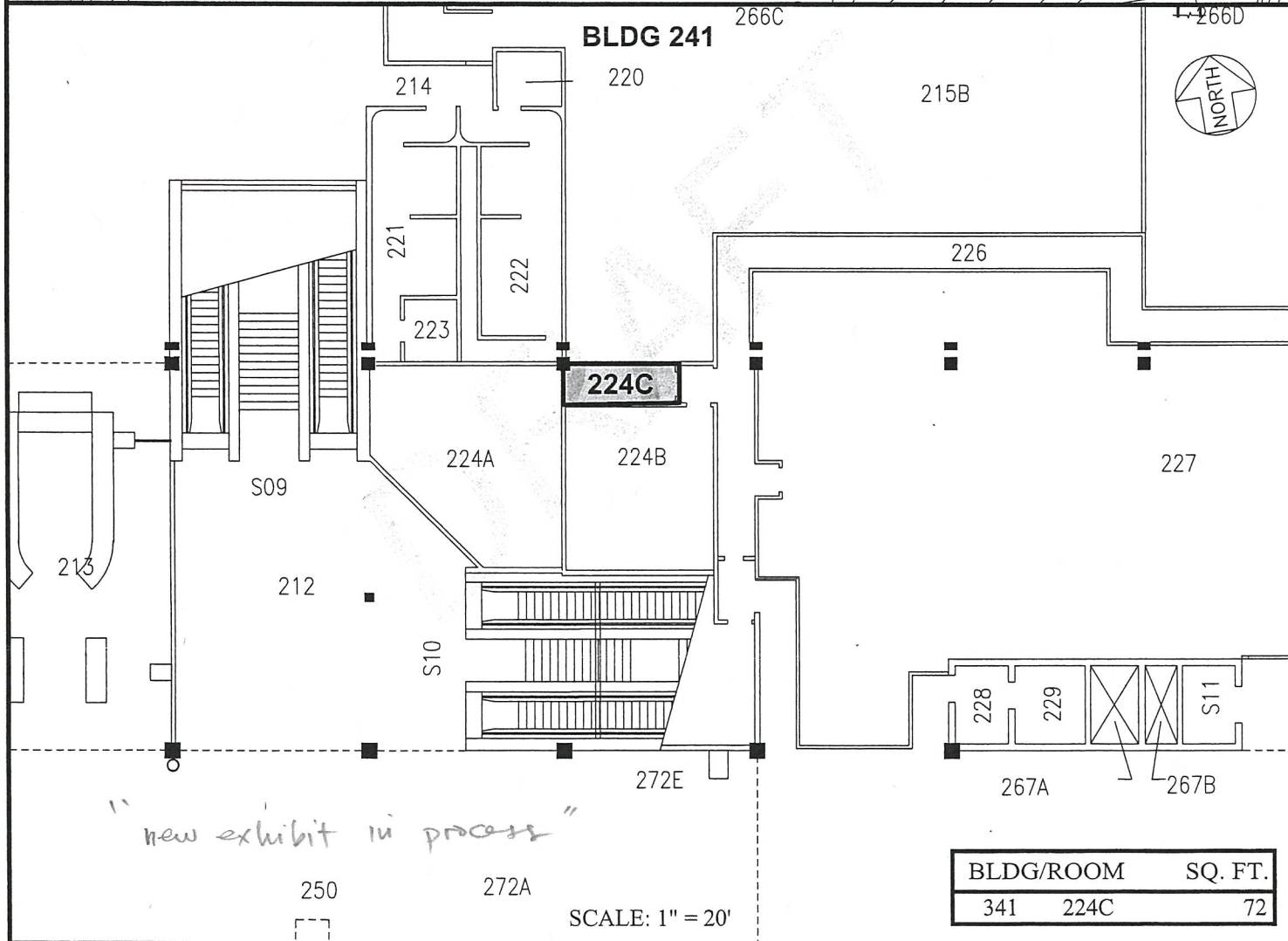
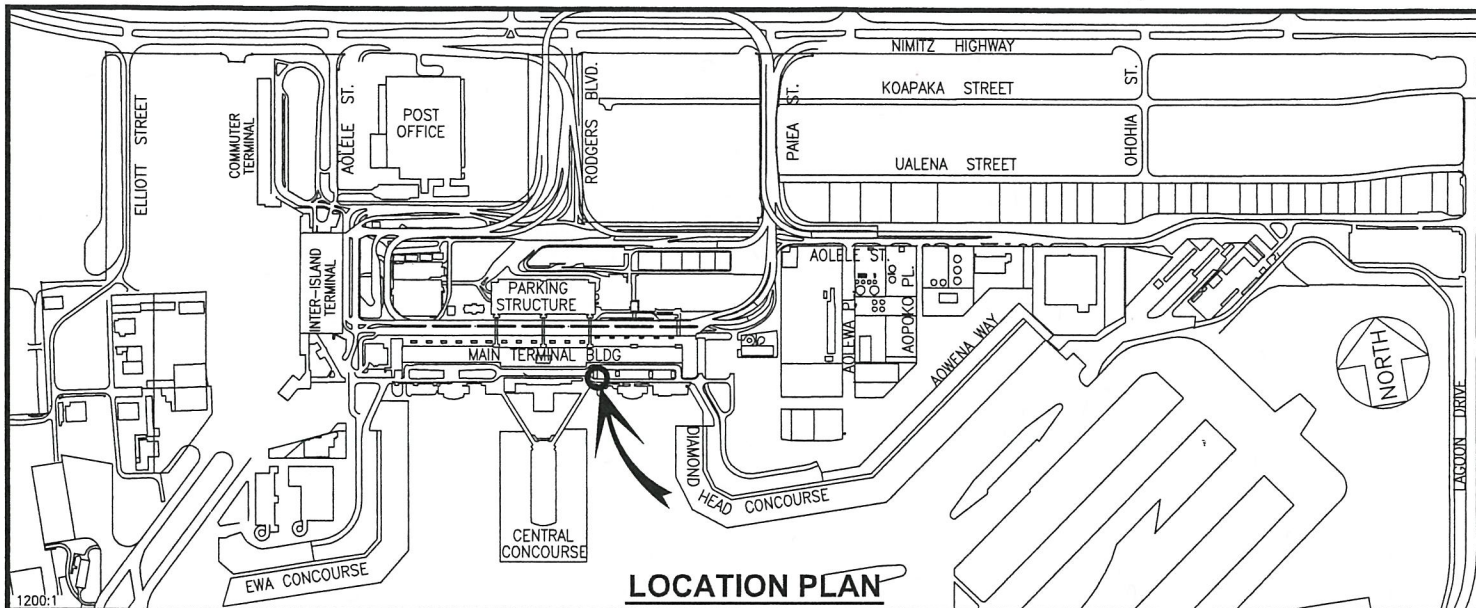

DATE : FEBRUARY 2018

EXHIBIT: **A**



Airports Division

GREETERS OF HAWAII, LTD.

BUILDING 341
EWA DOMESTIC EXTN.
SECOND LEVEL

341224C

PLAT A2