

STATE OF HAWAII
DEPARTMENT OF TRANSPORTATION
869 PUNCHBOWL STREET
HONOLULU, HAWAII 96813-5097

Board of Land and
Natural Resources
State of Hawai'i
Honolulu, Hawai'i

ISSUANCE OF A REVOCABLE PERMIT FOR A MAINTENANCE OFFICE AND
STORAGE SPACE

KONE INC.

DANIEL K. INOUE INTERNATIONAL AIRPORT

O'AHU

TAX MAP KEYS: (1) 1-1-003: 001 (PORTION) and (1) 1-1-003: 066 (PORTION)

LEGAL REFERENCE:

Section 171-55, Hawai'i Revised Statutes (HRS).

APPLICANT:

Kone Inc. (Kone), whose mailing address is 3375 Koapaka Street #D160,
Honolulu, Hawai'i 96819.

LOCATION:

Building No. 360, Ewa Concourse, Ground Level, at Daniel K. Inouye International
Airport, identified by Tax Map Keys: 1st Division, 1-1-003: 001 (PORTION) and
1-1-003: 066 (PORTION).

AREA:

Bldg/Room No. 360-130C, containing an area of approximately 1,544 square feet,
Bldg/Room No. 360-130F, containing an area of approximately 237 square feet,
Bldg/Room No. 360-130G, containing an area of approximately 1,278 square feet,
Bldg/Room No. 360-130H, containing an area of approximately 479 square feet, and
Bldg/Room No. 360-130J, containing an area of approximately 260 square feet, as shown
and delineated on the attached map labeled Exhibit "A".

ZONING:

State Land Use District: Urban
City and County of Honolulu LUO: Industrial (I-2)

ITEM M-4

BLNR- ISSUANCE OF A REVOCABLE PERMIT
FOR A MAINTENANCE OFFICE AND STORAGE SPACE
KONE INC.
Page 2

LAND TITLE STATUS:

Non-ceded - Section 5(a) lands of the Hawai'i Admission Act
DHHL 30% entitlement lands pursuant to Hawai'i Admission Act YES ___ NO X

CURRENT USE STATUS:

Land presently encumbered by Governor's Executive Order No. 3201, dated June 8, 1983, setting aside 3,152.177 acres designated as Daniel K. Inouye International Airport under the control and management of the State of Hawai'i, Department of Transportation, Airports Division (DOTA) for Airport Purposes.

CHARACTER OF USE:

Kone will use the spaces as a maintenance office and for storage, as specifically stated in Contract No. 66130, State Project No. BO1821-43, Maintenance of Elevators and Escalators, Daniel K. Inouye International Airport.

COMMENCEMENT DATE:

To be determined by the Director of Transportation at a later date.

MONTHLY RENTAL:

\$125.00 (\$25.00 per space, per month as stated in Contract No. 66130, Section 10.20 Provisions for Field Office/Storage Space).

SECURITY DEPOSIT:

Three (3) times the monthly rental in effect.

DCCA VERIFICATION:

Place of business registration confirmed:	YES <u>X</u>	NO ___
Registered business name confirmed:	YES <u>X</u>	NO ___
Good standing confirmed:	YES <u>X</u>	NO ___

CHAPTER 343, HRS - ENVIRONMENTAL ASSESSMENT:

Pursuant to Section 11-200-8(a), Environmental Impact Statement Rules of the Department of Health, State of Hawai'i, this disposition is exempt from requirements regarding preparation of an environmental assessment, negative declaration, or environmental impact statement as required by Chapter 343, Hawai'i Revised Statutes, as amended, relating to Environmental Impact Statements, because the proposed action falls

BLNR- ISSUANCE OF A REVOCABLE PERMIT
FOR A MAINTENANCE OFFICE AND STORAGE SPACE
KONE INC.

Page 3

within Exemption Class #1, Comprehensive Exemption List for the State of Hawai'i, Department of Transportation, dated November 15, 2000, as approved by the Environmental Quality Council. Exemption Class #1 covers operations, repairs, or maintenance of existing structures, facilities, equipment, or topographical features involving negligible or no expansion or change of use beyond that previously existing.

The DOTA consulted with the U.S. Federal Aviation Administration as to the appropriateness of the citation of the Environmental Exemption Class from the Comprehensive list for the Department of Transportation dated November 15, 2000. The FAA concurred on the appropriateness.

REMARKS:

In accordance with Section 171-55, HRS, relating to Permits, the Department of Transportation proposes to issue a month-to-month revocable permit to Kone for a maintenance office and storage space, as specified in Contract No. 66130, State Project No. BO1821-43, Maintenance of Elevators and Escalators, Daniel K. Inouye International Airport.

RECOMMENDATION:

That the Board authorize the Department of Transportation to issue a month-to-month revocable permit to Kone Inc., subject to: (1) terms and conditions herein outlined, which are by reference incorporated herein; and (2) such additional terms and conditions as may be prescribed by the Director of Transportation to best serve the interests of the State.

Respectfully submitted,

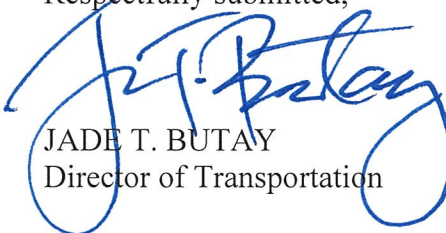
JADE T. BUTAY
Director of Transportation

APPROVED FOR SUBMITTAL:

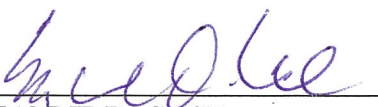
SUZANNE D. CASE
Chairperson and Member

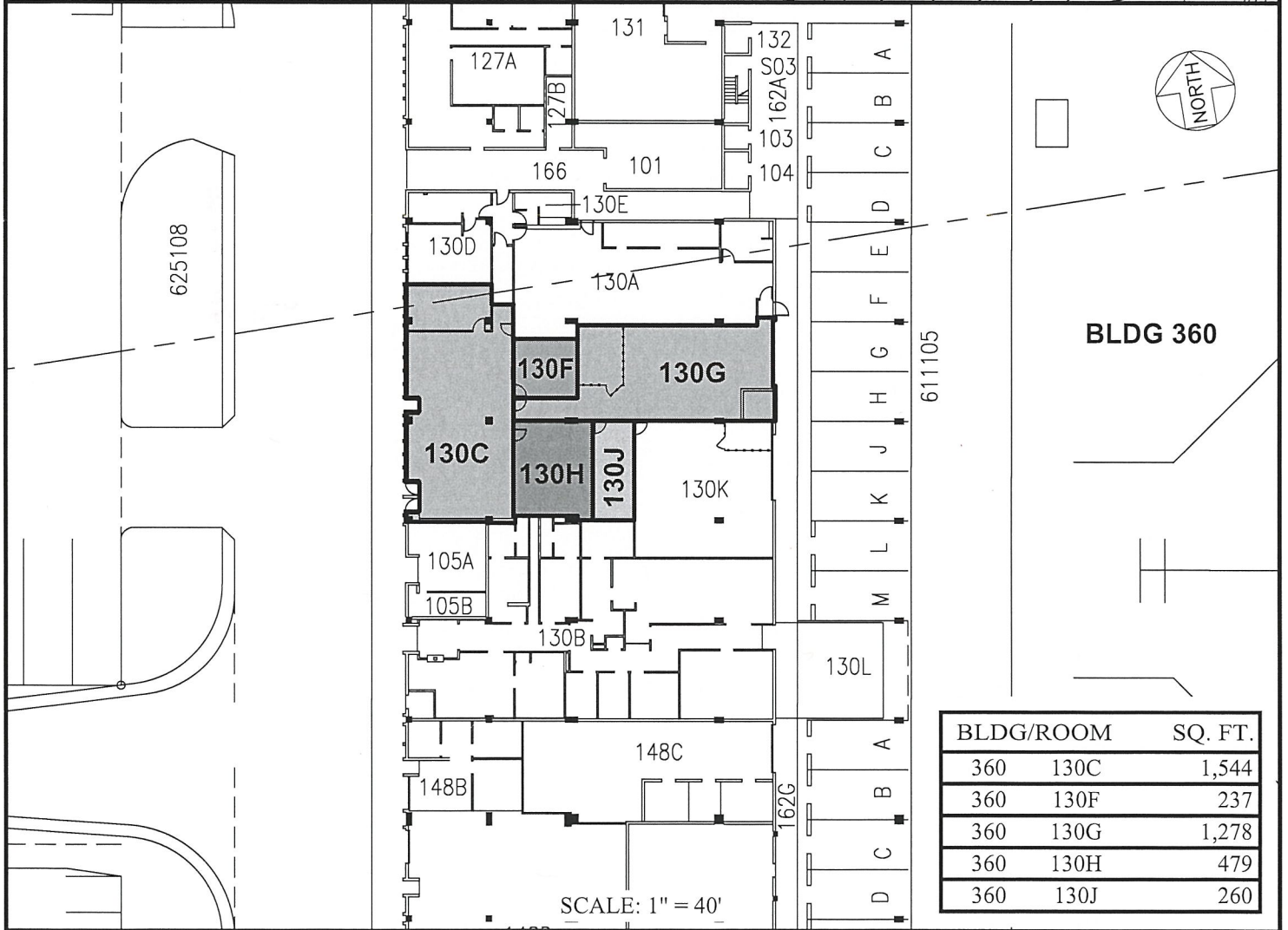
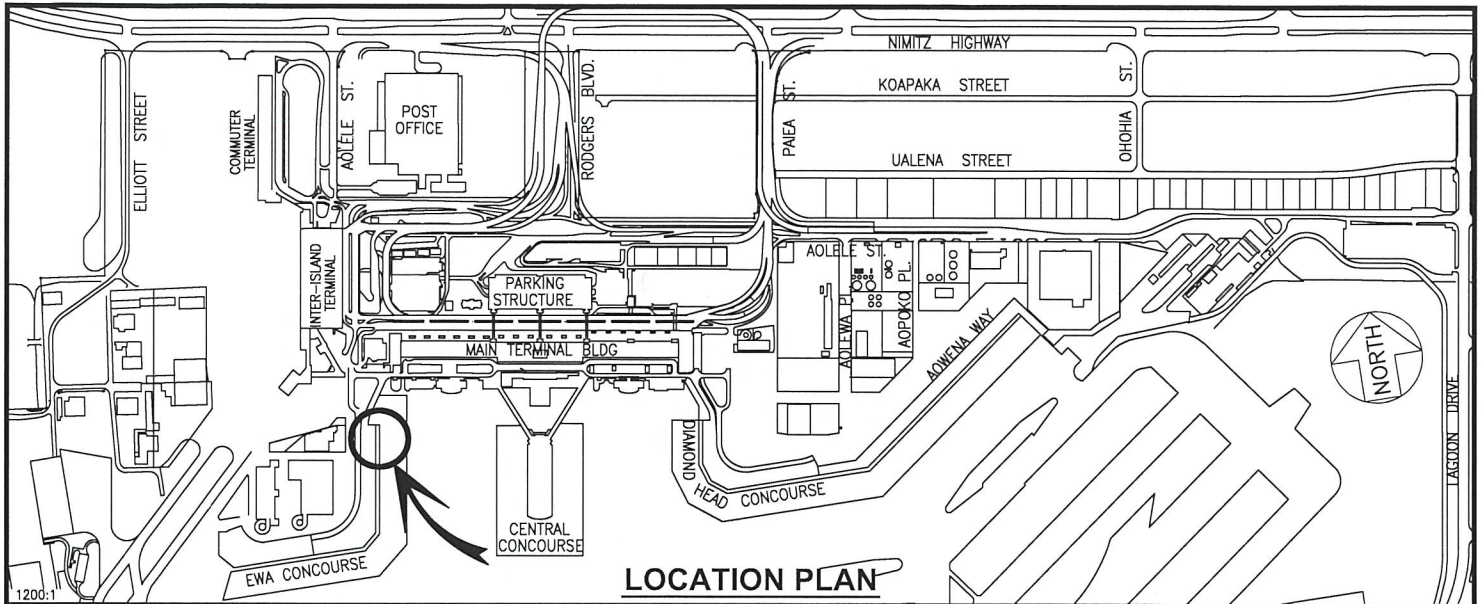

DATE : MAY 2018

EXHIBIT: **A**



Airports Division

KONE INC.

BUILDING 360
EWA CONCOURSE
GROUND LEVEL

360130C
360130F-H
360130J
PLAT A1