

STATE OF HAWAII
DEPARTMENT OF TRANSPORTATION
869 PUNCHBOWL STREET
HONOLULU, HAWAII 96813-5097

JADE T. BUTAY
DIRECTOR

Deputy Directors
ROY CATALANI
ROSS M. HIGASHI
EDWIN H. SNIFFEN
DARRELL T. YOUNG

IN REPLY REFER TO:

Board of Land and
Natural Resources
State of Hawai'i
Honolulu, Hawai'i

ISSUANCE OF A REVOCABLE PERMIT FOR PASSENGER CHECK IN, OFFICE
SPACE, AND AREA FOR A RUBBISH DUMPSTER
OMNI AIR INTERNATIONAL, LLC
DANIEL K. INOUE INTERNATIONAL AIRPORT O'AHU
TAX MAP KEYS: (1) 1-1-003: 053 (PORTION) AND (1) 1-1-003: 001 (PORTION)

LEGAL REFERENCE:

Section 171-55, Hawai'i Revised Statutes (HRS).

APPLICANT:

Omni Air International, LLC (Omni), whose mailing address is 3303 N. Sheridan Road
Hangar 19, Tulsa, Oklahoma 74115.

LOCATION:

Portion of Building No. 339, Diamond Head Domestic, Second Level, and Airline Cargo
Building Area, Ground Level at Daniel K. Inouye International Airport, identified by
Tax Map Keys: 1st Division, 1-1-003: 053 (Portion) and 1-1-003: 001 (Portion).

AREA:

Diamond Head Domestic:

Bldg/Room No. 339-210, containing an area of approximately 836 square feet,
Bldg/Room No. 339-220, containing an area of approximately 183 square feet, and
Bldg/Room No. 339-230, containing an area of approximately 584 square feet, as shown and
delineated on the attached map labeled Exhibit "A".

Airline Cargo Area:

Area/Space No. 641-129, containing an area of approximately 96 square feet, as shown and
delineated on the attached map labeled Exhibit "B".

ITEM M-5

BLNR- ISSUANCE OF A REVOCABLE PERMIT FOR
PASSENGER CHECK IN, OFFICE SPACE AND AREA FOR A RUBBISH DUMPSTER
OMNI AIR INTERNATIONAL, LLC
Page 2

ZONING:

State Land Use District: Urban
City and County of Honolulu LUO: Industrial (I-2)

LAND TITLE STATUS:

Non-ceded - Section 5(a) lands of the Hawai'i Admission Act
DHHL 30% entitlement lands pursuant to Hawai'i Admission Act YES ___ NO X

CURRENT USE STATUS:

Land presently encumbered by Governor's Executive Order No. 3201, dated June 8, 1983, setting aside 3,152.177 acres designated as Daniel K. Inouye International Airport under the control and management of the State of Hawai'i, Department of Transportation, Airports Division (DOTA) for Airport Purposes.

CHARACTER OF USE:

Omni will use the spaces for passenger check in, office space and an area for a rubbish dumpster as part of its Non-signatory Commercial Airline Carrier Operation at Daniel K. Inouye International Airport.

COMMENCEMENT DATE:

To be determined by the Director of Transportation at a later date.

MONTHLY RENTAL:

\$11,537.77 (\$11,488.17 as determined from the DOTA Non-signatory Commercial Air Carrier Rates and Charges, Hawai'i Airports System, effective August 1, 2018, and \$49.60 based upon a rate of \$6.20 per square foot, per annum for improved, paved land as determined from the DOTA schedule of rates and charges established by appraisal of Airports property statewide).

SECURITY DEPOSIT:

Three (3) times the monthly rental in effect

DCCA VERIFICATION:

Place of business registration confirmed: YES X NO ___
Registered business name confirmed: YES X NO ___
Good standing confirmed: YES X NO ___

CHAPTER 343, HRS - ENVIRONMENTAL ASSESSMENT:

Pursuant to Section 11-200-8(a), Environmental Impact Statement Rules of the Department of Health, State of Hawai'i, this disposition is exempt from requirements regarding preparation of an environmental assessment, negative declaration, or environmental impact statement as required by Chapter 343, Hawai'i Revised Statutes, as amended, relating to Environmental Impact Statements, because the proposed action falls within Exemption Class #1, Comprehensive Exemption List for the State of Hawai'i, Department of Transportation, dated November 15, 2000, as approved by the Environmental Quality Council. Exemption Class #1 covers operations, repairs, or maintenance of existing structures, facilities, equipment, or topographical features involving negligible or no expansion or change of use beyond that previously existing.

The DOTA consulted with the U.S. Federal Aviation Administration as to the appropriateness of the citation of the Environmental Exemption Class from the Comprehensive list for the Department of Transportation dated November 15, 2000. The FAA concurred on the appropriateness.

REMARKS:

In accordance with Section 171-55, HRS, relating to Permits, the Department of Transportation proposes to issue a month-to-month revocable permit to Omni for passenger check in, office space and area for a rubbish dumpster as part of its Non-signatory Commercial Airline Carrier Operations at Daniel K. Inouye International Airport.

RECOMMENDATION:

That the Board authorize the Department of Transportation to issue a month-to-month revocable permit to Omni, subject to: (1) terms and conditions herein outlined, which are by reference incorporated herein; and (2) such additional terms and conditions as may be prescribed by the Director of Transportation to best serve the interests of the State.

Respectfully submitted,

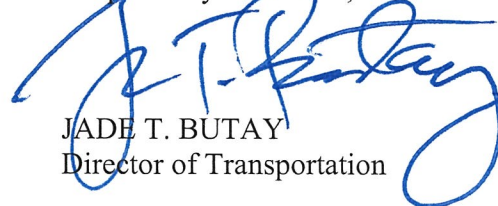

JADE T. BUTAY
Director of Transportation

APPROVED FOR SUBMITTAL:

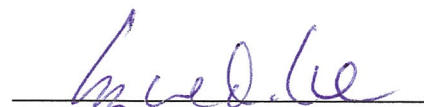

SUZANNE D. CASE
Chairperson and Member

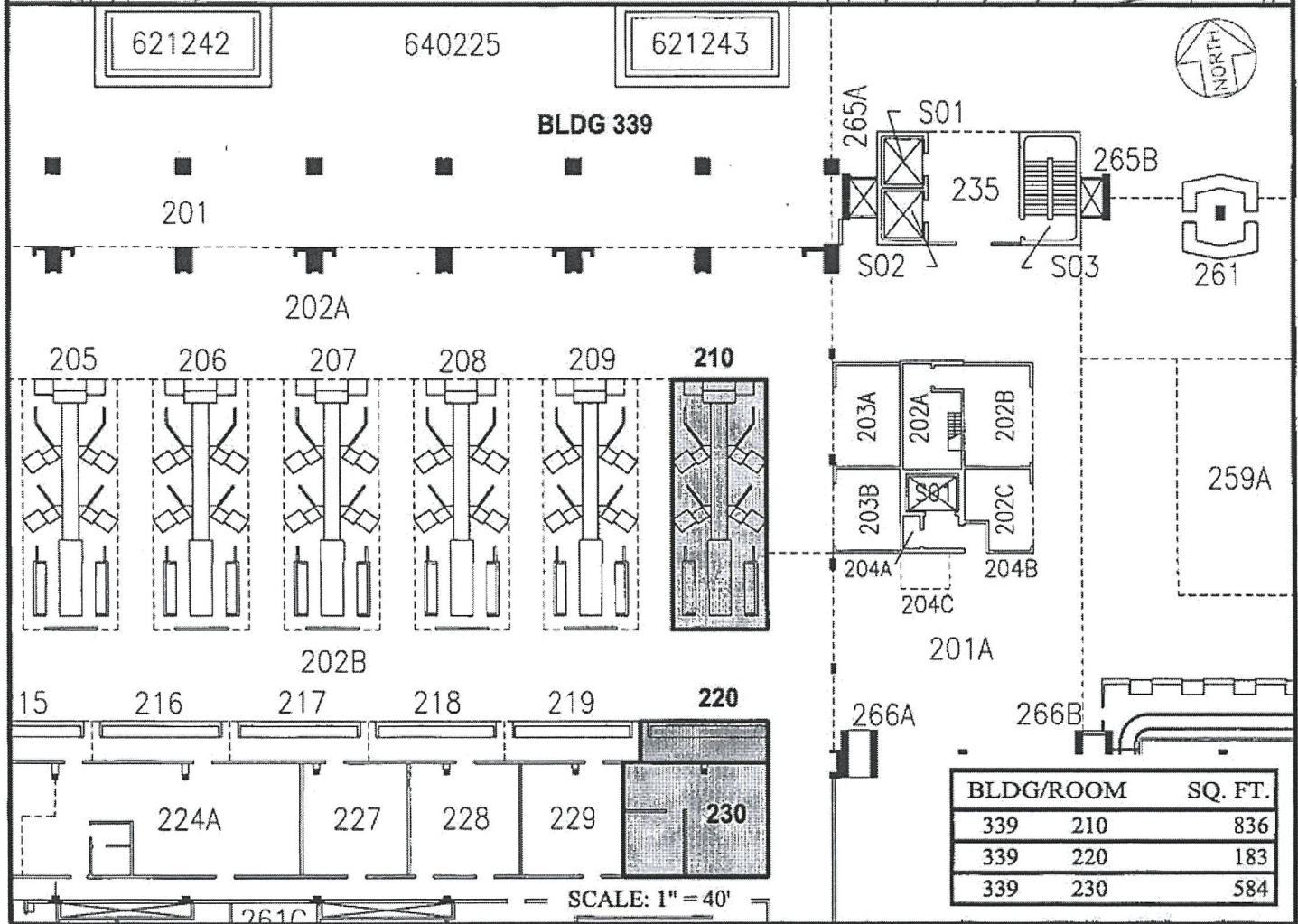
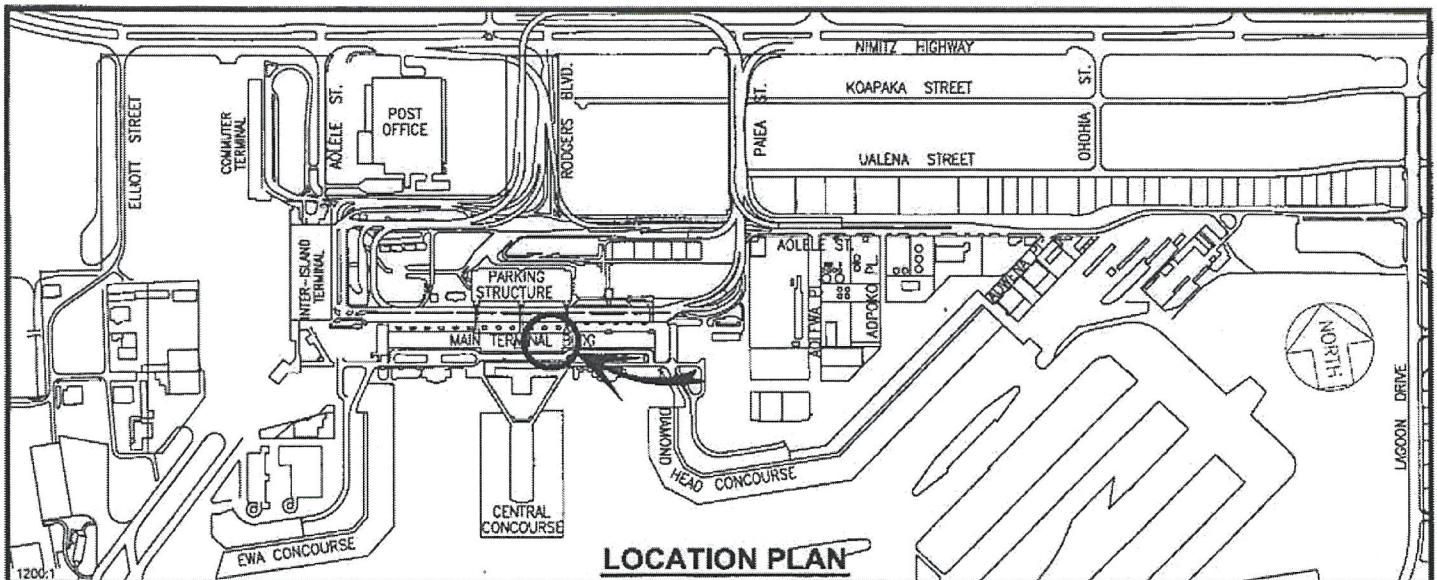

RP-8736 DATE : SEPTEMBER 2008 EXHIBIT: A

 Airports Division	OMNI AIR INTERNATIONAL, INC.	BUILDING 339	339210
		DIAMOND HEAD DOMESTIC	339220
		SECOND LEVEL	339230
			PLAT A2

HONOLULU INTERNATIONAL AIRPORT

N:\AIRPORTS\HNL_HONOLULU\CAD\PW\HNL_339210-01.DWG

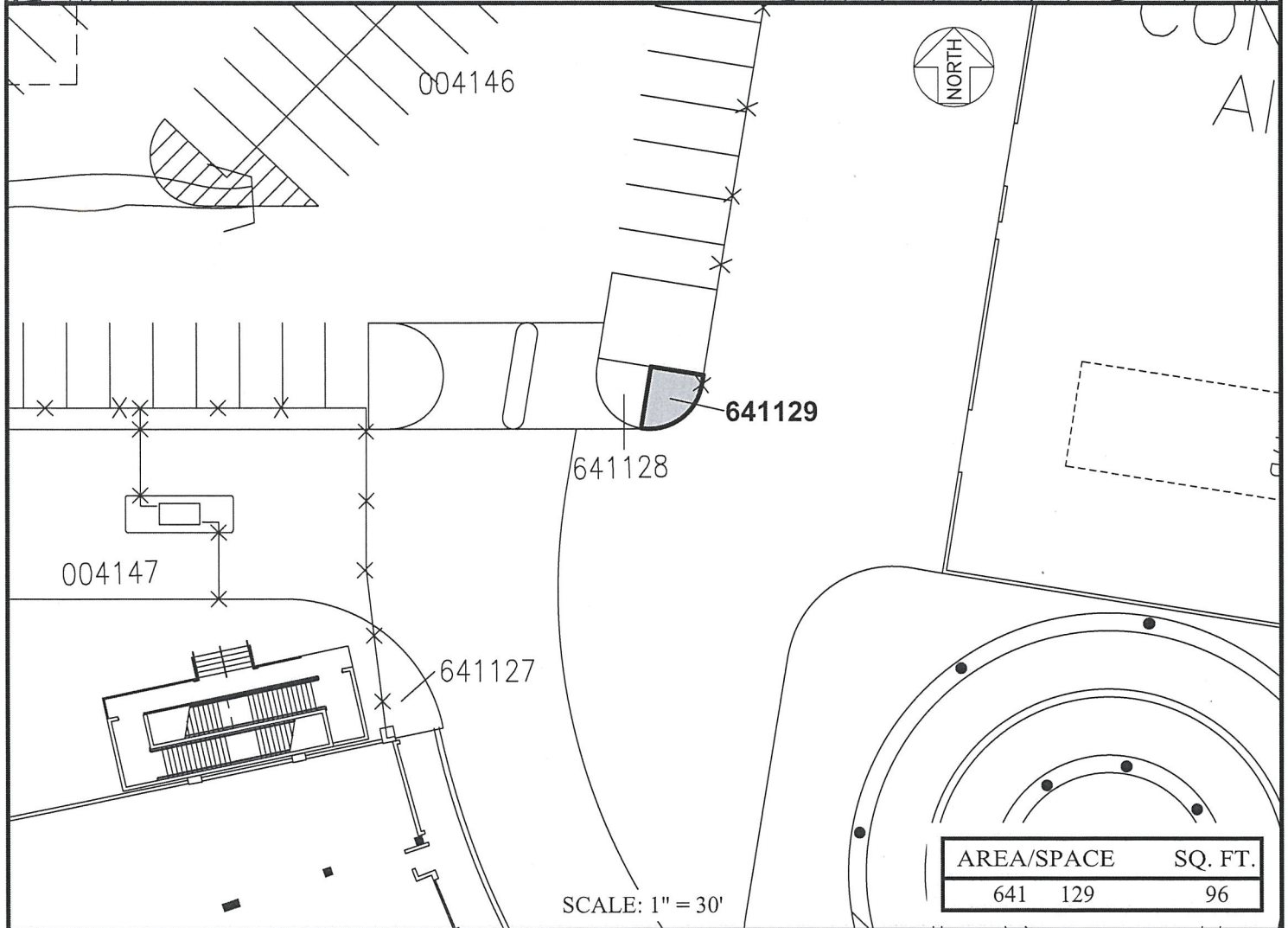
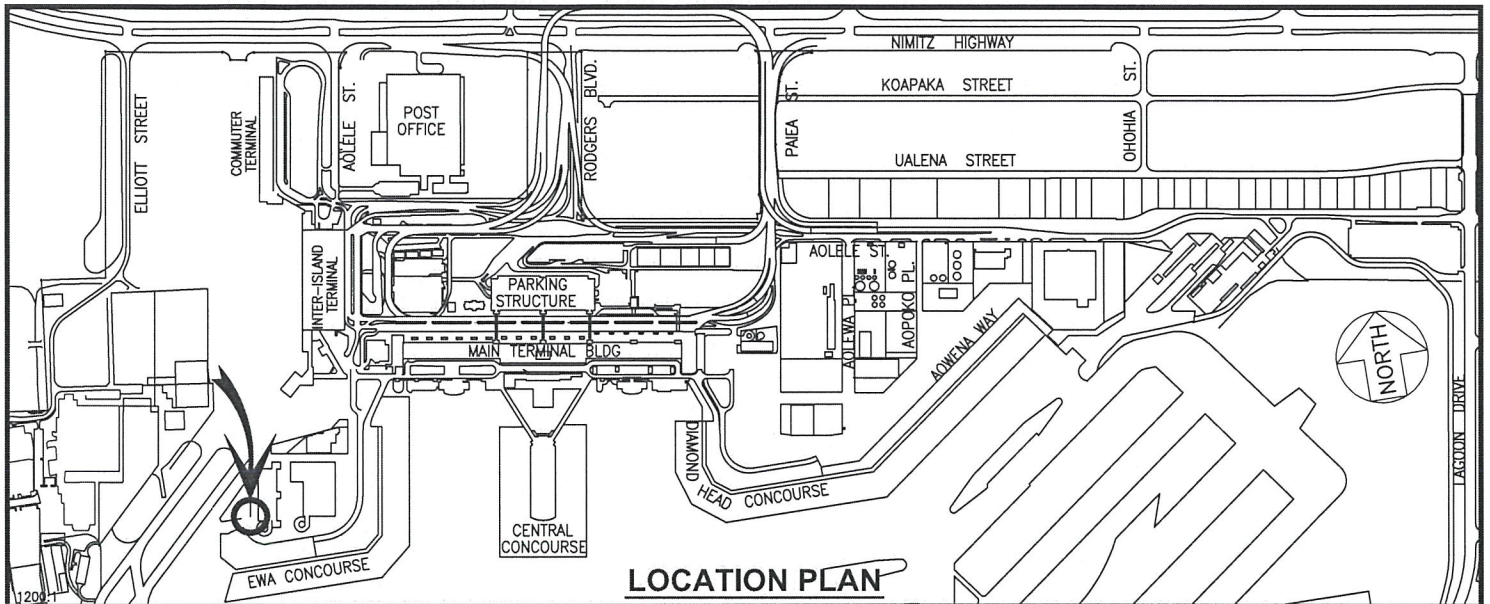

AREA/SPACE	SQ. FT.
641 129	96

RP-8736 DATE : SEPTEMBER 2018 EXHIBIT: **B**



OMNI AIR
INTERNATIONAL, LLC

AIRLINE CARGO
BUILDING AREA
GROUND LEVEL

641129

PLAT F1

DANIEL K. INOUE INTERNATIONAL AIRPORT

N:\AIRPORTS\HNL_HONOLULU\CAD\PM\HNL_641129-01.DWG