



STATE OF HAWAII
DEPARTMENT OF TRANSPORTATION
869 PUNCHBOWL STREET
HONOLULU, HAWAII 96813-5097

IN REPLY REFER TO:

Board of Land and
Natural Resources
State of Hawai'i
Honolulu, Hawai'i

ISSUANCE OF A REVOCABLE PERMIT FOR TERMINAL SERVICE COUNTER
AND OFFICE SPACE FOR GREETER'S STATION AND PASSENGER LOUNGE
HUALALAI INVESTORS, LLC
DBA FOUR SEASONS AT HISTORIC KA'UPULEHU
ELLISON ONIZUKA KONA INTERNATIONAL AIRPORT AT KEĀHOLE
TAX MAP KEY: (3) 7-3-43: PORTION OF 40 HAWAI'I

LEGAL REFERENCE:

Section 171-55, Hawai'i Revised Statutes.

APPLICANT:

Hualalai Investors, LLC (HILLC), whose business address is PO Box 1269,
Kailua-Kona, Hawai'i 96745.

LOCATION AND TAX MAP KEY:

Portion of Ellison Onizuka Kona International Airport at Keāhole (KOA), Kailua-Kona,
Island of Hawai'i, identified by Tax Map Key: 3rd Division, 7-3-43: Portion of 40.

AREA:

Spaces 307-109 and 307-110, containing areas of 74 and 190 square feet, respectively, as
shown on the attached Exhibit A.

ZONING:

State Land Use District: Urban & Conservation
County of Hawai'i: Industrial (MG-1a) and Open

BLNR – ISSUANCE OF A REVOCABLE PERMIT TO HUALALAI INVESTORS, LLC DBA
FOUR SEASONS AT HISTORIC KA‘UPULEHU FOR TERMINAL SERVICE COUNTER
AND OFFICE SPACE FOR GREETER’S STATION AND PASSENGER LOUNGE

Page 2

LAND TITLE STATUS:

Section 5(a) lands of the Hawai‘i Admission Act: Ceded
DHHL 30% entitlement lands pursuant to Hawai‘i Admission Act YES ___ NO X

CURRENT USE STATUS:

Airport and aeronautical purposes.

CHARACTER OF USE:

HILLC will use the spaces as a greeter’s station and passenger lounge.

COMMENCEMENT DATE:

Upon execution of the revocable permit.

MONTHLY RENTAL:

\$723.46 (as determined from the DOTA schedule of rates and charges established by appraisal of Airports property statewide).

SECURITY DEPOSIT:

\$2,170.38 or three times the monthly rental in effect.

HOLDOVER TENANCY:

\$24.12

DCCA VERIFICATION:

Place of business registration confirmed:	YES <u>X</u>	NO _____
Registered business name confirmed:	YES <u>X</u>	NO _____
Good standing confirmed:	YES <u>X</u>	NO _____

CHAPTER 343, HRS - ENVIRONMENTAL ASSESSMENT:

Pursuant to Section 11-200-8(a), Environmental Impact Statement Rules of the Department of Health, State of Hawai‘i, this disposition is exempt from requirements regarding preparation of an environmental assessment, negative declaration, or

BLNR – ISSUANCE OF A REVOCABLE PERMIT TO HUALALAI INVESTORS, LLC DBA
FOUR SEASONS AT HISTORIC KA‘UPULEHU FOR TERMINAL SERVICE COUNTER
AND OFFICE SPACE FOR GREETER’S STATION AND PASSENGER LOUNGE
Page 3

environmental impact statement as required by Chapter 343, Hawai‘i Revised Statutes, as amended, relating to Environmental Impact Statements, because the proposed action falls within Exemption Class #1, Comprehensive Exemption List for the State of Hawai‘i, Department of Transportation, dated November 15, 2000, as approved by the Environmental Quality Council. Exemption Class #1 covers operations, repairs, or maintenance of existing structures, facilities, equipment, or topographical features involving negligible or no expansion or change of use beyond that previously existing.

The DOTA consulted with the U.S. Federal Aviation Administration as to the appropriateness of the citation of the Environmental Exemption Class from the Comprehensive list for the Department of Transportation dated November 15, 2000. In this case, the FAA concurred on the appropriateness.

REMARKS:

In accordance with Section 171-55 HRS, relating to Permits, the Department of Transportation proposes to issue a month-to-month revocable permit to HILLC for greeter’s station operations at KOA.

RECOMMENDATION:

That the Board authorize the Department of Transportation to issue a month-to-month revocable permit to HILLC, subject to: (1) terms and conditions herein outlined, which are by reference incorporated herein; and (2) such additional terms and conditions as may be prescribed by the Director of Transportation to best serve the interests of the State.

Respectfully submitted,

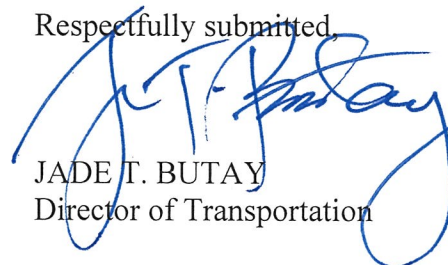

JADE T. BUTAY
Director of Transportation

APPROVED FOR SUBMITTAL:

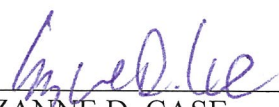

SUZANNE D. CASE
Chairperson and Member

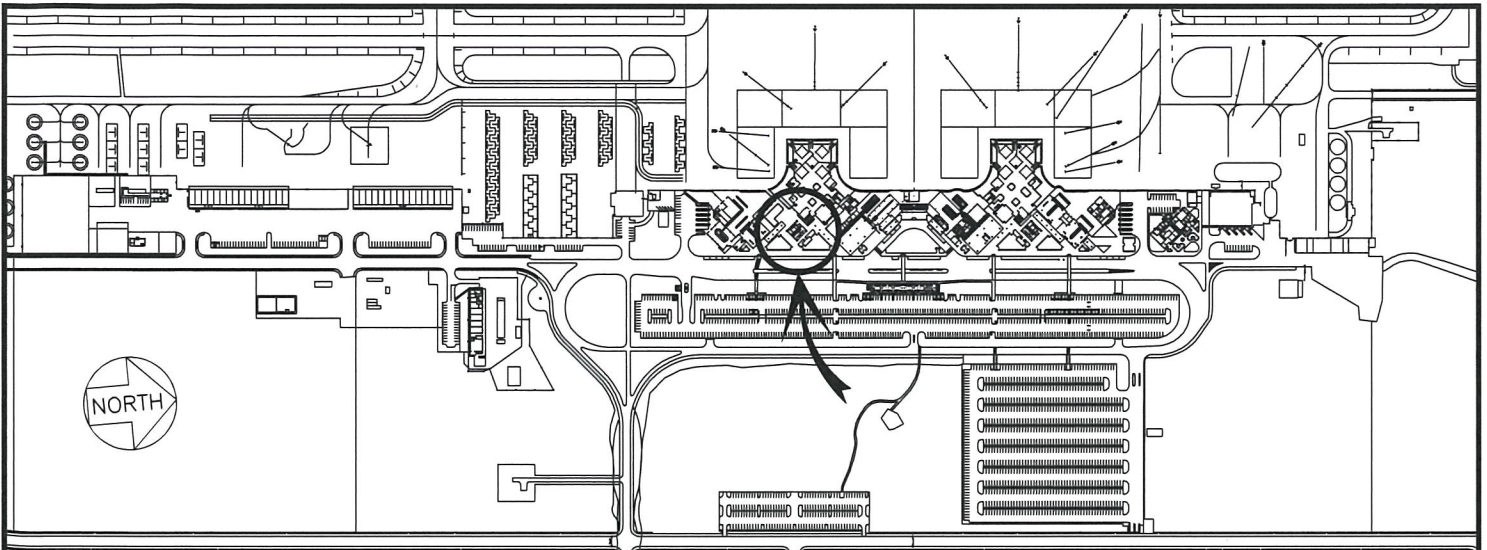

LOCATION PLAN

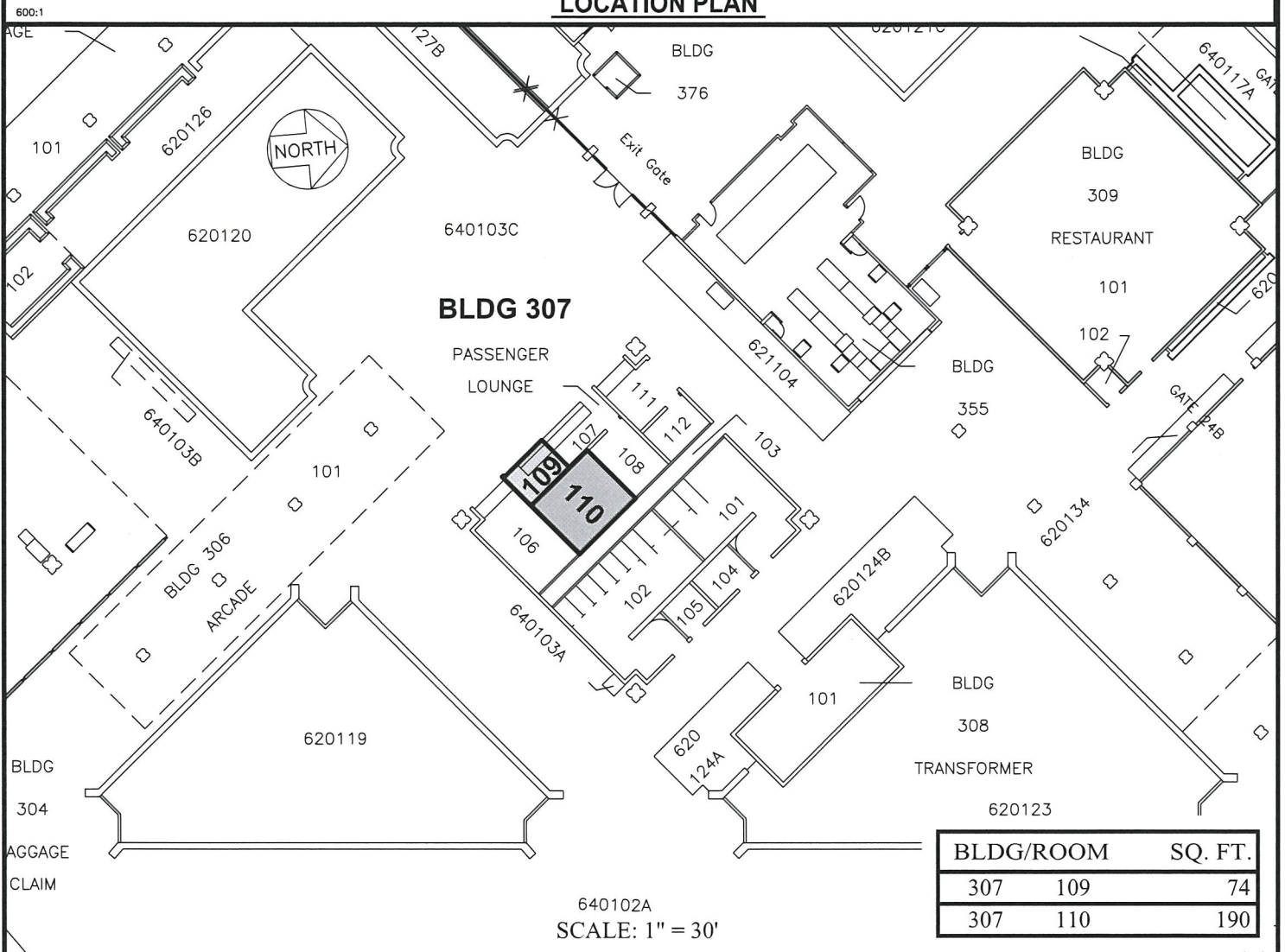

DATE : JULY 2018

EXHIBIT: **A**

DEPARTMENT OF TRANSPORTATION
STATE OF HAWAII
Airports Division

HUALALAI INVESTORS, LLC

BUILDING 307
PASSENGER LOUNGE
GROUND LEVEL

307109
307110
PLATS D1, 58