

STATE OF HAWAII
DEPARTMENT OF TRANSPORTATION
869 PUNCHBOWL STREET
HONOLULU, HAWAII 96813-5097

JADE T. BUTAY
DIRECTOR

Deputy Directors
LYNN A.S. ARAKI-REGAN
DEREK J. CHOW
ROSS M. HIGASHI
EDWIN H. SNIFFEN

IN REPLY REFER TO:

Board of Land and
Natural Resources
State of Hawai'i
Honolulu, Hawai'i

ISSUANCE OF A REVOCABLE PERMIT FOR
U.S. POSTAL MAIL SORTATION AND GROUND EQUIPMENT STORAGE
BRADLEY PACIFIC AVIATION, INC. DBA SIGNATURE FLIGHT SUPPORT
DANIEL K. INOUE INTERNATIONAL AIRPORT
TAX MAP KEY: (1) 1-1-72: 11 (PORTION) O'AHU

LEGAL REFERENCE:

Sections 171-55, Hawai'i Revised Statutes (HRS).

APPLICANT/LESSEE:

Bradley Pacific Aviation, Inc. dba Signature Flight Support (BPA), whose business address is 98 Kapalulu Place, Honolulu, Hawai'i 96819.

LOCATION AND TAX MAP KEY:

A portion of Daniel K. Inouye International Airport, Island of O'ahu, State of Hawai'i, identified by Tax Map Key: 1st Division, 1-1-72: 11 (Portion).

AREA:

Area/Space No. 009-107C, containing an area of approximately 24,000 square feet, as shown and delineated on the attached map labeled Exhibit A.

ZONING:

State Land Use District: Urban
City and County of Honolulu: I-2 (Industrial)

LAND TITLE STATUS:

Non-ceded - Section 5(a) lands of the Hawai'i Admission Act
DHHL 30% entitlement lands pursuant to Hawai'i Admission Act YES ☐ NO ☒

ITEM M-2

BLNR-ISSUANCE OF A REVOCABLE PERMIT FOR U.S. POSTAL MAIL SORTATION
AND THE STAGING OF GROUND EQUIPMENT TO BRADLEY PACIFIC AVIATION,
INC. DBA SIGNATURE FLIGHT SUPPORT

Page 2

CURRENT USE STATUS:

Land presently encumbered by Governor's Executive Order No. 3201, dated June 8, 1983, setting aside 3,152.177 acres designated as Daniel K. Inouye International Airport under the control and management of the State of Hawai'i, Department of Transportation, Airports Division for Airport Purposes.

CHARACTER OF USE:

BPA will use the space for U.S. postal mail sortation and the staging of ground equipment, in support of BPA's Fixed-Based Operations (FBO).

COMMENCEMENT DATE:

Upon execution of the revocable permit.

MONTHLY RENTAL:

\$12,400.00 per month (based upon a rate of \$6.20 per square foot per annum, for improved/paved land at the Airport, as determined from the Airports Division Schedule of Rates and Charges for Airport properties statewide).

SECURITY DEPOSIT:

Three (3) times the monthly rental in effect.

DCCA VERIFICATION:

Place of business registration confirmed:	YES <u>X</u>	NO <u> </u>
Registered business name confirmed:	YES <u>X</u>	NO <u> </u>
Good standing confirmed:	YES <u>X</u>	NO <u> </u>

CHAPTER 343, HRS - ENVIRONMENTAL ASSESSMENT:

Pursuant to Section 11-200-8(a), Environmental Impact Statement Rules of the Department of Health, State of Hawai'i, this disposition is exempt from requirements regarding preparation of an environmental assessment, negative declaration, or environmental impact statement as required by Chapter 343, Hawai'i Revised Statutes, as amended, relating to Environmental Impact Statements, because the proposed action falls within Exemption Class #1, Comprehensive Exemption List for the State of Hawai'i, Department of Transportation (DOT) dated November 15, 2000, as approved by the Environmental Quality Council. Exemption Class #1 covers operations, repairs, or

BLNR-ISSUANCE OF A REVOCABLE PERMIT FOR U.S. POSTAL MAIL SORTATION
AND THE STAGING OF GROUND EQUIPMENT TO BRADLEY PACIFIC AVIATION,
INC. DBA SIGNATURE FLIGHT SUPPORT

Page 3

maintenance of existing structures, facilities, equipment, or topographical features involving negligible or no expansion or change of use beyond that previously existing.

The Department of Transportation, Airports Division consulted with the U.S. Federal Aviation Administration (FAA) as to the appropriateness of the citation of the Environmental Exemption Class from the Comprehensive list for the DOT dated November 15, 2000. The FAA concurred on the appropriateness.

REMARKS:

In accordance with Sections 171-55, HRS, relating to Permits, the DOT proposes to issue a month-to-month revocable permit to BPA for U.S. postal mail sortation and the staging of ground equipment, in support of BPA's Fixed-Based Operations (FBO) at the Airport. DOT has no objections to BPA's request.

RECOMMENDATION:

That the Board authorize the DOT to issue a month-to-month revocable permit to BPA, subject to: (1) terms and conditions herein outlined, which are by reference incorporated herein; (2) such additional terms and conditions as may be prescribed by the Director of Transportation to best serve the interests of the State.

Respectfully submitted,

JADE T. BUTAY
Director of Transportation

APPROVED FOR SUBMITTAL:

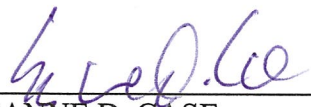
SUZANNE D. CASE
Chairperson and Member

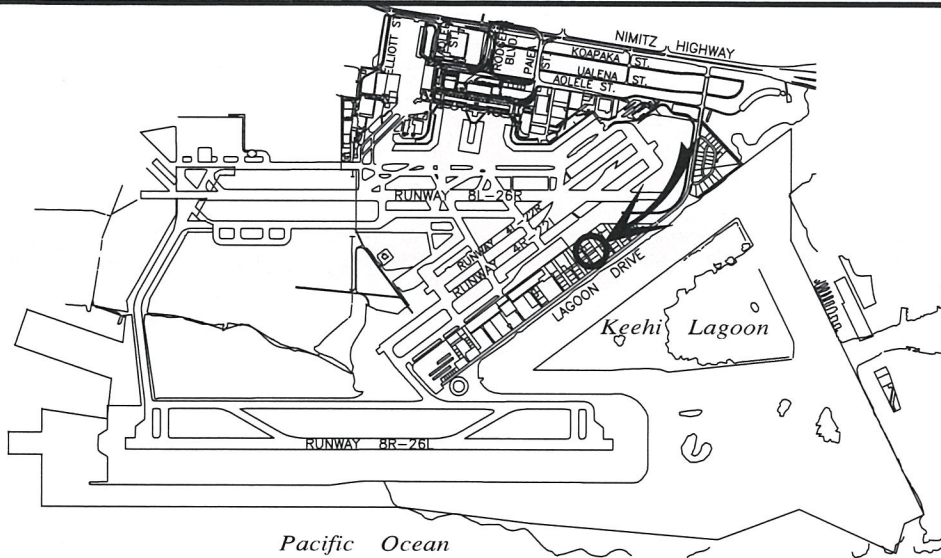

5000:1

LOCATION PLAN

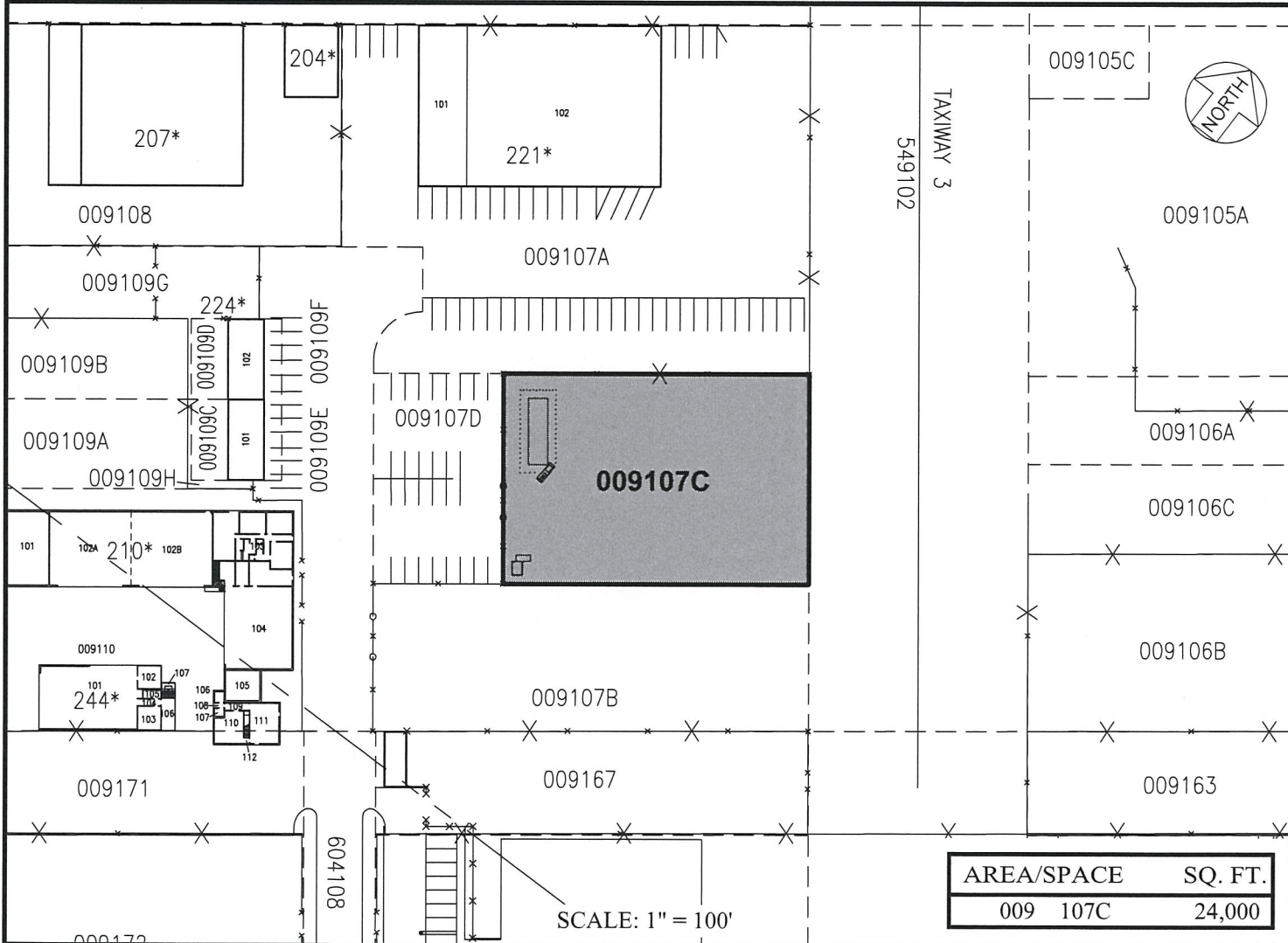

DATE : JANUARY

EXHIBIT: **A**



Airports Division

BRADLEY PACIFIC AVIATION, INC.
DBA
SIGNATURE FLIGHT SUPPORT

LOTS
SOUTH RAMP

009107C

PLAT 36

DANIEL K. INOUE INTERNATIONAL AIRPORT

N:\AIRPORTS\HNL_HONOLULU\CAD\PM\HNL_009107C-01.DWG