



STATE OF HAWAII
DEPARTMENT OF TRANSPORTATION
869 PUNCHBOWL STREET
HONOLULU, HAWAII 96813-5097

JADE T. BUTAY
DIRECTOR

Deputy Directors
ROSS M. HIGASHI
EDWIN H. SNIFFEN
DARRELL T. YOUNG

IN REPLY REFER TO:

Board of Land and
Natural Resources
State of Hawai'i
Honolulu, Hawai'i

ISSUANCE OF A REVOCABLE PERMIT FOR
CONSTRUCTION FIELD OFFICES
KIEWIT INFRASTRUCTURE WEST CO.
DANIEL K. INOUE INTERNATIONAL AIRPORT
TAX MAP KEY: (1) 1-1-003: 065 (PORTION)

O'AHU

APPLICANT:

Kiewit Infrastructure West Co. (Kiewit), whose mailing address is 707 Richards Street,
Suite 750, Honolulu, Hawai'i 96813.

LEGAL REFERENCE:

Section 171-55, Hawai'i Revised Statutes.

LOCATION:

Building No. 373, Diamond Head Concourse, Ground Level, Daniel K. Inouye
International Airport, Island of O'ahu, State of Hawai'i, identified by
Tax Map Key: 1st Division, 1-1-003: 065 (Portion).

AREA:

Building/Room No. 373-145, containing an area of approximately 190 square feet and
Building/Room No. 373-151B, containing an area of approximately 741 square feet;
as shown and delineated on the attached map labeled Exhibit "A".

ZONING:

State Land Use District: Urban
City and County of Honolulu LUO: Industrial (I-2)

BLNR – ISSUANCE OF A REVOCABLE PERMIT FOR
CONSTRUCTION FIELD OFFICES
KIEWIT INFRASTRUCTURE WEST CO.
Page 2

LAND TITLE STATUS:

Non-ceded - Section 5(a) lands of the Hawai'i Admission Act
DHHL 30% entitlement lands pursuant to Hawai'i Admission Act YES ____ NO X

CURRENT USE STATUS:

Land presently encumbered by Governor's Executive Order No. 3201, dated June 8, 1983, setting aside 3,152.177 acres designated as Daniel K. Inouye International Airport under the control and management of the State of Hawai'i, Department of Transportation, Airports Division (DOTA) for Airport Purposes.

CHARACTER OF USE:

Kiewit will use the spaces for construction field offices, at no charge, as specifically stated under Contract No. 67025, State Project No. AO1035-18, Diamond Head Apron Reconstruction Gates G1 to G6, Daniel K. Inouye International Airport.

COMMENCEMENT DATE:

To be determined by the Director of Transportation at a later date.

MONTHLY RENTAL:

Not applicable (NA)

SECURITY DEPOSIT:

NA

DCCA VERIFICATION:

Place of business registration confirmed:	YES <u>X</u>	NO ____
Registered business name confirmed:	YES <u>X</u>	NO ____
Good standing confirmed:	YES <u>X</u>	NO ____

CHAPTER 343, HRS - ENVIRONMENTAL ASSESSMENT:

Pursuant to Section 11-200-8(a), Environmental Impact Statement Rules of the Department of Health, State of Hawai'i, this disposition is exempt from requirements regarding preparation of an environmental assessment, negative declaration, or environmental impact statement as required by Chapter 343, Hawai'i Revised Statutes, as

BLNR – ISSUANCE OF A REVOCABLE PERMIT FOR
CONSTRUCTION FIELD OFFICES
KIEWIT INFRASTRUCTURE WEST CO.

Page 3

amended, relating to Environmental Impact Statements, because the proposed action falls within Exemption Class #1, Comprehensive Exemption List for the State of Hawai'i, Department of Transportation, dated November 15, 2000, as approved by the Environmental Quality Council. Exemption Class #1 covers operations, repairs, or maintenance of existing structures, facilities, equipment, or topographical features involving negligible or no expansion or change of use beyond that previously existing.

The DOTA consulted with the U.S. Federal Aviation Administration as to the appropriateness of the citation of the Environmental Exemption Class from the Comprehensive list for the Department of Transportation dated November 15, 2000. The FAA concurred on the appropriateness.

REMARKS:

The Department of Transportation proposes to issue a permit to Kiewit for the use of the spaces for construction field offices, at no charge, as specifically stated under Contract No. 67025, State Project No. AO1035-18, Diamond Head Apron Reconstruction Gates G1 to G6 at Daniel K. Inouye International Airport, Section 1.04, Provisions for Field Office/Storage Space: "Pending the availability of space on airport property, the State will issue a permit to the Contractor for the use of the space, at no charge, to be used specifically for a field office and/or storage of materials and equipment...."

RECOMMENDATION:

That the Board authorize the Department of Transportation to issue a month-to-month revocable permit to Kiewit, subject to: (1) terms and conditions herein outlined, which are by reference incorporated herein; and (2) such additional terms and conditions as may be prescribed by the Director of Transportation to best serve the interests of the State.

Respectfully submitted,

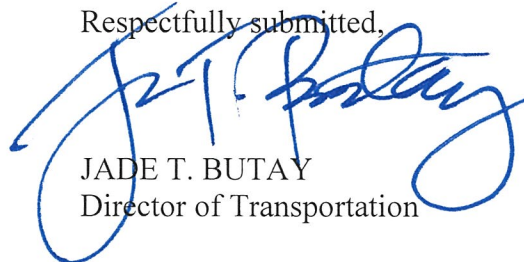

JADE T. BUTAY
Director of Transportation

APPROVED FOR SUBMITTAL:

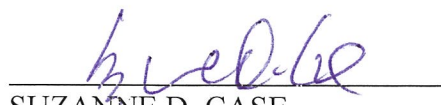

SUZANNE D. CASE
Chairperson and Member

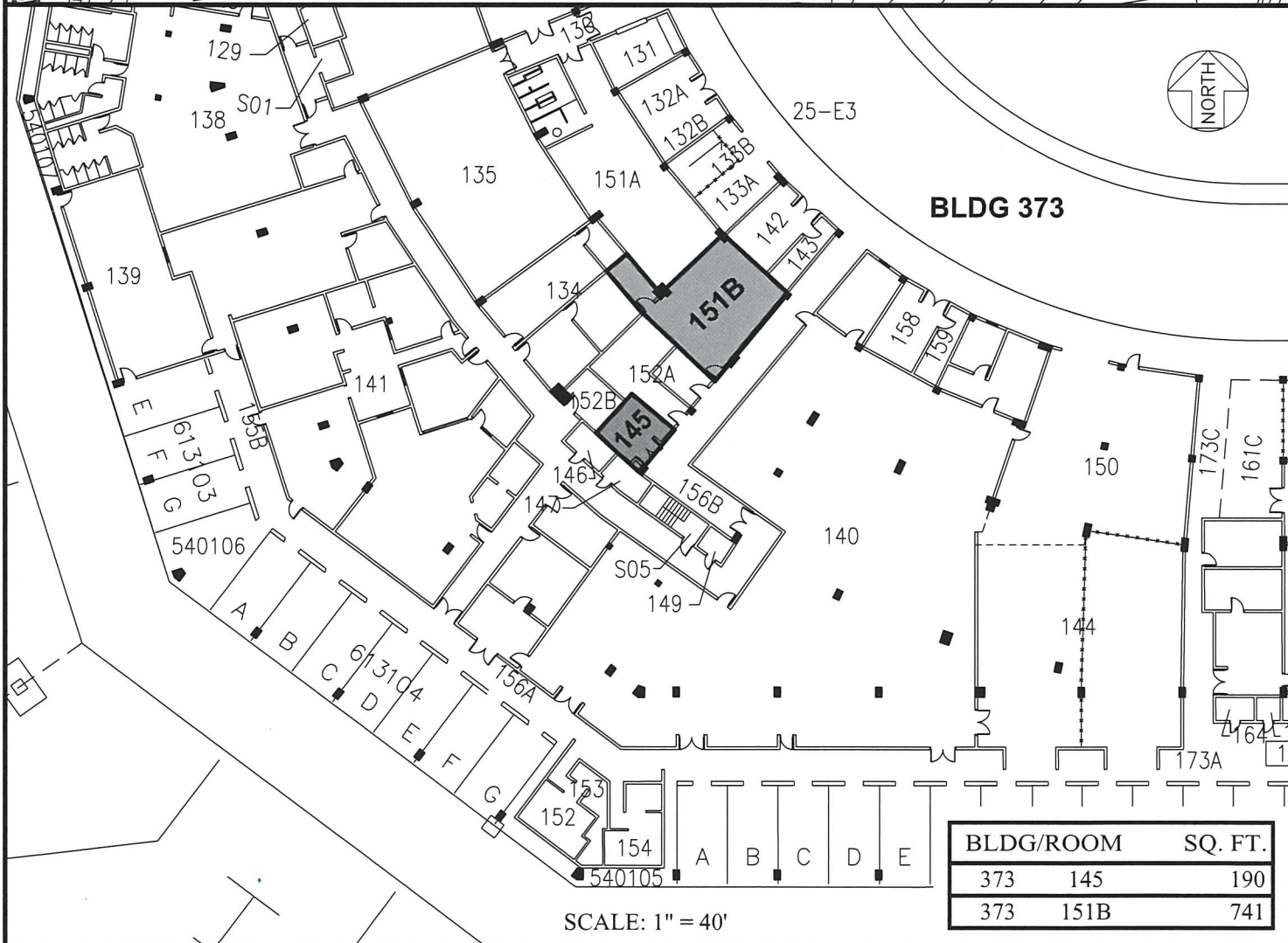
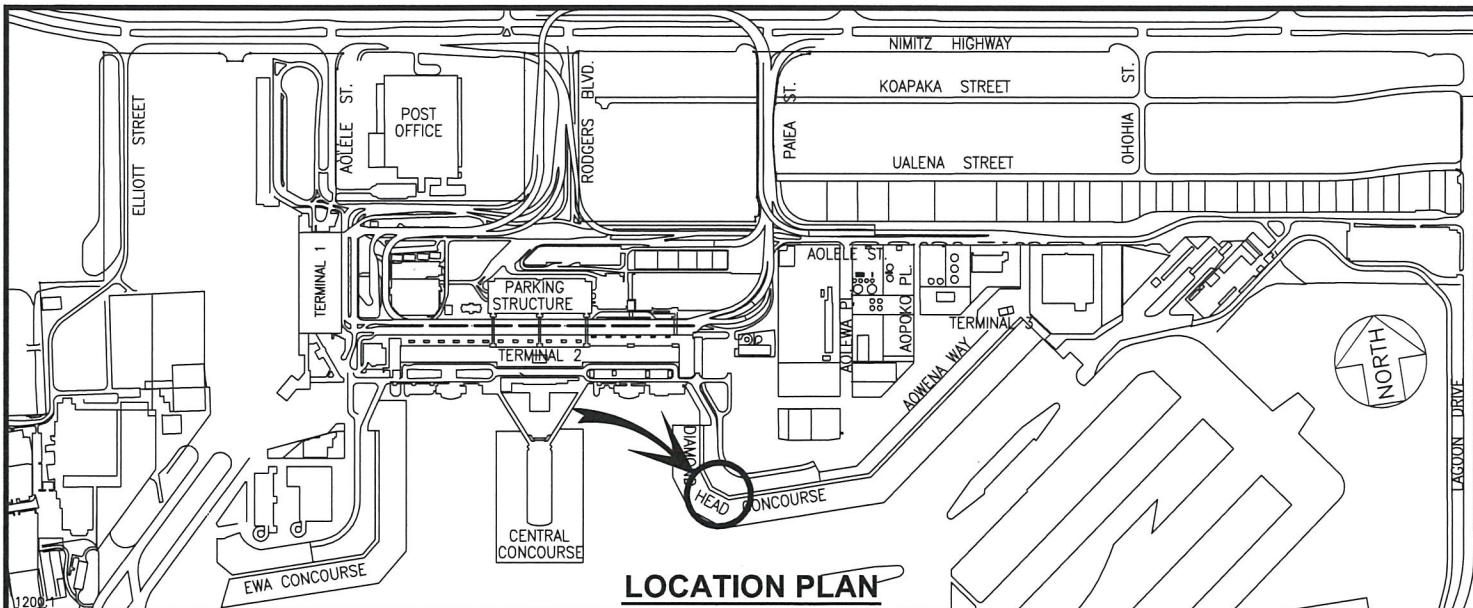

RP-8823

DATE : DECEMBER 2018

EXHIBIT: **A**



KIEWIT
INFRASTRUCTURE
WEST CO.

BUILDING 373
DIAMOND HEAD CONCOURSE
GROUND LEVEL

373145
373151B
PLAT M1

DANIEL K. INOUE INTERNATIONAL AIRPORT

N:\AIRPORTS\HNL\HONOLULU\CAD\PM\EXHIBIT_2018\HNL_373145-02.DWG