

STATE OF HAWAII
DEPARTMENT OF TRANSPORTATION
869 PUNCHBOWL STREET
HONOLULU, HAWAII 96813-5097

Board of Land and
Natural Resources
State of Hawai'i
Honolulu, Hawai'i

ISSUANCE OF A REVOCABLE PERMIT FOR
A CONSTRUCTION STAGING AREA FOR EQUIPMENT AND MATERIALS
NAN, INC.

DANIEL K. INOUE INTERNATIONAL AIRPORT
TAX MAP KEY: (1) 1-1-003: 021 (PORTION)

O'AHU

APPLICANT:

Nan, Inc. (NAN), a Hawai'i corporation, authorized to do business in the State of Hawai'i, whose mailing address is 636 Laumaka Street, Honolulu, Hawai'i 96819.

LEGAL REFERENCE:

Section 171-55, Hawai'i Revised Statutes (HRS).

LOCATION:

A portion of Daniel K. Inouye International Airport, Island of O'ahu, State of Hawai'i, identified by Tax Map Key: 1st Division, 1-1-003: 021 (Portion).

AREA:

Area/Space No. 616-109, containing an area of approximately 30,914 square feet, as shown and delineated on the attached map labeled Exhibit "A".

ZONING:

State Land Use District: Urban
City and County of Honolulu LUO: Industrial (I-2)

LAND TITLE STATUS:

Non-ceded - Section 5(a) lands of the Hawai'i Admission Act
DHHL 30% entitlement lands pursuant to Hawai'i Admission Act YES ___ NO X

BLNR – ISSUANCE OF A REVOCABLE PERMIT FOR
A CONSTRUCTION STAGING AREA FOR EQUIPMENT AND MATERIALS
NAN, INC.
Page 2

CURRENT USE STATUS:

Land presently encumbered by Governor’s Executive Order No. 3201, dated June 8, 1983, setting aside 3,152.177 acres designated as Daniel K. Inouye International Airport under the control and management of the State of Hawai‘i, Department of Transportation, Airports Division (DOTA) for Airport Purposes.

CHARACTER OF USE:

NAN will use the space as a construction staging area for equipment and materials, as part of Contract No. 67013, State Project No. AO1114-18, Replacement of Parking Structure Pedestrian Bridges at Daniel K. Inouye International Airport.

COMMENCEMENT DATE:

To be determined by the Director of Transportation at a later date.

MONTHLY RENTAL:

Not applicable (NA)

SECURITY DEPOSIT:

NA

DCCA VERIFICATION:

| | | |
|---|--------------|----------|
| Place of business registration confirmed: | YES <u>X</u> | NO _____ |
| Registered business name confirmed: | YES <u>X</u> | NO _____ |
| Good standing confirmed: | YES <u>X</u> | NO _____ |

CHAPTER 343, HRS - ENVIRONMENTAL ASSESSMENT:

Pursuant to Section 11-200-8(a), Environmental Impact Statement Rules of the Department of Health, State of Hawai‘i, this disposition is exempt from requirements regarding preparation of an environmental assessment, negative declaration, or environmental impact statement as required by Chapter 343, Hawai‘i Revised Statutes, as amended, relating to Environmental Impact Statements, because the proposed action falls within Exemption Class #1, Comprehensive Exemption List for the State of Hawai‘i, Department of Transportation, dated November 15, 2000, as approved by the Environmental Quality Council. Exemption Class #1 covers operations, repairs, or maintenance of existing structures, facilities, equipment, or topographical features involving negligible or no expansion or change of use beyond that previously existing.

The DOTA consulted with the U.S. Federal Aviation Administration as to the appropriateness of the citation of the Environmental Exemption Class from the Comprehensive list for the Department of Transportation dated November 15, 2000. The FAA concurred on the appropriateness.

REMARKS:

In accordance with Section 171-55, HRS, relating to Permits, the DOTA proposes to issue a permit to NAN for the use of the space for a construction staging area for equipment and materials, at no charge, as specifically stated under Contract No. 67013, State Project No. AO1114-18, Replacement of Parking Structure Pedestrian Bridges, Section 1.08, Provisions for Field Office/Storage Space: “Pending the availability of space on airport property, the State will issue a permit to the Contractor for the use of the space, at no charge, to be used specifically for a field office and/or storage of materials and equipment....”

RECOMMENDATION:

That the Board authorize the Department of Transportation to issue a month-to-month revocable permit to NAN, subject to: (1) terms and conditions herein outlined, which are by reference incorporated herein; and (2) such additional terms and conditions as may be prescribed by the Director of Transportation to best serve the interests of the State.

Respectfully submitted,

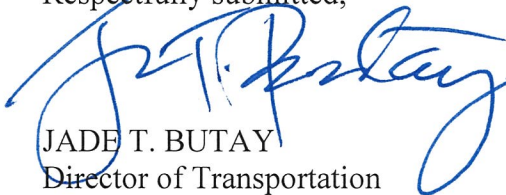
JADE T. BUTAY
Director of Transportation

APPROVED FOR SUBMITTAL:

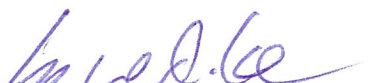
SUZANNE D. CASE
Chairperson and Member

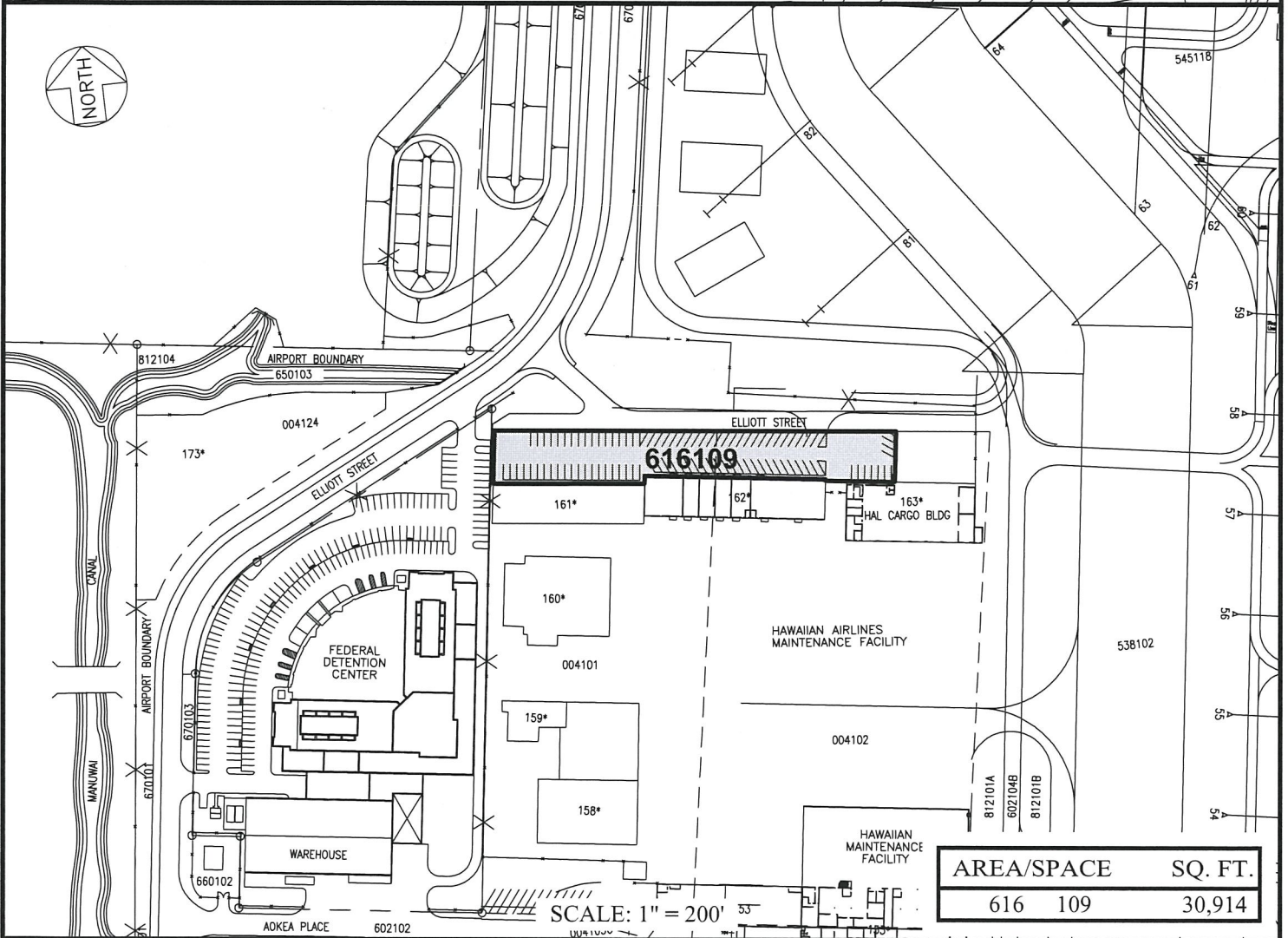
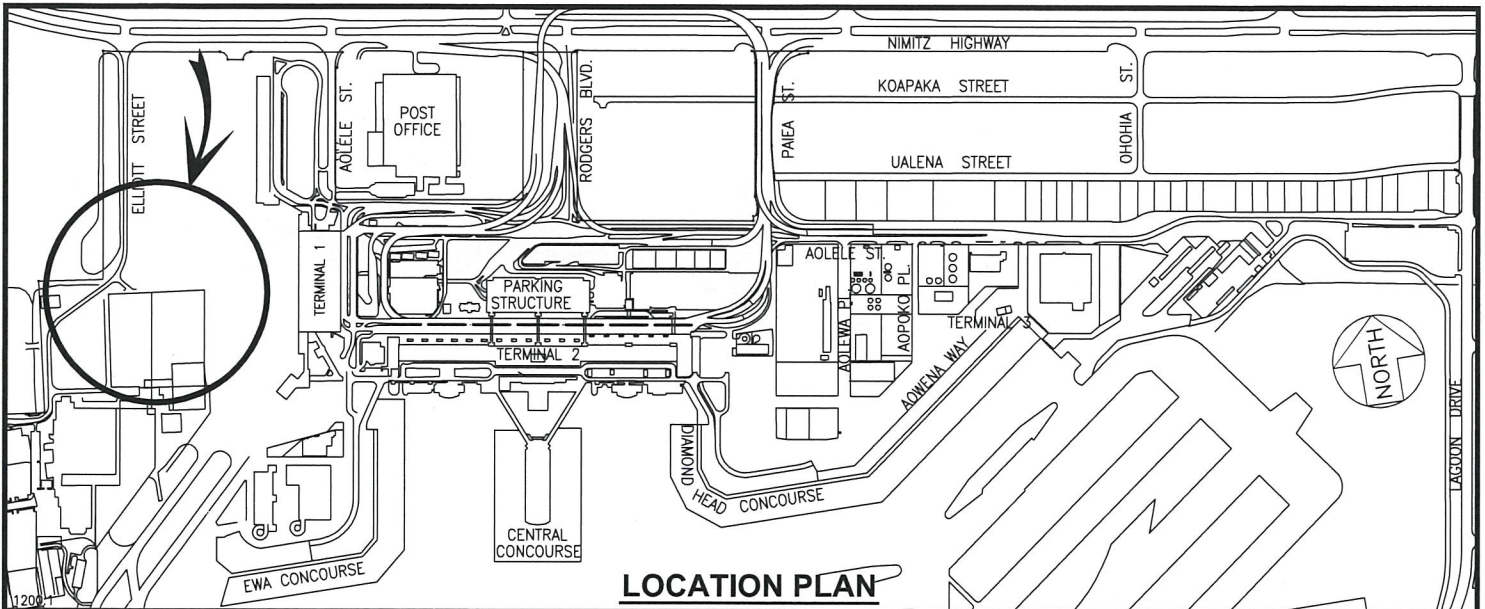

| AREA/SPACE | SQ. FT. |
|------------|---------|
| 616 109 | 30,914 |

DATE : NOVEMBER 2018

EXHIBIT: **A**



NAN, INC.

PARKING
INTER-ISLAND
MAINTENANCE

616109
PLAT 14