

State of Hawai'i  
DEPARTMENT OF LAND AND NATURAL RESOURCES  
Division of State Parks  
Honolulu, Hawai'i 96813

April 26, 2018

Board of Land and Natural Resources  
State of Hawai'i  
Honolulu, Hawai'i

Kaua'i

REQUESTING APPROVAL FOR THE ISSUANCE OF A REVOCABLE PERMIT THAT  
WIL BE NEGOTIATED AND EXECUTED BY CHAIRPERSON FOR THE COLLECTION  
OF PARKING AND ENTRY FEES AT HĀ'ENA STATE PARK, KAUA'I, HAWAI'I, TAX  
MAP KEY (4)-1-4-001:007 PORTION

Declare Project Exempt from Requirements of Chapter 343, HRS And Title 11, Chapter 200,  
Hawaii Administrative Rules.

APPLICANT:

Republic Parking, an impark company

LEGAL REFERENCE:

Hawai'i Revised Statutes § 171-13 and 55 as amended.

LOCATION:

Portion of Government Lands of Hā'ena State Park, Kaua'i, Hawai'i, identified by Tax  
Map Key: (4)-1-4-001:007 (por.), as shown on the map attached as EXHIBIT A.

AREA:

An approximate two-acre portion of 50 acres, more or less

ZONING:

State Land Use District: Conservation  
County of Kauai CZO: P-1

TRUST LAND STATUS:

Section 5(a) lands of the Hawai'i Admission Act  
DHHL 30% entitlement lands pursuant to Hawai'i State Constitution: NO

**CURRENT USE STATUS:**

Encumbered by Governor's Executive Order 3391, effective September 13, 1988, setting aside land for state park purposes to be under the control and management of the State of Hawai'i, Department of Land and Natural Resources, Division of State Parks.

**CHARACTER OF USE:**

The collection of parking and entry fees.

**CHAPTER 343 ENVIRONMENTAL ASSESSMENT:**

The Division of State Parks (DSP) believes that this project will have minimal or no significant effect on the environment and is therefore exempt from the preparation of an environmental assessment under Chapter 343, Hawai'i Revised Statutes (HRS) and §11-200-8 (a) (1), Hawai'i Administrative Rules (HAR) and within exemption Class 1, of the State Parks Exemption List which exempts operations involving negligible or no expansion or change of use beyond that previously existing within park boundaries [February 5, 1976].

**DCCA VERIFICATION:**

Place of business registration confirmed:	YES
Registered business name confirmed:	YES
Applicant in good standing confirmed:	YES

**REMARKS:**

Hā'ena, a storied place at the far northwestern corner of Kaua'i's beautiful North Shore, is also home to one of the State of Hawai'i's busiest parks, Hā'ena State Park. Torrential rains in April of 2018 and the subsequent flooding caused significant damage to its infrastructure. However, the closure of the park provided an opportunity to implement a number of improvements and management recommendations proposed in the Hā'ena State Park Master Plan on May 25, 2018 and the Final Environmental Impact Statement (FEIS) published July 8, 2018.

In order to achieve a Master Plan goal of establishing visitor limits and reducing vehicle traffic at the park and surround area, DSP seeks to enact parking fees and an advanced reservation system for entry. DSP will also work with a County of Kaua'i sponsored shuttle service to further mitigate impacts on resources while enhancing the overall experience for park visitors and the North Shore Kaua'i community.

The applicant has not had a lease, permit, easement or other disposition of State lands terminated within the last five years due to non-compliance with such terms and conditions and therefore, DSP recommends approval for the issuance of a revocable permit for the collection of parking and entry fees and further recommends the Board delegate to the Chairperson the authority of negotiate any other specific terms necessary to effectuate the revocable permit.

RECOMMENDATION:

1. It is recommended that the Board find that this action will probably have minimal or no significant effect on the environment and is presumed to be exempt from the preparation of an environmental assessment.

Declare Project Exempt from Requirements of Chapter 343, HRS And Title 11, Chapter 200, Hawaii Administrative Rules.

2. Authorize the issuance of the revocable permit pursuant to the terms above which, by this reference, are incorporated herein, on a month-to-month basis and for a one-year period effective upon execution of both parties.
3. Approve such other terms conditions as may be prescribed by the Chairperson to best serve the interest of the State of Hawai'i.

Respectfully submitted,



For CURT A. COTTRELL  
Administrator  
Division of State Parks

APPROVED FOR SUBMITTAL:

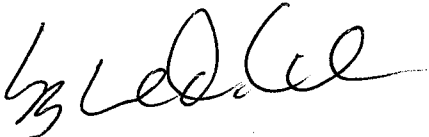

SUZANNE D. CASE  
Chairperson  
Board of Land and Natural Resources

ATTACHMENTS:

Exhibit A: Site Layout Plan

Exhibit B: Exemption Notification

# Exhibit A

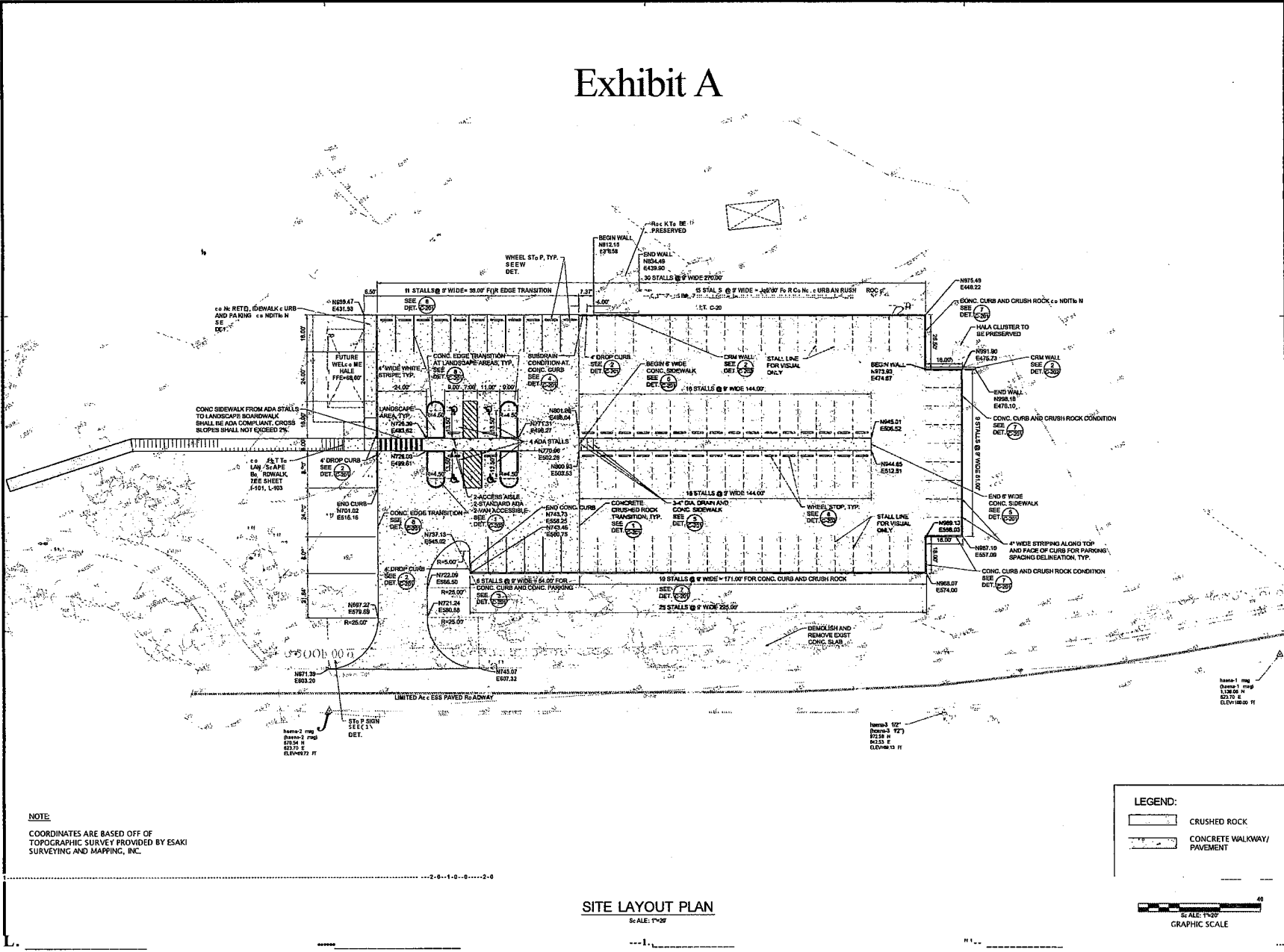

**SAM O. HROTA, INC.**  
 ENGINEERS & SURVEYORS  
 585 St. Andrew Street  
 Honolulu, Hawaii 96813  
 Tel: (808) 525-0911  
 Fax: (808) 524-6111



**REVISIONS:**

No.	DATE	INT.

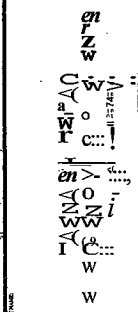

**SITE LAYOUT PLAN**

**LEGEND:**

- CRUSHED ROCK
- CONCRETE WALKWAY/PAVEMENT

SCALE: 1"=20'  
 GRAPHIC SCALE



**NOTE:**  
 COORDINATES ARE BASED OFF OF TOPOGRAPHIC SURVEY PROVIDED BY ESAKI SURVEYING AND MAPPING, INC.

**SITE LAYOUT PLAN**  
 SCALE: 1"=20'

DAVID Y. IGE  
GOVERNOR OF HAWAII

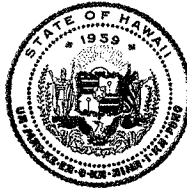
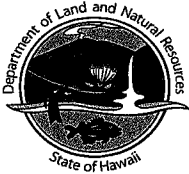

SUZANNE D. CASE  
CHAIRPERSON  
BOARD OF LAND AND NATURAL RESOURCES  
COMMISSION ON WATER RESOURCE MANAGEMENT

ROBERT K. MASUDA  
FIRST DEPUTY

DEAN D. UYENO  
ACTING DEPUTY DIRECTOR - WATER

STATE OF HAWAII  
DEPARTMENT OF LAND AND NATURAL RESOURCES

POST OFFICE BOX 621  
HONOLULU, HAWAII 96809

AQUATIC RESOURCES  
BOATING AND OCEAN RECREATION  
BUREAU OF CONVEYANCES  
COMMISSION ON WATER RESOURCE MANAGEMENT  
CONSERVATION AND COASTAL LANDS  
CONSERVATION AND RESOURCES ENFORCEMENT  
ENGINEERING  
FORESTRY AND WILDLIFE  
HISTORIC PRESERVATION  
KAHOOLAWE ISLAND RESERVE COMMISSION  
LAND  
STATE PARKS

EXEMPTION NOTIFICATION

Regarding the preparation of an environmental assessment pursuant to Chapter 343, HRS and Chapter 11-200, HAR.

Project Title: REQUESTING APPROVAL FOR THE ISSUANCE OF A REVOCABLE PERMIT THAT WILL BE NEGOTIATED AND EXECUTED BY CHAIRPERSON FOR THE COLLECTION OF PARKING AND ENTRY FEES AT HĀ'ENA STATE PARK, KAUA'I, HAWAII

Project / Reference No.: N/A

Project Location: Kaua'i

Project Description: COLLECTION OF PARKING AND ENTRY FEES

Chap. 343 Trigger(s): Use of State Land

Exemption Class No.: In accordance with Hawaii Administrative Rule Section 11-200-8(a)(1), the subject request is exempt from the preparation of an environmental assessment pursuant to Exemption Class No. 1 which exempts, "**Operations, repairs, or maintenance of existing structures, facilities, equipment, or topographical features, involving negligible or no expansion or change of use beyond that previously existing**".

Each of the revocable permits listed in the submittal are for existing uses previously authorized by the Board.

Consulted Parties: DLNR - Division of Forestry and Wildlife

Recommendation: It is recommended that the Board find that this action will probably have minimal or no significant effect on the environment and is presumed to be exempt from the preparation of an environmental assessment.

EXHIBIT B