

DAVID Y. IGE  
GOVERNOR

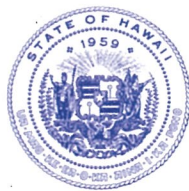

**STATE OF HAWAII**  
**DEPARTMENT OF TRANSPORTATION**  
869 PUNCHBOWL STREET  
HONOLULU, HAWAII 96813-5097

JADE T. BUTAY  
DIRECTOR

Deputy Directors  
LYNN A.S. ARAKI-REGAN  
DEREK J. CHOW  
ROSS M. HIGASHI  
EDWIN H. SNIFFEN

IN REPLY REFER TO:

Board of Land and  
Natural Resources  
State of Hawai'i  
Honolulu, Hawai'i

ISSUANCE OF A REVOCABLE PERMIT FOR STORAGE SPACE  
IN THE MAIN TERMINAL  
HAWAIIAN AIRLINES, INC.  
MOLOKAI AIRPORT  
TAX MAP KEY: (2) 5-2-04: PORTION OF 8

MOLOKAI

LEGAL REFERENCE:

Subsection 171-11 and 171-55, Hawai'i Revised Statutes.

APPLICANT:

Hawaiian Airlines Inc. ("HAL") whose business address is P.O. Box 30008,  
Honolulu, Hawai'i 96819

LOCATION AND TAX MAP KEY:

Portion of Molokai Airport (MKK), Hoolehua, Island of Molokai, identified by  
Tax Map Key: 2<sup>nd</sup> Division, 5-2-04: Portion of 8.

AREA:

Building/Room No. 301-109A, containing an area of approximately 191 square feet; and  
Building/Room No. 301-109B, containing an area of approximately 273 square feet,  
respectively as shown and delineated on the attached map labeled Exhibit "A".

ZONING:

State Land Use: Agricultural  
County: Interim Zoning Provisions of the Maui County Zoning Code

**ITEM M-10**

BLNR- ISSUANCE OF A REVOCABLE PERMIT FOR STORAGE SPACE  
IN THE MAIN TERMINAL, HAWAIIAN AIRLINES, INC.

Page 2

LAND TITLE STATUS:

Section 5(b), Hawai'i Admissions Act - Ceded  
DHHL, 30% entitlement lands Yes \_\_\_\_\_ No X

CURRENT USE STATUS:

Aeronautical purposes.

CHARACTER OF USE:

Storage space to support airline operations.

COMMENCEMENT DATE:

Upon complete execution of the revocable permit.

MONTHLY RENTAL:

\$1,086.19

SECURITY DEPOSIT:

\$3,258.57

DCCA VERIFICATION:

Place of business registration confirmed:	YES <u>X</u>	NO _____
Registered business name confirmed:	YES <u>X</u>	NO _____
Good standing confirmed:	YES <u>X</u>	NO _____

CHAPTER 343, HRS - ENVIRONMENTAL ASSESSMENT:

Pursuant to Section 11-200-8(a), Environmental Impact Statement Rules of the Department of Health, State of Hawai'i, this disposition is exempt from requirements regarding preparation of an environmental assessment, negative declaration, or environmental impact statement as required by Chapter 343, Hawai'i Revised Statutes, as amended, relating to Environmental Impact Statements, because the proposed action falls within Exemption Class #1, Comprehensive Exemption List for the State of Hawai'i, Department of Transportation, dated November 15, 2000, as approved by the Environmental Quality Council. Exemption Class #1 covers operations, repairs, or maintenance of existing structures, facilities, equipment, or topographical features involving negligible or no expansion or change of use beyond that previously existing.

BLNR- ISSUANCE OF A REVOCABLE PERMIT FOR STORAGE SPACE  
IN THE MAIN TERMINAL, HAWAIIAN AIRLINES, INC.

Page 3

The DOTA consulted with the U.S. Federal Aviation Administration as to the appropriateness of the citation of the Environmental Exemption Class from the Comprehensive list for the Department of Transportation dated November 15, 2000. In this case, the FAA concurred on the appropriateness.

REMARKS:

The DOT has no objections to HAL's request and therefore, in accordance with Sections 171-11 and 171-55, HRS, relating to Public Purposes and Permits respectively, the DOT proposes to issue a month-to-month revocable permit to HAL.

RECOMMENDATION:

That the Board authorizes the Department of Transportation to issue a revocable permit to HAL, subject to: (1) terms and conditions herein outlined, which are by reference incorporated herein; (2) such other terms and conditions as may be prescribed by the Director of Transportation to best serve the interests of the State

Respectfully submitted,



JADE T. BUTAY  
Director of Transportation

APPROVED FOR SUBMITTAL:

  
\_\_\_\_\_  
SUZANNE D. CASE  
Chairperson & Member



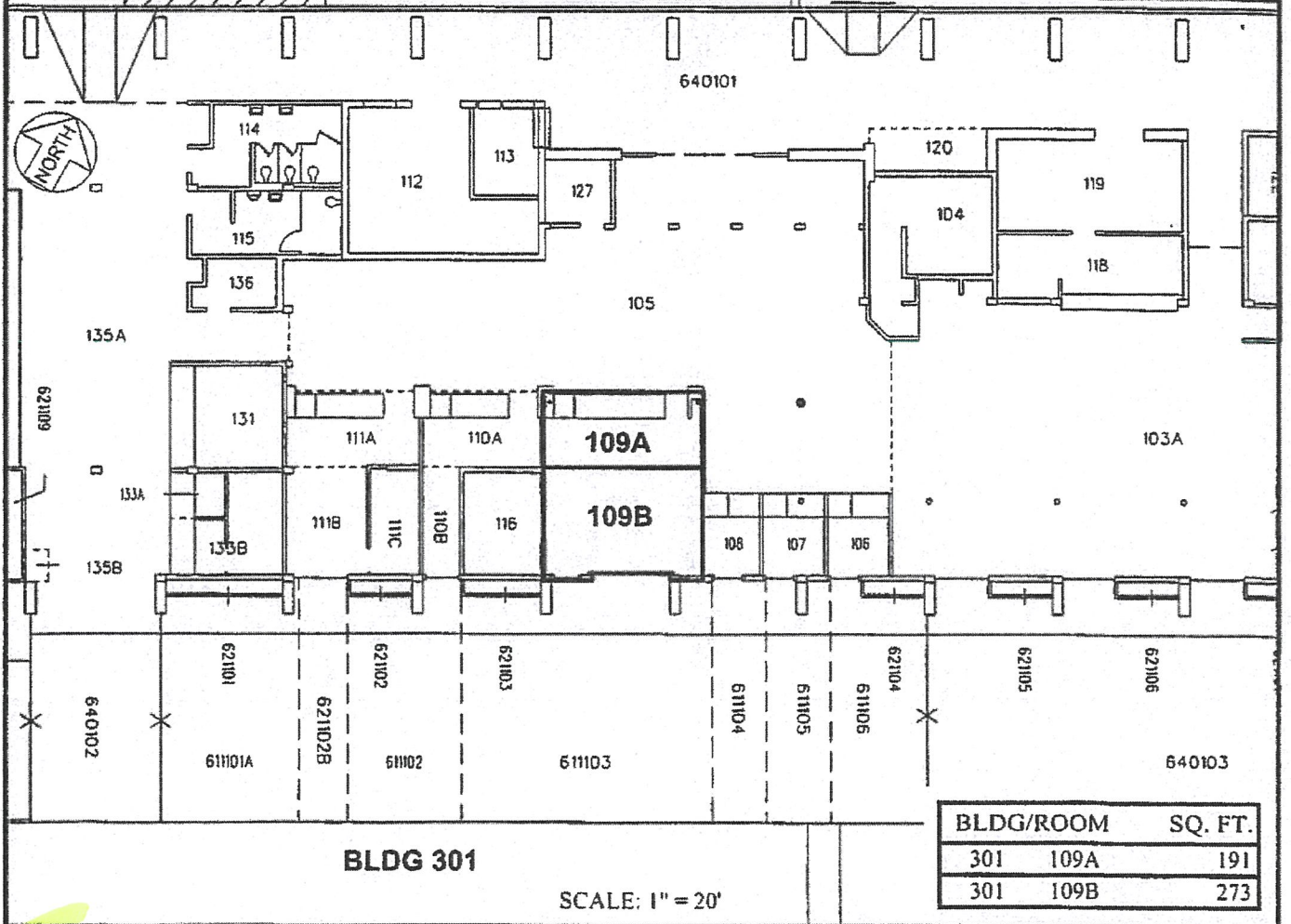
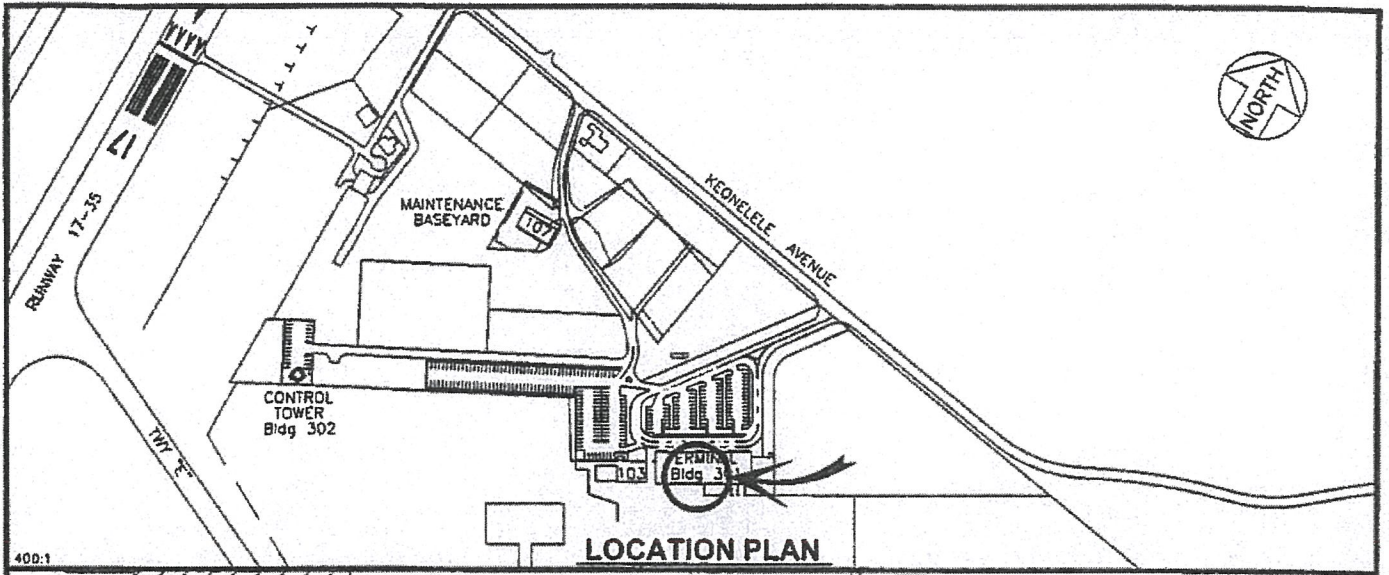

RP-

DATE : JUNE 2018

EXHIBIT: **A**

 Airports Division	HAWAIIAN AIRLINES, INC	BUILDING 301 TERMINAL BUILDING GROUND LEVEL	301109A
			301109B
			PLATS A1, 33

**MOLOKAI AIRPORT**

N:\AIRPORTS\MKK\_Molokai\CAD\PM\mkk\_301109A-01.dwg