



STATE OF HAWAII
DEPARTMENT OF TRANSPORTATION
869 PUNCHBOWL STREET
HONOLULU, HAWAII 96813-5097

IN REPLY REFER TO:

Board of Land and
Natural Resources
State of Hawai'i
Honolulu, Hawai'i

ISSUANCE OF A REVOCABLE PERMIT FOR AMBULANCE VEHICLE PARKING
INTERNATIONAL LIFE SUPPORT, INC., DBA AMERICAN MEDICAL RESPONSE
WAIMEA-KOHALA AIRPORT
TAX MAP KEY: (3) 6-7-001: PORTION OF 08 HAWAI'I

LEGAL REFERENCE:

Section 171-55, Hawai'i Revised Statutes.

APPLICANT:

International Life Support, Inc., DBA American Medical Response (AMR), whose
business address 99-840 Iwaiwa St, Aiea, Hawai'i 96701.

LOCATION AND TAX MAP KEY:

Portion of Waimea-Kohala Airport, Kamuela, Island of Hawai'i, identified by Tax Map
Key: (3) 6-7-001: Portion OF 08.

AREA:

Area/Space 610-113, containing an area of approximately 210 square feet, as shown on the
attached Exhibit A.

ZONING:

State Land Use District:
County of Hawai'i:

Agricultural District
A-40A Agriculture

LAND TITLE STATUS:

Section 5(a) lands of the Hawai'i Admission Act: Non-Ceded
DHHL 30% entitlement lands pursuant to Hawai'i Admission Act YES ___ NO X

CURRENT USE STATUS:

Airport and aeronautical purposes.

CHARACTER OF USE:

AMR will use the space to park an ambulance.

COMMENCEMENT DATE:

Upon execution of the revocable permit.

MONTHLY RENTAL:

\$41.00 (as determined from the DOTA schedule of rates and charges established by appraisal of Airports property statewide).

SECURITY DEPOSIT:

\$123.00 or three times the monthly rental in effect.

DCCA VERIFICATION:

Place of business registration confirmed:	YES <u>X</u>	NO _____
Registered business name confirmed:	YES <u>X</u>	NO _____
Good standing confirmed:	YES <u>X</u>	NO _____

CHAPTER 343, HRS - ENVIRONMENTAL ASSESSMENT:

Pursuant to Section 11-200-8(a), Environmental Impact Statement Rules of the Department of Health, State of Hawai'i, this disposition is exempt from requirements regarding preparation of an environmental assessment, negative declaration, or environmental impact statement as required by Chapter 343, Hawai'i Revised Statutes, as amended, relating to Environmental Impact Statements, because the proposed action falls within Exemption Class #1, Comprehensive Exemption List for the State of Hawai'i, Department of Transportation, dated November 15, 2000, as approved by the Environmental Quality Council. Exemption Class #1 covers operations, repairs, or maintenance of existing structures, facilities, equipment, or topographical features involving negligible or no expansion or change of use beyond that previously existing.

The DOTA consulted with the U.S. Federal Aviation Administration as to the appropriateness of the citation of the Environmental Exemption Class from the Comprehensive list for the Department of Transportation dated November 15, 2000. In this case, the FAA concurred on the appropriateness.

REMARKS:

In accordance with Section 171-55 HRS, relating to Permits, the Department of Transportation proposes to issue a month-to-month revocable permit to AMR for ambulance parking.

RECOMMENDATION:

That the Board authorize the Department of Transportation to issue a month-to-month revocable permit to AMR, subject to: (1) terms and conditions herein outlined, which are by reference incorporated herein; and (2) such additional terms and conditions as may be prescribed by the Director of Transportation to best serve the interests of the State.

Respectfully submitted,



JADE T. BUTAY
Director of Transportation

APPROVED FOR SUBMITTAL:

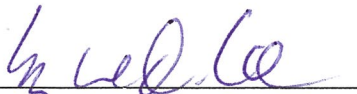

SUZANNE D. CASE
Chairperson and Member

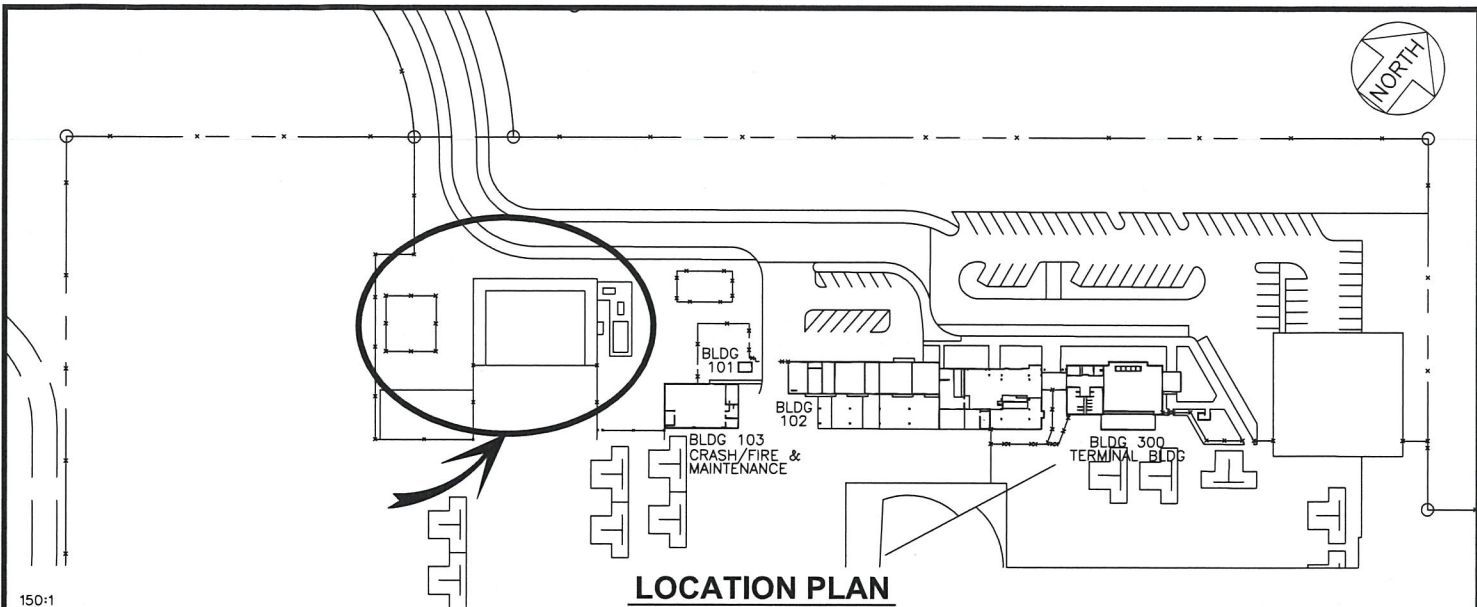

LOCATION PLAN

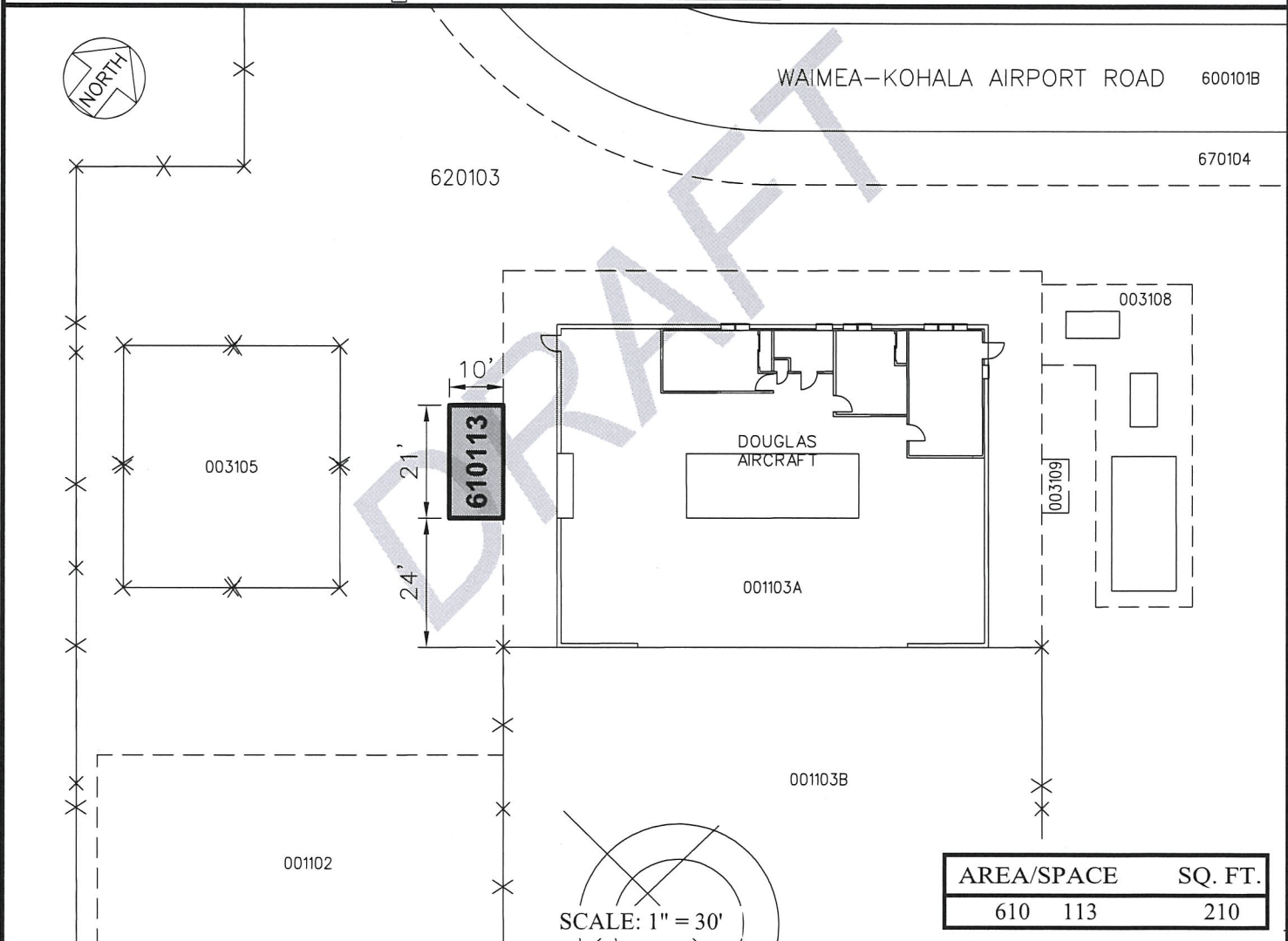

SCALE: 1" = 30'

DRAFT

DATE : MAY 2019

EXHIBIT: **A**



Airports Division

INTERNATIONAL LIFE SUPPORT, INC.

VEHICLE PARKING
GROUND LEVEL

610113

PLATS A1, 41

WAIMEA-KOHALA AIRPORT

N:\AIRPORTS\MUE\WAIMEA\KOHALA\CAD\PM\MUE_610113-01_DRAFT.DWG