

DAVID Y. IGE
GOVERNOR



STATE OF HAWAII
DEPARTMENT OF TRANSPORTATION
869 PUNCHBOWL STREET
HONOLULU, HAWAII 96813-5097

JADE T. BUTAY
DIRECTOR

Deputy Directors
LYNN A.S. ARAKI-REGAN
DEREK J. CHOW
ROSS M. HIGASHI
EDWIN H. SNIFFEN

IN REPLY REFER TO:

Board of Land and
Natural Resources
State of Hawai'i
Honolulu, Hawai'i

ISSUANCE OF A REVOCABLE PERMIT FOR A SATELLITE DISH
HOST INTERNATIONAL, INC.
DANIEL K. INOUE INTERNATIONAL AIRPORT
TAX MAP KEY: (1) 1-1-003: 001 (PORTION)

O'AHU

LEGAL REFERENCE:

Chapter 102 and Section 261-7, Hawai'i Revised Statutes, as amended.

APPLICANT:

Host International, Inc. (HOST), whose business address is 6905 Rockledge Drive,
Bethesda, Maryland 20817.

LOCATION AND TAX MAP KEY:

A portion of Daniel K. Inouye International Airport, Island of O'ahu, State of Hawai'i,
identified by Tax Map Key: 1st Division, 1-1-003: 001 (PORTION).

AREA:

Area/Space No. 373-402, containing an area of approximately 25 square feet as
delineated on the attached map Exhibit "A".

ZONING:

State Land Use District:	Urban
County of Honolulu	Industrial (I-2)

ITEM M-2

BLNR – ISSUANCE OF A REVOCABLE PERMIT FOR A SATELLITE DISH
HOST INTERNATIONAL, INC.

Page 2

LAND TITLE STATUS:

Section 5(a) lands of the Hawai‘i Admissions Act: Non-Ceded
DHHL 30% entitlement lands pursuant to the Hawai‘i State Constitution: No

CURRENT USE STATUS:

Land presently encumbered by Governor’s Executive Order No. 3201, dated June 8, 1983, setting aside 3,152,177 acres designated as Daniel K. Inouye International Airport under the control and management of the State of Hawai‘i, Department of Transportation Airports Division (DOTA) for Airports purposes.

CHARACTER OF USE:

Satellite dish.

COMMENCEMENT DATE:

Upon execution of the revocable permit.

MONTHLY RENTAL:

\$ 25.00

SECURITY DEPOSIT:

\$ 75.00 or three times the monthly rental in effect.

HOLDOVER TENANCY:

\$.83

DCCA VERIFICATION:

Place of business registration confirmed:	YES <u>X</u>	NO _____
Registered business name confirmed:	YES <u>X</u>	NO _____
Good standing confirmed:	YES <u>X</u>	NO _____

CHAPTER 343, HRS – ENVIRONMENTAL ASSESSMENT:

Pursuant to Section 11-200-8 (a), Environmental Impact Statement Rules of the Department of Health, State of Hawai‘i, this disposition is exempt from requirements regarding preparation of an environmental assessment, negative declaration, or environmental impact statement as required by Chapter 343, Hawai‘i Revised Statutes, as amended, relating to Environmental Impact Statements because the proposed action falls

within Exemption Class #1, Comprehensive Exemption List for the State of Hawai‘i, Department of Transportation Amended November 15, 2000, as approved by the Environmental Quality Council. Exemption Class #1 covers operations, repairs, or maintenance of existing structures, facilities, equipment, or topographical features involving negligible or no expansion or change of use beyond that previously existing.

The DOTA consulted with the U.S. Federal Aviation Administration as to the appropriateness of the citation of the Environmental Exemption Class from the Comprehensive list for the Department of Transportation dated November 15, 2000. The FAA concurred on the appropriateness.

REMARKS:

In accordance with Section 171-55, HRS, relating to Permits, the Department of Transportation proposes to issue a month-to-month revocable permit to Host International, Inc., who has been successfully operating the Restaurant and Lounge Concession at Daniel K. Inouye International Airport.

RECOMMENDATION:

That the Board authorizes the Department of Transportation to issue a month-to month revocable permit to Host International, Inc., subject to: 1) terms and conditions herein outlined, which are by reference incorporated herein, and 2) such other terms and conditions as may be prescribed by the Director of Transportation to best serve the interests of the State.

Respectfully submitted,



 JADE T. BUTAY
Director of Transportation

APPROVAL FOR SUBMITTAL:

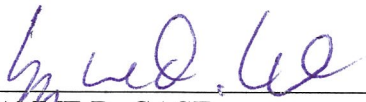

SUZANNE D. CASE
Chairperson and Member

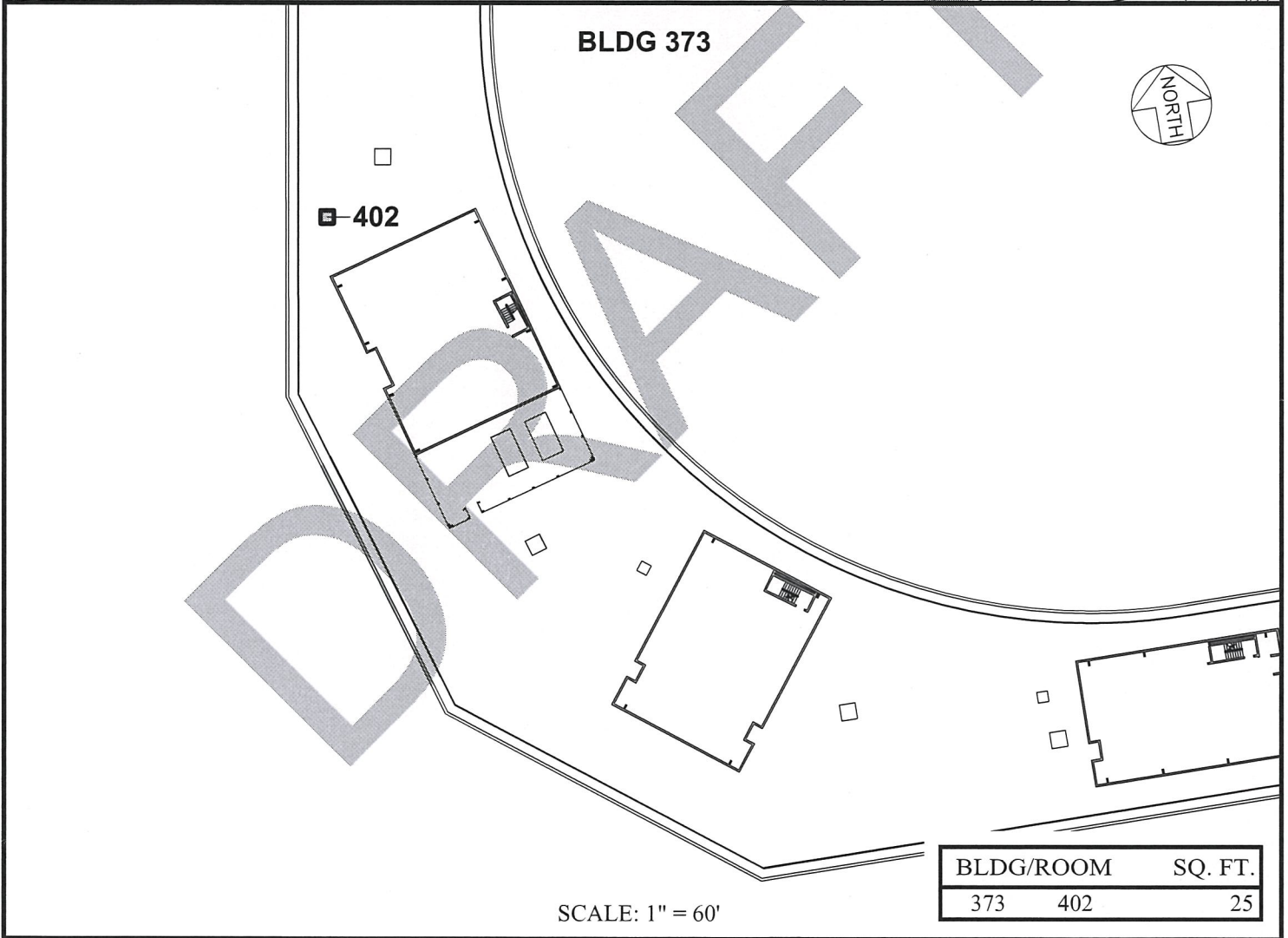
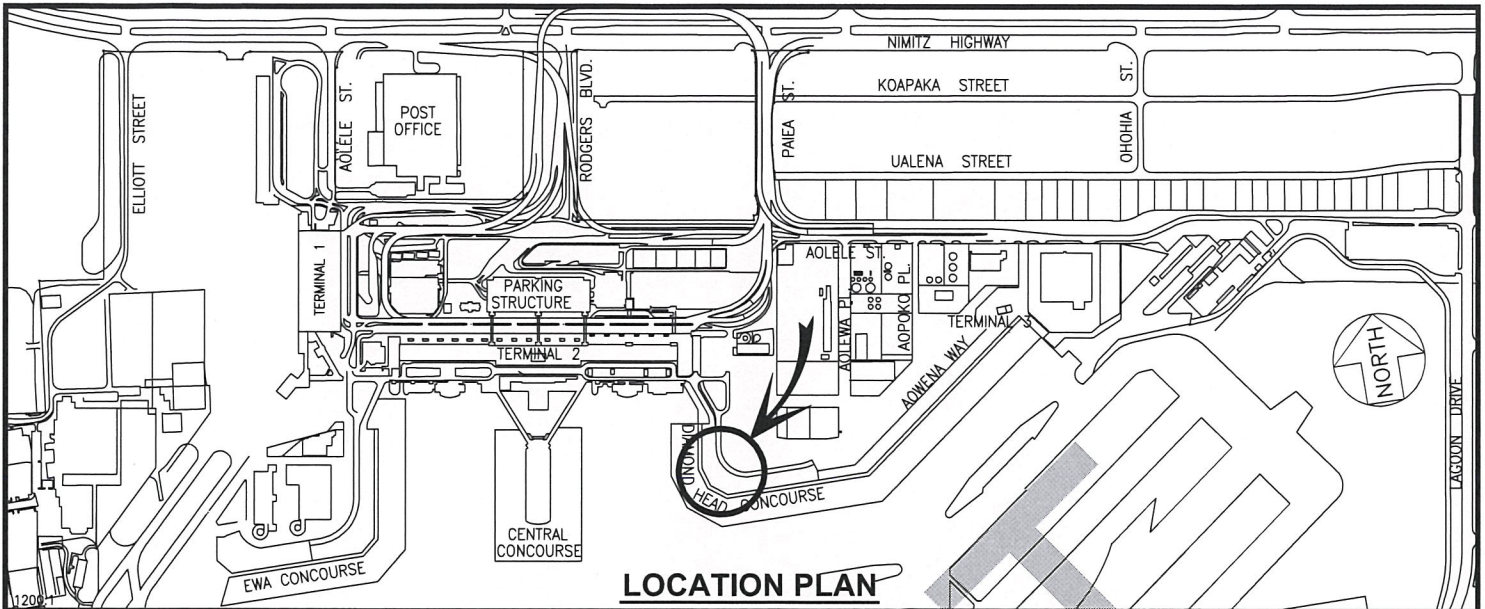

DATE : APRIL 2019

EXHIBIT: **A**

Airports Division	HOST INTERNATIONAL, INC.	BUILDING 373 D. H. CONCOURSE FOURTH LEVEL	373402
			PLAT M4

N:\AIRPORTS\HNL_HONOLULU\CAD\PM_DRAFT\HNL_373402-01_DRAFT.DWG

DANIEL K. INOUE INTERNATIONAL AIRPORT