

STATE OF HAWAII
DEPARTMENT OF TRANSPORTATION
869 PUNCHBOWL STREET
HONOLULU, HAWAII 96813-5097

JADE T. BUTAY
DIRECTOR

Deputy Directors
LYNN A.S. ARAKI-REGAN
DEREK J. CHOW
ROSS M. HIGASHI
EDWIN H. SNIFFEN

IN REPLY REFER TO:

Board of Land and
Natural Resources
State of Hawai'i
Honolulu, Hawai'i

ISSUANCE OF A REVOCABLE PERMIT FOR OFFICE SPACE IN
CAR RENTAL BUILDING NO. 307
AVAIRPROS SERVICES, INC.
LĪHU'E AIRPORT
TAX MAP KEY: (4) 3-5-01: PORTION OF 8

KAUA'I

LEGAL REFERENCE:

Section 171-55, Hawai'i Revised Statutes.

APPLICANT:

AvAirPros Services, Inc. (ASI), whose business address is 5551 Ridgewood Drive,
Suite 300, Naples, Florida 34108.

LOCATION AND TAX MAP KEY:

Portion of Līhu'e Airport, (LIH), Līhu'e, Island of Kaua'i, identified by Tax Map
Key: 4th Division, 3-5-01:Portion of 8.

AREA:

Bldg./No. 307-105, containing an area of approximately 75 square feet of space, as shown
on the attached Exhibit A.

ZONING:

State Land Use District:
County of Kaua'i:

Urban
Industrial (IG-STP)

BLNR – ISSUANCE OF A REVOCABLE PERMIT FOR OFFICE SPACE
IN CAR RENTAL BUILDING NO. 307, AVAIRPROS SERVICES, INC.

Page 2

LAND TITLE STATUS:

Section 5(a) lands of the Hawai'i Admission Act: Non-Ceded
DHHL 30% entitlement lands pursuant to Hawai'i Admission Act YES ___ NO X

CURRENT USE STATUS:

Airport and aeronautical purposes.

CHARACTER OF USE:

ASI will use the space for their representative to use as an office.

COMMENCEMENT DATE:

Upon execution of the revocable permit.

MONTHLY RENTAL:

\$168.00 (as determined from the DOTA schedule of rates and charges established by appraisal of Airports property statewide).

SECURITY DEPOSIT:

\$504.00, or three times the monthly rental in effect.

HOLDOVER TENANCY:

\$5.60

DCCA VERIFICATION:

Place of business registration confirmed:	YES <u>X</u>	NO _____
Registered business name confirmed:	YES <u>X</u>	NO _____
Good standing confirmed:	YES <u>X</u>	NO _____

CHAPTER 343, HRS - ENVIRONMENTAL ASSESSMENT:

Pursuant to Section 11-200-8(a), Environmental Impact Statement Rules of the Department of Health, State of Hawai'i, this disposition is exempt from requirements regarding preparation of an environmental assessment, negative declaration, or environmental impact statement as required by Chapter 343, Hawai'i Revised Statutes, as amended, relating to Environmental Impact Statements, because the proposed action falls

BLNR – ISSUANCE OF A REVOCABLE PERMIT FOR OFFICE SPACE
IN CAR RENTAL BUILDING NO. 307, AVAIRPROS SERVICES, INC.

Page 3

within Exemption Class #1, Comprehensive Exemption List for the State of Hawai'i, Department of Transportation, dated November 15, 2000, as approved by the Environmental Quality Council. Exemption Class #1 covers operations, repairs, or maintenance of existing structures, facilities, equipment, or topographical features involving negligible or no expansion or change of use beyond that previously existing.

The DOTA consulted with the U.S. Federal Aviation Administration as to the appropriateness of the citation of the Environmental Exemption Class from the Comprehensive list for the Department of Transportation dated November 15, 2000. In this case, the FAA concurred on the appropriateness.

REMARKS:

In accordance with Section 171-55 HRS, relating to Permits, the Department of Transportation proposes to issue a month-to-month revocable permit to ASI for an office space at LIH.

RECOMMENDATION:

That the Board authorize the Department of Transportation to issue a month-to-month revocable permit to ASI, subject to: (1) terms and conditions herein outlined, which are by reference incorporated herein; and (2) such additional terms and conditions as may be prescribed by the Director of Transportation to best serve the interests of the State.

Respectfully submitted,

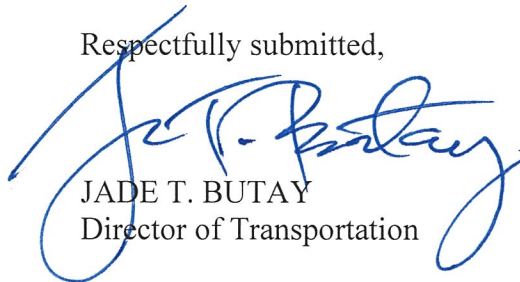

JADE T. BUTAY
Director of Transportation

APPROVED FOR SUBMITTAL:



SUZANNE D. CASE
Chairperson and Member

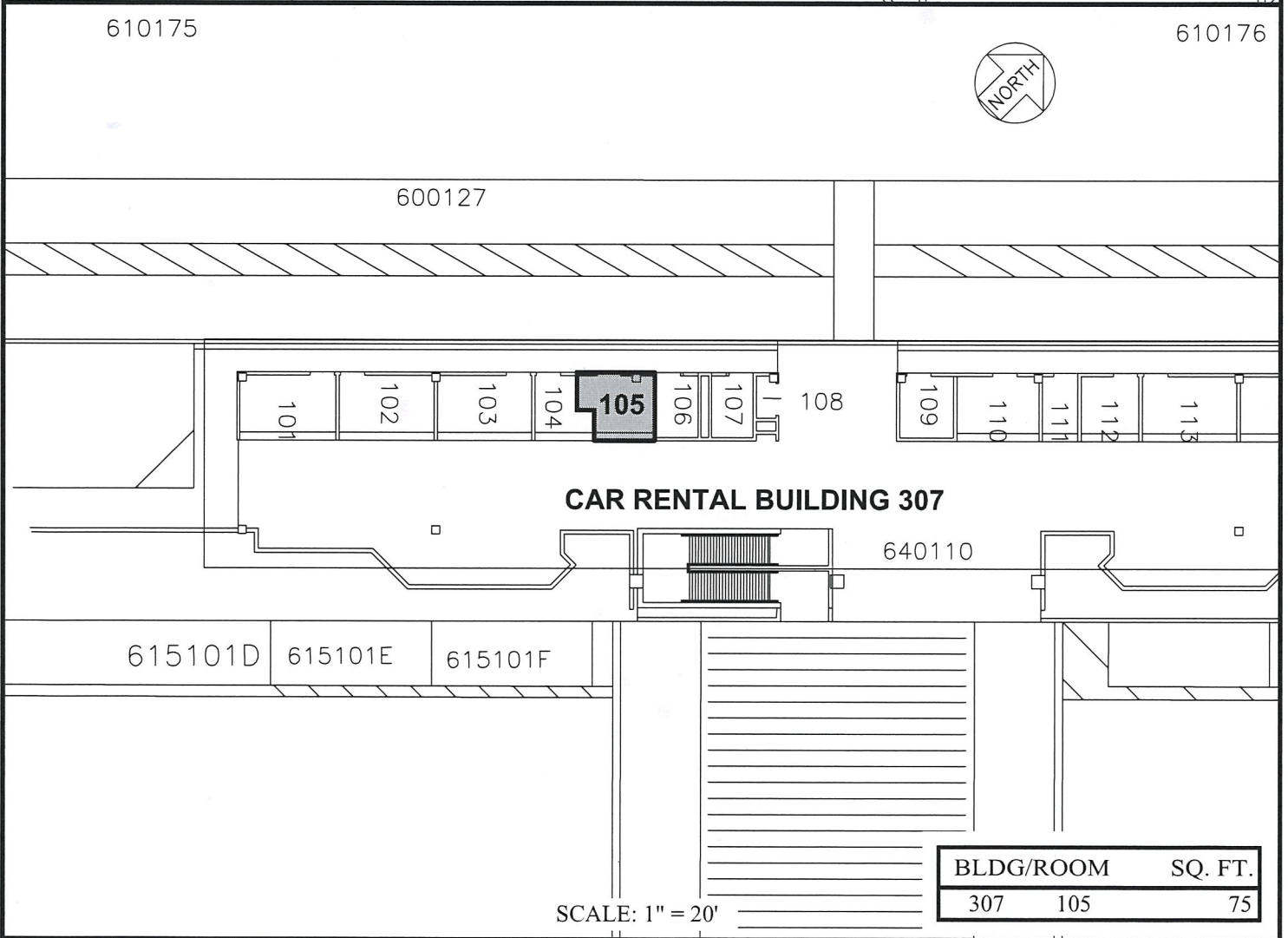
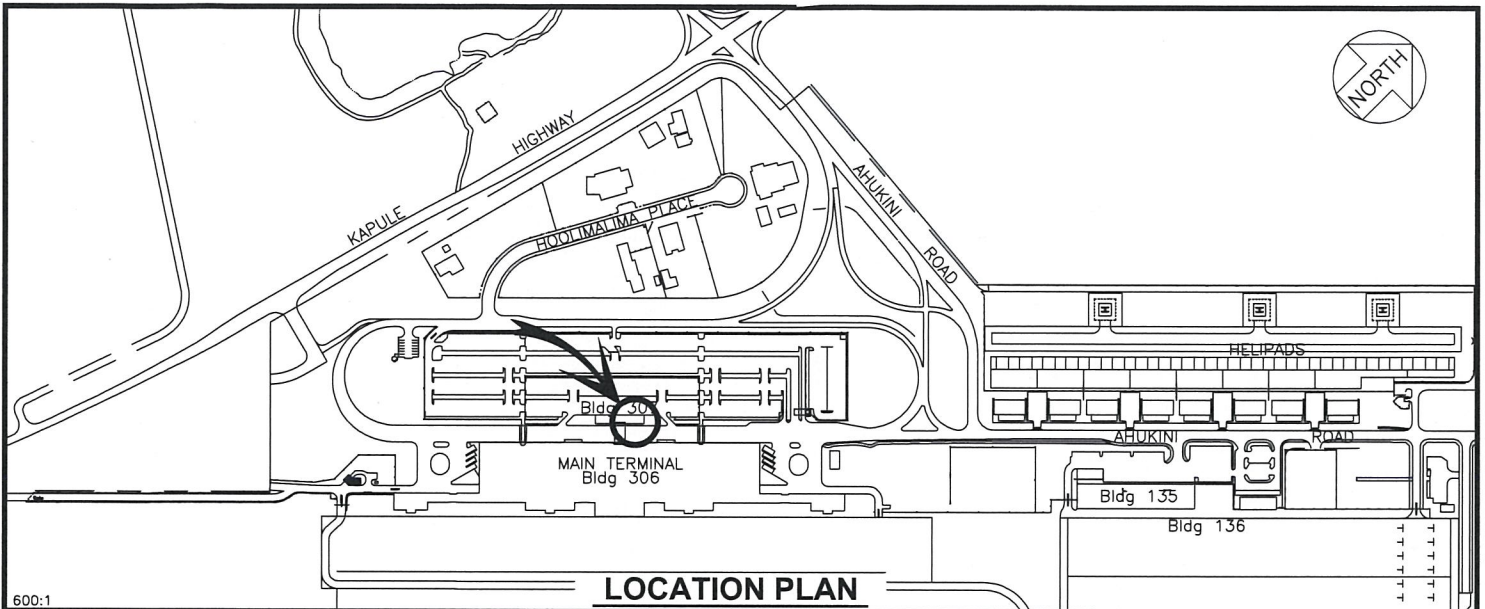

RP-8882

DATE : APRIL 2019

EXHIBIT: **A**



AVAIRPROS SERVICES, INC.

BUILDING 307
CAR RENTAL
GROUND LEVEL

307105
PLAT C1, 45