

DAVID Y. IGE  
GOVERNOR



**STATE OF HAWAII**  
**DEPARTMENT OF TRANSPORTATION**  
869 PUNCHBOWL STREET  
HONOLULU, HAWAII 96813-5097

JADE T. BUTAY  
DIRECTOR

Deputy Directors  
LYNN A.S. ARAKI-REGAN  
DEREK J. CHOW  
ROSS M. HIGASHI  
EDWIN H. SNIFFEN

IN REPLY REFER TO:

Board of Land and  
Natural Resources  
State of Hawai'i  
Honolulu, Hawai'i

ISSUANCE OF A REVOCABLE PERMIT  
FOR CONTAINER STORAGE AND EQUIPMENT STAGING AREA  
NAN, INC.  
DANIEL K. INOUE INTERNATIONAL AIRPORT  
TAX MAP KEY: (1) 1-1-003: 001 (PORTION)

O'AHU

APPLICANT:

Nan, Inc. (NAN), a Hawai'i corporation, authorized to do business in the State of Hawai'i, whose mailing address is 636 Laumaka Street, Honolulu, Hawai'i 96819.

LEGAL REFERENCE:

Section 171-55, Hawai'i Revised Statutes (HRS).

LOCATION:

A portion of Daniel K. Inouye International Airport, Island of O'ahu, State of Hawai'i, identified by Tax Map Key: 1st Division, 1-1-003: 001 (Portion).

AREA:

Area/Space No. 600-134, containing an area of approximately 5,103 square feet, as shown and delineated on the attached map labeled Exhibit "A".

ZONING:

State Land Use District: Urban  
City and County of Honolulu LUO: Industrial (I-2)

LAND TITLE STATUS:

Non-ceded - Section 5(a) lands of the Hawai'i Admission Act  
DHHL 30% entitlement lands pursuant to Hawai'i Admission Act YES \_\_\_ NO X

**ITEM M-1**

BLNR – ISSUANCE OF A REVOCABLE PERMIT  
FOR CONTAINER STORAGE AND EQUIPMENT STAGING AREA  
NAN, INC.  
Page 2

CURRENT USE STATUS:

Land presently encumbered by Governor’s Executive Order No. 3201, dated June 8, 1983, setting aside 3,152.177 acres designated as Daniel K. Inouye International Airport under the control and management of the State of Hawai‘i, Department of Transportation, Airports Division (DOTA) for Airport Purposes.

CHARACTER OF USE:

NAN will use the space for container storage and equipment staging area, as specifically stated under Contract No. 67055, State Project No. AO1033-23, Baggage Handling Systems Improvements, Overseas Terminal, Phase 1, Daniel K. Inouye International Airport.

COMMENCEMENT DATE:

To be determined by the Director of Transportation at a later date.

MONTHLY RENTAL:

\$25.00 (as stated in Addendum No. 1 of Contract No. 67055, State Project No. AO1033-23, Baggage Handling Systems Improvements, Overseas Terminal, Phase 1, Daniel K. Inouye International Airport).

SECURITY DEPOSIT:

Three (3) times the monthly rental in effect.

DCCA VERIFICATION:

Place of business registration confirmed:	YES <u>X</u>	NO _____
Registered business name confirmed:	YES <u>X</u>	NO _____
Good standing confirmed:	YES <u>X</u>	NO _____

CHAPTER 343, HRS - ENVIRONMENTAL ASSESSMENT:

Pursuant to Section 11-200-8(a), Environmental Impact Statement Rules of the Department of Health, State of Hawai‘i, this disposition is exempt from requirements regarding preparation of an environmental assessment, negative declaration, or environmental impact statement as required by Chapter 343, Hawai‘i Revised Statutes, as amended, relating to Environmental Impact Statements, because the proposed action falls within Exemption Class #1, Comprehensive Exemption List for the State of Hawai‘i, Department of Transportation, dated November 15, 2000, as approved by the

Environmental Quality Council. Exemption Class #1 covers operations, repairs, or maintenance of existing structures, facilities, equipment, or topographical features involving negligible or no expansion or change of use beyond that previously existing.

The DOTA consulted with the U.S. Federal Aviation Administration as to the appropriateness of the citation of the Environmental Exemption Class from the Comprehensive list for the Department of Transportation dated November 15, 2000. The FAA concurred on the appropriateness.

REMARKS:

In accordance with Section 171-55, HRS, relating to Permits, the DOTA proposes to issue a permit to NAN for container storage and equipment staging area, as specifically stated in Addendum No. 1, dated May 24, 2018, of Contract No. 67055, State Project No. AO1033-23, Baggage Handling Systems Improvements, Overseas Terminal, Phase 1, Daniel K. Inouye International Airport, Item No. 15, “Space on the airport property is severely limited and therefore space provided to the Contractor for the use of a field office and/or storage/staging area is not guaranteed.... If the space on airport property does come available, the State will issue a permit to the Contractor for the use of the space, at \$25 per month under a revocable permit, to be used specifically for a field office and/or staging area....”

RECOMMENDATION:

That the Board authorize the Department of Transportation to issue a month-to-month revocable permit to NAN, subject to: (1) terms and conditions herein outlined, which are by reference incorporated herein; and (2) such additional terms and conditions as may be prescribed by the Director of Transportation to best serve the interests of the State.

Respectfully submitted,

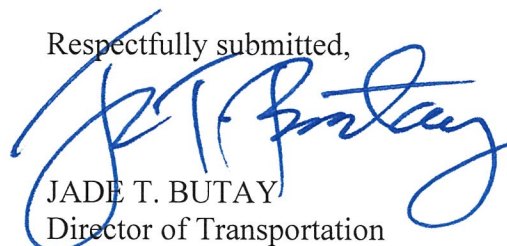

JADE T. BUTAY  
Director of Transportation

APPROVED FOR SUBMITTAL:



SUZANNE D. CASE  
Chairperson and Member



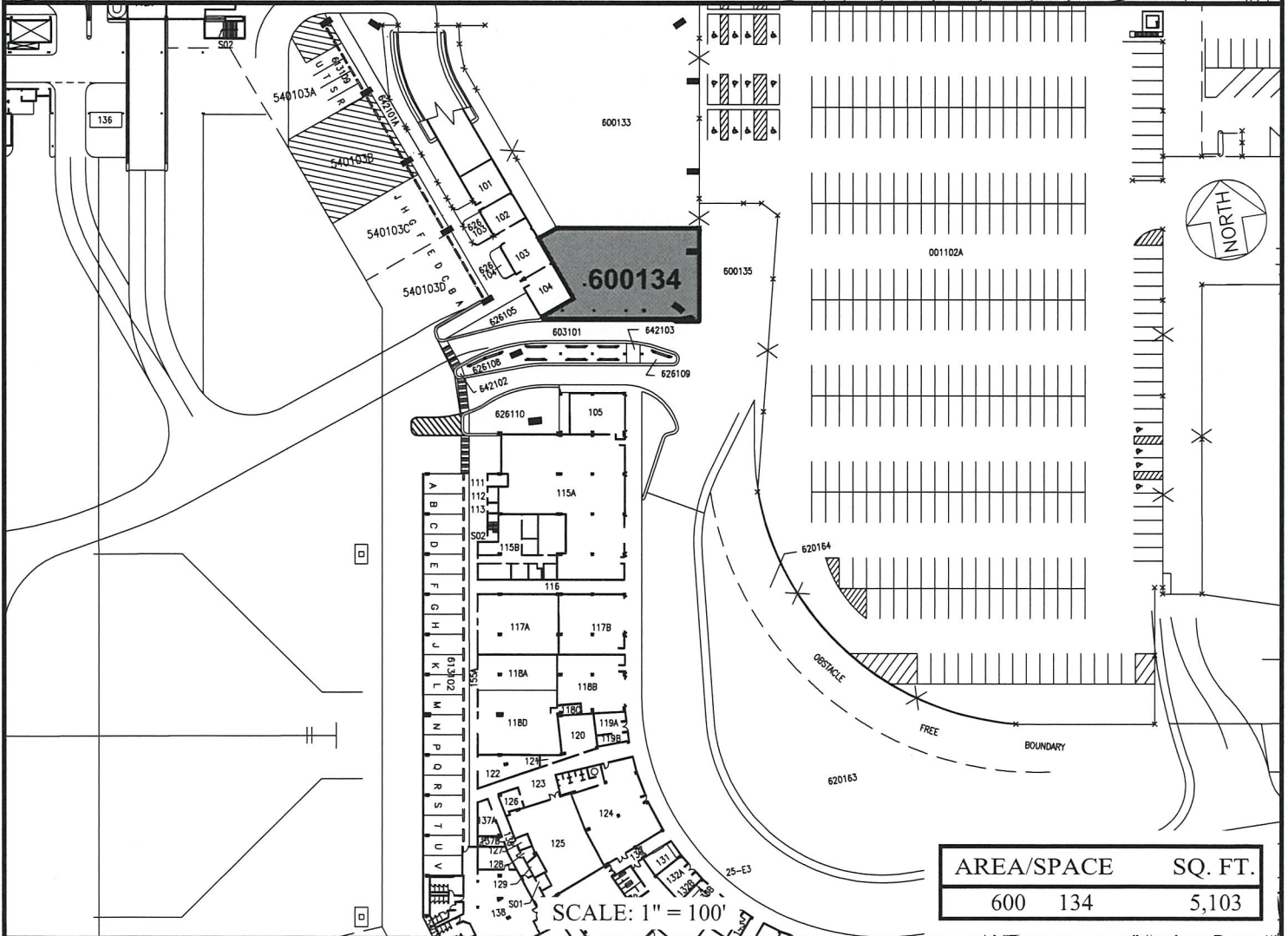
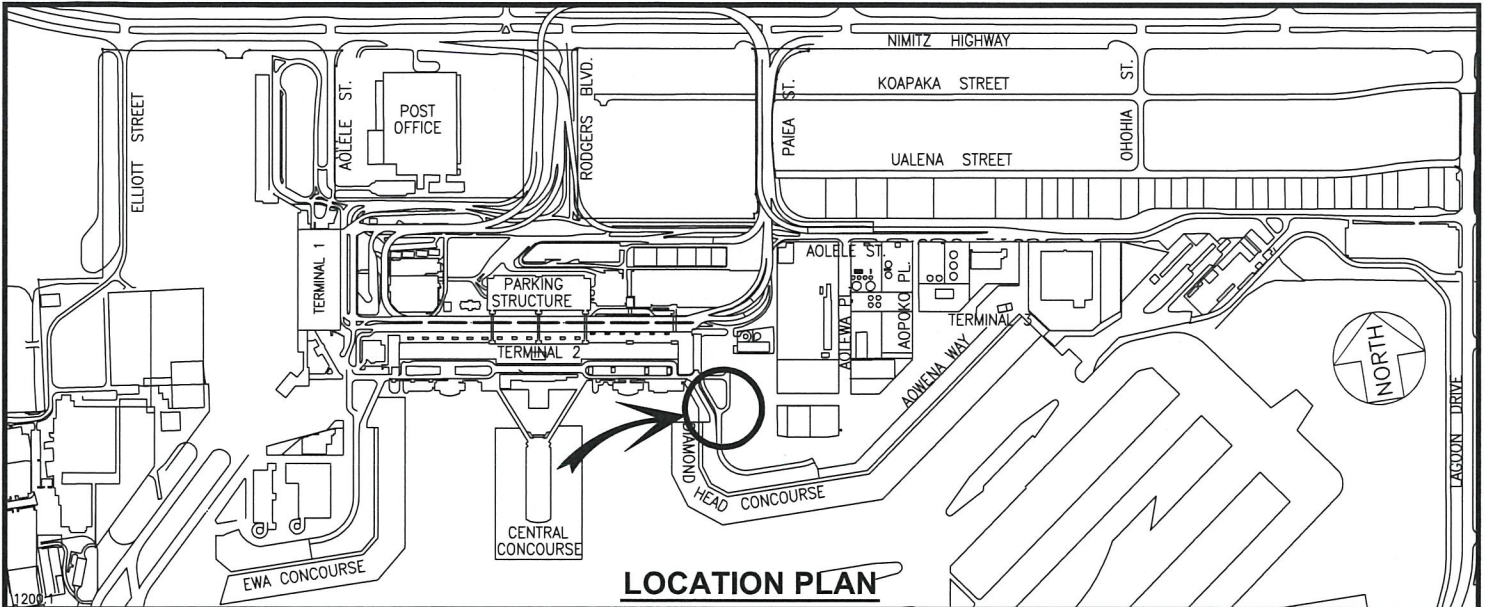

RP-8908

DATE : JUNE 2019

EXHIBIT: **A**



NAN, INC.

ROADS & STREETS  
MAIN TERMINAL AREA  
GROUND LEVEL

600134  
PLAT A1

DANIEL K. INOUE INTERNATIONAL AIRPORT

N:\AIRPORTS\HNL\_HONOLULU\CAD\PM\HNL\_600134-02.DWG