

STATE OF HAWAII
DEPARTMENT OF TRANSPORTATION
869 PUNCHBOWL STREET
HONOLULU, HAWAII 96813-5097

JADE T. BUTAY
DIRECTOR

Deputy Directors
LYNN A.S. ARAKI-REGAN
DEREK J. CHOW
ROSS M. HIGASHI
EDWIN H. SNIFFEN

IN REPLY REFER TO:

Board of Land and
Natural Resources
State of Hawai'i
Honolulu, Hawai'i

ISSUANCE OF A REVOCABLE PERMIT FOR ADMINISTRATIVE SPACE
AIRLINES COMMITTEE OF HAWAII, INC.
INTER-ISLAND TERMINAL
DANIEL K. INOUE INTERNATIONAL AIRPORT
TAX MAP KEY: (1) 1-1-003: 073 (PORTION)

O'AHU

APPLICANT:

Airlines Committee of Hawaii, Inc. (ACH), whose business address is
300 Rodgers Boulevard #62, Honolulu, Hawai'i 96819.

LEGAL REFERENCE:

Section 171-55, Hawai'i Revised Statutes (HRS).

LOCATION:

Portion of Building 310, Inter-Island Terminal, Third Floor, at Daniel K. Inouye
International Airport, identified by Tax Map Key: 1st Division, 1-1-003: 073 (Portion).

AREA:

Building/Room No. 310-305C, containing an area of approximately 1,553 square feet,
Building/Room No. 310-305D, containing an area of approximately 59 square feet, and
Building/Room No. 310-305E, containing an area of approximately 167 square feet,
as shown and delineated on the attached map labeled Exhibit "A".

ZONING:

State Land Use District: Urban
City and County of Honolulu LUO: Industrial (I-2)

ITEM M-1

LAND TITLE STATUS:

Non-Ceded - Section 5(a) lands of the Hawai'i Admission Act
DHHL 30% entitlement lands pursuant to Hawai'i Admission Act YES ____ NO X

CURRENT USE STATUS:

Land presently encumbered by Governor's Executive Order No. 3201, dated June 8, 1983, setting aside 3,152.177 acres designated as Honolulu International Airport under the control and management of the State of Hawai'i, Department of Transportation, Airports Division (DOTA) for Airport Purposes.

CHARACTER OF USE:

ACH will use the AREA as administrative space (office, storage and breakroom) as part of its business operation as consultants to the Signatory Airline Carriers.

COMMENCEMENT DATE:

To be determined by the Director of Transportation at a later date.

MONTHLY RENTAL:

\$4,567.12 (\$3,516.70, as determined from the DOTA schedule of rates and charges established by appraisal of Airports property statewide plus \$605.67 for utilities and \$444.75 for air conditioning).

SECURITY DEPOSIT:

Three (3) times the monthly rental in effect.

DCCA VERIFICATION:

Place of business registration confirmed:	YES <u>X</u>	NO ____
Registered business name confirmed:	YES <u>X</u>	NO ____
Good standing confirmed:	YES <u>X</u>	NO ____

CHAPTER 343, HRS - ENVIRONMENTAL ASSESSMENT:

Pursuant to Section 11-200-8(a), Environmental Impact Statement Rules of the Department of Health, State of Hawai'i, this disposition is exempt from requirements regarding preparation of an environmental assessment, negative declaration, or environmental impact statement as required by Chapter 343, Hawai'i Revised Statutes, as amended, relating to Environmental Impact Statements, because the proposed action falls within Exemption Class #1, Comprehensive Exemption List for the State of Hawai'i,

BLNR – ISSUANCE OF A REVOCABLE PERMIT FOR ADMINISTRATIVE SPACE
AIRLINES COMMITTEE OF HAWAII, INC.

Page 3

Department of Transportation, dated November 15, 2000, as approved by the Environmental Quality Council. Exemption Class #1 covers operations, repairs, or maintenance of existing structures, facilities, equipment, or topographical features involving negligible or no expansion or change of use beyond that previously existing.

The DOTA consulted with the U.S. Federal Aviation Administration as to the appropriateness of the citation of the Environmental Exemption Class from the Comprehensive list for the Department of Transportation dated November 15, 2000. The FAA concurred on the appropriateness.

REMARKS:

In accordance with Section 171-55, HRS, relating to Permits, the Department of Transportation proposes to issue a month-to-month revocable permit to ACH for administrative space (office, storage and breakroom) as part of its business operation as consultants to the Signatory Airline Carriers at Daniel K. Inouye International Airport.

RECOMMENDATION:

That the Board authorize the Department of Transportation to issue a month-to-month revocable permit to ACH, subject to: (1) terms and conditions herein outlined, which are by reference incorporated herein; and (2) such additional terms and conditions as may be prescribed by the Director of Transportation to best serve the interests of the State.

Respectfully submitted,

JADE T. BUTAY
Director of Transportation

APPROVED FOR SUBMITTAL:

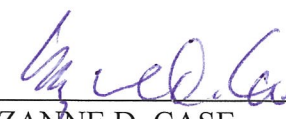
SUZANNE D. CASE
Chairperson and Member

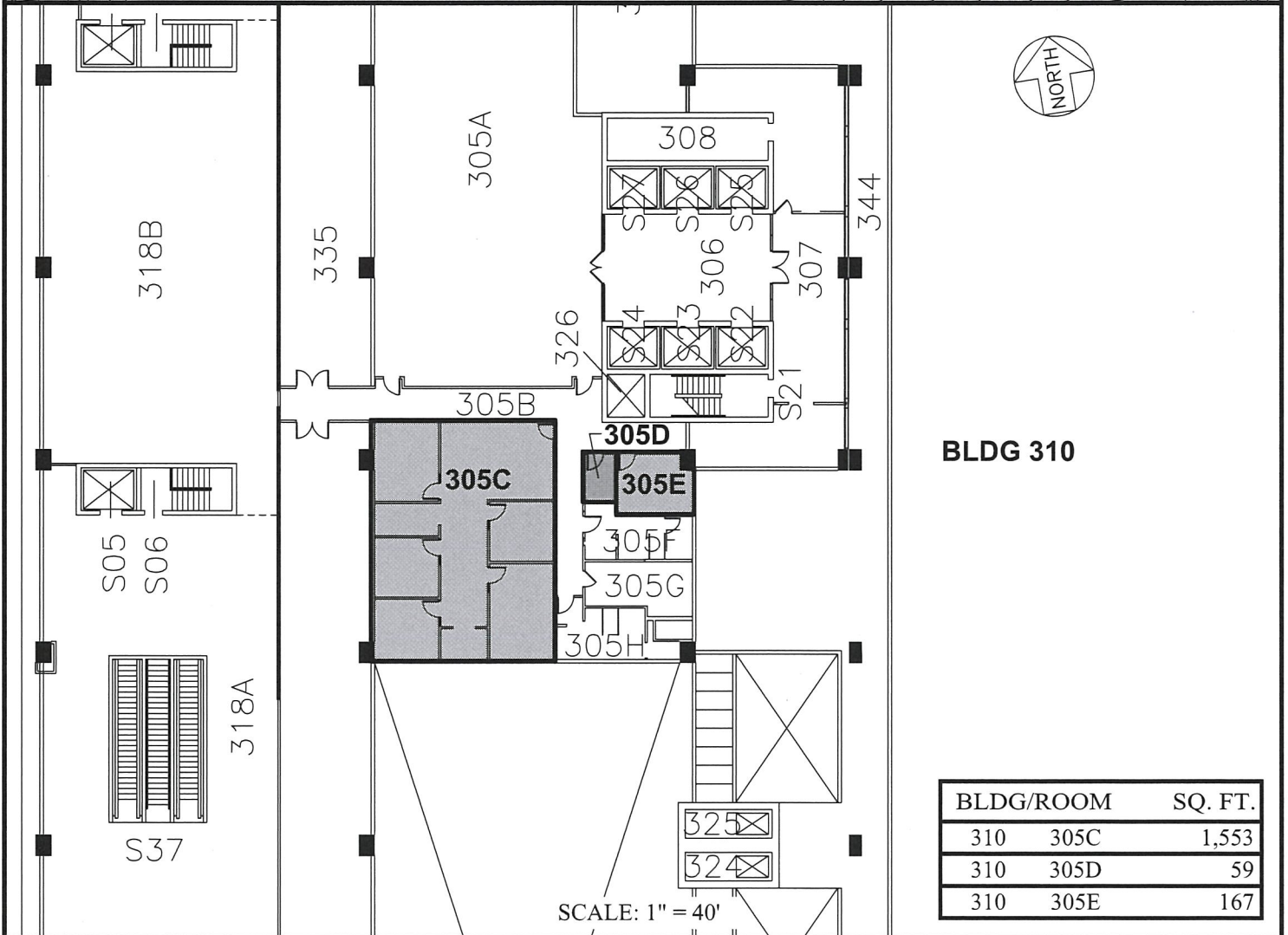
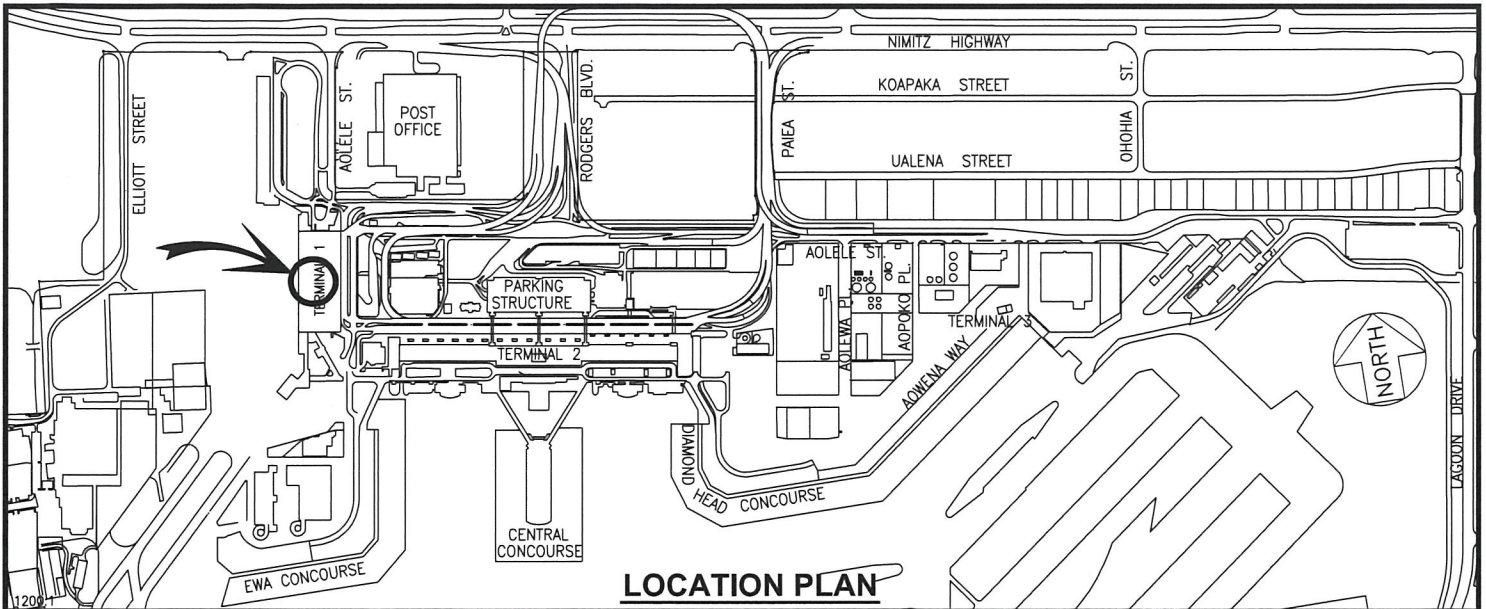

BLDG/ROOM	SQ. FT.
310 305C	1,553
310 305D	59
310 305E	167

RP-8921

DATE : AUGUST 2019

EXHIBIT: **A**



AIRLINES COMMITTEE
OF HAWAII, INC.

BUILDING 310
INTER-ISLAND TERMINAL
THIRD LEVEL

310305C
310305D
310305E
PLAT E3