

STATE OF HAWAII
DEPARTMENT OF TRANSPORTATION
869 PUNCHBOWL STREET
HONOLULU, HAWAII 96813-5097

JADE T. BUTAY
DIRECTOR

Deputy Directors
LYNN A.S. ARAKI-REGAN
DEREK J. CHOW
ROSS M. HIGASHI
EDWIN H. SNIFFEN

IN REPLY REFER TO:

Board of Land and
Natural Resources
State of Hawai'i
Honolulu, Hawai'i

ISSUANCE OF A REVOCABLE PERMIT FOR PASSENGER CHECK-IN KIOSKS
HAWAIIAN AIRLINES, INC.
DANIEL K. INOUE INTERNATIONAL AIRPORT
TAX MAP KEY: (1) 1-1-003: 073 (PORTION)

O'AHU

APPLICANT:

Hawaiian Airlines, Inc. (Hawaiian Airlines), whose business address is 3375 Koapaka Street, Suite G350, Honolulu, Hawai'i 96819.

LEGAL REFERENCE:

Section 171-55, Hawai'i Revised Statutes (HRS).

LOCATION AND TAX MAP KEY:

Portion of Building No. 310, Inter-Island Terminal, Second Level at Daniel K. Inouye International Airport, Island of Oahu, State of Hawai'i, identified by Tax Map Key: 1st Division, 1-1-003: 073 (Portion).

AREA:

- + Bldg/Room No. 310-220H, containing an area of approximately 90 square feet;
- + Bldg/Room No. 310-220J, containing an area of approximately 90 square feet;
- + Bldg/Room No. 310-220K, containing an area of approximately 90 square feet;
- + Bldg/Room No. 310-220L, containing an area of approximately 90 square feet;
- + Bldg/Room No. 310-220M, containing an area of approximately 90 square feet;
- + Bldg/Room No. 310-220N, containing an area of approximately 90 square feet;

BLNR – ISSUANCE OF A REVOCABLE PERMIT FOR PASSENGER CHECK-IN KIOSKS,
HAWAIIAN AIRLINES, INC.

Page 2

Bldg/Room No. 310-258L, containing an area of approximately 90 square feet;
Bldg/Room No. 310-258M, containing an area of approximately 90 square feet;
Bldg/Room No. 310-258N, containing an area of approximately 90 square feet;
Bldg/Room No. 310-258P, containing an area of approximately 90 square feet;
Bldg/Room No. 310-258Q, containing an area of approximately 90 square feet;
Bldg/Room No. 310-258R, containing an area of approximately 90 square feet, as shown
and delineated on the attached map labeled Exhibit “A”.

ZONING:

State Land Use District: Urban
City and County of Honolulu LUO: Industrial (I-2)

LAND TITLE STATUS:

Non-Ceded - Section 5(a) lands of the Hawai‘i Admission Act
DHHL 30% entitlement lands pursuant to Hawai‘i Admission Act YES ___ NO X

CURRENT USE STATUS:

Land presently encumbered by Governor’s Executive Order No. 3201, dated June 8,
1983, setting aside 3,152.177 acres designated as Daniel K. Inouye International Airport
under the control and management of the State of Hawai‘i, Department of Transportation,
Airports Division (DOTA) for Airport Purposes.

CHARACTER OF USE:

Hawaiian Airlines will use the spaces for passenger check-in kiosks as part of their
Signatory Airline Carrier Operations at Daniel K. Inouye International Airport.

COMMENCEMENT DATE:

Upon execution of the revocable permit.

MONTHLY RENTAL:

\$6,648.30 (as determined from the Airports Division Signatory Carrier Rates and
Charges, Hawai‘i Airports System, effective July 1, 2019).

The Airports Division Signatory Carrier Rates and Charges, Hawai‘i Airports System for
Fiscal Year 2020 is \$73.87 per square foot, per annum.

BLNR – ISSUANCE OF A REVOCABLE PERMIT FOR PASSENGER CHECK-IN KIOSKS,
HAWAIIAN AIRLINES, INC.

Page 3

SECURITY DEPOSIT:

Three (3) times the monthly rental in effect.

DCCA VERIFICATION:

Place of business registration confirmed:	YES <u>X</u>	NO _____
Registered business name confirmed:	YES <u>X</u>	NO _____
Good standing confirmed:	YES <u>X</u>	NO _____

CHAPTER 343, HRS - ENVIRONMENTAL ASSESSMENT:

Pursuant to Section 11-200-8(a), Environmental Impact Statement Rules of the Department of Health, State of Hawai'i, this disposition is exempt from requirements regarding preparation of an environmental assessment, negative declaration, or environmental impact statement as required by Chapter 343, Hawai'i Revised Statutes, as amended, relating to Environmental Impact Statements, because the proposed action falls within Exemption Class #1, Comprehensive Exemption List for the State of Hawai'i, Department of Transportation, dated November 15, 2000, as approved by the Environmental Quality Council. Exemption Class #1 covers operations, repairs, or maintenance of existing structures, facilities, equipment, or topographical features involving negligible or no expansion or change of use beyond that previously existing.

The DOTA consulted with the U.S. Federal Aviation Administration (FAA) as to the appropriateness of the citation of the Environmental Exemption Class from the Comprehensive list for the Department of Transportation dated November 15, 2000. The FAA concurred on the appropriateness.

REMARKS:

In accordance with Section 171-55, HRS, relating to Permits, the Department of Transportation proposes to issue a month-to-month revocable permit to Hawaiian Airlines for passenger check-in kiosks, as part of their Signatory Airline Carrier Operations at Daniel K. Inouye International Airport.

BLNR – ISSUANCE OF A REVOCABLE PERMIT FOR PASSENGER CHECK-IN KIOSKS,
HAWAIIAN AIRLINES, INC.

Page 4

RECOMMENDATION:

That the Board authorize the Department of Transportation to issue a month-to-month revocable permit to Hawaiian Airlines, subject to: (1) terms and conditions herein outlined, which are by reference incorporated herein; and (2) such additional terms and conditions as may be prescribed by the Director of Transportation to best serve the interests of the State.

Respectfully submitted,

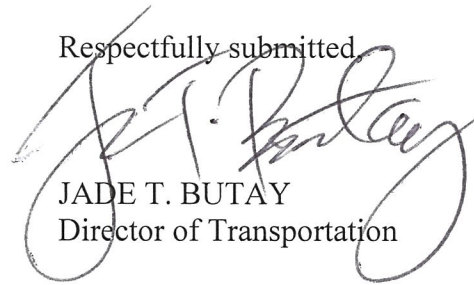
A handwritten signature in blue ink, appearing to read "Jade T. Butay", is written over the typed name and title.

JADE T. BUTAY
Director of Transportation

APPROVED FOR SUBMITTAL:

A handwritten signature in blue ink, appearing to read "Suzanne D. Case", is written over a horizontal line.

SUZANNE D. CASE
Chairperson and Member

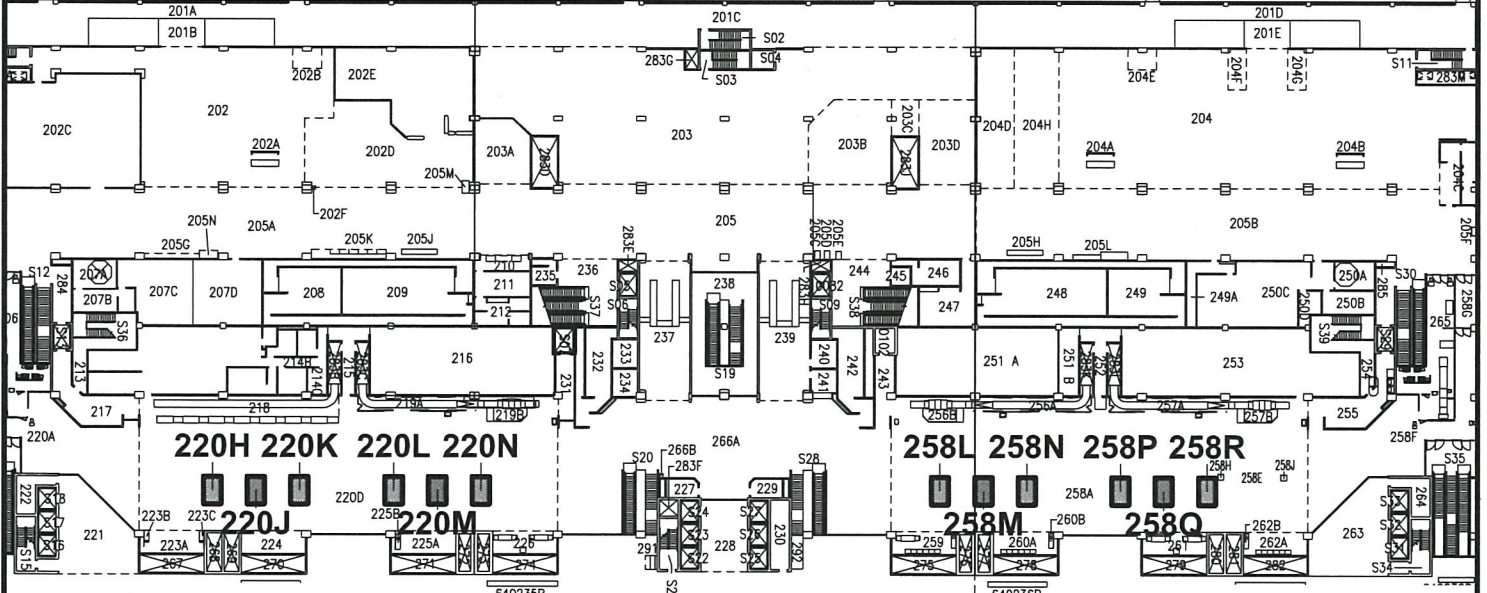
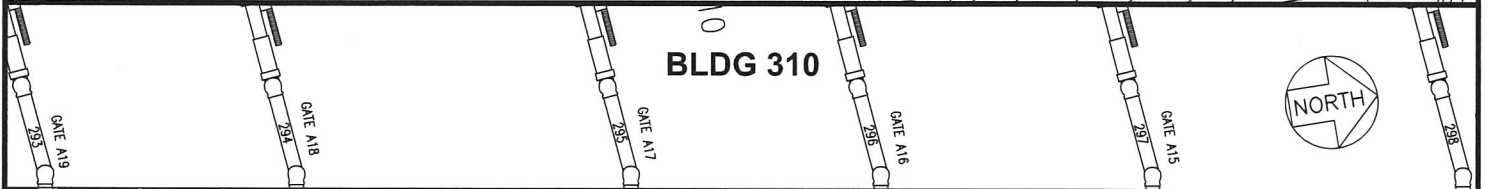
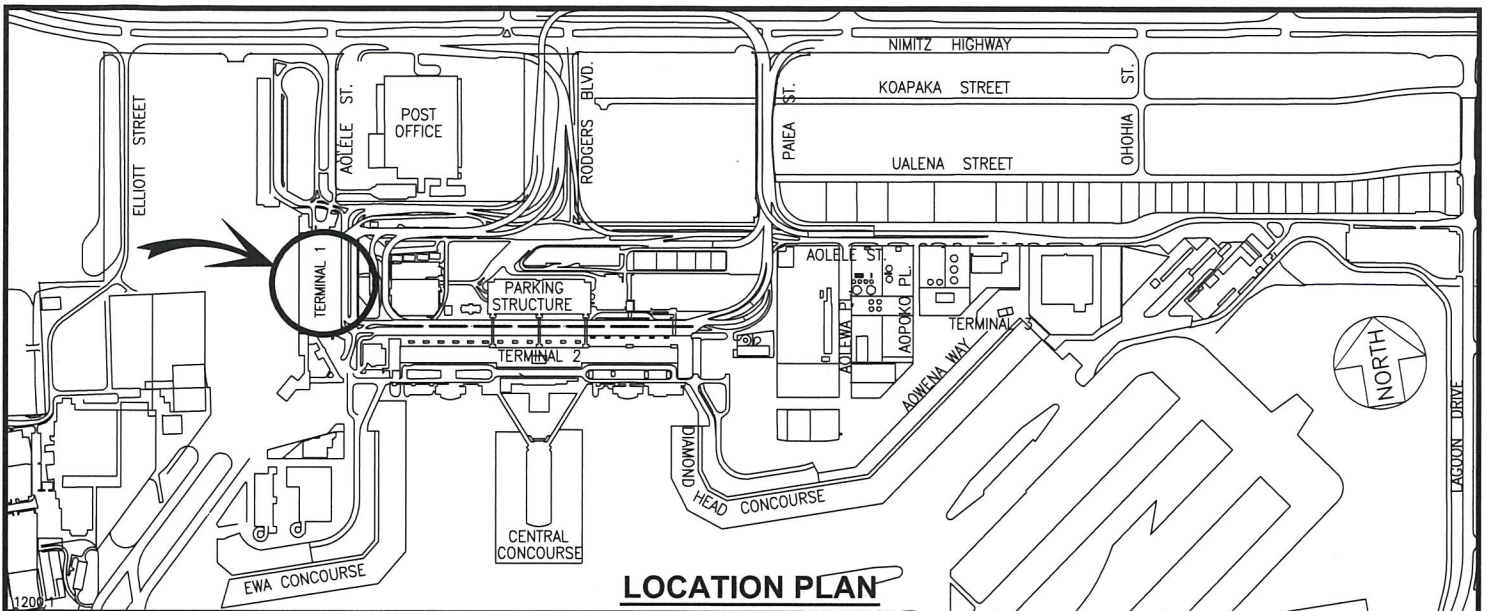

BLDG/ROOM	SQ. FT.
310 220H	90
310 220J	90
310 220K	90
310 220L	90
310 220M	90
310 220N	90

BLDG/ROOM	SQ. FT.
310 258L	90
310 258M	90
310 258N	90
310 258P	90
310 258Q	90
310 258R	90

SCALE: 1" = 80'

RP-8913

DATE : SEPTEMBER 2019

EXHIBIT: **A**



HAWAIIAN AIRLINES, INC.

**BUILDING 310
INTER-ISLAND TERMINAL
SECOND LEVEL**

310220H-N
310258L-R
PLAT E2