



STATE OF HAWAII
DEPARTMENT OF TRANSPORTATION
869 PUNCHBOWL STREET
HONOLULU, HAWAII 96813-5097

IN REPLY REFER TO:

October 11, 2019

Board of Land and
Natural Resources
State of Hawai'i
Honolulu, Hawai'i

ISSUANCE OF A REVOCABLE PERMIT
FOR CARGO AREA RAMP SPACE FOR EQUIPMENT STORAGE
AEKO KULA, LLC DBA ALOHA AIR CARGO
ELLISON ONIZUKA KONA INTERNATIONAL AIRPORT AT KEĀHOLE
TAX MAP KEY: (3) 7-3-43: PORTION OF 40

HAWAI'I

LEGAL REFERENCE:

Section 171-55, Hawai'i Revised Statutes.

APPLICANT:

Aeko Kula, LLC dba Aloha Air Cargo (AAC), whose business address is 50 Elliott Street, Honolulu, Hawai'i 96818.

LOCATION AND TAX MAP KEY:

Portion of Ellison Onizuka Kona International Airport at Keāhole (KOA), Kailua-Kona, Island of Hawai'i, identified by Tax Map Key: 3rd Division, 7-3-43: Portion of 40.

AREA:

Spaces 630-151, 630-152, and 630-153, containing areas of 3,150 square feet, 5,400 square feet, and 3,120 square feet, respectively, shown on the attached Exhibit A.

ZONING:

State Land Use District: Urban & Conservation
County of Hawai'i: Industrial (MG-1a) and Open

LAND TITLE STATUS:

Section 5(a) lands of the Hawai'i Admission Act: Ceded
DHHL 30% entitlement lands pursuant to Hawai'i Admission Act YES ___ NO X

BLNR – ISSUANCE OF A REVOCABLE PERMIT TO AEKO KULA, LLC DBA ALOHA
AIR CARGO FOR THE PURPOSE OF CARGO RAMP SPACE FOR EQUIPMENT
STORAGE

Page 2

CURRENT USE STATUS:

Airport and aeronautical purposes.

CHARACTER OF USE:

AAC will use the spaces as part of its cargo operations.

COMMENCEMENT DATE:

Upon execution of the revocable permit.

MONTHLY RENTAL:

\$1,507.38 (as determined from the DOTA schedule of rates and charges established by appraisal of Airports property statewide).

SECURITY DEPOSIT:

\$4,522.14 or three times the monthly rental in effect

HOLDOVER TENANCY:

\$50.25

DCCA VERIFICATION:

Place of business registration confirmed:	YES <u>X</u>	NO _____
Registered business name confirmed:	YES <u>X</u>	NO _____
Good standing confirmed:	YES <u>X</u>	NO _____

CHAPTER 343, HRS - ENVIRONMENTAL ASSESSMENT:

Pursuant to Section 11-200-8(a), Environmental Impact Statement Rules of the Department of Health, State of Hawai‘i, this disposition is exempt from requirements regarding preparation of an environmental assessment, negative declaration, or environmental impact statement as required by Chapter 343, Hawai‘i Revised Statutes, as amended, relating to Environmental Impact Statements, because the proposed action falls within Exemption Class #1, Comprehensive Exemption List for the State of Hawai‘i, Department of Transportation, dated November 15, 2000, as approved by the Environmental Quality Council. Exemption Class #1 covers operations, repairs, or maintenance of existing structures, facilities, equipment, or topographical features involving negligible or no expansion or change of use beyond that previously existing.

BLNR – ISSUANCE OF A REVOCABLE PERMIT TO AEKO KULA, LLC DBA ALOHA
AIR CARGO FOR THE PURPOSE OF CARGO RAMP SPACE FOR EQUIPMENT
STORAGE

Page 3

The DOTA consulted with the U.S. Federal Aviation Administration as to the appropriateness of the citation of the Environmental Exemption Class from the Comprehensive list for the Department of Transportation dated November 15, 2000. In this case, the FAA concurred on the appropriateness.

REMARKS:

In accordance with Section 171-55 HRS, relating to Permits, the Department of Transportation proposes to issue a month-to-month revocable permit to AAC for its cargo operations at KOA.

RECOMMENDATION:

That the Board authorize the Department of Transportation to issue a month-to-month revocable permit to AAC, subject to: (1) terms and conditions herein outlined, which are by reference incorporated herein; and (2) such additional terms and conditions as may be prescribed by the Director of Transportation to best serve the interests of the State.

Respectfully submitted,

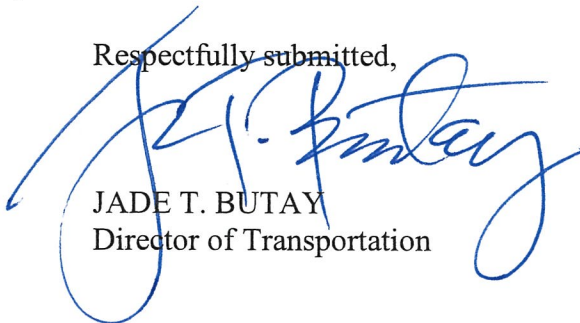

JADE T. BUTAY
Director of Transportation

APPROVED FOR SUBMITTAL:



SUZANNE D. CASE
Chairperson and Member

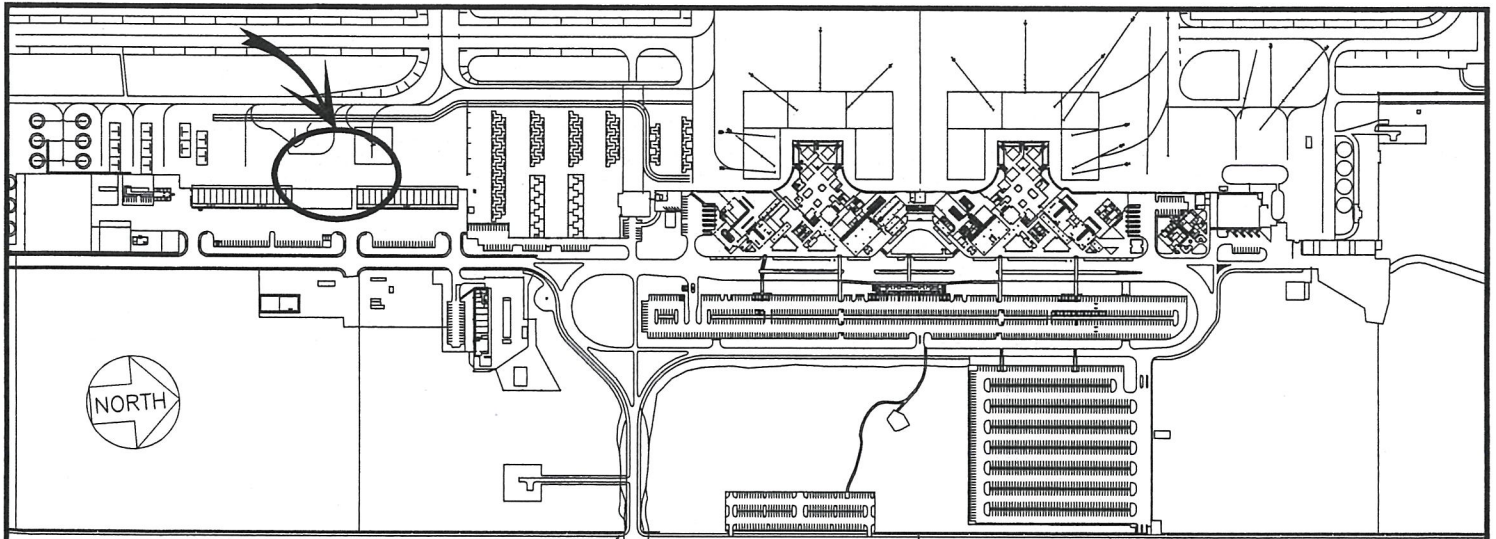

LOCATION PLAN

600:1

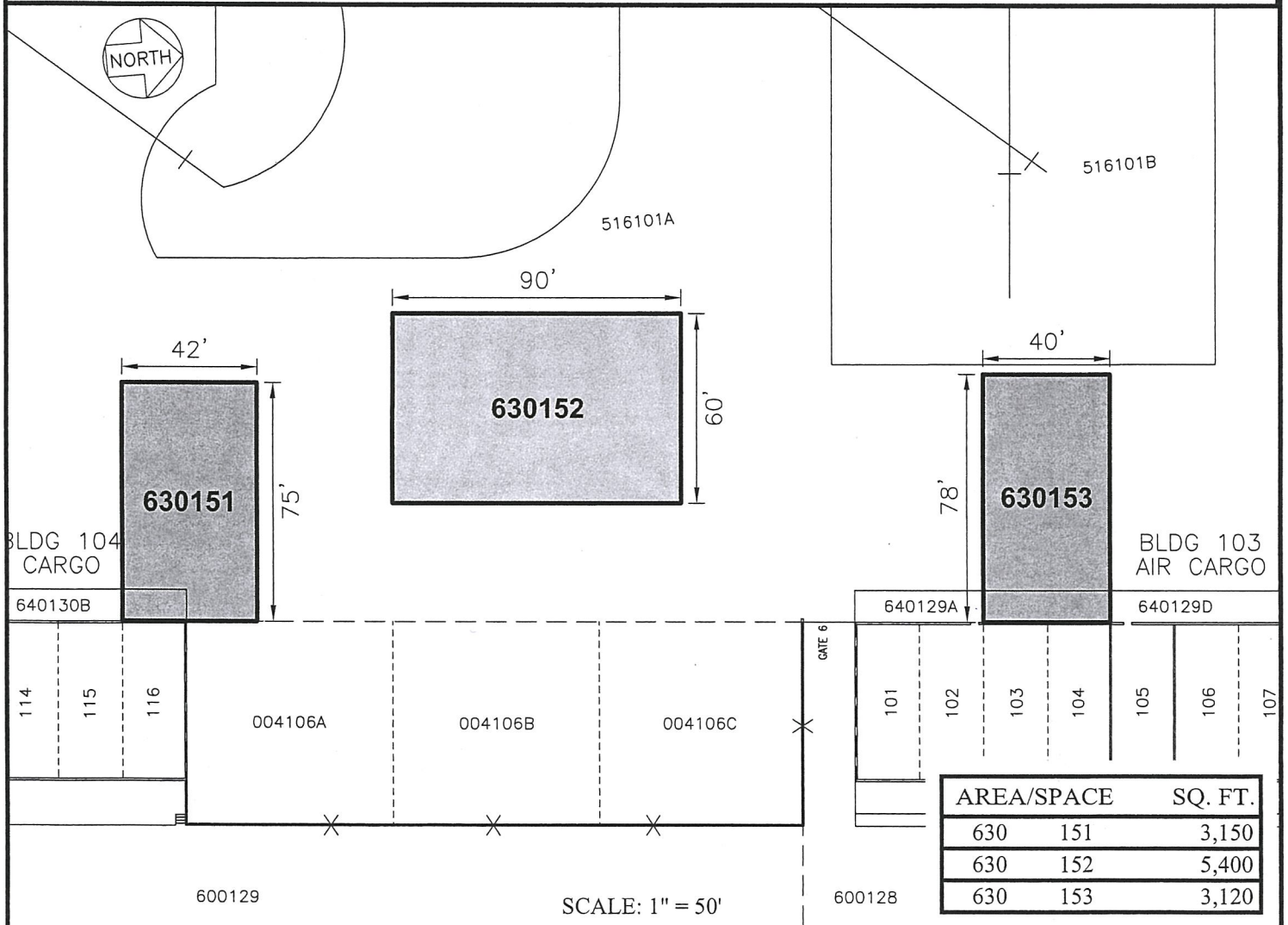

AREA/SPACE	SQ. FT.
630 151	3,150
630 152	5,400
630 153	3,120

RP-8781

DATE : SEPTEMBER 2018

EXHIBIT: **A**



AEKO KULA
dba
ALOHA AIR CARGO

PAVED AREAS
GROUND LEVEL

630151
630152
630153
PLATS C1, 39