



STATE OF HAWAII
DEPARTMENT OF TRANSPORTATION
869 PUNCHBOWL STREET
HONOLULU, HAWAII 96813-5097

JADE T. BUTAY
DIRECTOR

Deputy Directors
LYNN A.S. ARAKI-REGAN
DEREK J. CHOW
ROSS M. HIGASHI
EDWIN H. SNIFFEN

IN REPLY REFER TO:

Board of Land and
Natural Resources
State of Hawai'i
Honolulu, Hawai'i

ISSUANCE OF A REVOCABLE PERMIT FOR A T-HANGAR, FOR THE USE BY
UTILITY HELICOPTER COMPANY PROVIDING SERVICES TO HAWAIIAN
ELECTRIC COMPANY AND MAUI ELECTRIC COMPANY
PACIFIC HELICOPTER TOURS, INC.
KALAELOA AIRPORT
TAX MAP KEY: (1) 9-1-13: PORTION OF 32

O'AHU

REQUEST:

Issuance of a Revocable Permit for a T-Hangar, for the use by utility helicopter company,
Pacific Helicopter Tours, Inc., situated at Kalaeloa Airport.

LEGAL REFERENCE:

Section 171-55, Hawai'i Revised Statutes (HRS).

APPLICANT:

Pacific Helicopter Tours, Inc., whose mailing address is P. O. Box 818, Puunene, Hawai'i
96784.

LOCATION AND TAX MAP KEY:

A portion of Kalaeloa Airport, Kapolei, Island of O'ahu, State of Hawai'i, identified by
Tax Map Keys: 1st Division, 9-1-13: portion of 32.

AREA:

Building/Room No. 410-106, containing an area of approximately 1,763 square feet, as
shown and delineated on the attached map labeled Exhibit "A".

ITEM M-7

BLNR – ISSUANCE OF A REVOCABLE PERMIT FOR T-HANGAR FOR THE USE BY
UTILITY HELICOPTER COMPANY PROVIDING SERVICES TO HAWAIIAN ELECTRIC
COMPANY AND MAUI ELECTRIC COMPANY
PACIFIC HELICOPTER TOURS, INC.
PAGE 2

ZONING:

State Land Use District: Urban
City and County of Honolulu LUO: P-2 (To be rezoned in the future)

LAND TITLE STATUS:

Non-ceded - Section 5(a) lands of the Hawai'i Admission Act
DHHL 30% entitlement lands pursuant to Hawai'i Admission Act YES ___ NO X

CURRENT USE STATUS:

Land presently encumbered by Governor's Executive Order No. 3861, setting aside
Kalaeloa Airport under the control and management of the Department of Transportation,
Airports Division (DOTA), State of Hawai'i, for Airport Purposes.

CHARACTER OF USE:

T-Hangar for the storage and maintenance of aircraft
(1980 Hughes 369D, Tail No. N9FU).

COMMENCEMENT DATE:

To be determined by the Director of Transportation at a later date.

MONTHLY RENTAL:

\$1,939.30, as determined from the DOTA schedule of rates and charges established by
appraisal of Airports property statewide.

SECURITY DEPOSIT:

Three (3) times the monthly rental in effect.

CHAPTER 343, HRS - ENVIRONMENTAL ASSESSMENT:

The subject land area is covered by the Final Environmental Assessment for the Kalaeloa
Airfield Development Plan Improvements, State Project No. AO5011-02 dated June 2010.
This Environmental Assessment was prepared by Wilson Okamoto Corp. for the State of
Hawai'i, Department of Transportation, Airports Division, in part to evaluate the
environmental effects of the recommended Kalaeloa Airfield Master Plan to meet existing
and forecast general aviation demands.

BLNR – ISSUANCE OF A REVOCABLE PERMIT FOR T-HANGAR FOR THE USE BY
UTILITY HELICOPTER COMPANY PROVIDING SERVICES TO HAWAIIAN ELECTRIC
COMPANY AND MAUI ELECTRIC COMPANY
PACIFIC HELICOPTER TOURS, INC.
PAGE 3

REMARKS:

The issuance of a revocable permit to Pacific Helicopter Tours, Inc., for a T-Hangar for the use by utility helicopter company supplying services to Hawaiian Electric Company and Maui Electric Company, at Kalaeloa Airport complies with Chapter 343, Exemption Class 1.D.10 as a continuing aeronautical use, and is in accordance with Section 171-55 HRS, relating to Permits.

RECOMMENDATION:

That the Board authorize the Department of Transportation to issue a month-to-month revocable permit to Pacific Helicopter Tours, Inc., subject to: (1) terms and conditions herein outlined, which are by reference incorporated herein; and (2) such additional terms and conditions as may be prescribed by the Director of Transportation to best serve the interests of the State.

Respectfully submitted,



JADE T. BUTAY
Director of Transportation

APPROVED FOR SUBMITTAL:

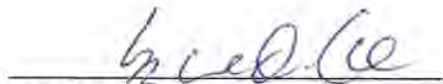

SUZANNE D. CASE
Chairperson and Member

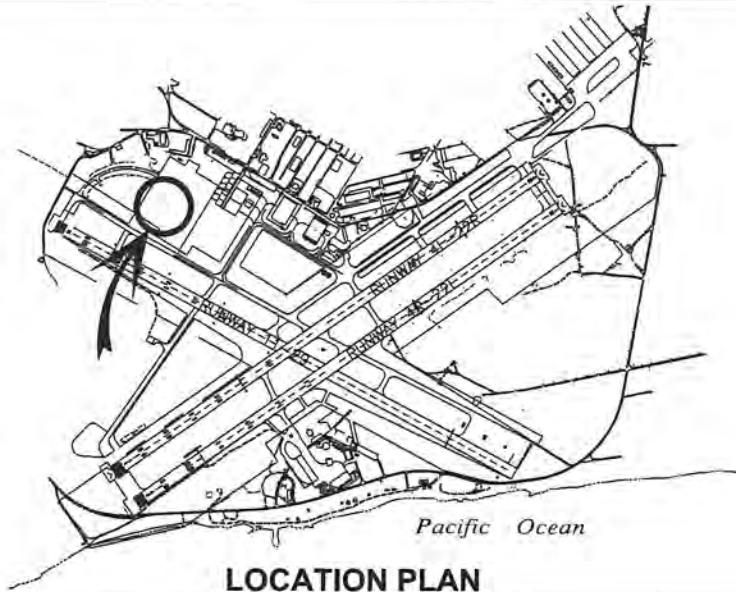

LOCATION PLAN

3000:1

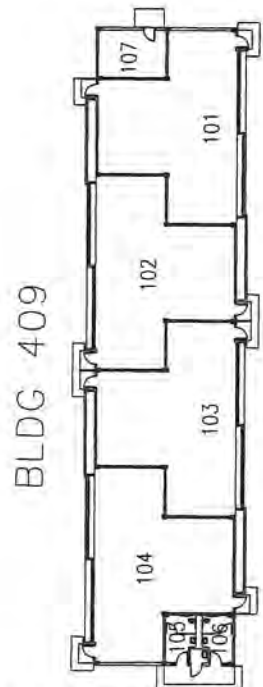
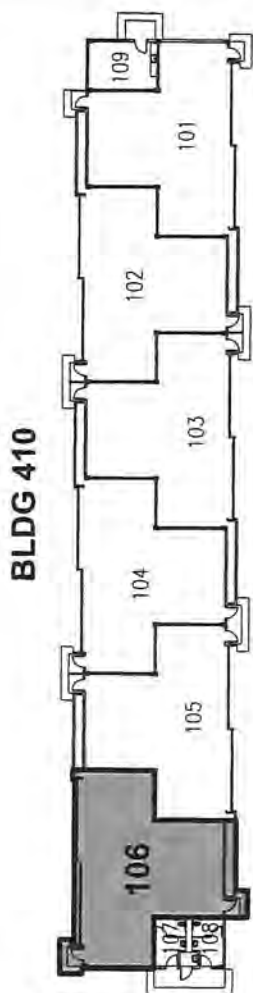

SCALE: 1" = 50'

AREA/SPACE	SQ. FT.
410 106	1,763

RP-8933

DATE : OCTOBER 2019

EXHIBIT: **A**



Airports Division

PACIFIC HELICOPTER TOURS, INC.

GENERAL AVIATION
T-HANGARS

410106

KALAELOA AIRPORT

N:\AIRPORTS\JRF_Kalaeloa\CAD\PM\jrf_410106-01.dwg