



STATE OF HAWAII
DEPARTMENT OF TRANSPORTATION
869 PUNCHBOWL STREET
HONOLULU, HAWAII 96813-5097

JADE T. BUTAY
DIRECTOR

Deputy Directors
LYNN A.S. ARAKI-REGAN
DEREK J. CHOW
ROSS M. HIGASHI
EDWIN H. SNIFFEN

IN REPLY REFER TO:

Board of Land and
Natural Resources
State of Hawai'i
Honolulu, Hawai'i

ISSUANCE OF A REVOCABLE PERMIT
FOR NON-EXCLUSIVE SUBSURFACE PIPELINE EASEMENTS
IES DOWNSTREAM, LLC
DANIEL K. INOUE INTERNATIONAL AIRPORT
TAX MAP KEYS: (1) 1-1-003: 001 (PORTION), (1) 1-1-014:001 (PORTION),
(1) 1-1-014:002 (PORTION) AND (1) 1-1-070 (PORTION)

O'AHU

APPLICANT:

IES Downstream, LLC (IES), whose mailing address is 91-480 Malakole Street,
Kapolei, Hawai'i 96707.

LEGAL REFERENCE:

Section 171-55, Hawai'i Revised Statutes (HRS).

LOCATION:

Subsurface pipeline easements that run through portions of Daniel K. Inouye
International Airport (Airport) property, Island of O'ahu, State of Hawai'i,
identified by Tax Map Keys: 1st Division, 1-1-003: 001 (Portion), 1-1-014:001 (Portion)
1-1-014:002 (Portion) and 1-1-070 (Portion).

AREA:

Non-exclusive subsurface pipeline easements, below the surface of the ground, known as
EAS-B04, EAS-B05, EAS-B07, EAS-B08, EAS-B09, EAS-B10 and EAS-B11,
containing a total area of approximately 63,071 square feet of improved, unpaved land, as
shown and delineated on the attached map labeled Exhibit "A".

ITEM M-1

BLNR – ISSUANCE OF A REVOCABLE PERMIT
FOR NON-EXCLUSIVE SUBSURFACE PIPELINE EASEMENTS
IES DOWNSTREAM, LLC
Page 2

ZONING:

State Land Use District: Urban
City and County of Honolulu LUO: Industrial (I-2)

LAND TITLE STATUS:

Non-Ceded - Section 5(a) lands of the Hawai'i Admission Act
DHHL 30% entitlement lands pursuant to Hawai'i Admission Act YES ___ NO X

CURRENT USE STATUS:

Land presently encumbered by Governor's Executive Order Nos. 3201 and 3894, setting aside a portion of the Airport under the control and management of the State of Hawai'i, Department of Transportation, Airports Division (DOTA) for Airport Purposes.

CHARACTER OF USE:

IES will use and maintain the subsurface pipeline easements for existing fuel line purposes.

COMMENCEMENT DATE:

To be determined by the Director of Transportation at a later date.

MONTHLY RENTAL:

\$14,926.80, based on Airports Departmental Staff Manual, Chapter 8.3.06 (Easement Rental), and the improved, unpaved land, as determined from the DOTA schedule of rates and charges established by appraisal of Airports property statewide.

SECURITY DEPOSIT:

Three (3) times the monthly rental in effect.

CHAPTER 343, HRS - ENVIRONMENTAL ASSESSMENT:

Pursuant to Section 11-200-8(a), Environmental Impact Statement Rules of the Department of Health, State of Hawai'i, this disposition is exempt from requirements regarding preparation of an environmental assessment, negative declaration, or environmental impact statement as required by Chapter 343, HRS, as amended, relating

BLNR – ISSUANCE OF A REVOCABLE PERMIT
FOR NON-EXCLUSIVE SUBSURFACE PIPELINE EASEMENTS
IES DOWNSTREAM, LLC

Page 3

to Environmental Impact Statements, because the proposed action falls within Exemption Class #1, Comprehensive Exemption List for the State of Hawai‘i, Department of Transportation, dated November 15, 2000, as approved by the Environmental Quality Council. Exemption Class #1 covers operations, repairs, or maintenance of existing structures, facilities, equipment, or topographical features involving negligible or no expansion or change of use beyond that previously existing.

The DOTA consulted with the U.S. Federal Aviation Administration as to the appropriateness of the citation of the Environmental Exemption Class from the Comprehensive list for the Department of Transportation dated November 15, 2000. The FAA concurred on the appropriateness.

REMARKS:

In accordance with Section 171-55, HRS, relating to Permits, the Department of Transportation proposes to issue a month-to-month revocable permit to IES for the use of non-exclusive subsurface pipeline easements for existing fuel line purposes at the Airport.

RECOMMENDATION:

That the Board authorize the Department of Transportation to issue a month-to-month revocable permit to IES, subject to: (1) terms and conditions herein outlined, which are by reference incorporated herein; and (2) such additional terms and conditions as may be prescribed by the Director of Transportation to best serve the interests of the State.

Respectfully submitted,



JADE T. BUTAY
Director of Transportation

APPROVED FOR SUBMITTAL:

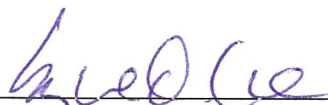

SUZANNE D. CASE
Chairperson and Member

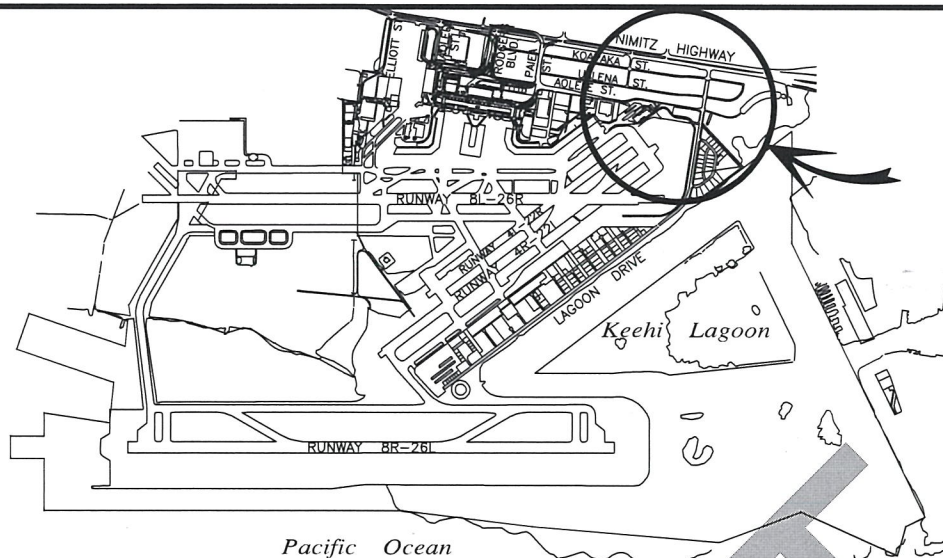

LOCATION PLAN

5000:1

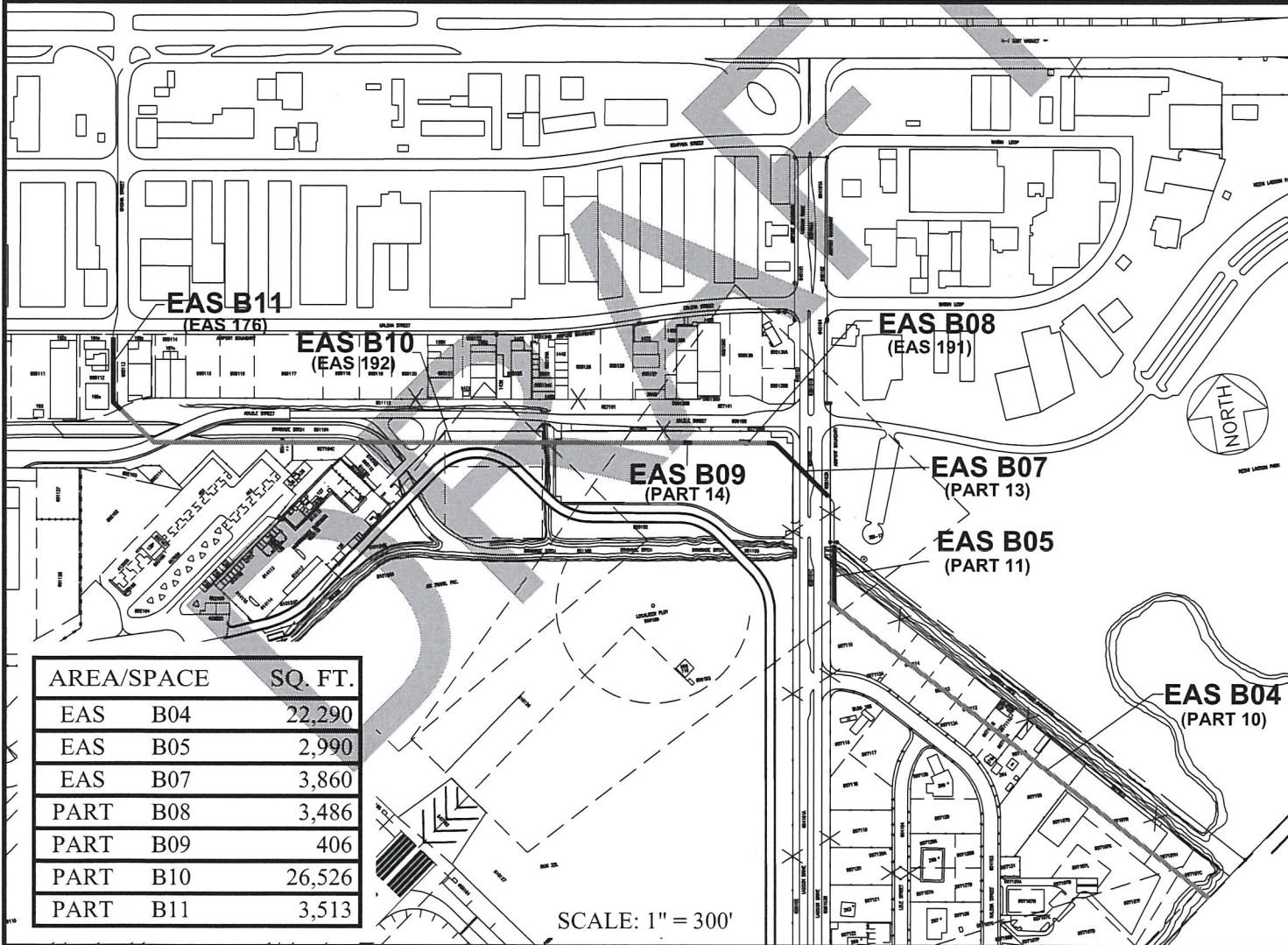

DATE : NOVEMBER 2019

EXHIBIT: **A**



Airports Division

IES DOWNSTREAM, LLC

FUEL EASEMENT
PIPELINES
AOELE, KALEWA STREETS

EAS B04-
EAS B11
PLAT 26,27