



STATE OF HAWAII
DEPARTMENT OF TRANSPORTATION
869 PUNCHBOWL STREET
HONOLULU, HAWAII 96813-5097

Board of Land and Natural Resources
State of Hawaii
Honolulu, Hawaii

OAHU

ISSUANCE OF CONSTRUCTION RIGHT-OF-ENTRY TO HAWAII FUELING FACILITIES CORPORATION, TO PERFORM WORK ON HARBORS LANDS TO INSTALL PIPELINE WITHIN A PORTION OF THE HIGHWAY DIVISION'S PROPERTY AT SAND ISLAND ACCESS ROAD, HONOLULU HARBOR, OAHU, TAX MAP KEY NOS. (1) 1-2-025: PORTIONS OF 17, 74, 75, 119, AND 121, GOVERNOR'S EXECUTIVE ORDER NOS. 4206, 4574, AND 4596

LEGAL REFERENCE:

Sections 171-6, 171-13, 171-17, 171-55, and 171-59, Hawaii Revised Statutes (HRS), as amended.

APPLICANT:

Hawaii Fueling Facilities Corporation (Applicant) is a domestic profit corporation whose business registration and mailing address is 745 Fort Street, Suite 1500, Honolulu, Hawaii 96813.

CHARACTER OF USE:

To allow the Applicant and its permitted agents (assignees, contractors, sub-contractors, and agents) the right, privilege, and authority to temporarily enter to construct, maintain and repair temporary improvements, to support Applicants work to install a new pipeline in the Highway Division's Right-of-Way, subject to the terms and conditions as indicated below.

LOCATION:

Portion of Government land located in Kapalama, Honolulu, Oahu, identified by Tax Map Key Nos. (1) 1-2-025: Portions of 17, 74, 75, 119 and 121, Governor's Executive Order Nos. 4206, 4574, and 4596, see attached Exhibit A.

AREA: See attached Exhibits A, B, and C

A twenty-five (25) foot wide strip of land, approximately 1,100 feet long, totaling approximately 27,500 square feet, more or less.

CONSIDERATION:

Gratis

ZONING:

State Land Use Commission:	Urban
City and County of Honolulu:	I-3 (Waterfront Industrial District)

TERM OF RIGHT-OF-ENTRY:

Twelve (12) months, with the option to extend the term an additional six (6) months, as needed and as approved by the Director of Transportation.

COMMENCEMENT DATE:

To be determined by the Director of Transportation.

TRUST LAND STATUS:

Subsections 5(b) and 5(e) of the Hawaii Admission Act (Ceded Lands).

CURRENT USE STATUS:

Encumbered by Governor's Executive Order Nos. 4206, 4574, and 4596.

LAND TITLE STATUS:

Acquired by the Department of Transportation, Harbors Division (DOT Harbors), through eminent domain proceedings by issuance of Governor's Executive Order Nos. 4206, 4574, and 4596.

CHAPTER 343 - ENVIRONMENTAL ASSESSMENT:

The Final Environmental Assessment Notice of Finding of No Significant Impact regarding the Kapalama Container Terminal (KCT) and Tenant Relocations for the subject projects described in the Remarks section below, and the work associated with this request for Construction Right-of-Entry (CROE), was published with the Office of Environmental Quality Control on Page 9 of the March 8, 2018 edition of *The Environmental Notice*.

REMARKS:

With the development of the KCT, the Applicant is constructing a redundant loading and unloading of jet fuel hatch and pipelines at the new KCT pier for pipeline connections to the Applicant's existing storage tanks at Keehi Lagoon. The Applicant will be constructing these new facilities.

The Applicant has consulted and coordinated with DOT Harbors and DOT Highways for the bracing placement details and timing, in relation to the H.C. 10502 project and DOT Harbors has no objection to the work subject to the conditions stated below.

Right-of-Entry:

Staff recommends that the Board authorize the issuance of a CROE, to the Applicant, for a period of one (1) year. DOT Harbors recommends that the CROE include the following conditions:

It is DOT Harbors' understanding that the Applicant (and their sub-consultant, BMCD) will need the right-of-entry to lands under DOT Harbors jurisdiction to construct the new connecting pipelines ahead of the KCT construction within the Sand Island Access Road Right-of-Way. Conducting the work ahead of Phase II of the KCT project minimizes impacts to the DOT Harbors construction project.

RECOMMENDATION:

That the Board authorize the DOT Harbors to issue the Applicant and its permitted agents a CROE for the subject area for the purposes cited above, subject to the terms and conditions outlined above and incorporated herein by reference, and such terms and conditions as may be prescribed by the Director of Transportation to best serve the interests of the State.

Respectfully submitted,



for JADE T. BUTAY
Director of Transportation

APPROVED FOR SUBMITTAL:



SUZANNE D. CASE
Chairperson and Member
Board of Land and Natural Resources

Attachments: Exhibits A, B, and C

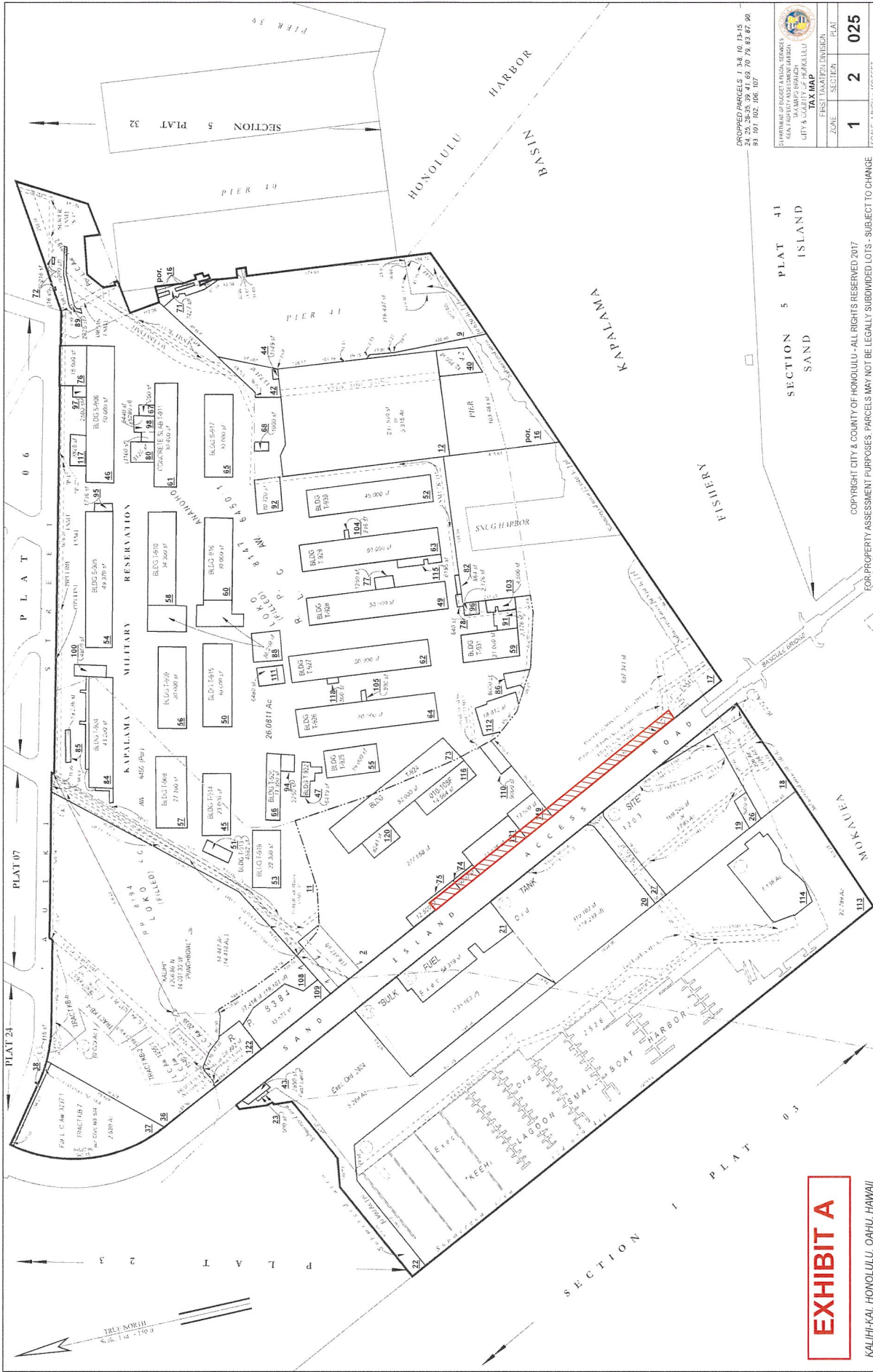

DROPPED PARCELS 1, 5, 8, 10, 13-15
 24, 25, 26-28, 29, 41, 69, 70, 78, 83, 87, 90
 93, 101, 102, 106, 107

DEPARTMENT OF EDUCATION, SERVICES HONOLULU KAPALAMA BRANCH CITY & COUNTY OF HONOLULU TAX MAP			
ZONE	SECTION	PLAT	
1	2	025	
FIRST EDITION JUNE 1987			

SECTION 5 PLAT 41
 SAND ISLAND

COPYRIGHT CITY & COUNTY OF HONOLULU - ALL RIGHTS RESERVED 2017
 FOR PROPERTY ASSESSMENT PURPOSES, PARCELS MAY NOT BE LEGALLY SUBDIVIDED LOTS - SUBJECT TO CHANGE

EXHIBIT A

KAPALAMA, HONOLULU, OAHU, HAWAII



July 10, 2018

Deputy Director Darrell T. Young
State of Hawaii Department of Transportation – Harbors Division
Harbors Division
79 South Nimitz Highway
Honolulu, HI 96813

Re: Construction Right-of-Entry, HFFC Kapalama Jet Fuel Pipeline – Road Package

Dear Mr. Young:

Burns & McDonnell Engineering Company, Inc. (BMcD) has been commissioned by Hawaii Fueling Facilities Corporation (HFFC) to construct an 18” jet fuel pipeline from HFFC’s Sand Island Fuel Facility to a new load/unload vault on the new Kapalama Container Terminal. This project has been broken up into a Road and Wharf package, the former of which we cordially request permission for Construction Right-of-Entry (CROE) on DOT-Harbors property. Please see below for pertinent information for the project. CROE will be requested for the Wharf package at a later date. If you have any questions or comments, please contact myself at 808-824-0817 or bseabaugh@burnsmcd.com.

Project Description

This project will construct a new 18” jet fuel pipeline at the HFFC Sand Island Fuel Facility and within the Sand Island Access Road Right of Way. In general, this project consists of the following Scope of Work: demolition, excavation, concrete, asphalt, piping, electrical/cathodic protection, valves, and traffic control. Please see Attachment 1 for further details.

Project Location

The project site is generally within the Sand Island Access Road Right-of-Way. Please see Attachment 1 for further details.

Project Schedule

The anticipated schedule for the project is August 2018 - May 2019.

Sincerely,

A handwritten signature in blue ink that reads "Brian A. Seabaugh".

Brian Seabaugh
Project Manager

Enclosures:

Attachment 1 - Kapalama Rd Pckge - DOT Highways Comments Clouded - 09Jul2018

EXHIBIT B

Hawaii Fueling Facilities Corporation
Request for Construction Right-of-Entry

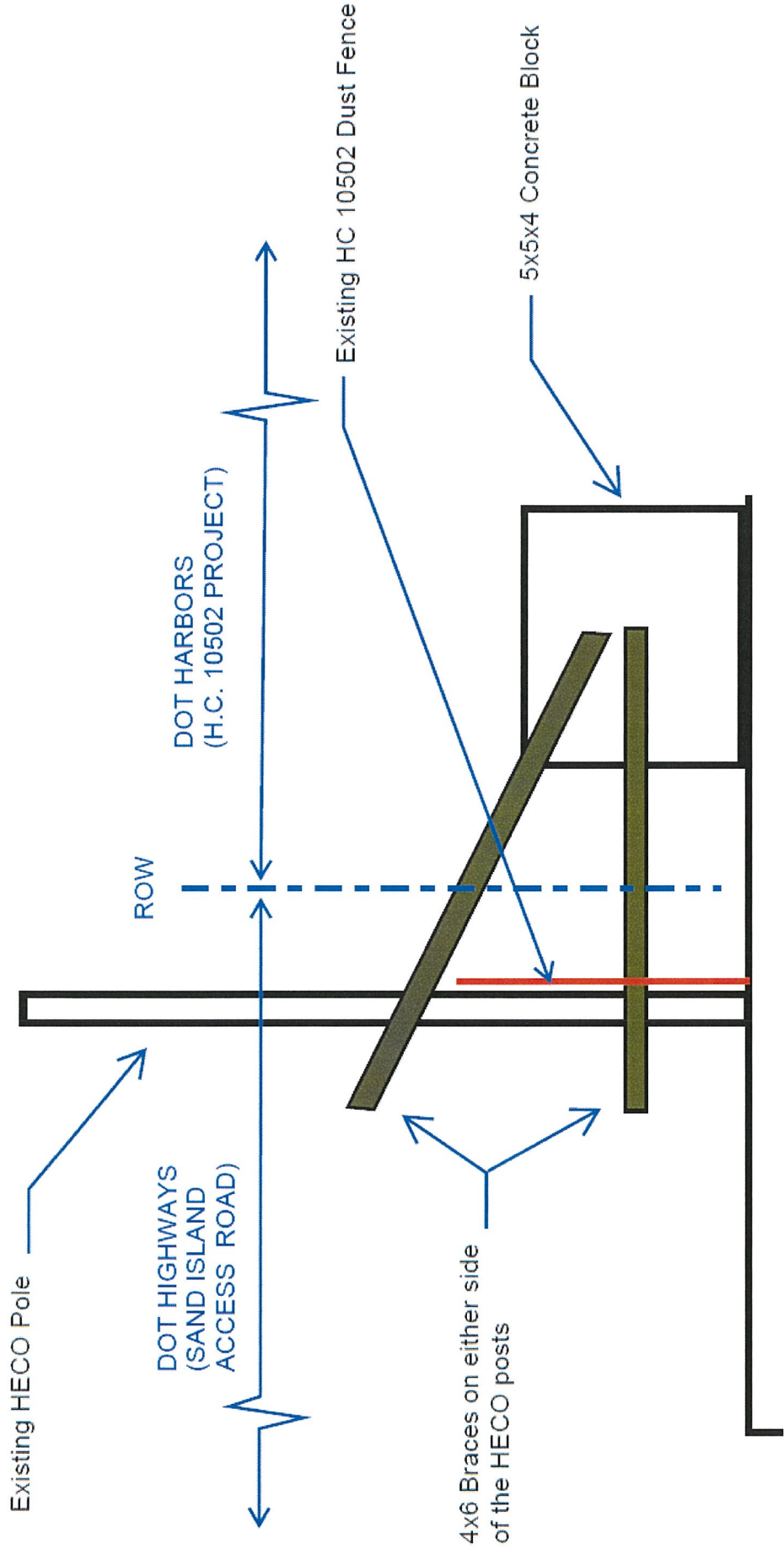

[Handwritten Signature]

Signature:

Email: LYNN.ARAKI-REGAN@HAWAII.GOV

EXHIBIT C