

DAVID Y. IGE
GOVERNOR



STATE OF HAWAII
DEPARTMENT OF TRANSPORTATION
869 PUNCHBOWL STREET
HONOLULU, HAWAII 96813-5097

JADE T. BUTAY
DIRECTOR

Deputy Directors
LYNN A. S. ARAKI-REGAN
DEREK J. CHOW
ROSS M. HIGASHI
EDWIN H. SNIFFEN

IN REPLY REFER TO:

Board of Land and
Natural Resources
State of Hawai'i
Honolulu, Hawai'i

ISSUANCE OF A REVOCABLE PERMIT FOR OFFICE SPACES
HAWAIIAN AIRLINES, INC.

KAHULUI AIRPORT

MAUI

TAX MAP KEYS: (2) 3-8-01: 240 (PORTION) AND (2) 3-8-01: 260 (PORTION)

LEGAL REFERENCE:

Sections 171-11 and 171-55, Hawai'i Revised Statutes (HRS).

APPLICANT:

Hawaiian Airlines, Inc. (HAL), whose business address is PO Box 30008, Honolulu, Hawai'i 96820.

LOCATION AND TAX MAP KEY:

Portion of Kahului Airport, Kahului, Island of Maui, identified by
Tax Map Keys: 2nd Division, 3-8-01: 240 (Portion) and 3-8-01: 260 (Portion).

AREAS:

Building/Room No. 342-115, containing an area of approximately 1,758 square feet,
Building/Room No. 344-105, containing an area of approximately 710 square feet, and
Building/Room No. 344-107, containing an area of approximately 1,350 square feet, as
shown on the attached Exhibit A.

ZONING:

State Land Use District: Urban
County of Maui: Airport

ITEM M-6

LAND TITLE STATUS:

Section 5(a) lands of the Hawai'i Admission Act: Non-Ceded
DHHL 30% entitlement lands pursuant to Hawai'i Admission Act YES ___ NO X

CURRENT USE STATUS:

Airport and aeronautical purposes.

CHARACTER OF USE:

Office spaces for airline operations.

COMMENCEMENT DATE:

Upon complete execution of the revocable permit.

MONTHLY RENTAL:

\$29,716.77 (as determined from the DOTA Signatory Carrier Rates and Charges, Hawai'i Airports System, effective July 1, 2019).

SECURITY DEPOSIT:

Three times the monthly rental in effect.

DCCA VERIFICATION:

Place of business registration confirmed:	YES <u>X</u>	NO _____
Registered business name confirmed:	YES <u>X</u>	NO _____
Good standing confirmed:	YES <u>X</u>	NO _____

CHAPTER 343, HRS - ENVIRONMENTAL ASSESSMENT:

Pursuant to Section 11-200-8(a), Environmental Impact Statement Rules of the Department of Health, State of Hawai'i, this disposition is exempt from requirements regarding preparation of an environmental assessment, negative declaration, or environmental impact statement as required by Chapter 343, Hawai'i Revised Statutes, as amended, relating to Environmental Impact Statements, because the proposed action falls within Exemption Class #1, Comprehensive Exemption List for the State of Hawai'i, Department of Transportation, dated November 15, 2000, as approved by the Environmental Quality Council. Exemption Class #1 covers operations, repairs, or

BLNR – ISSUANCE OF A REVOCABLE PERMIT FOR OFFICE SPACES
HAWAIIAN AIRLINES, INC.

Page 3

maintenance of existing structures, facilities, equipment, or topographical features involving negligible or no expansion or change of use beyond that previously existing.

The DOTA consulted with the U.S. Federal Aviation Administration as to the appropriateness of the citation of the Environmental Exemption Class from the Comprehensive list for the Department of Transportation dated November 15, 2000. In this case, the FAA concurred on the appropriateness.

REMARKS:

The Department of Transportation (DOT) has no objections to HAL's request and therefore, in accordance with Sections 171-11 and 171-55, HRS, relating to Public Purposes and Permits, respectively and therefore, the DOT proposes to issue a month-to-month revocable permit to HAL for spaces in the Main Terminal to be used as offices for its airline operation.

RECOMMENDATION:

That the Board authorize the Department of Transportation to issue a month-to-month revocable permit to HAL, subject to: (1) terms and conditions herein outlined, which are by reference incorporated herein; and (2) such additional terms and conditions as may be prescribed by the Director of Transportation to best serve the interests of the State.

Respectfully submitted,

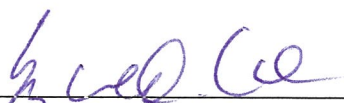

JADE T. BUTAY
Director of Transportation

APPROVED FOR SUBMITTAL:

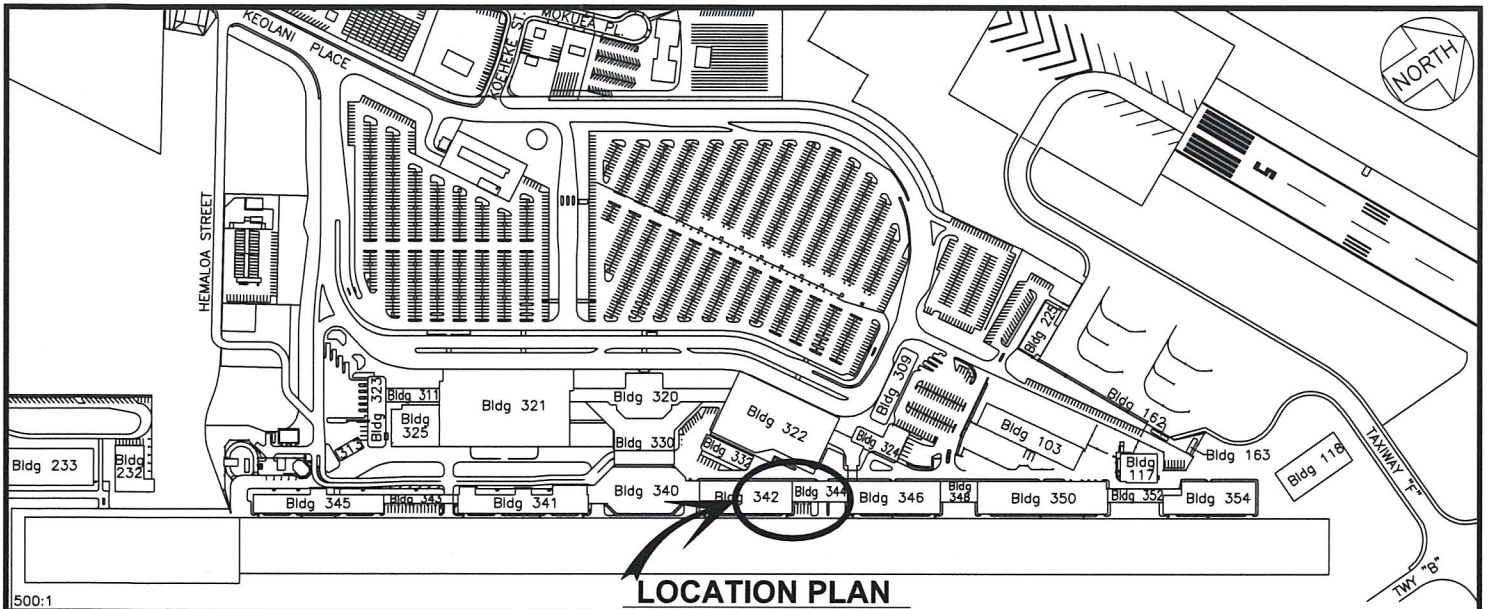
SUZANNE D. CASE
Chairperson and Member

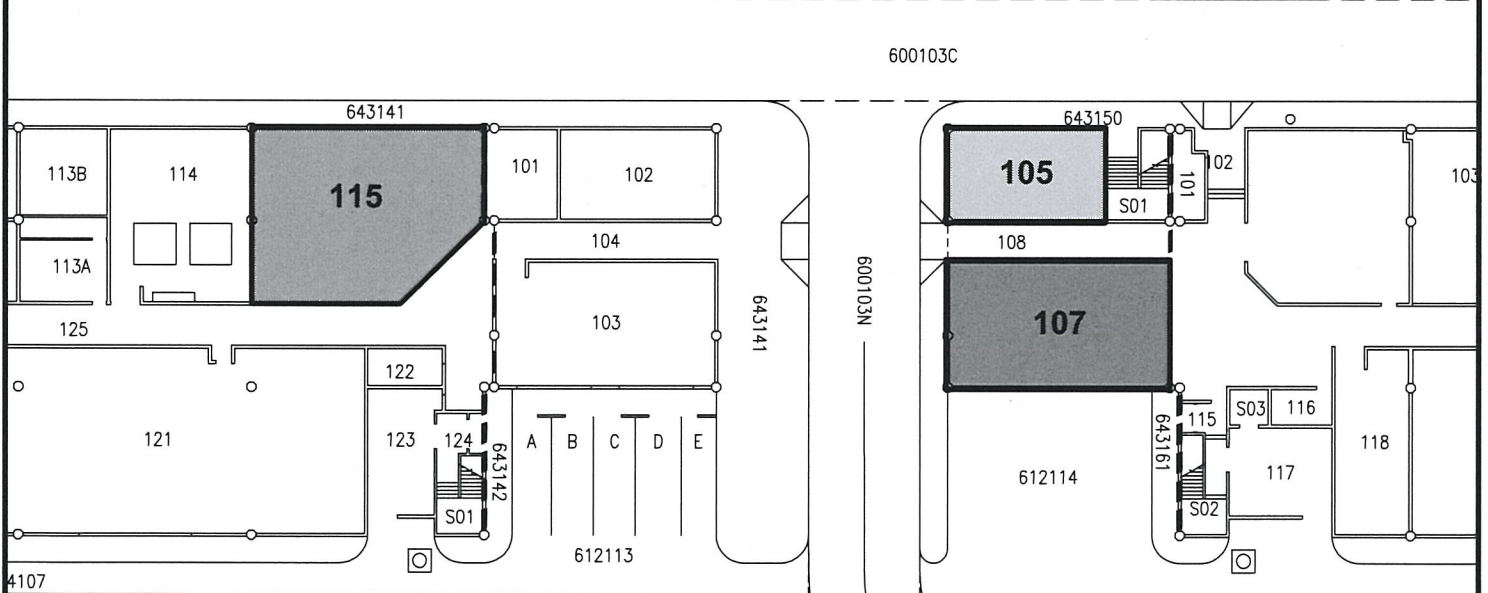
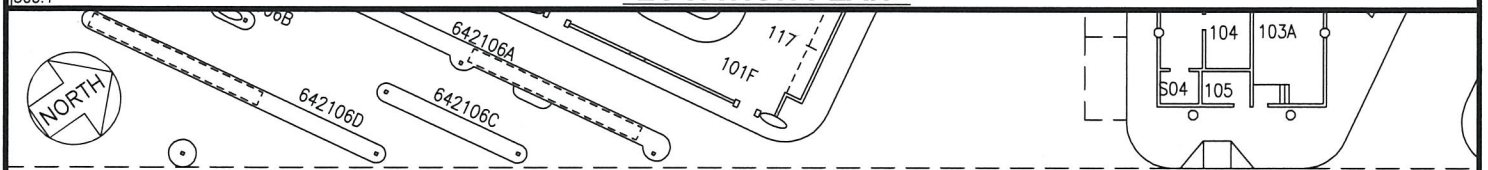

LOCATION PLAN



Holding Rooms C
BLDG 342

Concourse
BLDG 344

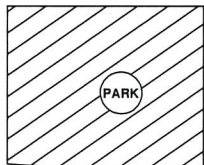

SCALE: 1" = 40'

BLDG/ROOM	SQ. FT.
342 115	1,758
344 105	710
344 107	1,350

RP-8929

DATE : SEPTEMBER 2019

EXHIBIT: **A**



Airports Division

HAWAIIAN AIRLINES, INC.

BUILDING 342 & 344
HOLDING ROOM & CONCOURSE
GROUND LEVEL

342115
344105
344107
PLATS A1, 35