

DAVID Y. IGE  
GOVERNOR

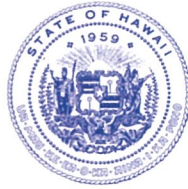

**STATE OF HAWAII**  
**DEPARTMENT OF TRANSPORTATION**  
869 PUNCHBOWL STREET  
HONOLULU, HAWAII 96813-5097

JADE T. BUTAY  
DIRECTOR

Deputy Directors  
LYNN A.S. ARAKI-REGAN  
DEREK J. CHOW  
ROSS M. HIGASHI  
EDWIN H. SNIFFEN

IN REPLY REFER TO:

Board of Land and  
Natural Resources  
State of Hawaii  
Honolulu, Hawaii

ISSUANCE OF A REVOCABLE PERMIT FOR OFFICE SPACE  
K & S HELICOPTERS, INC. DBA PARADISE HELICOPTERS  
HANA AIRPORT  
TAX MAP KEY: (2) 1-3-003-022 (PORTION)

MAUI

LEGAL REFERENCE:

Section 171-55, Hawaii Revised Statutes (HRS).

APPLICANT:

K & S Helicopters, Inc. DBA Paradise Helicopters (KSH), whose business address is  
P.O. Box 5371, Kailua-Kona, Hawaii 96745.

LOCATION AND TAX MAP KEY:

Hana Airport (HNM), Island of Maui, identified by  
Tax Map Key: 2nd Division, 1-3-003-022 (portion).

AREA:

Building/Room No. 301-102B, containing an area of approximately 45 square  
feet, as shown and delineated on the attached Exhibit A.

ZONING:

State Land Use District: Agricultural  
County of Maui: Airport

**ITEM M-10**

LAND TITLE STATUS:

Section 5(a), Hawaii Admissions Act: (Ceded Land)  
DHHL, 30% entitlement lands: Yes \_\_\_\_\_ No X

CURRENT USE STATUS:

Airport and aeronautical purposes.

CHARACTER OF USE

KSH will use the terminal space for an office in support of their helicopter tour operations at Hana Airport.

COMMENCEMENT DATE:

Upon complete execution of the revocable permit.

MONTHLY RENT:

\$54.11 (\$29.81, as determined from the DOTA schedule of rates and charges established by appraisal of Airports property statewide plus \$17.55 for electricity and \$6.75 for maintenance).

SECURITY DEPOSIT:

Three (3) times the monthly rental in effect.

DCCA VERIFICATION:

Place of business registration confirmed:	YES <u>X</u>	NO _____
Registered business name confirmed:	YES <u>X</u>	NO _____
Good standing confirmed:	YES <u>X</u>	NO _____

CHAPTER 343, HRS - ENVIRONMENTAL ASSESSMENT:

Pursuant to Section 11-200-8(a), Environmental Impact Statement Rules of the Department of Health, State of Hawaii, this disposition is exempt from requirements regarding preparation of an environmental assessment, negative declaration, or environmental impact statement as required by Chapter 343, Hawaii Revised Statutes, as amended, relating to Environmental Impact Statements, because the proposed action falls within Exemption Class #1, Comprehensive Exemption List for the State of Hawaii, Department of Transportation, dated November 15, 2000, as approved by the Environmental Quality Council. Exemption Class #1 covers operations, repairs, or

maintenance of existing structures, facilities, equipment, or topographical features involving negligible or no expansion or change of use beyond that previously existing.

The DOTA consulted with the U.S. Federal Aviation Administration as to the appropriateness of the citation of the Environmental Exemption Class from the Comprehensive list for the Department of Transportation dated November 15, 2000. In this case, the FAA concurred on the appropriateness.

REMARKS:

In accordance with Section 171-55, HRS, relating to Permits, the Department of Transportation (DOT) proposes to issue a month-to-month revocable permit to KSH for terminal office space in support of its helicopter tour operations at Hana Airport. DOT has no objections to KSH's request.

RECOMMENDATION:

That the Board authorize the Department of Transportation to issue a month-to-month revocable permit to KSH, subject to: (1) terms and conditions herein outlined, which are by reference incorporated herein; and (2) such additional terms and conditions as may be prescribed by the Director of Transportation to best serve the interests of the State.

Respectfully submitted,

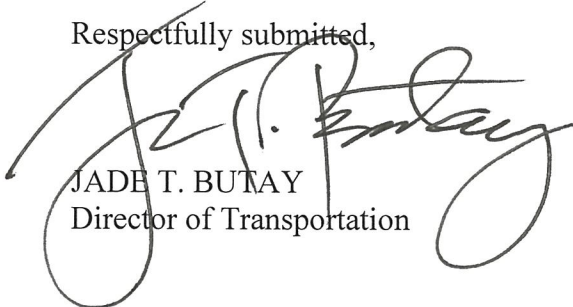
  
JADE T. BUTAY  
Director of Transportation

APPROVED FOR SUBMITTAL:

  
SUZANNE D. CASE  
Chairperson and Member

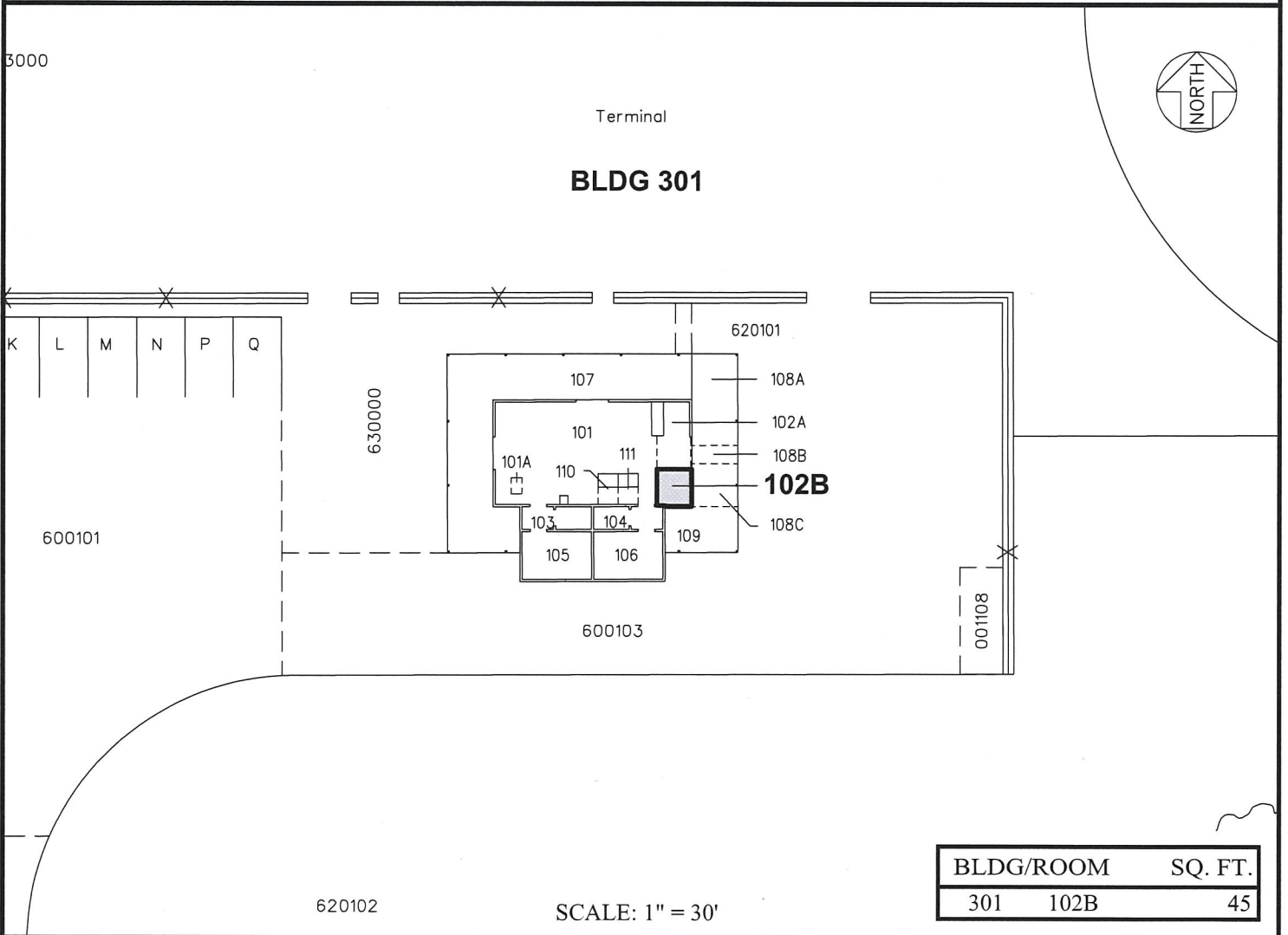
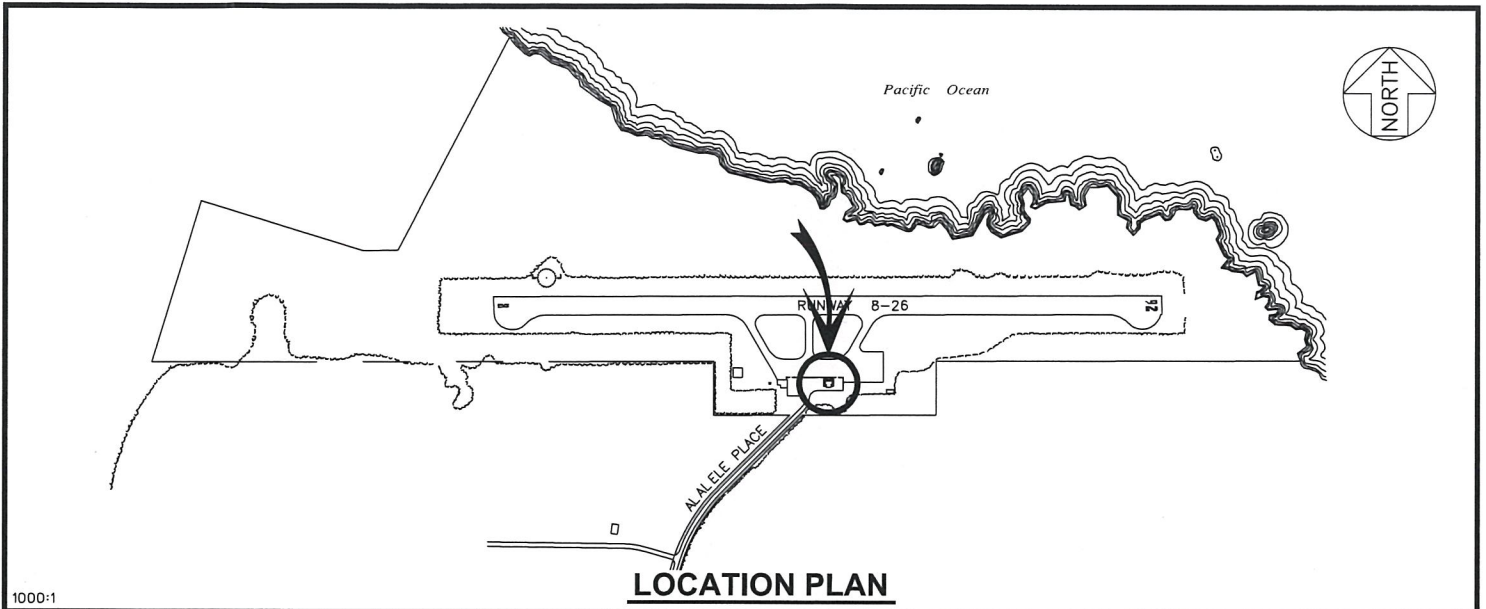

RP-8948	DATE : NOVEMBER 2019	EXHIBIT: <b>A</b>
	K & S HELICOPTERS, INC.	BUILDING 301 TERMINAL GROUND LEVEL
		301102B PLAT A1, 33

**HANA AIRPORT**