

**STATE OF HAWAII**  
**DEPARTMENT OF TRANSPORTATION**  
869 PUNCHBOWL STREET  
HONOLULU, HAWAII 96813-5097

JADE T. BUTAY  
DIRECTOR

Deputy Directors  
LYNN A.S. ARAKI-REGAN  
DEREK J. CHOW  
ROSS M. HIGASHI  
EDWIN H. SNIFFEN

IN REPLY REFER TO:

Board of Land and  
Natural Resources  
State of Hawaii  
Honolulu, Hawaii

ISSUANCE OF A REVOCABLE PERMIT FOR A RAMP OFFICE, FLEX UNIT,  
EQUIPMENT PARKING, AND KIOSK SPACES  
HAWAIIAN AIRLINES, INC.  
ELLISON ONIZUKA KONA INTERNATIONAL AIRPORT AT KEAHOLE  
TAX MAP KEY: (3) 7-3-43:003 (PORTION)

HAWAII

LEGAL REFERENCE:

Section 171-55, Hawaii Revised Statutes (HRS).

APPLICANT:

Hawaiian Airlines, Inc., (HA) whose business address is 3375 Koapaka St., Suite G350,  
Honolulu, Hawaii 96819.

LOCATION AND TAX MAP KEY:

Portion of Ellison Onizuka Kona International Airport at Keāhole (KOA), Kailua-Kona, Island  
of Hawaii, identified by Tax Map Key: 3rd Division, 7-3-43:003 (Portion).

AREA:

Building/Room No. 311-116, containing an area of approximately 359 square feet,  
as shown and delineated on the attached Exhibit A.

Area/Space No. 630-133, containing an area of approximately 8,550 square feet;  
Area/Space No. 630-138, containing an area of approximately 2,010 square feet; and  
Area/Space No. 630-139, containing an area of approximately 1,140 square feet,  
as shown and delineated on the attached Exhibit B.

Area/Space No. 630-141G, containing an area of approximately 640 square feet,  
as shown and delineated on the attached Exhibit C.

**ITEM M-12**

BLNR – ISSUANCE OF A REVOCABLE PERMIT FOR A RAMP OFFICE, FLEX UNIT,  
EQUIPMENT PARKING, AND KIOSK SPACES  
HAWAIIAN AIRLINES, INC.

Page 2

ZONING:

State Land Use District: Urban & Conservation  
County of Hawaii: Industrial (MG-1a) and Open

LAND TITLE STATUS:

Section 5(b) lands of the Hawaii Admission Act: Ceded  
DHHL 30% entitlement lands pursuant to Hawaii Admission Act YES \_\_\_ NO X

CURRENT USE STATUS:

Airport and aeronautical purposes.

CHARACTER OF USE:

HA will use the spaces for a ramp office, flex unit, equipment parking, and kiosks as part of their Signatory Carrier Operations at KOA.

COMMENCEMENT DATE:

Upon execution of the revocable permit.

MONTHLY RENTAL:

\$4,544.65 (\$2,016.68 as determined from the Airports Division Signatory Carrier Rates and Charges, Hawaii Airports System, effective July 1, 2019, and \$2,118.37 based on a rate of \$2.06 per square foot per annum for improved, paved land, as determined from the DOTA schedule of rates and charges established by appraisal of Airports property statewide, plus \$409.60 for electricity and air conditioning).

SECURITY DEPOSIT:

\$13,633.95 or three (3) times the monthly rental in effect.

DCCA VERIFICATION:

Place of business registration confirmed:	YES <u>X</u>	NO _____
Registered business name confirmed:	YES <u>X</u>	NO _____
Good standing confirmed:	YES <u>X</u>	NO _____

BLNR – ISSUANCE OF A REVOCABLE PERMIT FOR A RAMP OFFICE, FLEX UNIT,  
EQUIPMENT PARKING, AND KIOSK SPACES  
HAWAIIAN AIRLINES, INC.

Page 3

CHAPTER 343, HRS - ENVIRONMENTAL ASSESSMENT:

Pursuant to Section 11-200-8(a), Environmental Impact Statement Rules of the Department of Health, State of Hawaii, this disposition is exempt from requirements regarding preparation of an environmental assessment, negative declaration, or environmental impact statement as required by Chapter 343, Hawaii Revised Statutes, as amended, relating to Environmental Impact Statements, because the proposed action falls within Exemption Class #1, Comprehensive Exemption List for the State of Hawaii, Department of Transportation, dated November 15, 2000, as approved by the Environmental Quality Council. Exemption Class #1 covers operations, repairs, or maintenance of existing structures, facilities, equipment, or topographical features involving negligible or no expansion or change of use beyond that previously existing.

The DOTA consulted with the U.S. Federal Aviation Administration as to the appropriateness of the citation of the Environmental Exemption Class from the Comprehensive list for the Department of Transportation dated November 15, 2000. In this case, the FAA concurred on the appropriateness.

REMARKS:

In accordance with Section 171-55, HRS, relating to Permits, the Department of Transportation proposes to issue a month-to-month revocable permit to HA for spaces for a ramp office, flex unit, equipment parking, and kiosks as part of their Signatory Carrier Operations at KOA.

RECOMMENDATION:

That the Board authorize the Department of Transportation to issue a month-to-month revocable permit to HA, subject to: (1) terms and conditions herein outlined, which are by reference incorporated herein; and (2) such additional terms and conditions as may be prescribed by the Director of Transportation to best serve the interests of the State.

Respectfully submitted,



JADE T. BUTAY  
Director of Transportation

APPROVED FOR SUBMITTAL:

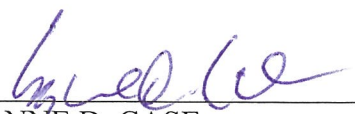
  
\_\_\_\_\_  
SUZANNE D. CASE  
Chairperson and Member



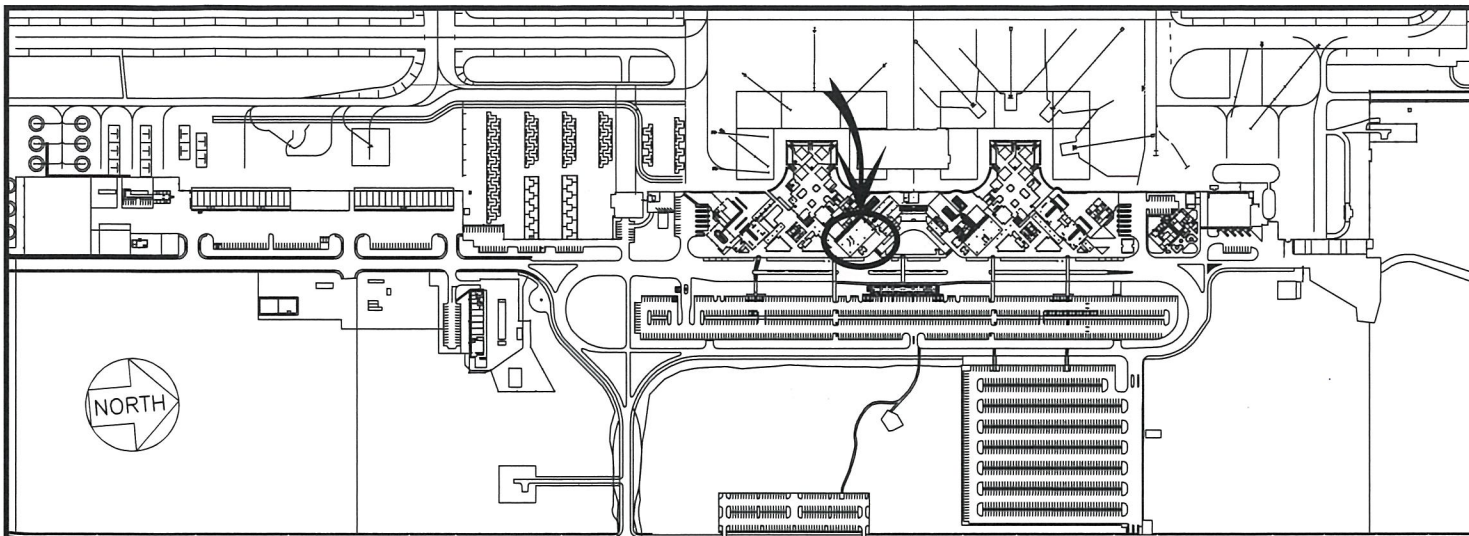

**LOCATION PLAN**

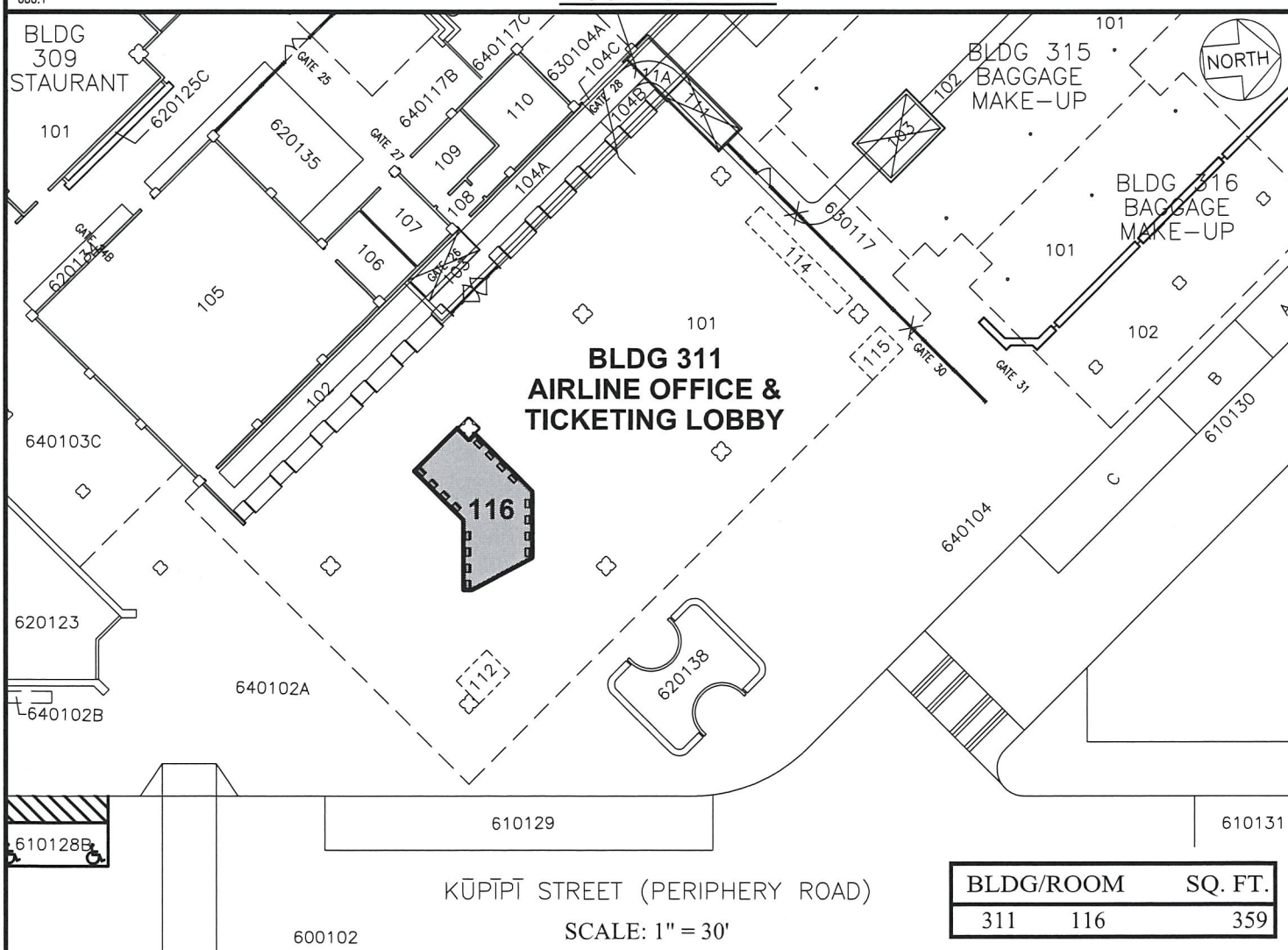

**BLDG 311  
AIRLINE OFFICE &  
TICKETING LOBBY**

BLDG/ROOM	SQ. FT.
311 116	359

RP-8947

DATE : DECEMBER 2019

EXHIBIT:

**A**



Airports Division

HAWAIIAN AIRLINES, INC.

**BUILDING 311  
AIRLINE OFFICE &  
TICKETING LOBBY  
GROUND LEVEL**

311116

PLATS E1, 58

**ELLISON ONIZUKA KONA INTERNATIONAL AIRPORT AT KEAHOLE**

N:\AIRPORTS\KOA\_Kona\CAD\PM\2019 Hawaiian Airlines\koa\_311116-02.dwg

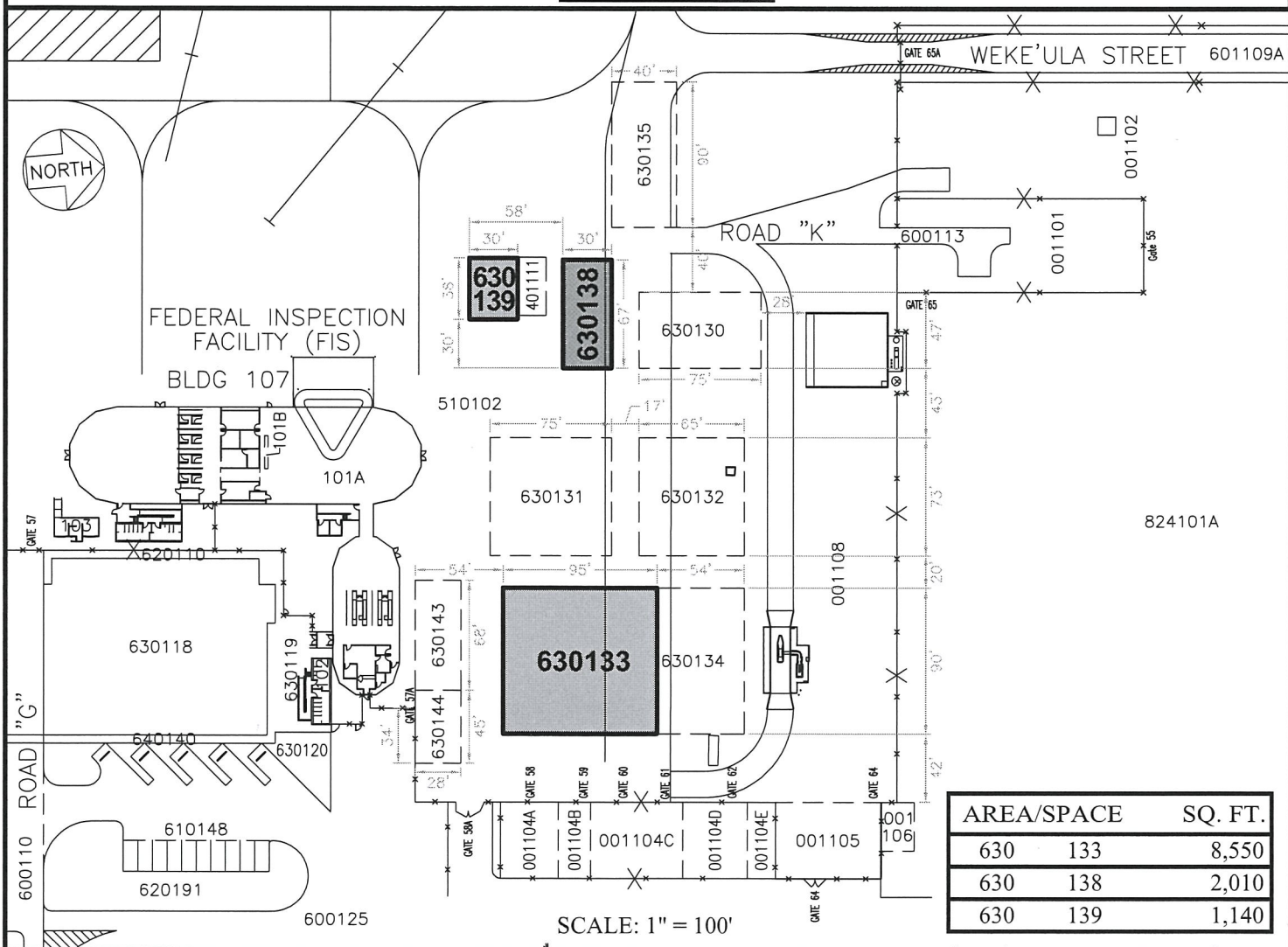
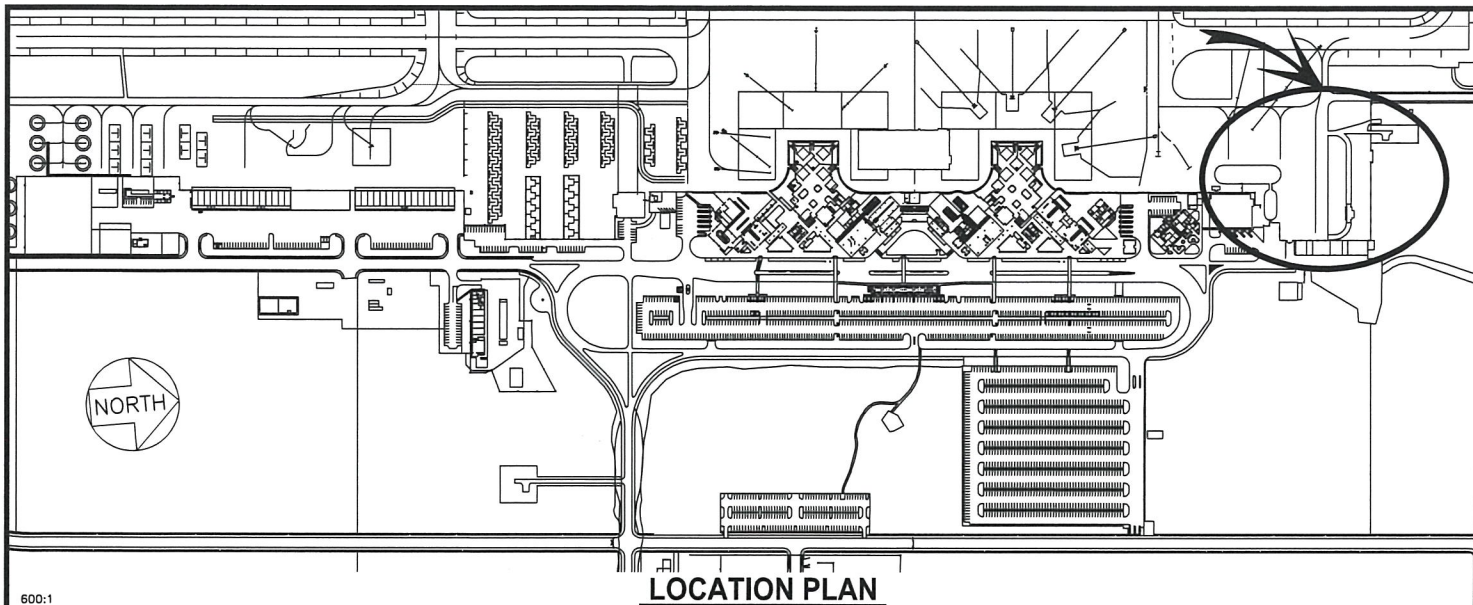

RP-8947

DATE : DECEMBER 2019

EXHIBIT: **B**



Airports Division

HAWAIIAN AIRLINES, INC.

PAVED AREA

630133  
630138  
630139  
PLATS F1, 38, 58



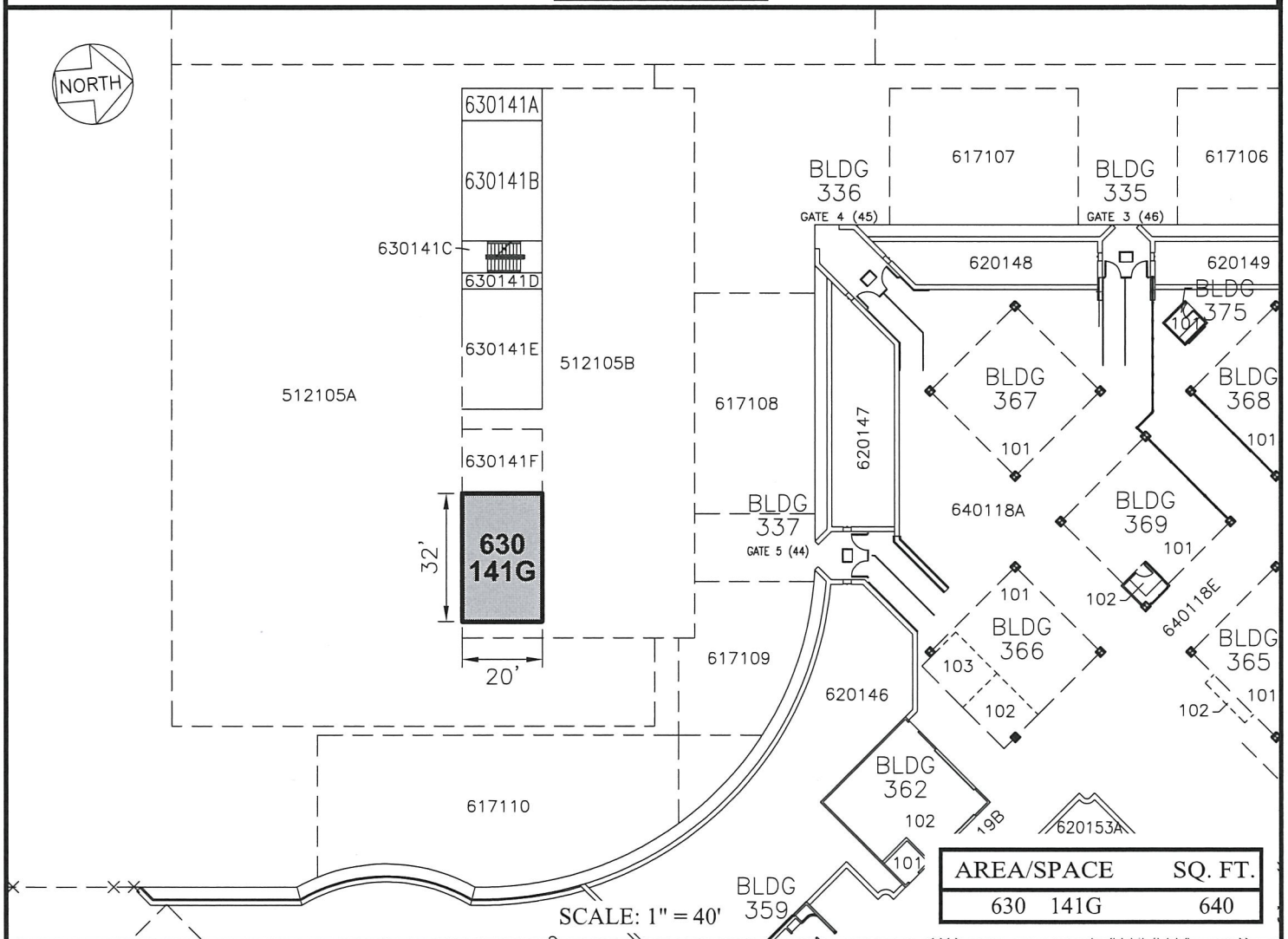
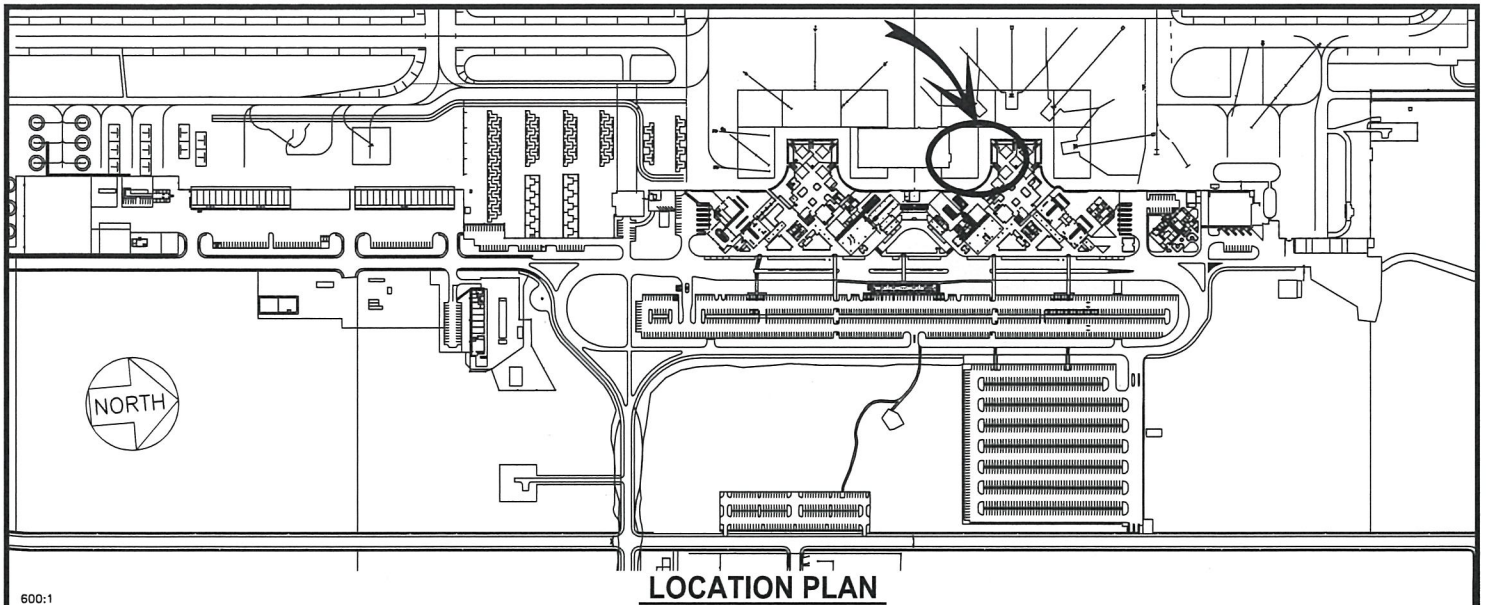

RP-8947

DATE : DECEMBER 2019

EXHIBIT: **C**



Airports Division

HAWAIIAN AIRLINES, INC.

PAVED AREA  
GROUND LEVEL

630141G

PLATS E1, 38