

DAVID Y. IGE  
GOVERNOR

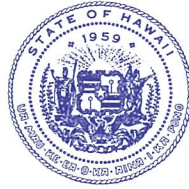

**STATE OF HAWAII  
DEPARTMENT OF TRANSPORTATION  
869 PUNCHBOWL STREET  
HONOLULU, HAWAII 96813-5097**

JADE T. BUTAY  
DIRECTOR

Deputy Directors  
LYNN A.S. ARAKI-REGAN  
DEREK J. CHOW  
ROSS M. HIGASHI  
EDWIN H. SNIFFEN

IN REPLY REFER TO:

Board of Land and  
Natural Resources  
State of Hawai'i  
Honolulu, Hawai'i

ISSUANCE OF A REVOCABLE PERMIT FOR OFFICE SPACE  
SCHUMAN AVIATION COMPANY, LTD. DBA MAKANI KAI AIR  
MOLOKA'I AIRPORT  
TAX MAP KEY: (2) 5-2-04: PORTION OF 8

MOLOKA'I

LEGAL REFERENCE:

Section 171-55, Hawai'i Revised Statutes (HRS).

APPLICANT:

Schuman Aviation Company, Ltd. ("SAC") whose business address is 130 Iolana Place,  
Honolulu, Hawai'i 96819.

LOCATION AND TAX MAP KEY:

Portion of Moloka'i Airport (MKK), Hoolehua, Island of Moloka'i, identified by  
Tax Map Key: 2<sup>nd</sup> Division, 5-2-04: Portion of 8.

AREA:

Building/Room No. 301-110A, containing an area of approximately 148 square feet; and  
Building/Room No. 301-110B, containing an area of approximately 70 square feet, as  
shown and delineated on the attached map labeled Exhibit "A".

ZONING:

State Land Use: Agricultural  
County: Interim Zoning Provisions of the Maui County Zoning Code

**ITEM M-9**

BLNR- ISSUANCE OF A REVOCABLE PERMIT FOR OFFICE SPACE  
SCHUMAN AVIATION COMPANY, LTD.

Page 2

LAND TITLE STATUS:

Section 5(b), Hawai'i Admissions Act - Ceded  
DHHL, 30% entitlement lands Yes \_\_\_\_\_ No X

CURRENT USE STATUS:

Airport and aeronautical purposes.

CHARACTER OF USE:

SAC will use the office space in support of its Commuter Airline Operations at MKK.

COMMENCEMENT DATE:

Upon complete execution of the revocable permit.

MONTHLY RENTAL:

\$464.71 (\$346.99, as determined from the Department of Transportation, Airports Division [DOTA] schedule of rates and charges established by appraisal of Airports property statewide plus \$85.02 for utilities and \$32.70 for maintenance fees).

SECURITY DEPOSIT:

Three (3) times the monthly rental in effect.

DCCA VERIFICATION:

Place of business registration confirmed:	YES <u>X</u>	NO _____
Registered business name confirmed:	YES <u>X</u>	NO _____
Good standing confirmed:	YES <u>X</u>	NO _____

CHAPTER 343, HRS - ENVIRONMENTAL ASSESSMENT:

Pursuant to Section 11-200-8(a), Environmental Impact Statement Rules of the Department of Health, State of Hawai'i, this disposition is exempt from requirements regarding preparation of an environmental assessment, negative declaration, or environmental impact statement as required by Chapter 343, Hawai'i Revised Statutes, as amended, relating to Environmental Impact Statements, because the proposed action falls within Exemption Class #1, Comprehensive Exemption List for the State of Hawai'i, Department of Transportation, dated November 15, 2000, as approved by the Environmental Quality Council. Exemption Class #1 covers operations, repairs, or

BLNR- ISSUANCE OF A REVOCABLE PERMIT FOR OFFICE SPACE  
SCHUMAN AVIATION COMPANY, LTD.

Page 3

maintenance of existing structures, facilities, equipment, or topographical features involving negligible or no expansion or change of use beyond that previously existing.

The DOTA consulted with the U.S. Federal Aviation Administration as to the appropriateness of the citation of the Environmental Exemption Class from the Comprehensive list for the Department of Transportation dated November 15, 2000. In this case, the FAA concurred on the appropriateness.

REMARKS:

In accordance with Section 171-55, HRS, relating to Permits, the Department of Transportation proposes to issue a month-to-month revocable permit to SAC for office space in support of its Commuter Airline Operations at MKK.

RECOMMENDATION:

That the Board authorizes the Department of Transportation to issue a revocable permit to SAC, subject to: (1) terms and conditions herein outlined, which are by reference incorporated herein; (2) such other terms and conditions as may be prescribed by the Director of Transportation to best serve the interests of the State.

Respectfully submitted,



JADE T. BUTAY  
Director of Transportation

APPROVED FOR SUBMITTAL:

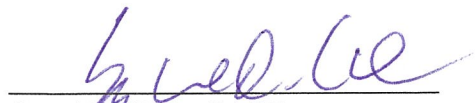
  
\_\_\_\_\_  
SUZANNE D. CASE  
Chairperson and Member

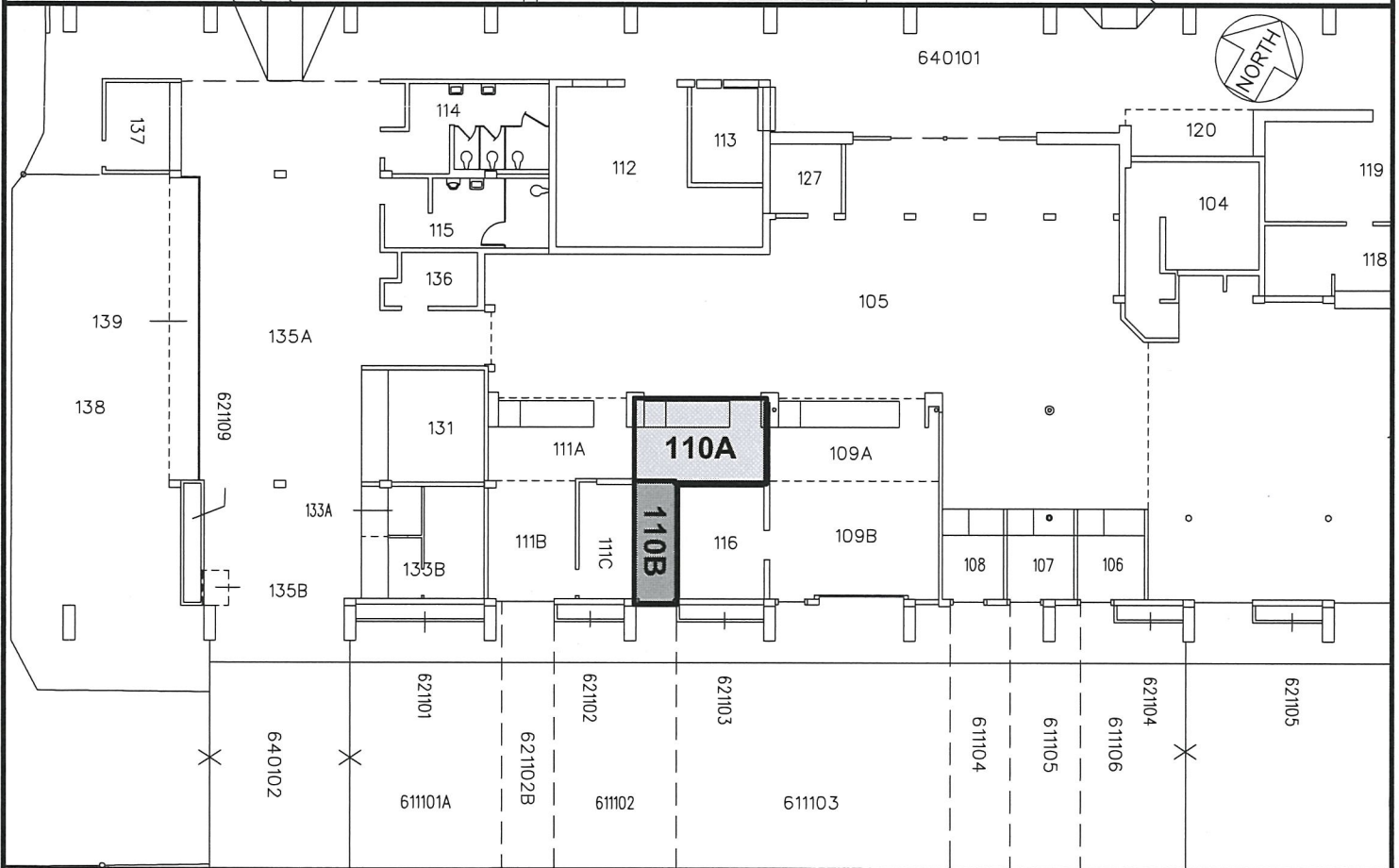
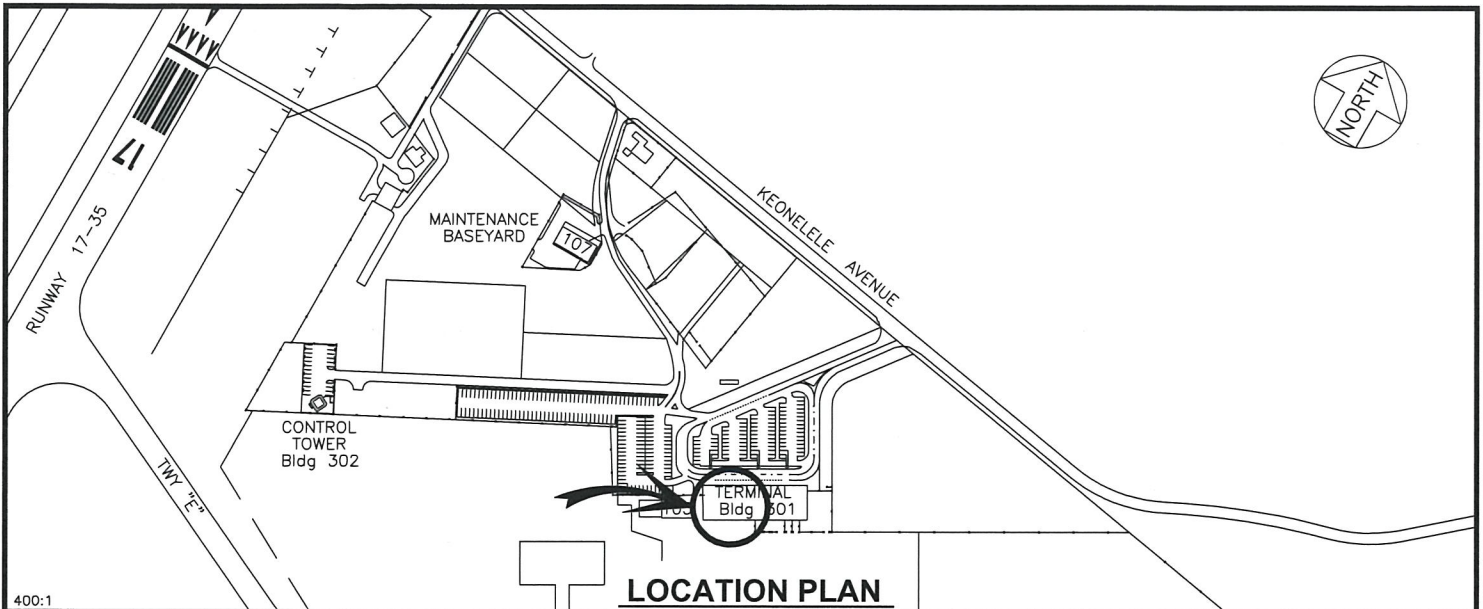

BLDG/ROOM		SQ. FT.
301	110A	148
301	110B	70

SCALE: 1" = 20'

RP-8943		DATE : NOVEMBER 2019		EXHIBIT: <b>A</b>	
Airports Division	SCHUMAN AVIATION COMPANY, LTD	BUILDING 301 TERMINAL BUILDING GROUND LEVEL		301110A	
				301110B	
				PLAT A1, 33	

**MOLOKAI AIRPORT**

N:\AIRPORTS\MKK\_Molokai\CAD\PM\mkk\_301110A-01.dwg