

STATE OF HAWAII
DEPARTMENT OF TRANSPORTATION
869 PUNCHBOWL STREET
HONOLULU, HAWAII 96813-5097

JADE T. BUTAY
DIRECTOR

Deputy Directors
LYNN A.S. ARAKI-REGAN
DEREK J. CHOW
ROSS M. HIGASHI
EDWIN H. SNIFFEN

IN REPLY REFER TO:

Board of Land and
Natural Resources
State of Hawai'i
Honolulu, Hawai'i

ISSUANCE OF A REVOCABLE PERMIT FOR THE PURPOSE OF ERECTING A
TEMPORARY HANGAR TO STORE EXPERIMENTAL SOLAR POWERED DRONES
AEROVIRONMENT, INC.
KALAELOA AIRPORT
TAX MAP KEYS: (1) 9-1-13: PORTION OF 32

O'AHU

REQUEST:

Issuance of a revocable permit for the purpose of erecting a temporary hangar structure to store solar powered aircraft drones to AeroVironment, Inc, situated at Kalaeloa Airport (Airport).

LEGAL REFERENCE:

Section 171-55, Hawai'i Revised Statutes ("HRS").

APPLICANT:

AeroVironment, Inc., whose mailing address is 900 Innovators Way, Simi Valley, California 93065.

LOCATION:

Portions of the Airport, Kapolei, Island of O'ahu, State of Hawai'i, identified by Tax Map Key: 1st Division, 9-1-13: portion of 32.

AREA:

Area/Space No. 001-124, containing an area of approximately 13,200 square feet, as shown and delineated on the attached map labeled Exhibit "A".

ITEM M-1

BLNR- ISSUANCE OF A REVOCABLE PERMIT FOR THE ERECTION OF
A TEMPORARY HANGAR TO STORE EXPERIMENTAL SOLAR DRONES
AEROVIRONMENT, INC.

Page 2

ZONING:

State Land Use District: Urban
City and County of Honolulu LUO: P-2 (To be rezoned in the future)

LAND TITLE STATUS:

Non-ceded land acquired from the U.S. Government by the State of Hawai'i after Statehood
DHHL 30% entitlement lands pursuant to Hawai'i Admission Act YES ____ NO X

CURRENT USE STATUS:

Land presently encumbered by Governor's Executive Order No. 3861, setting aside the
Airport under the control and management of the Department of Transportation, Airports
Division (DOTA), State of Hawai'i, for Airport Purposes.

CHARACTER OF USE:

Temporary Hangar Structure for the storage of experimental solar powered aircraft drones.

COMMENCEMENT DATE:

To be determined by the Director of Transportation at a later date.

MONTHLY RENTAL:

\$2,794.00 (based on a rate of \$2.54 per square foot per annum for unimproved, paved land,
as determined from the DOTA schedule of rates and charges established by appraisal of
Airports property statewide).

SECURITY DEPOSIT:

Three (3) times the monthly rental in effect

DCCA VERIFICATION:

Place of business registration confirmed:	YES <u>X</u>	NO ____
Registered business name confirmed:	YES <u>X</u>	NO ____
Good standing confirmed:	YES <u>X</u>	NO ____

BLNR- ISSUANCE OF A REVOCABLE PERMIT FOR THE ERECTION OF
A TEMPORARY HANGAR TO STORE EXPERIMENTAL SOLAR DRONES
AEROVIRONMENT, INC.

Page 3

CHAPTER 343, HRS - ENVIRONMENTAL ASSESSMENT:

The subject land area is covered by the Final Environmental Assessment for the Kalaeloa Airfield Development Plan Improvements, State Project No. AO5011-02 dated June 2010. This Environmental Assessment was prepared by Wilson Okamoto Corp. for the DOTA, in part to evaluate the environmental effects of the recommended Kalaeloa Airfield Master Plan to meet existing and forecast general aviation demands.

REMARKS:

In accordance with Section 171-55, HRS, relating to Permits, the Department of Transportation proposes to issue a month-to-month revocable permit to AeroVironment, Inc. for the erection of a temporary hangar structure to store solar powered aircraft drones at the Airport.

RECOMMENDATION:

That the Board authorize the Department of Transportation to issue a month-to-month revocable permit to AeroVironment, Inc., subject to: (1) terms and conditions herein outlined, which are by reference incorporated herein; and (2) such additional terms and conditions as may be prescribed by the Director of Transportation to best serve the interests of the State.

Respectfully submitted,

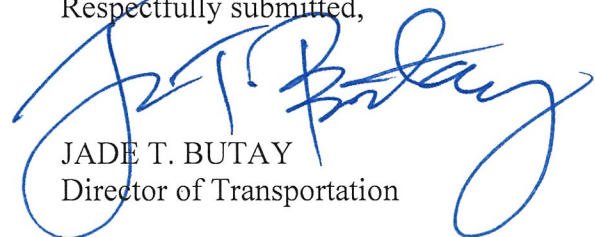

JADE T. BUTAY
Director of Transportation

APPROVED FOR SUBMITTAL:



SUZANNE D. CASE
Chairperson and Member

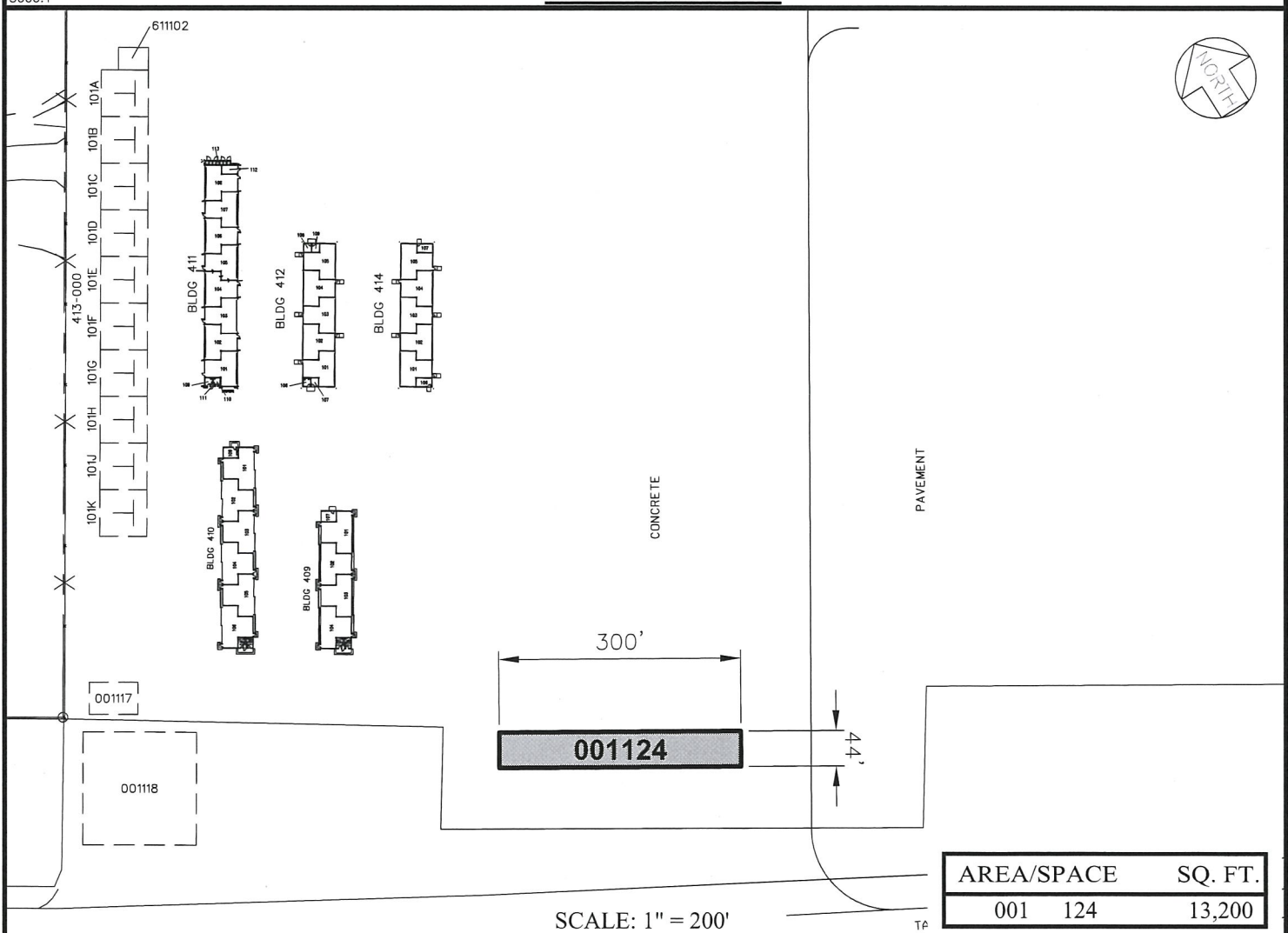
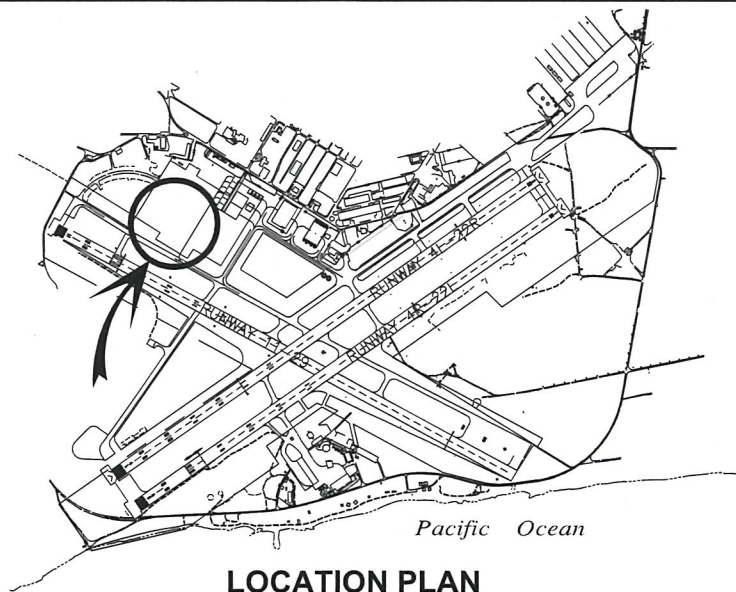

DATE : JANUARY 2020

EXHIBIT: **A**



Airports Division

AEROVIRONMENT, INC.

**HAWK30 DRONE HANGAR
GENERAL AVIATION**

001124

KALAELOA AIRPORT

N:\AIRPORTS\JRF_Kalaeloa\CAD\PM\jrf_001124-01.dwg