

DAVID Y. IGE
GOVERNOR

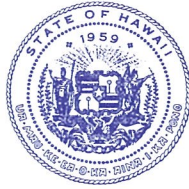

STATE OF HAWAII
DEPARTMENT OF TRANSPORTATION
869 PUNCHBOWL STREET
HONOLULU, HAWAII 96813-5097

JADE T. BUTAY
DIRECTOR

Deputy Directors
LYNN A.S. ARAKI-REGAN
DEREK J. CHOW
ROSS M. HIGASHI
EDWIN H. SNIFFEN

IN REPLY REFER TO:

Board of Land and
Natural Resources
State of Hawai'i
Honolulu, Hawai'i

ISSUANCE OF A GRANT OF NON-EXCLUSIVE EASEMENT AND
MANAGEMENT AND CONSTRUCTION RIGHT-OF-ENTRY FOR THE AHUKINI
TO LYDGATE PARK BIKE AND PEDESTRIAN SHARED-USE PATH PROJECT
COUNTY OF KAUA'I, DEPARTMENT OF PUBLIC WORKS
LĪHU'E AIRPORT KAUA'I
TAX MAP KEY: (4) 3-5-001: PORTION OF 008, (4) 3-5-001: PORTION OF 159

REQUEST:

Portion of Līhu'e Airport (LIH), Līhu'e, Island of Kaua'i, identified by
Tax Map Key: 4th Division, 3-5-001: Portion of 008, 3-5-001: Portion of 159.

LEGAL REFERENCE:

Sections 171-13, 171-55 and 171-95, Hawai'i Revised Statutes (HRS), as amended.

APPLICANT:

County of Kaua'i, Department of Public Works (COK-DPW), whose business address is
4444 Rice Street, Līhu'e, Hawai'i 96766.

LOCATION AND TAX MAP KEY:

Portion of Līhu'e Airport (LIH), Līhu'e, Island of Kaua'i, identified by
Tax Map Key: 4th Division, 3-5-001: Portion of 008, 3-5-001: Portion of 159.

AREA:

Area/Space No. 640-146, containing an area of approximately 27,551 square feet, as
shown and delineated on the attached map labeled Exhibit A.

ITEM M-6

BLNR-ISSUANCE OF A GRANT OF NON-EXCLUSIVE EASEMENT AND
MANAGEMENT AND CONSTRUCTION RIGHT-OF-ENTRY FOR THE AHUKINI TO
LYDGATE PARK BIKE AND PEDESTRIAN SHARED-USE PATH PROJECT
TO THE COUNTY OF KAUA'I, DEPARTMENT OF PUBLIC WORKS

Page 2

ZONING:

State Land Use District:	Urban
County of Kaua'i:	Industrial (IG-STP)

LAND TITLE STATUS:

Section 5(a) lands of the Hawai'i Admission Act:	<u>Non-Ceded</u>
DHHL 30% entitlement lands pursuant to Hawai'i Admission Act	<u>No</u>

CURRENT USE STATUS:

Land presently encumbered by Governor's Executive Order No. 4614 setting aside a portion of Līhu'e Airport under the control and management of the Department of Transportation, Airports Division, State of Hawai'i, for Airport and Airport related purposes.

CHARACTER OF USE:

Right, privilege and authority to construct, use, maintain and repair a bike and pedestrian shared-use path, under and across Airport-owned land for access (sidewalk and pathways) purposes.

COMMENCEMENT DATE:

To be determined by the Director of Transportation at a later date.

CHAPTER 343, HRS - ENVIRONMENTAL ASSESSMENT:

The Final Environmental Assessments for the subject project was published by the Office of Environmental Quality Control's Environmental Notice on July 8, 2016 for the Ahukini to Lydgate Park portion of the bike and pedestrian path use with a finding of no significant impact (FONSI).

REMARKS:

In accordance with Section 171-11 HRS, relating to Powers, the Department of Transportation proposes to issue a Right-of-Entry to County of Kaua'i Public Works for the purpose of topographic survey, which would include cutting of trees and shrubs to clear the line of sight for the survey.

BLNR-ISSUANCE OF A GRANT OF NON-EXCLUSIVE EASEMENT AND
MANAGEMENT AND CONSTRUCTION RIGHT-OF-ENTRY FOR THE AHUKINI TO
LYDGATE PARK BIKE AND PEDESTRIAN SHARED-USE PATH PROJECT
TO THE COUNTY OF KAUA'I, DEPARTMENT OF PUBLIC WORKS

Page 3

RECOMMENDATION:

That the Board approves the Right-of-Entry to County of Kaua'i, subject to: (1) terms and conditions herein outlined, which are by reference incorporated herein; (2) such additional terms and conditions as may be prescribed by the Director of Transportation to best serve the interests of the State; and (3) review and approval of the Department of the Attorney General as to the form and content of the Right-of-Entry.

Respectfully submitted,

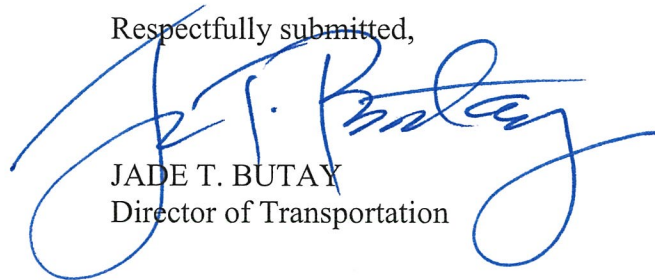

JADE T. BUTAY
Director of Transportation

APPROVED FOR SUBMITTAL:

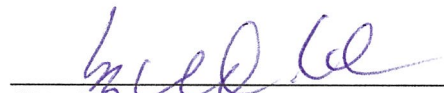

SUZANNE D. CASE
Chairperson and Member

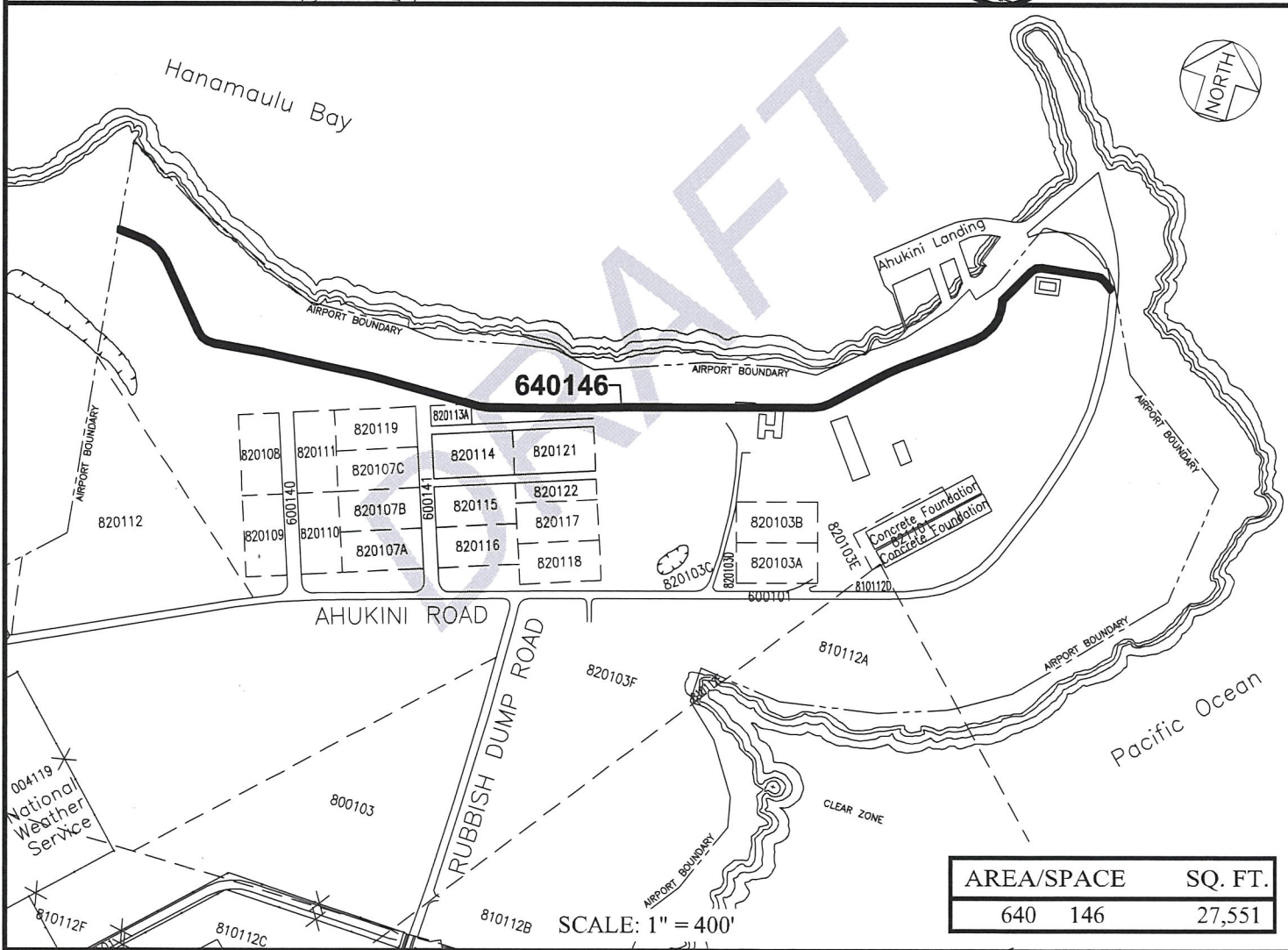
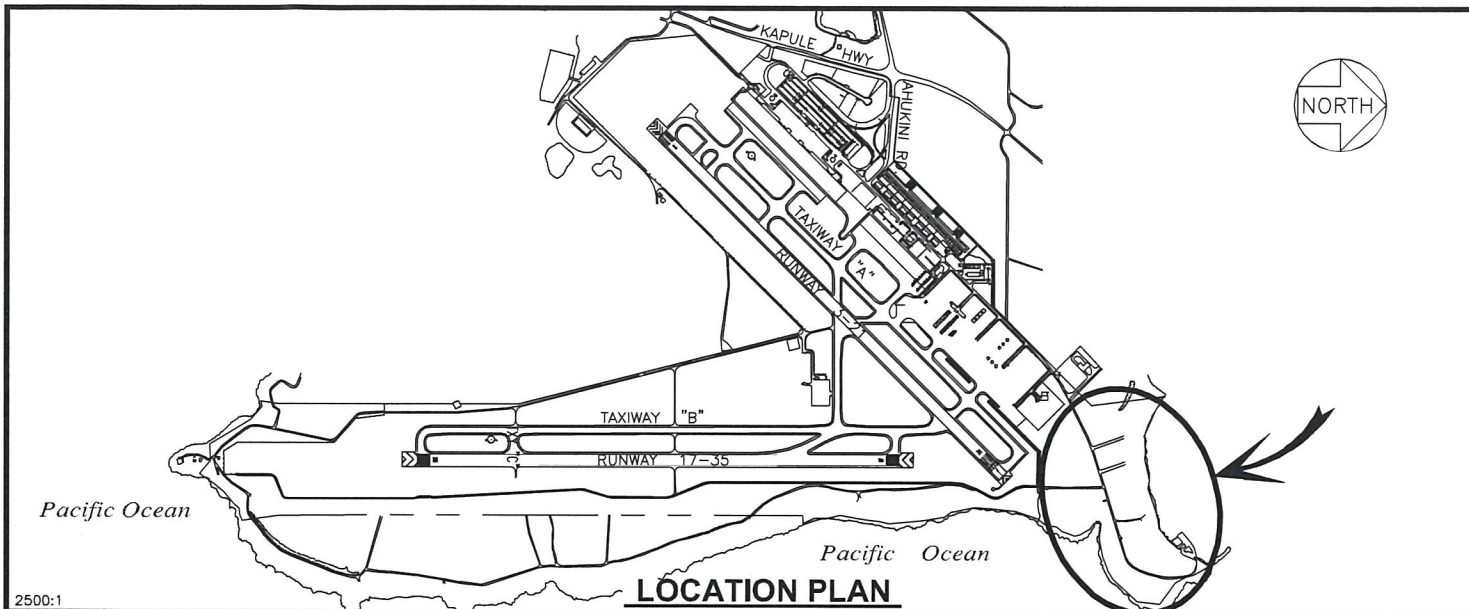

DRAFT

DATE : DECEMBER 2019

EXHIBIT: **A**



Airports Division

COUNTY OF KAUAI,
DEPARTMENT OF
PUBLIC WORKS

PROPOSED BIKE &
PEDESTRIAN PATH
GROUND LEVEL

640146

PLAT 26

LIHUE AIRPORT

N:\AIRPORTS\LIH_Lihue\CAD\PM\lih_640146-02_draft.dwg