

DAVID Y. IGE
GOVERNOR



**STATE OF HAWAII
DEPARTMENT OF TRANSPORTATION
869 PUNCHBOWL STREET
HONOLULU, HAWAII 96813-5097**

JADE T. BUTAY
DIRECTOR

Deputy Directors
LYNN A. S. ARAKI-REGAN
DEREK J. CHOW
ROSS M. HIGASHI
EDWIN H. SNIFFEN

IN REPLY REFER TO:

Board of Land and
Natural Resources
State of Hawai'i
Honolulu, Hawai'i

ISSUANCE OF A REVOCABLE PERMIT FOR TERMINAL OFFICE SPACE
AVAIRPROS SERVICES, INC.
KAHULUI AIRPORT
TAX MAP KEY: (2) 3-8-1: PORTION OF 226

MAUI

REQUEST:

Issuance of a Revocable Permit for terminal office space to Avairpros Services, Inc., situated at Kahului Airport (OGG).

LEGAL REFERENCE:

Section 171-55, Hawai'i Revised Statutes (HRS).

APPLICANT:

Avairpros Services, Inc. (ASI) whose mailing address is 5551 Ridgewood Drive, Suite 300, Naples, Florida 34108.

LOCATION AND TAX MAP KEY:

Portion of Kahului Airport, Kahului, Island of Maui, identified by
Tax Map Key: 2nd Division, 3-8-1: Portion of 226.

AREAS:

Building/Room No. 321-130, containing an area of approximately 382 square feet as shown and delineated on the attached Exhibit A.

ZONING:

State Land Use District:	Urban
County of Maui:	Airport

ITEM M-4

BLNR – ISSUANCE OF A REVOCABLE PERMIT FOR TERMINAL OFFICE SPACE
AVAIROS SERVICES, INC., KAHULUI AIRPORT

Page 2

LAND TITLE STATUS:

Section 5(a) lands of the Hawai'i Admission Act: Non-Ceded
DHHL 30% entitlement lands pursuant to Hawai'i Admission Act YES ___ NO X

CURRENT USE STATUS:

Airport and aeronautical purposes.

CHARACTER OF USE:

Office space.

COMMENCEMENT DATE:

Upon complete execution of the revocable permit.

MONTHLY RENTAL:

\$1,314.08 (\$1,012.30 as determined from the Department of Transportation, Airports
Division schedule of rates and charges established by appraisal of Airports property statewide
plus \$148.98 for utilities, \$95.50 for air conditioning and \$57.30 for maintenance).

SECURITY DEPOSIT:

Three (3) times the monthly rental in effect.

DCCA VERIFICATION:

Place of business registration confirmed:	YES <u>X</u>	NO ___
Registered business name confirmed:	YES <u>X</u>	NO ___
Good standing confirmed:	YES <u>X</u>	NO ___

CHAPTER 343, HRS - ENVIRONMENTAL ASSESSMENT:

In accordance with Chapter 11-200.1-15 (General types of actions eligible for exemption) of the Environmental Impact Statement Rules of the Department of Health, State of Hawai'i, this disposition is exempt from requirements regarding preparation of an environmental assessment, negative declaration, or environmental impact statement as required by Chapter 343, HRS, dated December 18, 2018.

The proposed action falls within the following Exemption:

Chapter 11-200.1-15 (c) (1) Operations, repairs, or maintenance of existing structures, facilities, equipment, or topographical features, involving minor expansion or minor change of use beyond that previously existing.

BLNR – ISSUANCE OF A REVOCABLE PERMIT FOR TERMINAL OFFICE SPACE
AVAIROS SERVICES, INC., KAHULUI AIRPORT

Page 3

This request would qualify under the above exemption because the Applicant would be using an existing office space, which does not require any changes beyond what is currently existing.

The DOTA consulted with the U.S. Federal Aviation Administration (FAA) as to the appropriateness of the citation of the Environmental Exemption from Chapter 11-200.1-15 (General types of actions eligible for exemption) dated December 18, 2018. The FAA concurred on the appropriateness.

REMARKS:

In accordance with Section 171-55 HRS, relating to Permits, the Department of Transportation proposes to issue a month-to-month revocable permit to ASI for office space for their aviation consulting operation.

RECOMMENDATION:

That the Board authorize the Department of Transportation to issue a month-to-month Revocable Permit to ASI, subject to: (1) terms and conditions herein outlined, which are by reference incorporated herein; and (2) such additional terms and conditions as may be prescribed by the Director of Transportation to best serve the interests of the State.

Respectfully submitted,

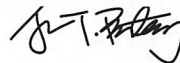

JADE T. BUTAY
Director of Transportation

APPROVED FOR SUBMITTAL:

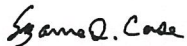

SUZANNE D. CASE
Chairperson and Member

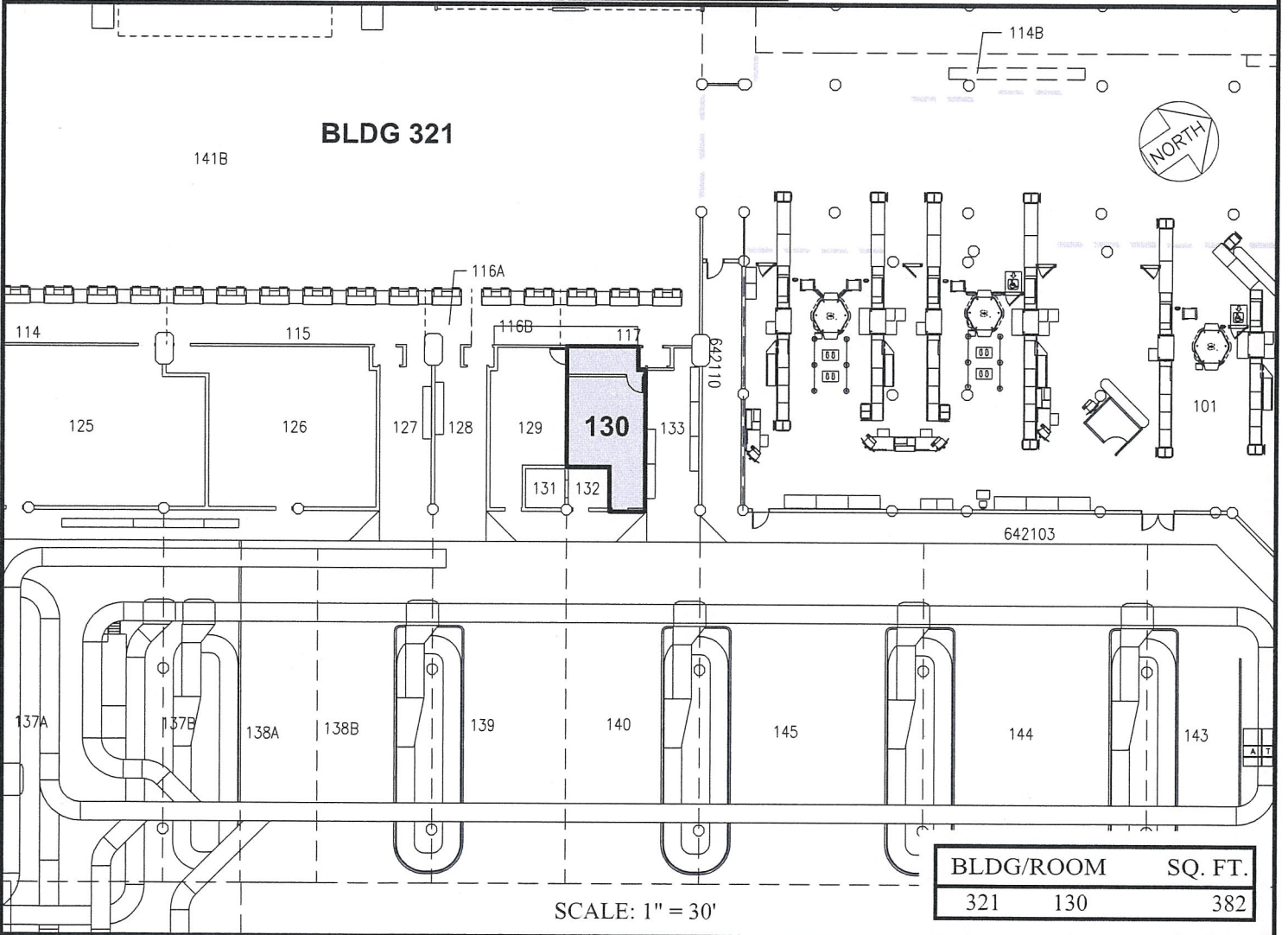
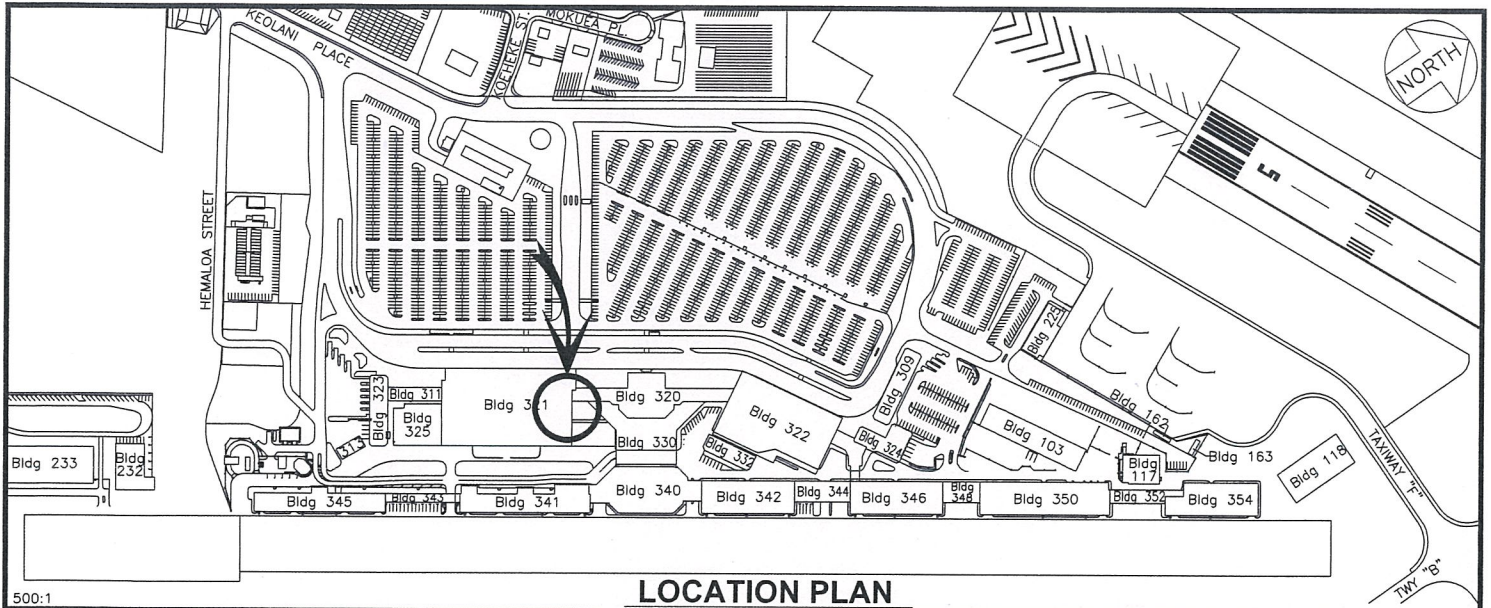

BLDG/ROOM	SQ. FT.
321 130	382

RP-8995

DATE : MAY 2020

EXHIBIT: **A**



Airports Division

AVAIRPROS SERVICES, INC.

**BUILDING 321
TICKET LOBBY
GROUND LEVEL**

**321130
PLATS A1, 35**

KAHULUI AIRPORT

N:\AIRPORTS\OGG_Kahului\CAD\PM\ogg_321130-01.dwg