

DAVID Y. IGE  
GOVERNOR

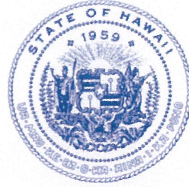

**STATE OF HAWAII**  
**DEPARTMENT OF TRANSPORTATION**  
869 PUNCHBOWL STREET  
HONOLULU, HAWAII 96813-5097

JADE T. BUTAY  
DIRECTOR

Deputy Directors  
LYNN A.S. ARAKI-REGAN  
DEREK J. CHOW  
ROSS M. HIGASHI  
EDWIN H. SNIFFEN

IN REPLY REFER TO:

Board of Land and  
Natural Resources  
State of Hawai'i  
Honolulu, Hawai'i

ISSUANCE OF A REVOCABLE PERMIT FOR RAMP SPACE FOR  
CARGO SORTING OPERATIONS  
AEKO KULA, LLC DBA ALOHA AIR CARGO  
ELLISON ONIZUKA KONA INTERNATIONAL AIRPORT AT KEĀHOLE HAWAI'I  
TAX MAP KEY: (3) 7-3-43: PORTION OF 003

LEGAL REFERENCE:

Section 171-55, Hawai'i Revised Statutes (HRS).

APPLICANT:

Aeko Kula, LLC dba Aloha Air Cargo (AAC), whose business address is  
50 Elliott Street, Honolulu, Hawai'i 96818.

LOCATION AND TAX MAP KEY:

Portion of Ellison Onizuka Kona International Airport at Keāhole (KOA), Kailua-Kona,  
Island of Hawai'i, identified by Tax Map Key: 3rd Division, 7-3-43:003 (Portion).

AREA:

Area/Space No. 004-106B, containing an area of 3,719 square feet; and  
Area/Space No. 004-106C, containing an area of 3,719 square feet, as shown and  
delineated on the attached Exhibit A.

ZONING:

State Land Use District:	Urban & Conservation
County of Hawai'i:	Industrial (MG-1a) and Open

**ITEM M-3**

BLNR – ISSUANCE OF A REVOCABLE PERMIT FOR RAMP SPACE FOR  
CARGO SORTING OPERATIONS  
AEKO KULA, LLC DBA ALOHA AIR CARGO

Page 2

LAND TITLE STATUS:

Section 5(a) lands of the Hawai‘i Admission Act: Ceded  
DHHL 30% entitlement lands pursuant to Hawai‘i Admission Act YES \_\_\_ NO X

CURRENT USE STATUS:

Airport and aeronautical purposes.

CHARACTER OF USE:

AAC will use the space for package sorting as part of its cargo operations.

COMMENCEMENT DATE:

Upon execution of the revocable permit.

MONTHLY RENTAL:

\$1,276.86 (as determined from the DOTA schedule of rates and charges established by appraisal of Airports property statewide).

SECURITY DEPOSIT:

Three (3) times the monthly rental in effect.

DCCA VERIFICATION:

Place of business registration confirmed:	YES <u>X</u>	NO _____
Registered business name confirmed:	YES <u>X</u>	NO _____
Good standing confirmed:	YES <u>X</u>	NO _____

CHAPTER 343, HRS - ENVIRONMENTAL ASSESSMENT:

The State of Hawai‘i, Department of Transportation, Airports Division (HDOT-A), has determined that the subject land areas are covered by the Keahole Airport Master Plan Final Environmental Impact Statement (EIS), published by the Office of Environmental Quality Control (OEQC) in the November 8, 1988, issue of The Environmental Notice and accepted by the Governor on December 19, 1988.

BLNR – ISSUANCE OF A REVOCABLE PERMIT FOR RAMP SPACE FOR  
CARGO SORTING OPERATIONS  
AEKO KULA, LLC DBA ALOHA AIR CARGO

Page 3

REMARKS:

In accordance with Section 171-55, HRS, relating to Permits, the Department of Transportation proposes to issue a month-to-month revocable permit to AAC for package sorting as part of its cargo operations at KOA.

RECOMMENDATION:

That the Board authorize the Department of Transportation to issue a month-to-month revocable permit to AAC, subject to: (1) terms and conditions herein outlined, which are by reference incorporated herein; and (2) such additional terms and conditions as may be prescribed by the Director of Transportation to best serve the interests of the State.

Respectfully submitted,



JADE T. BUTAY  
Director of Transportation

APPROVED FOR SUBMITTAL:

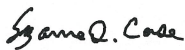

SUZANNE D. CASE  
Chairperson and Member

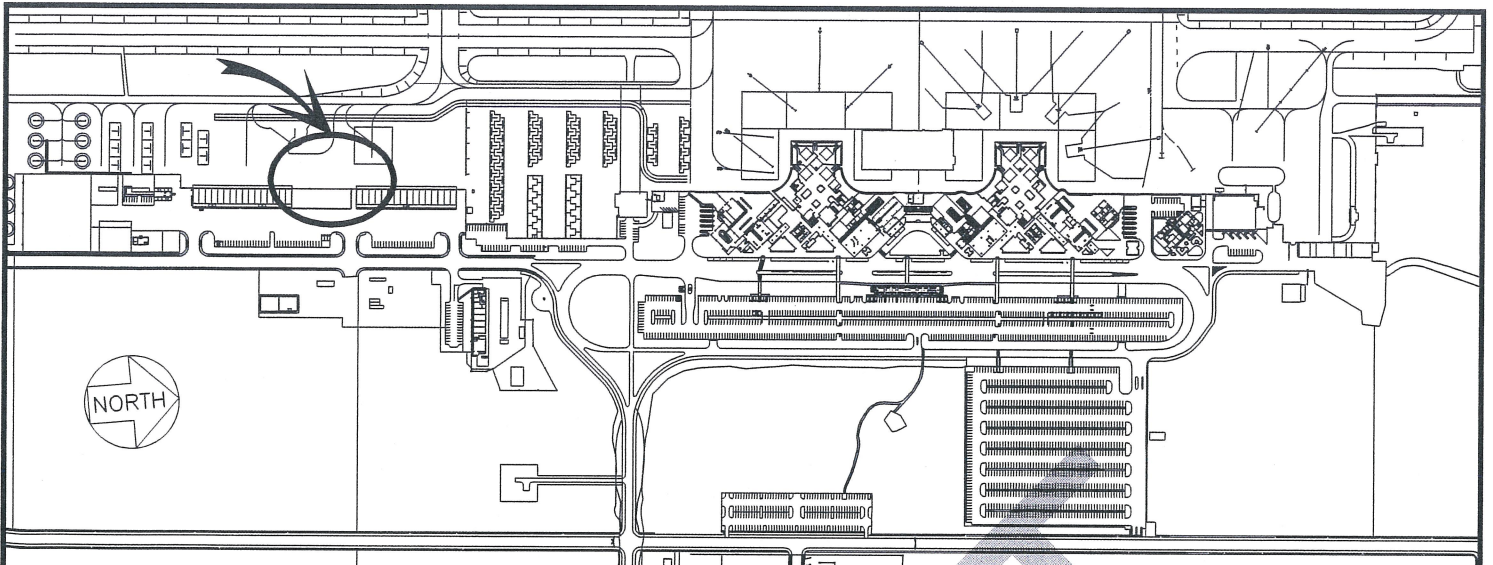

600:1

**LOCATION PLAN**

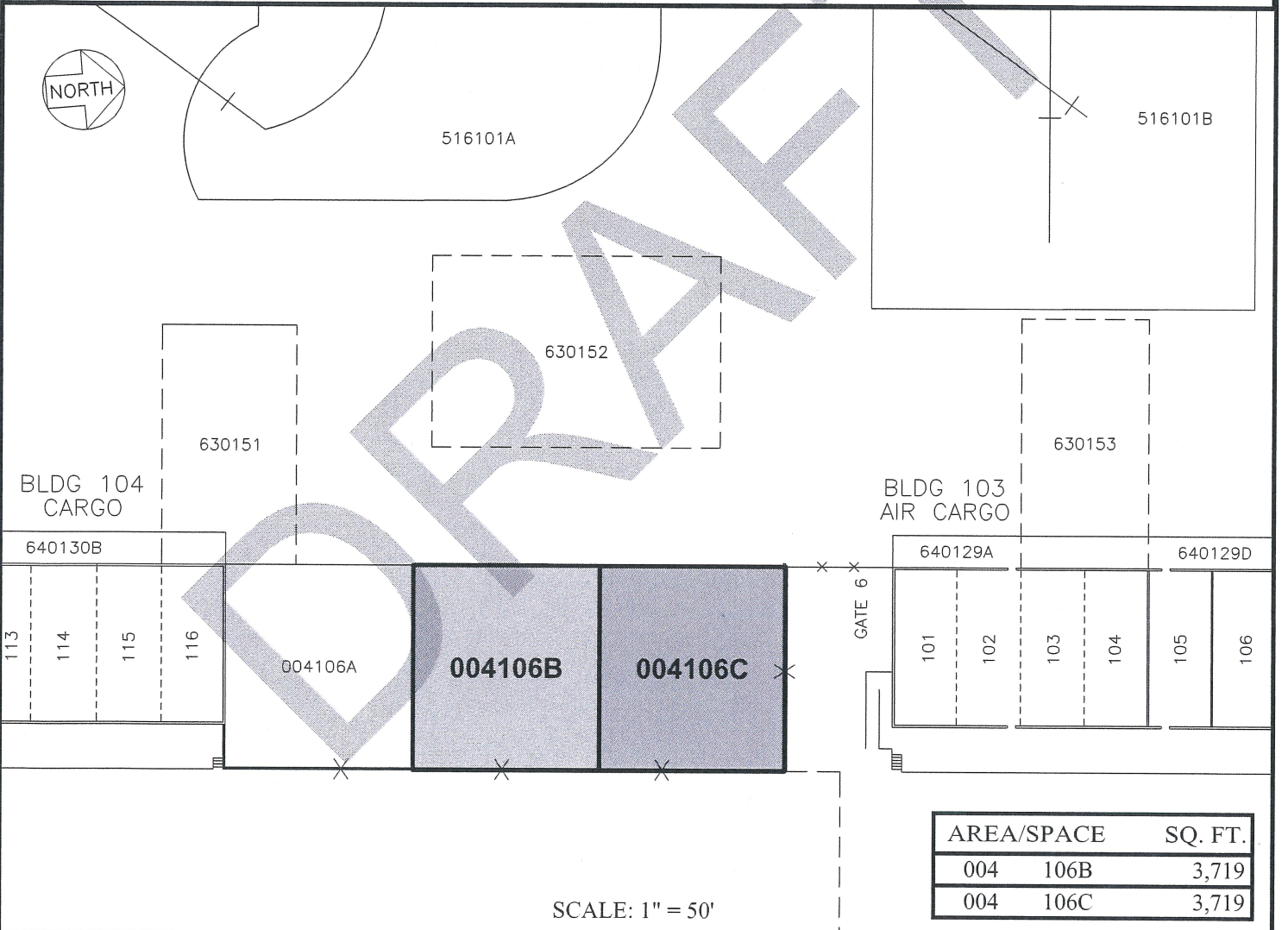

SCALE: 1" = 50'

AREA/SPACE	SQ. FT.
004 106B	3,719
004 106C	3,719

DRAFT

DATE : MAY 2020

EXHIBIT: **A**



Airports Division

AEKO KULA, LLC

LOTS

004106B  
004106C

PLATS C1, 39

**ELLISON ONIZUKA KONA INTERNATIONAL AIRPORT AT KEAHOLE**

N:\AIRPORTS\KOA\_Kona\CAD\PM\koa\_004106B-02\_draft.dwg