

DAVID Y. IGE
GOVERNOR

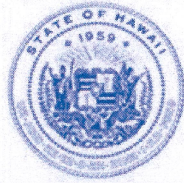

STATE OF HAWAII
DEPARTMENT OF TRANSPORTATION
869 PUNCHBOWL STREET
HONOLULU, HAWAII 96813-5097

JADE T. BUTAY
DIRECTOR

Deputy Directors
LYNN A.S. ARAKI-REGAN
DEREK J. CHOW
ROSS M. HIGASHI
EDWIN H. SNIFFEN

IN REPLY REFER TO:

Board of Land and
Natural Resources
State of Hawai'i
Honolulu, Hawai'i

ISSUANCE OF A REVOCABLE PERMIT FOR AIRCRAFT PARKING
WILLIAM ANDREW WOMACK
WAIMEA-KOHALA AIRPORT
TAX MAP KEY: (3) 6-7-001: PORTION OF 08

HAWAI'I

LEGAL REFERENCE:

Section 171-55, Hawai'i Revised Statutes (HRS).

APPLICANT:

William Andrew Womack, whose mailing address is 87-3156 Mamalahoa Highway,
Captain Cook, Hawai'i 96704.

LOCATION AND TAX MAP KEY:

Portion of Waimea-Kohala Airport, Kamuela, Island of Hawai'i, identified by
Tax Map Key: (3) 6-7-001: PORTION OF 08.

AREA:

Area/Space No. 401-104, containing an area of approximately 990 square feet, as
shown and delineated on the attached Exhibit A.

ZONING:

State Land Use District:
County of Hawai'i:

Agricultural District
A-40A Agriculture

ITEM M-2

BLNR – ISSUANCE OF A REVOCABLE PERMIT FOR AIRCRAFT PARKING
WILLIAM ANDREW WOMACK, WAIMEA-KOHALA AIRPORT

Page 2

LAND TITLE STATUS:

Section 5(a) lands of the Hawai'i Admission Act: Non-Ceded

DHHL 30% entitlement lands pursuant to Hawai'i Admission Act: YES ___ NO X

CURRENT USE STATUS:

Airport and aeronautical purposes.

CHARACTER OF USE:

Aircraft tie-down.

COMMENCEMENT DATE:

Upon complete execution of the parking permit.

MONTHLY RENTAL:

\$54.00 (as determined from the Department of Transportation, Airports Division schedule of rates and charges established by appraisal of Airports property statewide).

SECURITY DEPOSIT:

\$162.00, or three times the monthly rental in effect.

CHAPTER 343, HRS - ENVIRONMENTAL ASSESSMENT:

The State of Hawai'i, Department of Transportation, Airports Division (DOTA), has determined that the environmental impacts of the proposed tenant lease for the subject land use is covered by the Waimea-Kohala Airport Final Environmental Assessment (FEA), published by the Office of Environmental Quality Control (OEQC) in the November 8, 1999, issue of The Environmental Notice. Accordingly, all relevant mitigation from the FEA and best management practices will be implemented to address the minimum impacts of this action.

BLNR – ISSUANCE OF A REVOCABLE PERMIT FOR AIRCRAFT PARKING
WILLIAM ANDREW WOMACK, WAIMEA-KOHALA AIRPORT

Page 3

REMARKS:

In accordance with Section 171-55 HRS, relating to Permits, the Department of Transportation proposes to issue a month-to-month parking permit to William Andrew Womack for an aircraft tie-down at Waimea-Kohala Airport.

RECOMMENDATION:

That the Board authorize the Department of Transportation to issue a month-to-month parking permit to William Andrew Womack, subject to: (1) terms and conditions herein outlined, which are by reference incorporated herein; and (2) such additional terms and conditions as may be prescribed by the Director of Transportation to best serve the interests of the State.

Respectfully submitted,



JADE T. BUTAY
Director of Transportation

APPROVED FOR SUBMITTAL:



SUZANNE D. CASE
Chairperson and Member

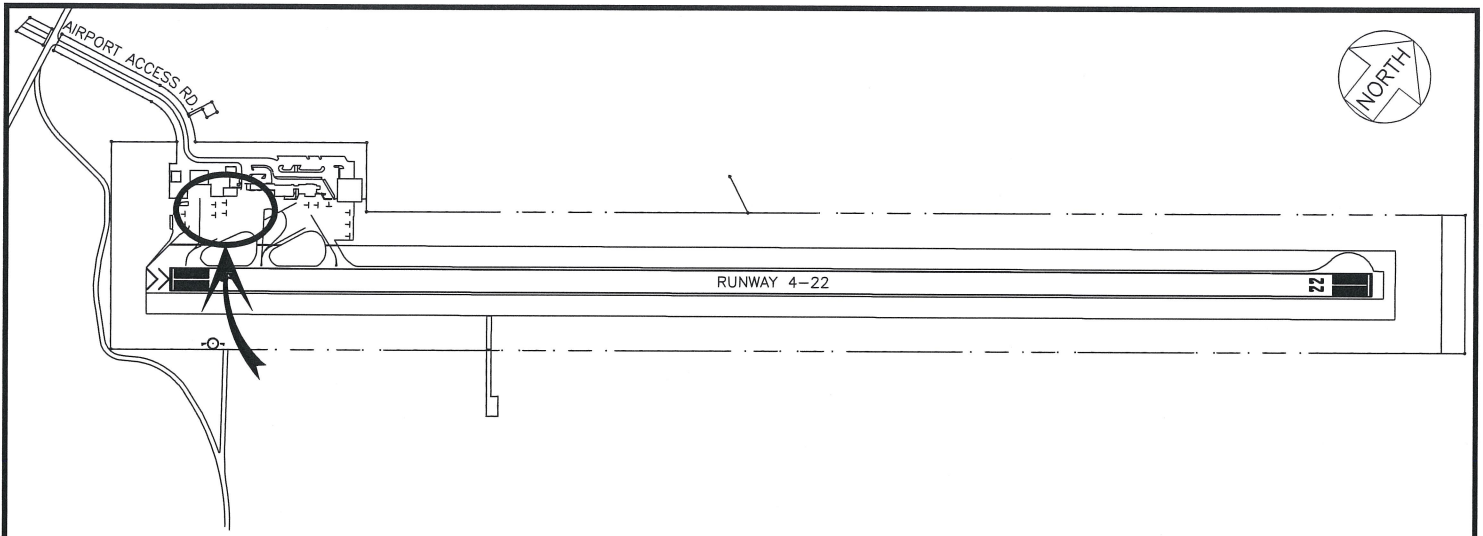

LOCATION PLAN

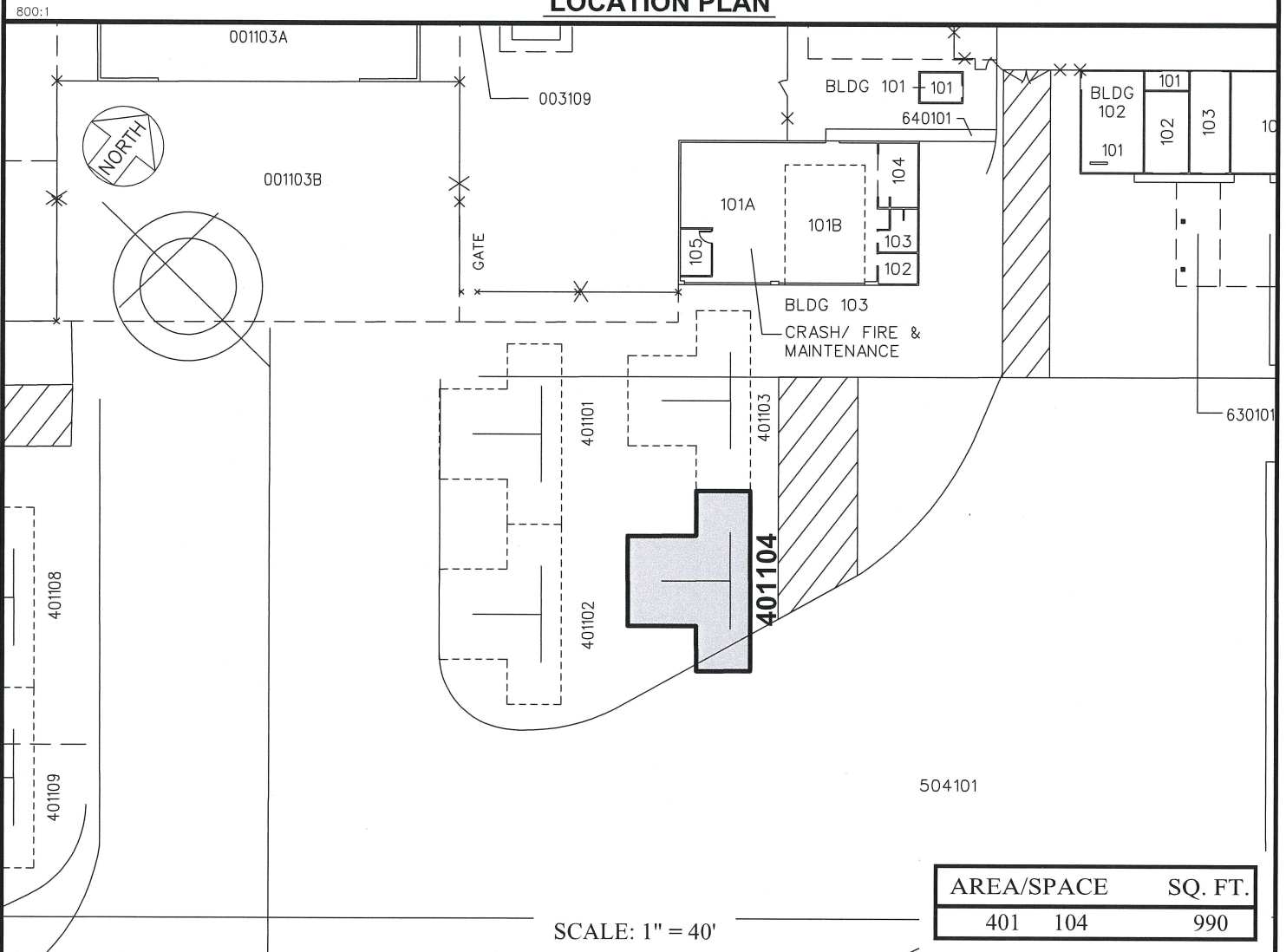

PP-20-N007

DATE : JULY 2020

EXHIBIT: **A**

<p>Airports Division</p>	<p>WILLIAM WOMACK</p>	<p>TIE-DOWN</p>	<p>401104</p> <p>PLAT A1, 41</p>
--------------------------	-----------------------	-----------------	----------------------------------