

DAVID Y. IGE
GOVERNOR



STATE OF HAWAII
DEPARTMENT OF TRANSPORTATION
869 PUNCHBOWL STREET
HONOLULU, HAWAII 96813-5097

JADE T. BUTAY
DIRECTOR

Deputy Directors
LYNN A.S. ARAKI-REGAN
DEREK J. CHOW
ROSS M. HIGASHI
EDWIN H. SNIFFEN

IN REPLY REFER TO:

Board of Land and
Natural Resources
State of Hawai'i
Honolulu, Hawai'i

ISSUANCE OF A REVOCABLE PERMIT FOR
CONSTRUCTION MATERIAL STORAGE AND EQUIPMENT STAGING
WATTS CONSTRUCTORS, LLC
DANIEL K. INOUYE INTERNATIONAL AIRPORT
TAX MAP KEY: (1) 1-1-4: 03 (PORTION)

O'AHU

APPLICANT:

Watts Constructors, LLC (WATTS), whose mailing address is 3375 Koapaka Street,
Suite F22024, Honolulu, Hawai'i 96813.

LEGAL REFERENCE:

Section 171-55, Hawai'i Revised Statutes (HRS).

LOCATION:

2825 Ualena Street, City and County of Honolulu, Island of O'ahu, State of Hawai'i,
identified by Tax Map Key: 1st Division, 1-1-4: 03 (POR).

AREA:

Area/Space No. 005-128C, containing an area of approximately 9,243 square feet;
Area/Space No. 005-128C, containing an area of approximately 184 square feet;
Building/Room No. 149-101, containing an area of approximately 10,599 square feet;
Building/Room No. 149-102, containing an area of approximately 5,293 square feet,
as shown and delineated on the attached map labeled Exhibit "A".

ZONING:

State Land Use District: Urban
City and County of Honolulu LUO: Industrial (I-2)

ITEM M-4

BLNR – ISSUANCE OF A REVOCABLE PERMIT FOR
CONSTRUCTION MATERIAL STORAGE AND EQUIPMENT STAGING
WATTS CONSTRUCTORS, LLC

Page 2

LAND TITLE STATUS:

Non-ceded - Section 5(a) lands of the Hawai'i Admission Act
DHHL 30% entitlement lands pursuant to Hawai'i Admission Act YES ___ NO X

CURRENT USE STATUS:

Land presently encumbered by Governor's Executive Order No. 3894, setting aside a portion of the Airport under the control and management of the State of Hawai'i, Department of Transportation, Airports Division (DOTA), for Airport purposes.

The DOTA acquired the subject property together with most of the remaining properties (except one) along the ocean (makai) side of Ualena Street, between Lagoon Drive and Paiea Street, in the mid 1990's from Loyalty Enterprises, Ltd.

CHARACTER OF USE:

WATTS will use the space for construction material and equipment staging, at no charge, as specifically stated under Contract No. 64998, State Project No. AO1117-06 (HNL Consolidated Car Rental Facility).

COMMENCEMENT DATE:

To be determined by the Director of Transportation at a later date.

MONTHLY RENTAL:

Not applicable (NA).

DCCA VERIFICATION:

Place of business registration confirmed:	YES <u>X</u>	NO ___
Registered business name confirmed:	YES <u>X</u>	NO ___
Good standing confirmed:	YES <u>X</u>	NO ___

CHAPTER 343, HRS - ENVIRONMENTAL ASSESSMENT:

The DOTA has determined that the subject land areas are covered by the Honolulu International Airport Ualena Street Industrial Lots Acquisition and Chevron Property Acquisition Environmental Assessment (EA) dated October 1990. The EA is published by the Office of Environmental Quality Control (OEQC) in the November 8, 1990 issue of the Environmental Notice. Accordingly, the actions have been determined to have little or no impact upon the environment.

BLNR – ISSUANCE OF A REVOCABLE PERMIT FOR
CONSTRUCTION MATERIAL STORAGE AND EQUIPMENT STAGING
WATTS CONSTRUCTORS, LLC

Page 3

REMARKS:

The Department of Transportation proposes to issue a permit to WATTS for the use of the space for construction material and equipment storage, at no charge, as specifically stated under Contract No. 64998, State Project No. AO1117-06, HNL Consolidated Car Rental Facility, Section 1.04, Provisions for Field Office/Storage Space: “Pending the availability of space on airport property, the State will issue a permit to the Contractor for the use of the space, at no charge, to be used specifically for a field office and/or storage of materials and equipment....”

RECOMMENDATION:

That the Board authorize the Department of Transportation to issue a month-to-month revocable permit to WATTS, subject to: (1) terms and conditions herein outlined, which are by reference incorporated herein; and (2) such additional terms and conditions as may be prescribed by the Director of Transportation to best serve the interests of the State.

Respectfully submitted,



JADE T. BUTAY
Director of Transportation

APPROVED FOR SUBMITTAL:

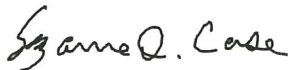

SUZANNE D. CASE
Chairperson and Member

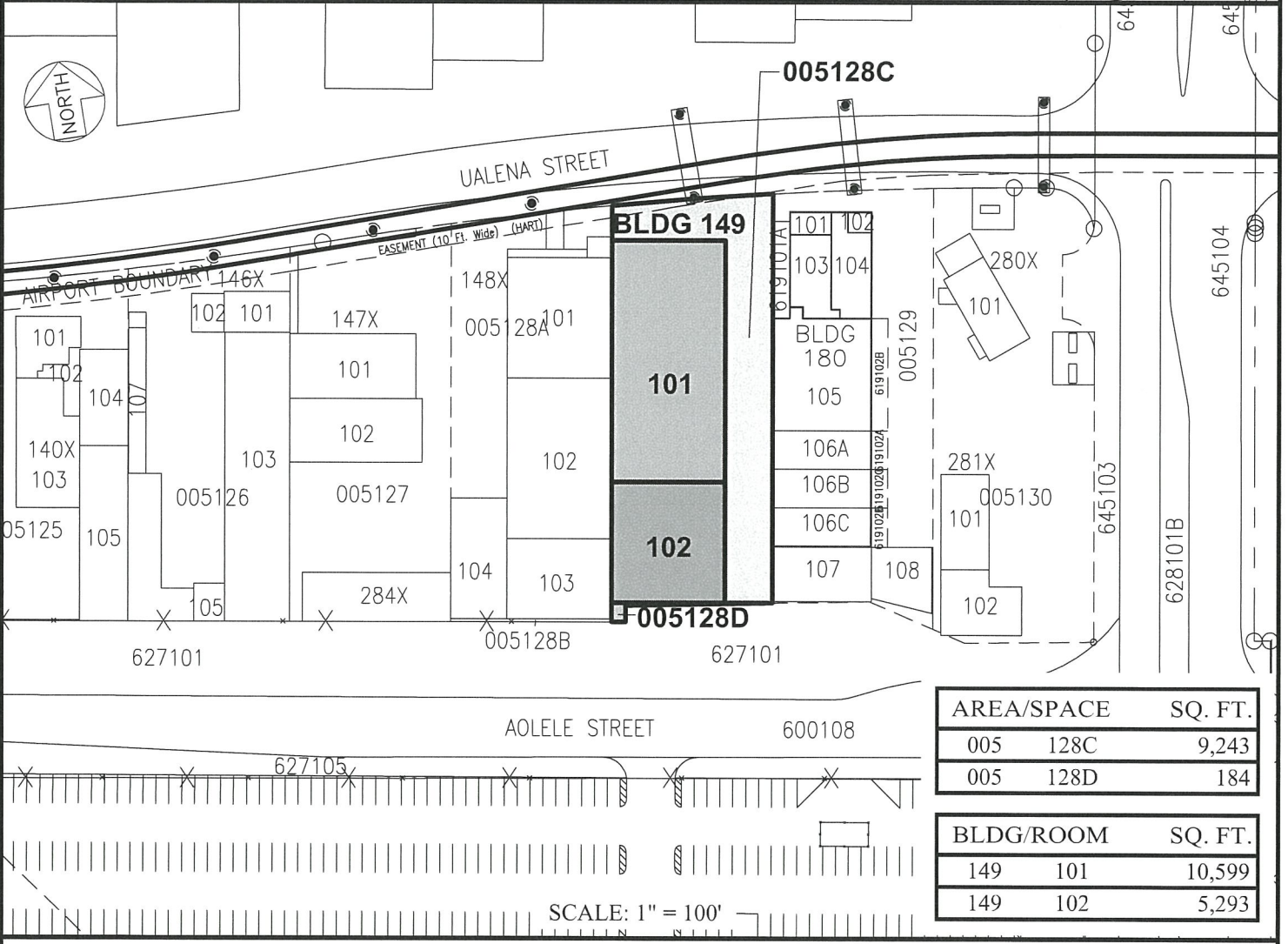
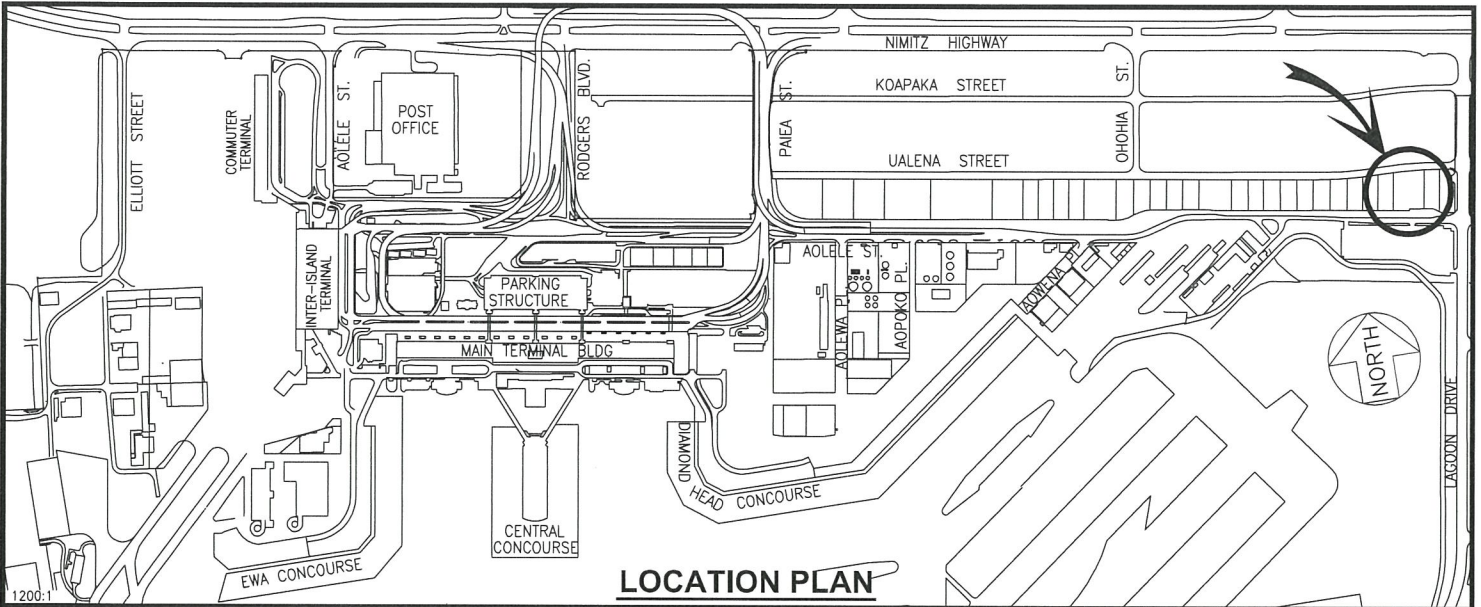

AREA/SPACE	SQ. FT.
005 128C	9,243
005 128D	184

BLDG/ROOM	SQ. FT.
149 101	10,599
149 102	5,293

DATE _____ EXHIBIT: **A**

2825 UALENA STREET
149101
149102
005128C,D
PLAT 16

HONOLULU INTERNATIONAL AIRPORT