

DAVID Y. IGE
GOVERNOR



STATE OF HAWAII
DEPARTMENT OF TRANSPORTATION
869 PUNCHBOWL STREET
HONOLULU, HAWAII 96813-5097

JADE T. BUTAY
DIRECTOR

Deputy Director
LYNN A.S. ARAKI-REGAN
DEREK J. CHOW
ROSS M. HIGASHI
EDWIN H. SNIFFIN

IN REPLY REFER TO:

Board of Land and
Natural Resources
State of Hawai'i
Honolulu, Hawai'i

ISSUANCE OF A REVOCABLE PERMIT FOR OFFICE SPACE FOR THE PURPOSE
OF PROVIDING 24-HOUR EMERGENCY MEDICAL RESPONSE SERVICES
INTERNATIONAL LIFE SUPPORT, INC. DBA AMERICAN MEDICAL RESPONSE
DANIEL K. INOUE INTERNATIONAL AIRPORT
TAX MAP KEY: (1) 1-1-72: 69 (PORTION) O'AHU

APPLICANT:

International Life Support, Inc., dba American Medical Response (ILS), whose mailing
address is 99-840 Iwaiwa Street, Aiea, Hawai'i 96701.

LEGAL REFERENCE:

Section 171-55, Hawai'i Revised Statutes (HRS).

LOCATION:

90 Nakolo Place, Building No. 206, Ground Level at Daniel K. Inouye International
Airport, identified by Tax Map Key: 1st Division, 1-1-72: 69 (Portion).

AREA:

Building/Room No. 206-117, containing an area of approximately 603 square feet;
as shown and delineated on the attached map labeled Exhibit "A".

ZONING:

State Land Use District: Urban
City and County of Honolulu LUO: Industrial (I-2)

ITEM M-1

LAND TITLE STATUS:

Public Law 88-233 - lands of the Hawai'i Admission Act – Ceded
DHHL 30% entitlement lands pursuant to the Hawai'i State Constitution: YES NO

CURRENT USE STATUS:

Land presently encumbered by Governor's Executive Order No. 3201, dated June 8, 1983, setting aside 3,152.177 acres designated as Daniel K. Inouye International Airport under the control and management of the State of Hawai'i, Department of Transportation, Airports Division (DOTA) for Airport Purposes.

CHARACTER OF USE:

ILS will use the space as an office that provides 24-hour emergency medical response services at the Daniel K. Inouye International Airport.

COMMENCEMENT DATE:

Upon execution of the revocable permit.

MONTHLY RENTAL:

\$753.75 (\$301.50, as determined from the DOTA schedule of rates and charges established by appraisal of airports property statewide plus \$301.50 for utilities and \$150.75 for maintenance fees).

SECURITY DEPOSIT:

Three (3) times the monthly rental in effect.

DCCA VERIFICATION:

Place of business registration confirmed:	YES <input checked="" type="checkbox"/>	NO <input type="checkbox"/>
Registered business name confirmed:	YES <input checked="" type="checkbox"/>	NO <input type="checkbox"/>
Good standing confirmed:	YES <input checked="" type="checkbox"/>	NO <input type="checkbox"/>

CHAPTER 343, HRS - ENVIRONMENTAL ASSESSMENT:

The environmental impacts of the proposed action to the subject land area is covered by the Honolulu International Airport Master Plan Update and Noise Compatibility Program Environmental Assessment (EA), State Project No. AO1011-03. The EA is a

BLNR – ISSUANCE OF A REVOCABLE PERMIT FOR OFFICE SPACE FOR THE
PURPOSE OF 24-HOUR EMERGENCY MEDICAL RESPONSE SERVICES,
INTERNATIONAL LIFE SUPPORT, INC. DBA AMERICAN MEDICAL RESPONSE
Page 3

joint State and Federal document dated September 1989, and published in the
October 23, 1989 issue of the OEQC Bulletin. Accordingly, relevant mitigation from the
EA and DOTA environmental best management practice will address minimal impacts
from this action.

REMARKS:

In accordance with Section 171-55, HRS, relating to Permits, the Department of
Transportation (DOT) proposes to issue a month-to-month revocable permit to ILS for
office space that provides 24-hour emergency medical response services at the Daniel K.
Inouye International Airport. DOT has no objections to ILS's request.

RECOMMENDATION:

That the Board authorize the DOT to issue a month-to-month revocable permit to ILS,
subject to: (1) terms and conditions herein outlined, which are by reference incorporated
herein; and (2) such additional terms and conditions as may be prescribed by the Director
of Transportation to best serve the interests of the State.

Respectfully submitted,

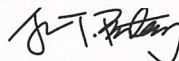

JADE T. BUTAY
Director of Transportation

APPROVED FOR SUBMITTAL:

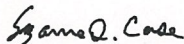

SUZANNE D. CASE
Chairperson and Member

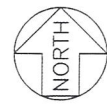
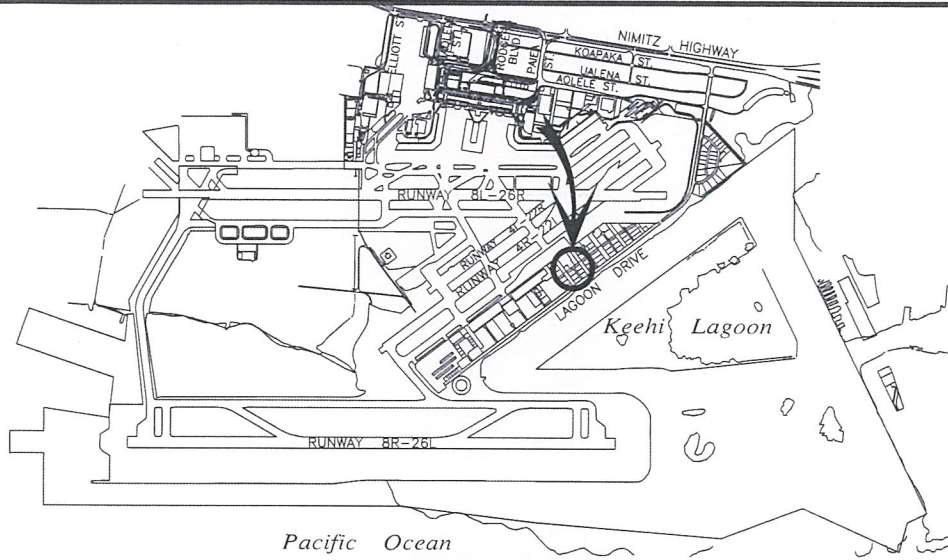

LOCATION PLAN

5000:1

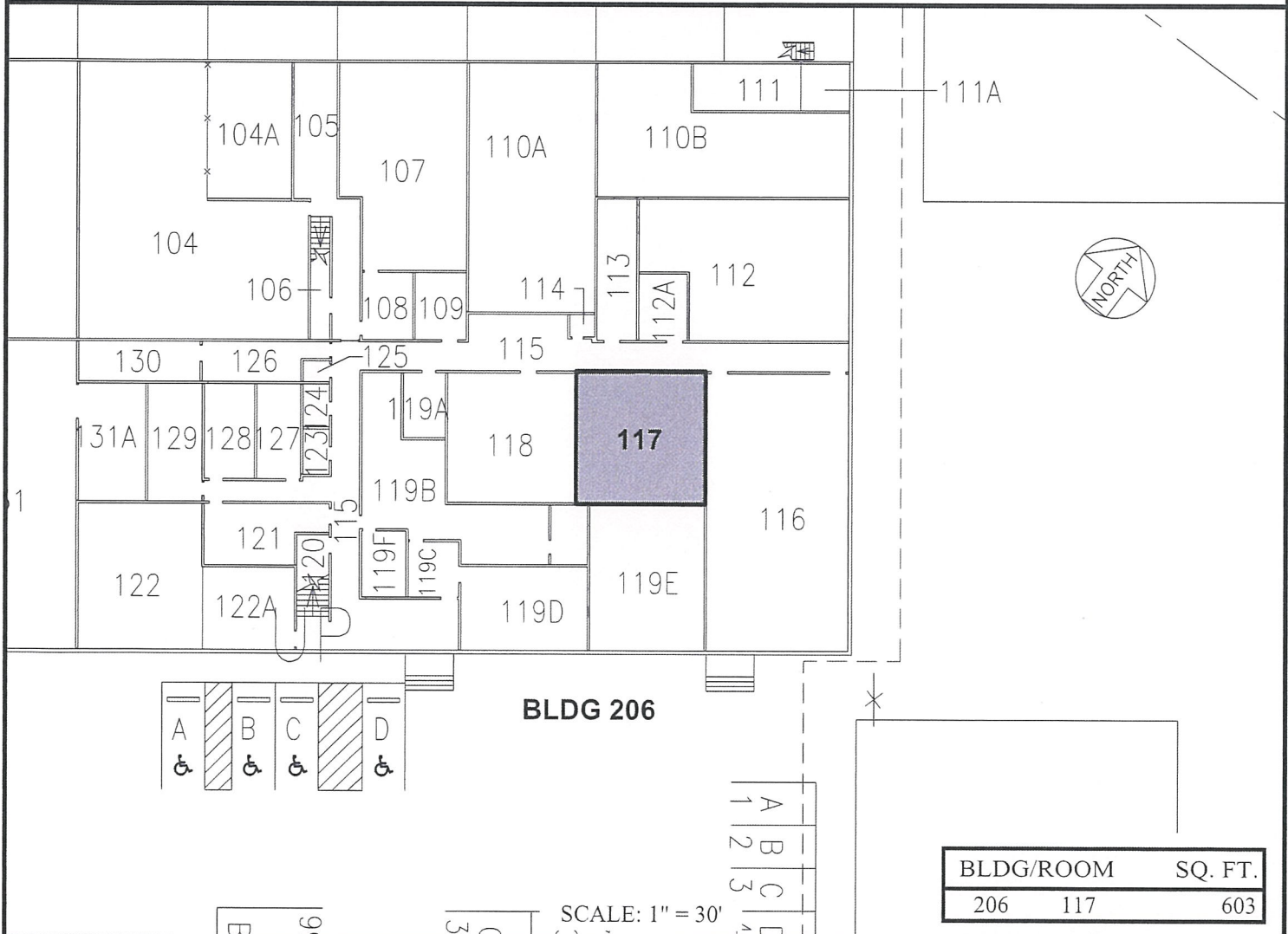

DATE : AUGUST 2020

EXHIBIT: **A**



INTERNATIONAL LIFE
SUPPORT, INC. DBA
AMERICAN MEDICAL RESPONSE

BUILDING 206
AIR SERVICE CORPORATION
GROUND LEVEL

206117
PLAT 36

DANIEL K. INOUE INTERNATIONAL AIRPORT

N:\AIRPORTS\HNL_HONOLULU\CAD\PM\HNL_206117-01.DWG