

DAVID Y. IGE  
GOVERNOR

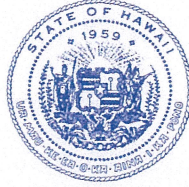

STATE OF HAWAII  
DEPARTMENT OF TRANSPORTATION  
869 PUNCHBOWL STREET  
HONOLULU, HAWAII 96813-5097

JADE T. BUTAY  
DIRECTOR

Deputy Directors  
LYNN A. S. ARAKI-REGAN  
DEREK J. CHOW  
ROSS M. HIGASHI  
EDWIN H. SNIFFEN

IN REPLY REFER TO:

Board of Land and  
Natural Resources  
State of Hawai'i  
Honolulu, Hawai'i

GRANT OF NON-EXCLUSIVE EASEMENTS TO HAWAIIAN ELECTRIC  
COMPANY, INC. FOR UNDERGROUND POWER LINES AND ISSUANCE  
OF IMMEDIATE CONSTRUCTION RIGHT-OF-ENTRY PERMIT  
DANIEL K. INOUE INTERNATIONAL AIRPORT  
TAX MAP KEY NOS: (1) 1-1-003:009 (PORTION),  
(1) 1-1-003:010 (PORTION) AND (1) 1-1-003:035 (PORTION) O'AHU

APPLICANT:

Hawaiian Electric Company, Inc., a Hawai'i corporation, whose post office address is  
P.O. Box 2750, Honolulu, Hawai'i 96840

LEGAL REFERENCE:

Sections 171-13, 55 and 95, Hawai'i Revised Statutes ("HRS"), as amended.

LOCATION AND TAX MAP KEY:

Underground power line easements affecting portions of Lot 3774, Map 629, Land Court  
Application No. 1074, situate at Moanalua, Honolulu, Island of O'ahu, State of Hawai'i,  
identified by Tax Map Key: 1<sup>st</sup> Division, 1-1-003:009 (Portion), 1<sup>st</sup> Division, 1-1-  
003:010 (Portion) and 1<sup>st</sup> Division, 1-1-003:035 (Portion), as shown on the attached map  
labeled Exhibit A.

AREA:

Easement 601 – approximately 2,800 square feet, TMK: (1) 1-1-003:009 (Portion); and  
Easement 603 – approximately 200 square feet, TMK: (1) 1-1-003:010 (Portion); and  
Easement 604 – approximately 320 square feet, TMK: (1) 1-1-003:035 (Portion),  
as shown and delineated on the attached Exhibits B and B-1.

**ITEM M-1**

ZONING:

State Land Use: Urban  
County: I-2 (Industrial)

LAND TITLE STATUS:

Section 5(a), Hawai‘i Admissions Act: Non-Ceded  
DHHL, 30% entitlement lands Yes  No

CURRENT USE STATUS:

Land encumbered under Governor’s Executive Order No. 3201, dated June 8, 1983, setting aside 2,704.167 acres designated as Daniel K. Inouye International Airport under the control and management of the Department of Transportation, Airports Division, State of Hawai‘i, for airport purposes. TMK Nos. (1) 1-1-003:009 & 010 are leased to Hawaii Fueling Facilities Corporation (HFFC), State Lease No. DOT-A-15-0014, for a Fueling Facility Lease. TMK No. (1) 1-1-003:035 is under the management of Delta Air Lines, Inc. for cargo facilities.

CHARACTER OF USE:

Right, privilege and authority to access, construct, use, maintain, repair, replace, remove and operate electric transmission wire lines, transformer, switching vault and such other appliances and equipment as may be necessary for the transmission and distribution of electricity and/or communication and control circuits, including the right to trim and keep trimmed any trees in the way of its appliances and equipment.

TERM:

Perpetual.

CONSIDERATION:

Gratis.

CHAPTER 343, HRS – ENVIRONMENTAL ASSESSMENT:

All environmental impacts and mitigation to the subject project were evaluated in the Honolulu High Capacity Transit Corridor Final Environmental Impact Statement (EIS), published in the OEQC Environmental Notice on July 8, 2010. The EIS was accepted and published in The Environmental Notice on January 8, 2011.

APPLICANT REQUIREMENTS:

1. Applicant shall be required to provide survey maps and descriptions according to State DAGS standards and at Applicant's own cost;
2. Applicant shall be required to process and obtain designation of easement approvals from the Department of Planning and Permitting, City and County of Honolulu, at Applicant's own cost.

DCCA VERIFICATION:

Place of business registration confirmed:	YES <u>X</u>	NO _____
Registered business name confirmed:	YES <u>X</u>	NO _____
Good standing confirmed:	YES <u>X</u>	NO _____

REMARKS:

The City and County of Honolulu (City), through the Honolulu Authority for Rapid Transportation, a semi-autonomous agency of the City, is constructing the Honolulu Rail Transit Project's Airport Guideway and Station (HRTP-Airport) section through Daniel K. Inouye International Airport. As a result of the HRTP-Airport guideway alignment, portions of Hawaiian Electric Company, Inc.'s (HECO) existing utility facilities are required to be relocated. The relocated portions are identified as Easement 601, consisting of approximately 2,800 square feet, Easement 603, consisting of approximately 200 square feet and Easement 604, consisting of approximately 320 square feet, see attached Exhibit B and B-1.

Easements 601 and 603 will encumber portions of properties leased to Hawaii Fueling Facilities Corporation (HFFC). Easement 604 will encumber a portion of property under the management of Delta Air Lines, Inc (Delta). HFFC and Delta have been informed of the proposed HECO utility easements.

HECO is also requesting a construction and management right-of-entry which shall expire upon issuance of the requested easements. The right-of-entry agreement may be amended upon mutual agreement of the parties.

Applicant has not had a lease, permit, easement or other disposition of State lands terminated within the last five years due to non-compliance with such terms and conditions.

There are no other pertinent issues or concerns.

RECOMMENDATION:

That the Board, subject to Applicant fulfilling the Applicant Requirements above:

1. Authorize the issuance of perpetual non-exclusive easements to HECO covering the subject area for utility purposes, under the terms and conditions cited above, which are by this reference incorporated herein and further subject to the following:
  - A. The standard terms and conditions of the most current perpetual easement document form, as may be amended from time to time;
  - B. Review and approval by the Department of the Attorney General; and
  - C. Such other terms and conditions as may be prescribed by the Chairperson or the Director of Transportation to best serve the interests of the State.
  
2. Authorize the issuance of a right-of-entry permit to HECO covering the subject area under the terms and conditions cited above, which are by this reference incorporated herein and further subject to the following:
  - A. The standard terms and conditions of the most current right-of-entry permit form, as may be amended from time to time;
  - B. The right-of-entry permit shall remain in force until the grant of easement has been issued;
  - C. Review and approval by the Department of the Attorney General; and
  - D. Such other terms and conditions as may be prescribed by the Chairperson or the Director of Transportation to best serve the interests of the State.

Respectfully submitted,



JADE T. BUTAY  
Director of Transportation

APPROVED FOR SUBMITTAL:

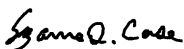

SUZANNE D. CASE  
Chairperson and Member

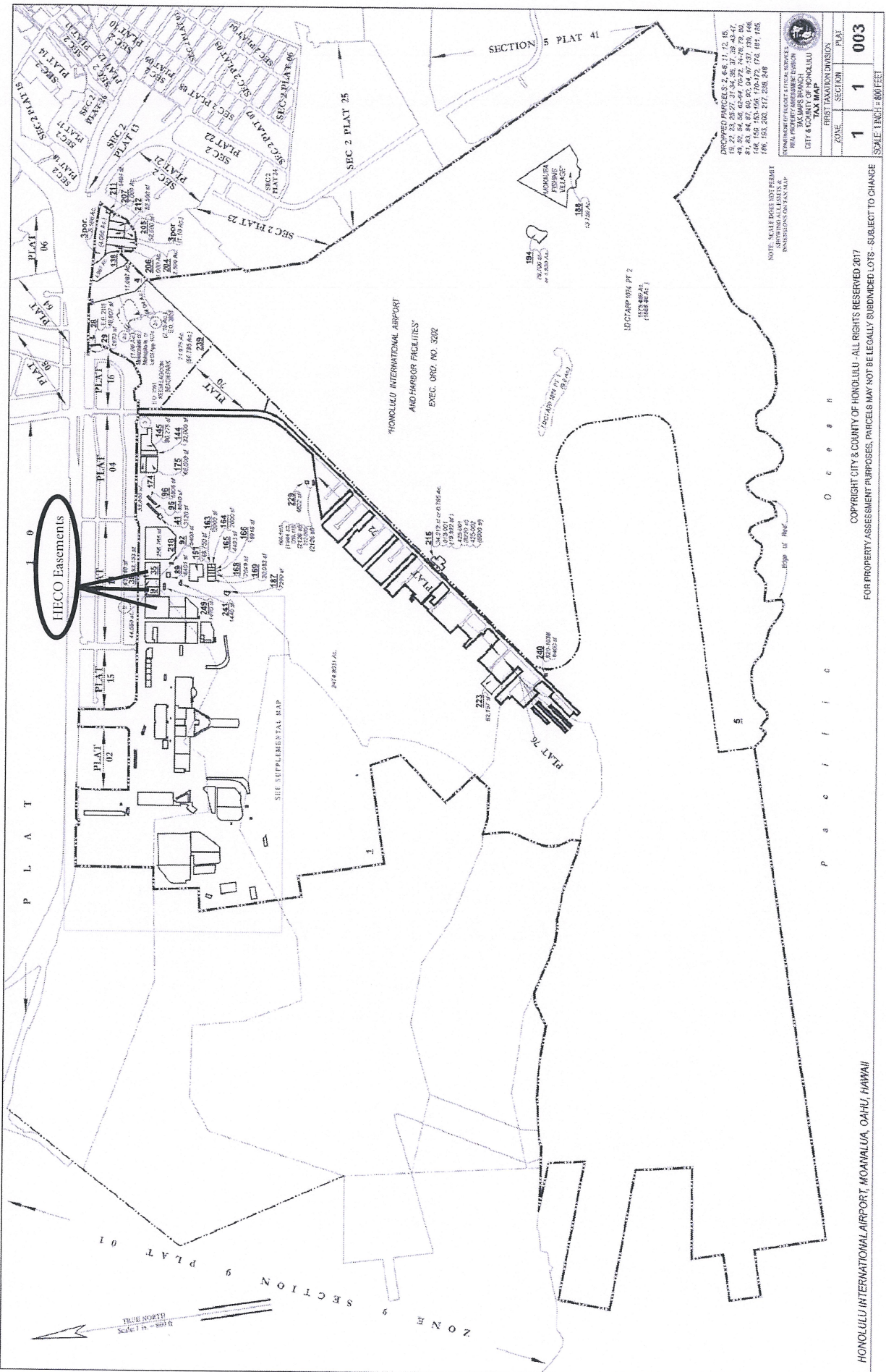

DRAWN PARCELS 2, 68, 71, 72, 105, 106, 107, 108, 109, 110, 111, 112, 113, 114, 115, 116, 117, 118, 119, 120, 121, 122, 123, 124, 125, 126, 127, 128, 129, 130, 131, 132, 133, 134, 135, 136, 137, 138, 139, 140, 141, 142, 143, 144, 145, 146, 147, 148, 149, 150, 151, 152, 153, 154, 155, 156, 157, 158, 159, 160, 161, 162, 163, 164, 165, 166, 167, 168, 169, 170, 171, 172, 173, 174, 175, 176, 177, 178, 179, 180, 181, 182, 183, 184, 185, 186, 187, 188, 189, 190, 191, 192, 193, 194, 195, 196, 197, 198, 199, 200, 201, 202, 203, 204, 205, 206, 207, 208, 209, 210, 211, 212, 213, 214, 215, 216, 217, 218, 219, 220, 221, 222, 223, 224, 225, 226, 227, 228, 229, 230, 231, 232, 233, 234, 235, 236, 237, 238, 239, 240, 241, 242, 243, 244, 245, 246, 247, 248, 249, 250, 251, 252, 253, 254, 255, 256, 257, 258, 259, 260, 261, 262, 263, 264, 265, 266, 267, 268, 269, 270, 271, 272, 273, 274, 275, 276, 277, 278, 279, 280, 281, 282, 283, 284, 285, 286, 287, 288, 289, 290, 291, 292, 293, 294, 295, 296, 297, 298, 299, 300, 301, 302, 303, 304, 305, 306, 307, 308, 309, 310, 311, 312, 313, 314, 315, 316, 317, 318, 319, 320, 321, 322, 323, 324, 325, 326, 327, 328, 329, 330, 331, 332, 333, 334, 335, 336, 337, 338, 339, 340, 341, 342, 343, 344, 345, 346, 347, 348, 349, 350, 351, 352, 353, 354, 355, 356, 357, 358, 359, 360, 361, 362, 363, 364, 365, 366, 367, 368, 369, 370, 371, 372, 373, 374, 375, 376, 377, 378, 379, 380, 381, 382, 383, 384, 385, 386, 387, 388, 389, 390, 391, 392, 393, 394, 395, 396, 397, 398, 399, 400, 401, 402, 403, 404, 405, 406, 407, 408, 409, 410, 411, 412, 413, 414, 415, 416, 417, 418, 419, 420, 421, 422, 423, 424, 425, 426, 427, 428, 429, 430, 431, 432, 433, 434, 435, 436, 437, 438, 439, 440, 441, 442, 443, 444, 445, 446, 447, 448, 449, 450, 451, 452, 453, 454, 455, 456, 457, 458, 459, 460, 461, 462, 463, 464, 465, 466, 467, 468, 469, 470, 471, 472, 473, 474, 475, 476, 477, 478, 479, 480, 481, 482, 483, 484, 485, 486, 487, 488, 489, 490, 491, 492, 493, 494, 495, 496, 497, 498, 499, 500, 501, 502, 503, 504, 505, 506, 507, 508, 509, 510, 511, 512, 513, 514, 515, 516, 517, 518, 519, 520, 521, 522, 523, 524, 525, 526, 527, 528, 529, 530, 531, 532, 533, 534, 535, 536, 537, 538, 539, 540, 541, 542, 543, 544, 545, 546, 547, 548, 549, 550, 551, 552, 553, 554, 555, 556, 557, 558, 559, 560, 561, 562, 563, 564, 565, 566, 567, 568, 569, 570, 571, 572, 573, 574, 575, 576, 577, 578, 579, 580, 581, 582, 583, 584, 585, 586, 587, 588, 589, 590, 591, 592, 593, 594, 595, 596, 597, 598, 599, 600, 601, 602, 603, 604, 605, 606, 607, 608, 609, 610, 611, 612, 613, 614, 615, 616, 617, 618, 619, 620, 621, 622, 623, 624, 625, 626, 627, 628, 629, 630, 631, 632, 633, 634, 635, 636, 637, 638, 639, 640, 641, 642, 643, 644, 645, 646, 647, 648, 649, 650, 651, 652, 653, 654, 655, 656, 657, 658, 659, 660, 661, 662, 663, 664, 665, 666, 667, 668, 669, 670, 671, 672, 673, 674, 675, 676, 677, 678, 679, 680, 681, 682, 683, 684, 685, 686, 687, 688, 689, 690, 691, 692, 693, 694, 695, 696, 697, 698, 699, 700, 701, 702, 703, 704, 705, 706, 707, 708, 709, 710, 711, 712, 713, 714, 715, 716, 717, 718, 719, 720, 721, 722, 723, 724, 725, 726, 727, 728, 729, 730, 731, 732, 733, 734, 735, 736, 737, 738, 739, 740, 741, 742, 743, 744, 745, 746, 747, 748, 749, 750, 751, 752, 753, 754, 755, 756, 757, 758, 759, 760, 761, 762, 763, 764, 765, 766, 767, 768, 769, 770, 771, 772, 773, 774, 775, 776, 777, 778, 779, 780, 781, 782, 783, 784, 785, 786, 787, 788, 789, 790, 791, 792, 793, 794, 795, 796, 797, 798, 799, 800, 801, 802, 803, 804, 805, 806, 807, 808, 809, 810, 811, 812, 813, 814, 815, 816, 817, 818, 819, 820, 821, 822, 823, 824, 825, 826, 827, 828, 829, 830, 831, 832, 833, 834, 835, 836, 837, 838, 839, 840, 841, 842, 843, 844, 845, 846, 847, 848, 849, 850, 851, 852, 853, 854, 855, 856, 857, 858, 859, 860, 861, 862, 863, 864, 865, 866, 867, 868, 869, 870, 871, 872, 873, 874, 875, 876, 877, 878, 879, 880, 881, 882, 883, 884, 885, 886, 887, 888, 889, 890, 891, 892, 893, 894, 895, 896, 897, 898, 899, 900, 901, 902, 903, 904, 905, 906, 907, 908, 909, 910, 911, 912, 913, 914, 915, 916, 917, 918, 919, 920, 921, 922, 923, 924, 925, 926, 927, 928, 929, 930, 931, 932, 933, 934, 935, 936, 937, 938, 939, 940, 941, 942, 943, 944, 945, 946, 947, 948, 949, 950, 951, 952, 953, 954, 955, 956, 957, 958, 959, 960, 961, 962, 963, 964, 965, 966, 967, 968, 969, 970, 971, 972, 973, 974, 975, 976, 977, 978, 979, 980, 981, 982, 983, 984, 985, 986, 987, 988, 989, 990, 991, 992, 993, 994, 995, 996, 997, 998, 999, 1000.

NOTE: STATE DOES NOT REBURY  
 REAR PLATS OF THIS MAP  
 INSURRECTION FOR ANY WAY

FIRST TARIATION DIVISION	
ZONE	SECTION
1	1

PLAT NO. 003

HONOLULU INTERNATIONAL AIRPORT, MOANALUA, OAHU, HAWAII

COPYRIGHT CITY & COUNTY OF HONOLULU - ALL RIGHTS RESERVED 2017  
 FOR PROPERTY ASSESSMENT PURPOSES, PARCELS MAY NOT BE LEGALLY SUBDIVIDED LOTS - SUBJECT TO CHANGE

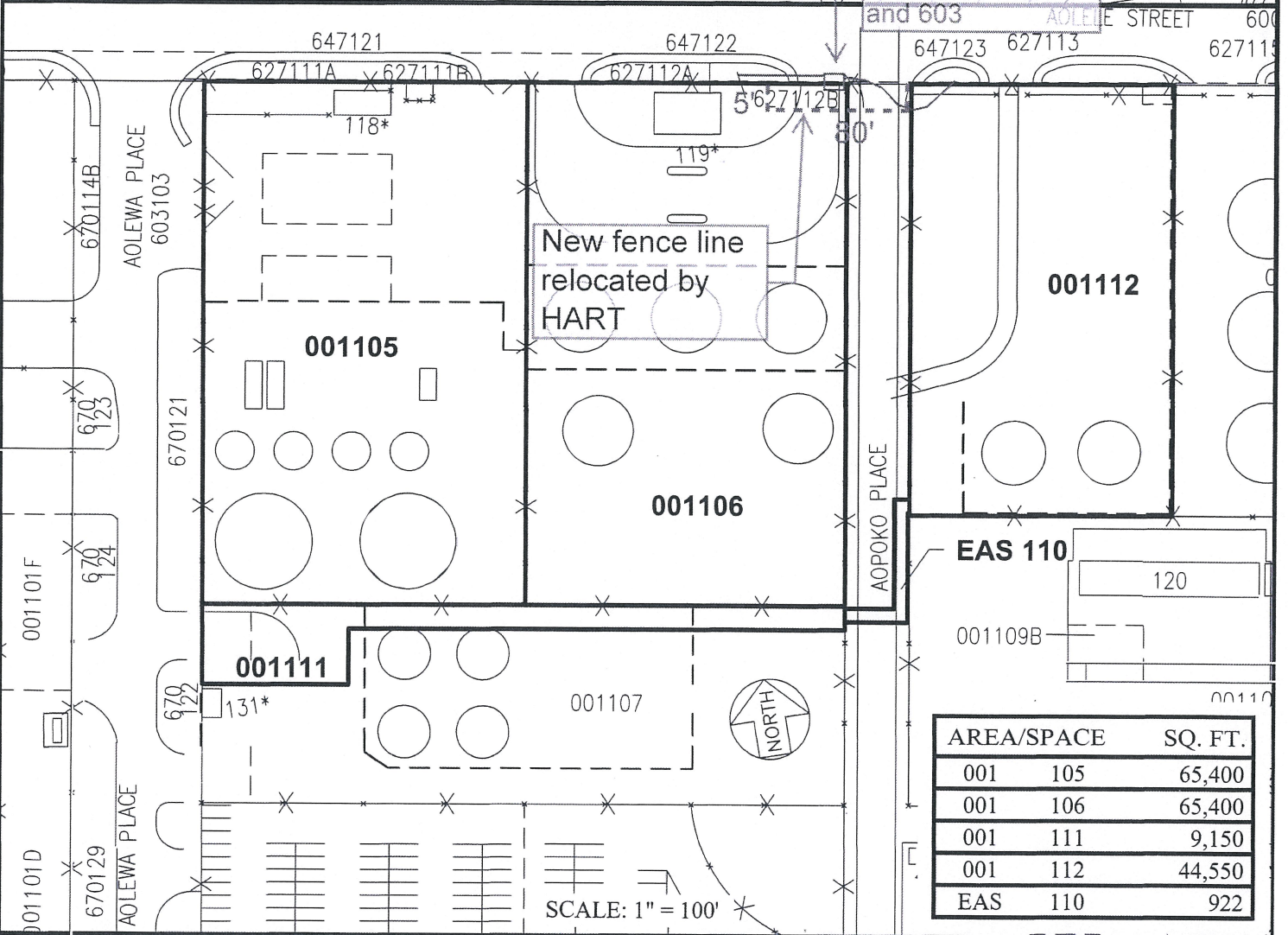
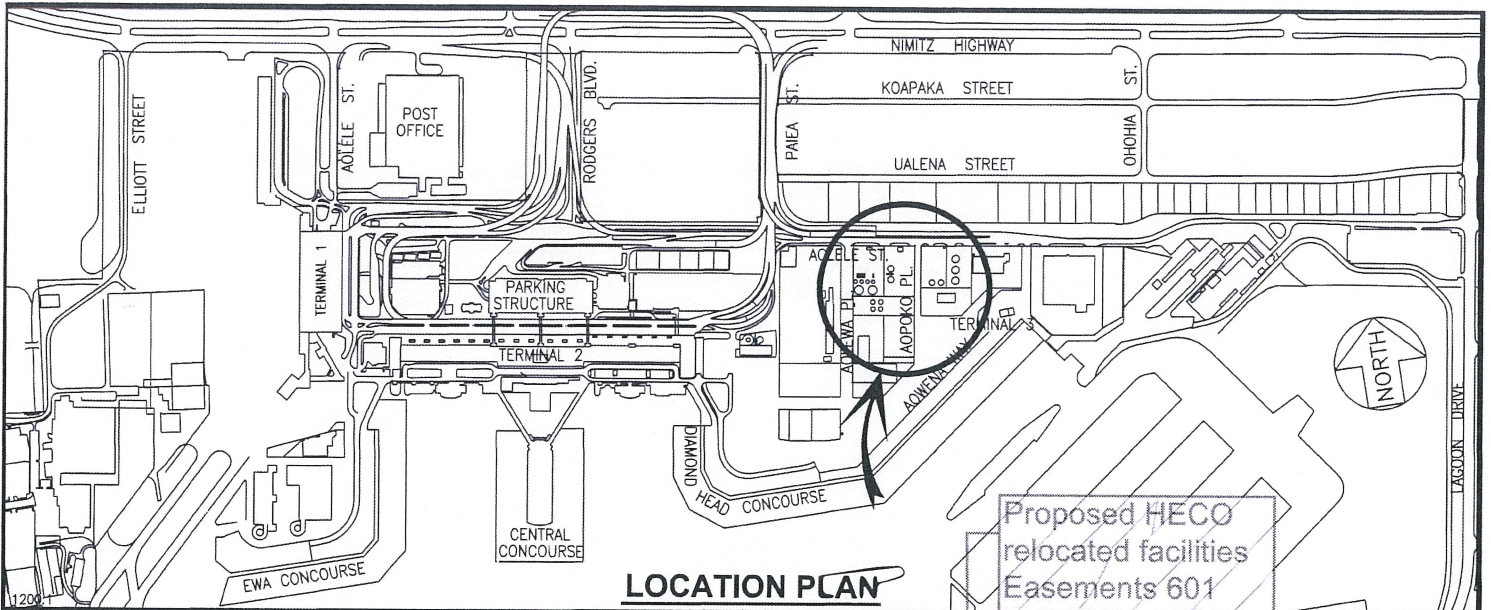

DATE : NOVEMBER 2011

EXHIBIT: **B**



HAWAII FUELING  
FACILITIES CORPORATION

NORTH RAMP  
GENERAL AVIATION AREA

001105-106  
001111-112  
EAS 110  
PLAT 26

**DANIEL K. INOUE INTERNATIONAL AIRPORT**

N:\AIRPORTS\HNL\_HONOLULU\CAD\PM\HNL\_001105-01.DWG

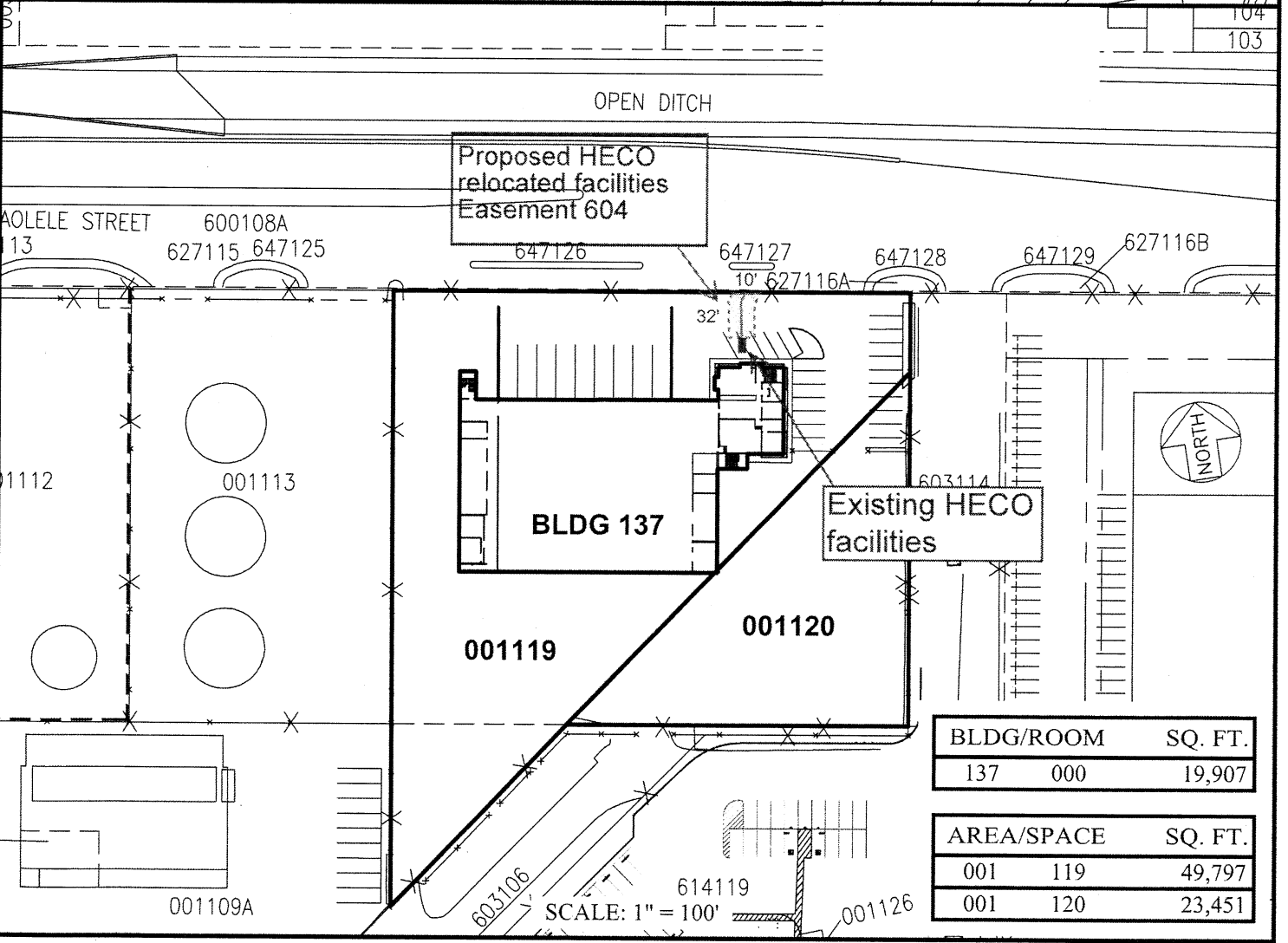
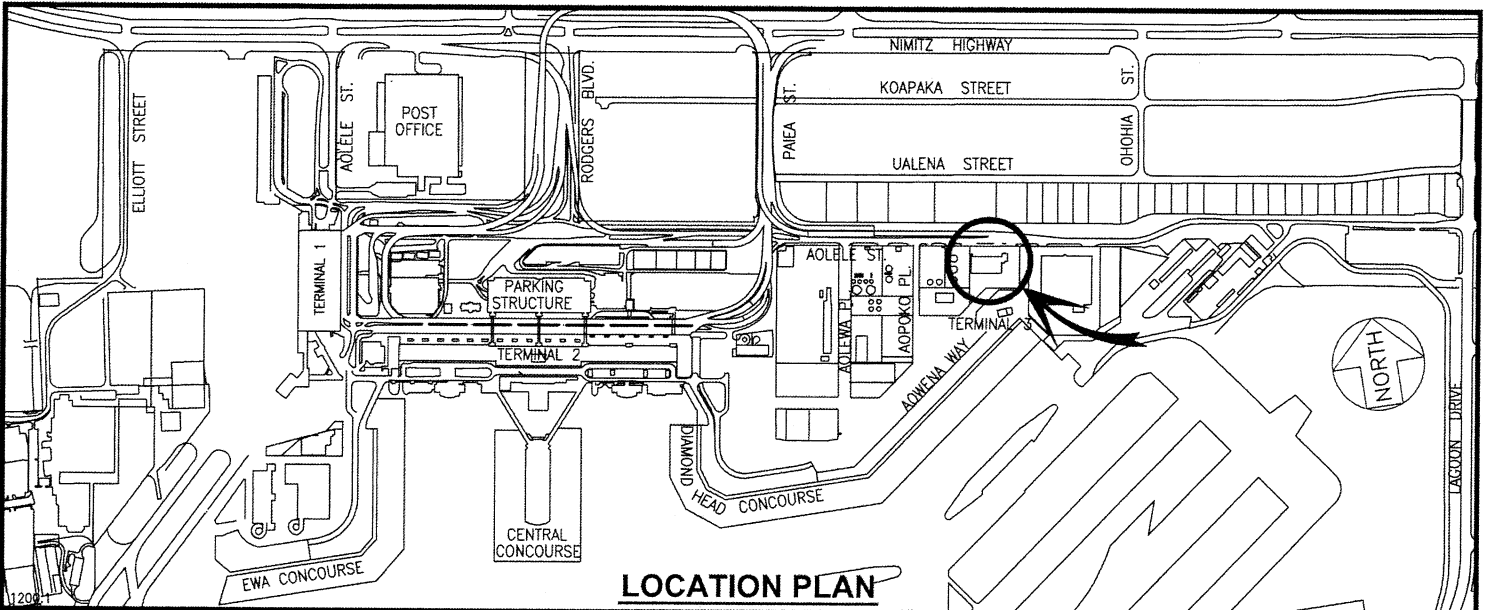

BLDG/ROOM	SQ. FT.
137 000	19,907

AREA/SPACE	SQ. FT.
001 119	49,797
001 120	23,451

DATE : JUNE, 2006

EXHIBIT: **B-1**



DELTA AIR LINES, INC.

DELTA CARGO  
NORTH RAMP

BLDG 137  
001119, 120  
PLAT 26

**DANIEL K. INOUE INTERNATIONAL AIRPORT**

N:\AIRPORTS\HNL\_HONOLULU\CAD\PM\HNL\_137000-01.DWG