

DAVID Y. IGE
GOVERNOR



STATE OF HAWAII
DEPARTMENT OF TRANSPORTATION
869 PUNCHBOWL STREET
HONOLULU, HAWAII 96813-5097

JADE T. BUTAY
DIRECTOR

Deputy Directors
LYNN A. S. ARAKI-REGAN
DEREK J. CHOW
ROSS M. HIGASHI
EDWIN H. SNIFFEN

IN REPLY REFER TO:

Board of Land and
Natural Resources
State of Hawai'i
Honolulu, Hawai'i

ISSUANCE OF A REVOCABLE PERMIT FOR A T-HANGAR
FOR STORAGE AND MAINTENANCE OF AIRCRAFT
SNOWBIRD AIR, LLC
KALAELOA AIRPORT
TAX MAP KEY: (1) 9-1-13: PORTION OF 32

O'AHU

REQUEST:

Issuance of a Revocable Permit for a T-Hangar for storage and maintenance of aircraft to Snowbird Air, LLC, situated at Kalaeloa Airport.

LEGAL REFERENCE:

Section 171-55, Hawai'i Revised Statutes (HRS).

APPLICANT:

Snowbird Air, LLC, whose mailing address is 16942 Eleonora Street, Eagle River, Alaska 99577.

LOCATION AND TAX MAP KEY:

A portion of Kalaeloa Airport, Kapolei, Island of O'ahu, State of Hawai'i, identified by Tax Map Key: 1st Division, 9-1-13: portion of 32.

AREA:

Building/Room No. 411-106, containing an area of approximately 1,280 square feet, as shown and delineated on the attached map labeled Exhibit "A".

ITEM M-4

BLNR – ISSUANCE OF A REVOCABLE PERMIT FOR A T-HANGAR FOR STORAGE AND MAINTENANCE OF AIRCRAFT, SNOWBIRD AIR, LLC
PAGE 2

ZONING:

State Land Use District: Urban
City and County of Honolulu LUO: P-2 (To be rezoned in the future)

LAND TITLE STATUS:

Non-ceded - Section 5(a) lands of the Hawai'i Admission Act
DHHL 30% entitlement lands pursuant to Hawai'i Admission Act YES ___ NO X

CURRENT USE STATUS:

Land presently encumbered by Governor's Executive Order No. 3861, setting aside Kalaeloa Airport under the control and management of the Department of Transportation, Airports Division (DOTA), State of Hawai'i, for Airport Purposes.

CHARACTER OF USE:

T-Hangar for the storage and maintenance of aircraft, (1976 Piper PA-23-250, Tail No. N-1715Y).

COMMENCEMENT DATE:

To be determined by the Director of Transportation at a later date.

MONTHLY RENTAL:

\$1,408.00, as determined from the DOTA schedule of rates and charges for T-Hangar (Commercial Rate), established by appraisal of Airports property statewide

SECURITY DEPOSIT:

Three (3) times the monthly rental in effect.

CHAPTER 343, HRS - ENVIRONMENTAL ASSESSMENT:

The subject land area is covered by the Final Environmental Assessment for the Kalaeloa Airfield Development Plan Improvements, State Project No. AO5011-02 dated June 2010. This Environmental Assessment was prepared by Wilson Okamoto Corp. for the State of Hawai'i, Department of Transportation, Airports Division, in part to evaluate the environmental effects of the recommended Kalaeloa Airfield Master Plan to meet existing and forecast general aviation demands.

BLNR – ISSUANCE OF A REVOCABLE PERMIT FOR A T-HANGAR FOR STORAGE
AND MAINTENANCE OF AIRCRAFT, SNOWBIRD AIR, LLC
PAGE 3

REMARKS:

The issuance of a revocable permit to Snowbird Air, LLC, for a T-Hangar for storage and maintenance of aircraft at Kalaeloa Airport complies with Chapter 343, Exemption Class 1.D.10 as a continuing aeronautical use, and is in accordance with Section 171-55 HRS, relating to Permits.

RECOMMENDATION:

That the Board authorize the Department of Transportation to issue a month-to-month revocable permit to Snowbird Air, LLC, subject to: (1) terms and conditions herein outlined, which are by reference incorporated herein; and (2) such additional terms and conditions as may be prescribed by the Director of Transportation to best serve the interests of the State.

Respectfully submitted,

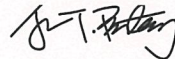

JADE T. BUTAY
Director of Transportation

APPROVED FOR SUBMITTAL:

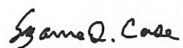

SUZANNE D. CASE
Chairperson and Member

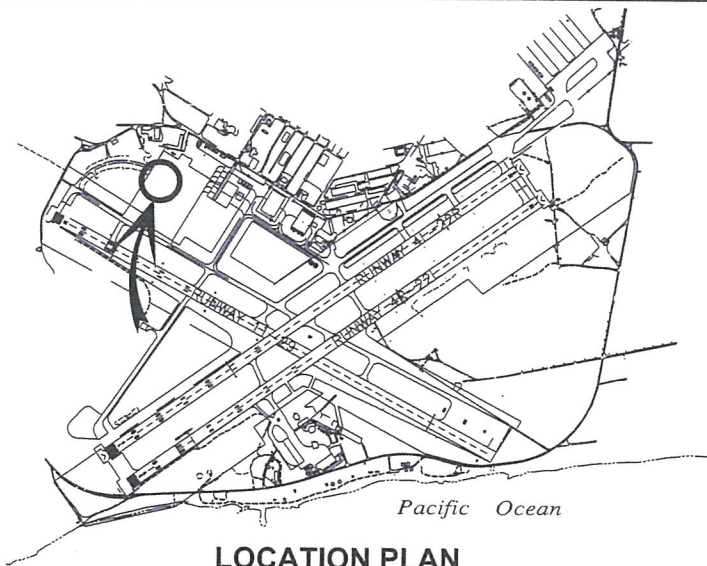

LOCATION PLAN

3000:1

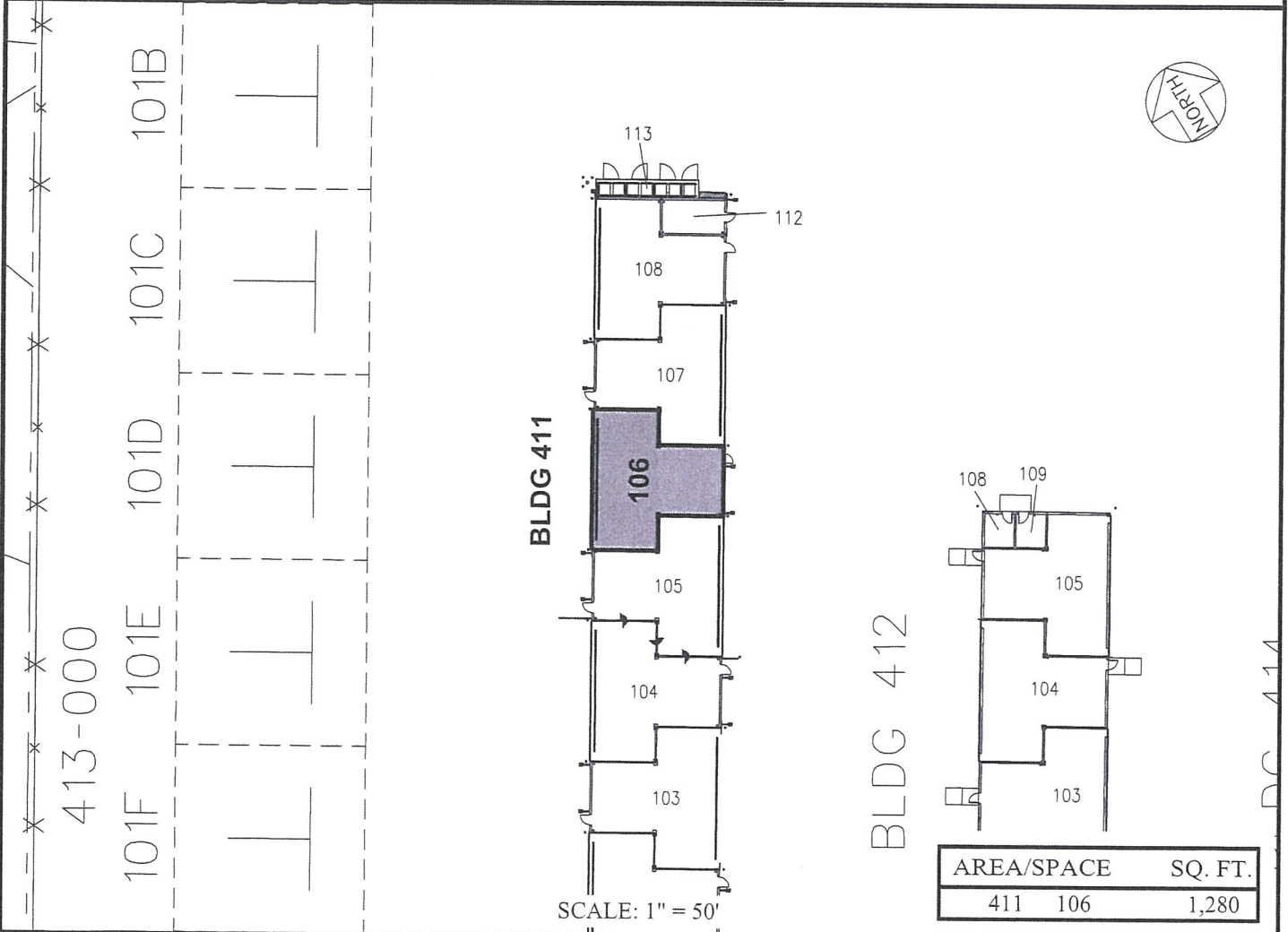

BLDG 411

BLDG 412

SCALE: 1" = 50'

AREA/SPACE	SQ. FT.
411 106	1,280

RP-9007

DATE : JULY 2020

EXHIBIT: **A**



Airports Division

SNOWBIRD AIR, LLC

T-HANGAR
GENERAL AVIATION

411106

KALAELOA AIRPORT

N:\AIRPORTS\JRF_Kalaeloa\CAD\PM\jrf_411106-01.dwg