

DAVID Y. IGE  
GOVERNOR



STATE OF HAWAII  
DEPARTMENT OF TRANSPORTATION  
869 PUNCHBOWL STREET  
HONOLULU, HAWAII 96813-5097

JADE T. BUTAY  
DIRECTOR

Deputy Directors  
LYNN A. S. ARAKI-REGAN  
DEREK J. CHOW  
ROSS M. HIGASHI  
EDWIN H. SNIFFEN

IN REPLY REFER TO:

Board of Land and  
Natural Resources  
State of Hawai'i  
Honolulu, Hawai'i

ISSUANCE OF A REVOCABLE PERMIT FOR TEMPORARY  
STORAGE AND MAINTENANCE OF AIRCRAFT  
SEAWINGS LLC  
ELLISON ONIZUKA KONA INTERNATIONAL AIRPORT AT KEĀHOLE  
TAX MAP KEY: (3) 7-3-43: PORTION OF 03

HAWAII

LEGAL REFERENCE:

Section 171-55, Hawai'i Revised Statutes.

APPLICANT:

Seawings LLC (Seawings), whose business address is P.O. Box 551, Holualoa, Hawai'i 96725.

LOCATION AND TAX MAP KEY:

Portion of Ellison Onizuka Kona International Airport at Keāhole (KOA), Kailua-Kona, Island of Hawai'i, identified by Tax Map Key: 3rd Division, 7-3-43: Portion of 03.

AREA:

Area/Space No. 517-108D, containing an area of approximately 2,861 square feet (1/3 share), as shown and delineated on the attached Exhibit A.

ZONING:

State Land Use District:	Urban & Conservation
County of Hawai'i:	Industrial (MG-1a) and Open

**ITEM M-6**

LAND TITLE STATUS:

Section 5(a) lands of the Hawai'i Admission Act: Ceded  
DHHL 30% entitlement lands pursuant to Hawai'i Admission Act YES \_\_\_ NO X

CURRENT USE STATUS:

Airport and aeronautical purposes.

CHARACTER OF USE:

Seawings will use the space for aircraft parking and maintenance.

COMMENCEMENT DATE:

Upon execution of the revocable permit.

MONTHLY RENTAL:

\$245.57 (as determined from the DOTA schedule of rates and charges established by appraisal of Airports property statewide).

SECURITY DEPOSIT:

\$736.71 or three times the monthly rental in effect.

DCCA VERIFICATION:

Place of business registration confirmed:	YES <u>X</u>	NO _____
Registered business name confirmed:	YES <u>X</u>	NO _____
Good standing confirmed:	YES <u>X</u>	NO _____

CHAPTER 343, HRS - ENVIRONMENTAL ASSESSMENT:

The State of Hawaii, Department of Transportation, Airports Division (HDOT-A), has determined that the subject land areas are covered by the Keahole Airport Master Plan Final Environmental Impact Statement (EIS), published by the Office of Environmental Quality Control (OEQC) in the November 8, 1988, issue of The Environmental Notice and accepted by the Governor on December 19, 1988.

BLNR – ISSUANCE OF A REVOCABLE PERMIT TO SEAWINGS LLC FOR THE  
PURPOSE OF TEMPORARY STORAGE AND MAINTENANCE OF AIRCRAFT  
Page 3

REMARKS:

In accordance with Section 171-55 HRS, relating to Permits, the Department of Transportation proposes to issue a month-to-month revocable permit to Seawings for aircraft parking and maintenance.

RECOMMENDATION:

That the Board authorize the Department of Transportation to issue a month-to-month revocable permit to Seawings, subject to: (1) terms and conditions herein outlined, which are by reference incorporated herein; and (2) such additional terms and conditions as may be prescribed by the Director of Transportation to best serve the interests of the State.

Respectfully submitted,

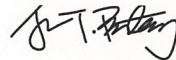

JADE T. BUTAY  
Director of Transportation

APPROVED FOR SUBMITTAL:

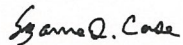

SUZANNE D. CASE  
Chairperson and Member

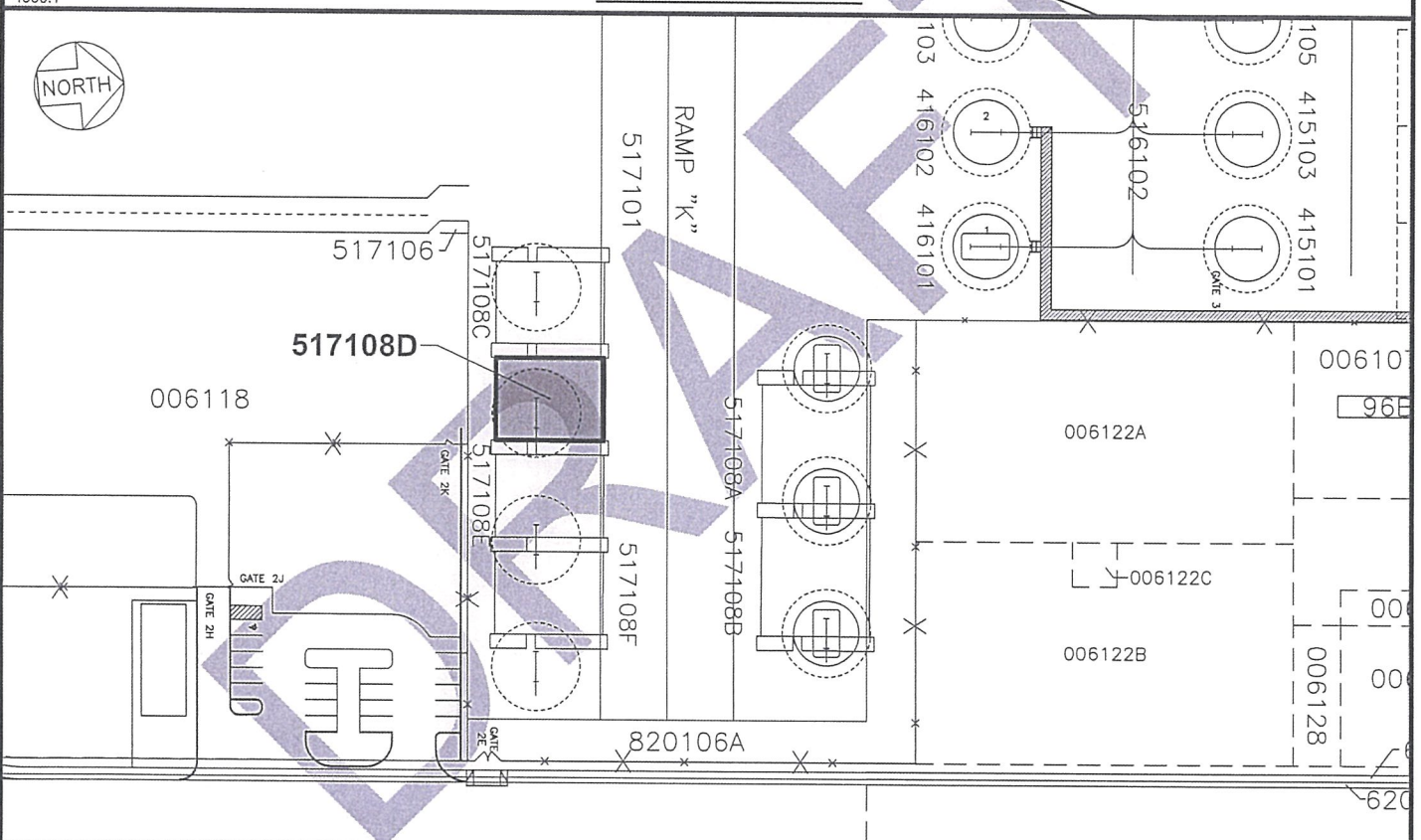
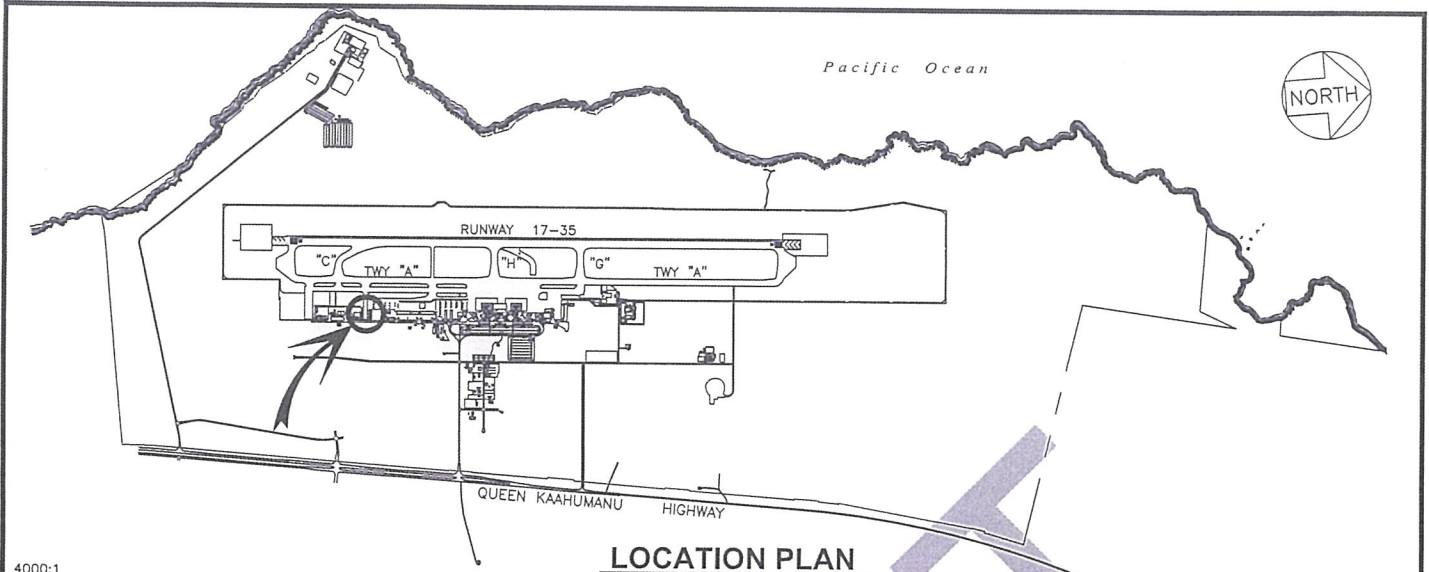

AREA/SPACE	SQ. FT.
517 108D	2,861

SCALE: 1" = 100'

DATE : SEPTEMBER 2020 EXHIBIT: **A**

<p>Department of Transportation State of Hawaii</p> <p>Airports Division</p>	SEAWINGS LLC	TAXIWAY "K"	517108D
			PLAT 40

**ELLISON ONIZUKA KONA INTERNATIONAL AIRPORT AT KEAHOLE**

N:\AIRPORTS\KOA\_Kona\CAD\PM\koa\_517108d-04\_draft.dwg