

DAVID Y. IGE
GOVERNOR



STATE OF HAWAII
DEPARTMENT OF TRANSPORTATION
869 PUNCHBOWL STREET
HONOLULU, HAWAII 96813-5097

JADE T. BUTAY
DIRECTOR

Deputy Directors
LYNN A. S. ARAKI-REGAN
DEREK J. CHOW
ROSS M. HIGASHI
EDWIN H. SNIFFEN

IN REPLY REFER TO:

Board of Land and
Natural Resources
State of Hawai'i
Honolulu, Hawai'i

ISSUANCE OF A REVOCABLE PERMIT FOR PASSENGER SCREENING
COUNTY OF HAWAI'I, CIVIL DEFENSE AGENCY
ELLISON ONIZUKA KONA INTERNATIONAL AIRPORT AT KEĀHOLE
TAX MAP KEY: (3) 7-3-43: PORTION OF 03

HAWAI'I

LEGAL REFERENCE:

Section 171-55, Hawai'i Revised Statutes (HRS).

APPLICANT:

County of Hawai'i, Civil Defense Agency (COH), whose business address is 920 Ululani Street, Hilo, Hawai'i 96720.

LOCATION AND TAX MAP KEY:

Portion of Ellison Onizuka Kona International Airport at Keāhole (KOA), Kailua-Kona, Island of Hawai'i, identified by Tax Map Key: 3rd Division, 7-3-43: Portion of 03.

AREA:

Building/Room No. 354-101, containing an area of approximately 8,809 square feet, Building/Room No. 354-104, containing an area of approximately 380 square feet, Building/Room No. 354-108, containing an area of approximately 800 square feet, and Building/Room No. 354-109, containing an area of approximately 800 square feet, as shown and delineated on the attached Exhibit A.

ZONING:

State Land Use District:
County of Hawai'i:

Urban & Conservation
Industrial (MG-1a) and Open

ITEM M-8

BLNR – ISSUANCE OF A REVOCABLE PERMIT TO COUNTY OF HAWAI‘I, CIVIL
DEFENSE AGENCY FOR THE PURPOSE OF PASSENGER SCREENING

Page 2

LAND TITLE STATUS:

Section 5(a) lands of the Hawai‘i Admission Act: Ceded
DHHL 30% entitlement lands pursuant to Hawai‘i Admission Act YES ___ NO X

CURRENT USE STATUS:

Airport and aeronautical purposes.

CHARACTER OF USE:

COH will use the spaces for passenger screening.

COMMENCEMENT DATE:

Upon execution of the revocable permit.

MONTHLY RENTAL:

N/A

SECURITY DEPOSIT:

N/A

CHAPTER 343, HRS - ENVIRONMENTAL ASSESSMENT:

The State of Hawai‘i, Department of Transportation, Airports Division (DOTA), has determined the subject land areas are covered by the Final Environmental Assessment (EA)/Finding of No Significant Impact (FONSI), Airfield, Terminal, and Facility Improvements for the Kona International Airport at Keāhole, published by the Office of Environmental Quality Control (OEQC) in the March 23, 2013, issue of The Environmental Notice. Accordingly, all relevant mitigation from the EA and best management practices will be implemented to address the minimum impacts of this action.

REMARKS:

In accordance with Section 171-55 HRS, relating to Permits, the Department of Transportation proposes to issue a month-to-month revocable permit to COH for passenger screening.

BLNR – ISSUANCE OF A REVOCABLE PERMIT TO COUNTY OF HAWAI‘I, CIVIL
DEFENSE AGENCY FOR THE PURPOSE OF PASSENGER SCREENING

Page 3

RECOMMENDATION:

That the Board authorize the Department of Transportation to issue a month-to-month revocable permit to COH, subject to: (1) terms and conditions herein outlined, which are by reference incorporated herein; and (2) such additional terms and conditions as may be prescribed by the Director of Transportation to best serve the interests of the State.

Respectfully submitted,



JADE T. BUTAY
Director of Transportation

APPROVED FOR SUBMITTAL:

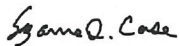

SUZANNE D. CASE
Chairperson and Member

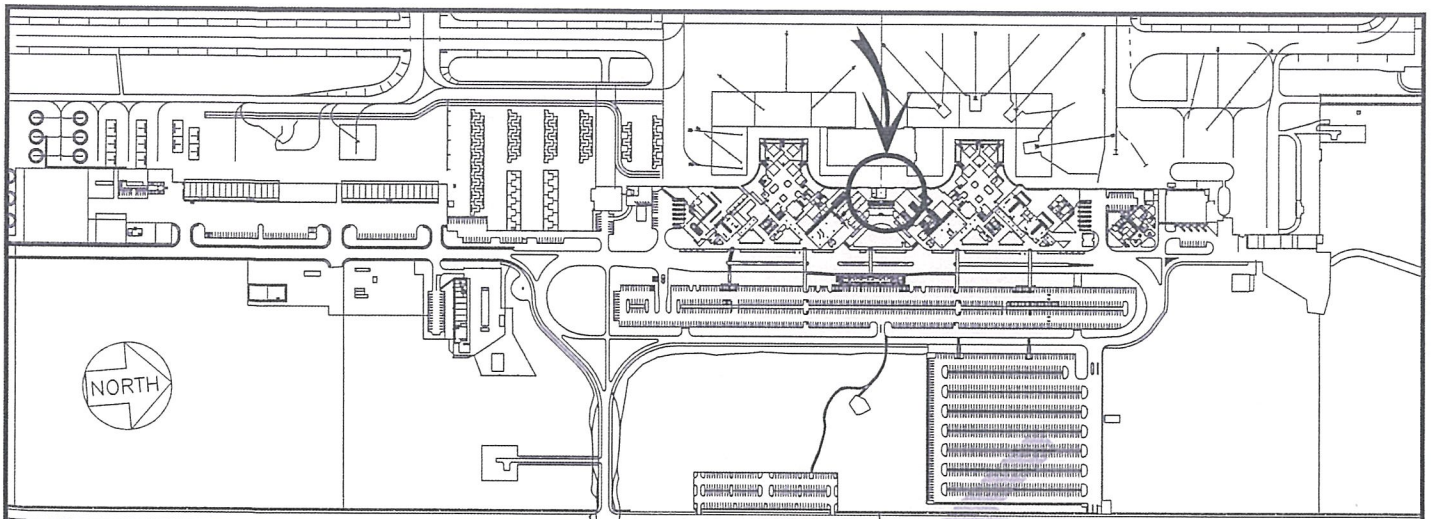

LOCATION PLAN

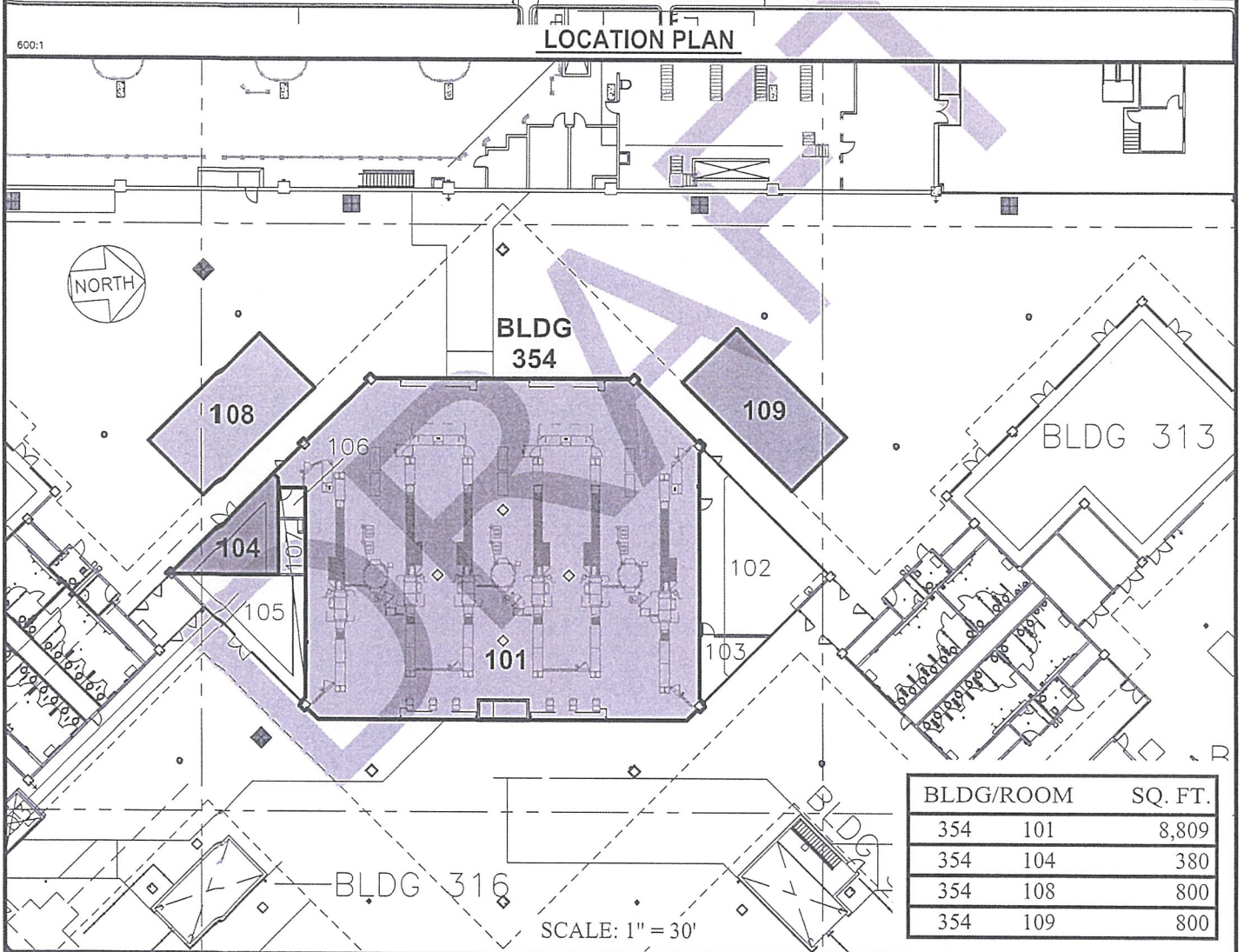

BLDG/ROOM	SQ. FT.
354 101	8,809
354 104	380
354 108	800
354 109	800

DATE : OCTOBER 2020

EXHIBIT: **A**



COUNTY OF HAWAII

BUILDING 354
SECURITY CHECKPOINT
GROUND LEVEL

354101,104
354108,109
PLAT D1, 38

ELLISON ONIZUKA KONA INTERNATIONAL AIRPORT AT KEAHOLE

N:\AIRPORTS\KOA_Kona\CAD\PM\koo_354108-01_draft.dwg