

DAVID Y. IGE  
GOVERNOR



STATE OF HAWAII  
DEPARTMENT OF TRANSPORTATION  
869 PUNCHBOWL STREET  
HONOLULU, HAWAII 96813-5097

JADE BUTAY  
DIRECTOR

Deputy Directors  
LYNN A.S. ARAKI-REGAN  
DEREK J. CHOW  
ROSS M. HIGASHI  
EDWIN H. SNIFFEN  
IN REPLY REFER TO:

Board of Land and  
Natural Resources  
State of Hawai'i  
Honolulu, Hawai'i

ISSUANCE OF A REVOCABLE PERMIT FOR A T-HANGAR FOR STORAGE  
AND MAINTENANCE OF AIRCRAFT FOR COMMERCIAL PURPOSES  
SUNSHINE HELICOPTERS, INC.  
LĪHU'E AIRPORT  
TAX MAP KEY: (4) 3-5-001: PORTION OF 08

KAUA'I

LEGAL REFERENCE:

Section 171-55, Hawai'i Revised Statutes.

APPLICANT:

Sunshine Helicopters, Inc. (SHI) whose business address is P.O. Box 126, Pu'unene,  
Hawai'i 96784-0126.

LOCATION AND TAX MAP KEY:

Portion of Līhu'e Airport (LIH), Līhu'e, Island of Kaua'i, identified by Tax Map Key:  
4th Division, 3-5-001: Portion of 08.

AREA:

Area/Space No. 410-102, containing an area of approximately 1,610 square feet, as shown  
and delineated on the attached Exhibit "A".

ZONING:

State Land Use District:  
County of Kaua'i:

Urban  
Industrial (I)

**ITEM M-11**

BLNR – ISSUANCE OF A REVOCABLE PERMIT FOR A T-HANGAR FOR STORAGE AND MAINTENANCE OF AIRCRAFT FOR COMMERCIAL PURPOSES  
SUNSHINE HELICOPTERS, INC.

Page 2

LAND TITLE STATUS:

Section 5(a) lands of the Hawai'i Admission Act: Non-Ceded  
DHHL 30% entitlement lands pursuant to Hawai'i Admission Act YES\_ NO X

CURRENT USE STATUS:

Airport and aeronautical purposes.

CHARACTER OF USE:

T-hangar for storage and maintenance of aircraft for commercial purposes.

COMMENCEMENT DATE:

Upon execution of the revocable permit.

MONTHLY RENTAL:

\$1,690.50 (\$1,610.00 as determined from the DOTA schedule of rates and charges established by appraisal of Airports property statewide plus \$80.50 for electricity).

SECURITY DEPOSIT:

\$5,071.50, or three times the monthly rental in effect.

HOLD OVER TENANCY:

\$56.35

DCCA VERIFICATION:

Place of business registration confirmed: YES X NO \_\_\_\_\_  
Registered business name confirmed: YES X NO \_\_\_\_\_  
Good standing confirmed: YES X NO \_\_\_\_\_

CHAPTER 343, HRS - ENVIRONMENTAL ASSESSMENT:

The State of Hawai'i, Department of Transportation, Airports Division (DOTA), has determined that the environmental impacts for the subject land use is covered by the Līhu'e Airport Ahukini Road Realignment and General Aviation Subdivision Final Environmental Assessment (FEA), published by the Office of Environmental Quality Control (OEQC) in the April 23, 1997, issue of The Environmental Notice. Accordingly,

BLNR – ISSUANCE OF A REVOCABLE PERMIT FOR A T-HANGAR FOR STORAGE  
AND MAINTENANCE OF AIRCRAFT FOR COMMERCIAL PURPOSES  
SUNSHINE HELICOPTERS, INC.

Page 3

all relevant mitigation from the FEA and best management practices will be implemented to address the minimum impacts of this action.

REMARKS:

In accordance with Section 171-55 HRS, relating to Permits, the Department of Transportation proposes to issue a month-to-month revocable permit to SHI for a T-hangar for storage and maintenance of aircraft for commercial purposes at LIH.

RECOMMENDATION:

That the Board authorize the Department of Transportation to issue a month-to-month revocable permit to SHI subject to: (1) terms and conditions herein outlined, which are by reference incorporated herein; and (2) such additional terms and conditions as may be prescribed by the Director of Transportation to best serve the interests of the State.

Respectfully submitted,

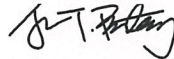

JADE T. BUTAY  
Director of Transportation

APPROVED FOR SUBMITTAL:

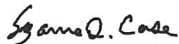

SUZANNE D. CASE  
Chairperson and Member



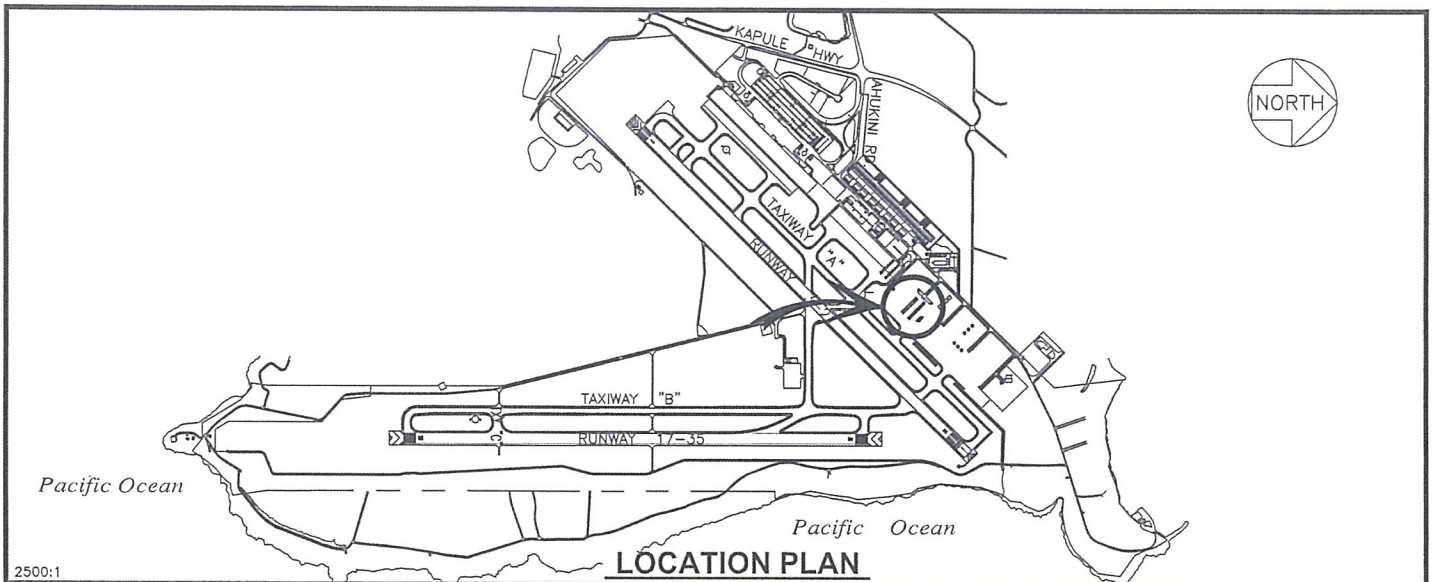

2500:1

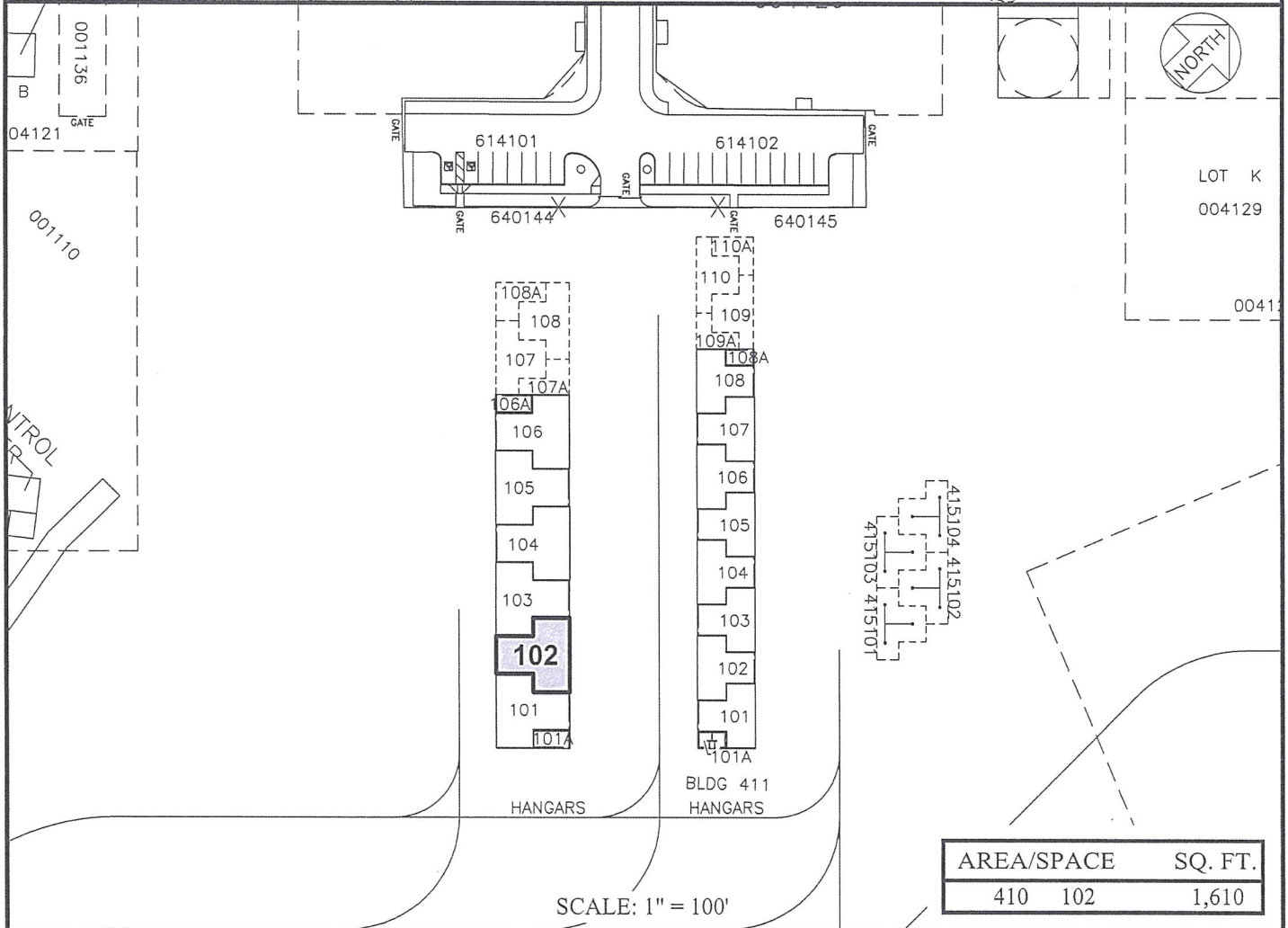

AREA/SPACE	SQ. FT.
410 102	1,610

DATE : OCTOBER 2020

EXHIBIT: **A**



Airports Division

SUNSHINE HELICOPTERS INC.

T-HANGAR

410102

PLAT E1, 35

**LIHUE AIRPORT**

N:\AIRPORTS\LIH\_Lihue\CAD\PM\lih\_410102-01.dwg