

DAVID Y. IGE
GOVERNOR



STATE OF HAWAII
DEPARTMENT OF TRANSPORTATION
869 PUNCHBOWL STREET
HONOLULU, HAWAII 96813-5097

JADE T. BUTAY
DIRECTOR

Deputy Directors
LYNN A.S. ARAKI-REGAN
DEREK J. CHOW
ROSS M. HIGASHI
EDWIN H. SNIFFEN

IN REPLY REFER TO:

Board of Land and
Natural Resources
State of Hawai'i
Honolulu, Hawai'i

ISSUANCE OF A REVOCABLE PERMIT FOR TICKET COUNTER
AND OFFICE SPACE
K & S HELICOPTERS, INC. DBA PARADISE HELICOPTERS
WAIMEA-KOHALA AIRPORT
TAX MAP KEY: (3) 6-7-001: PORTION OF 08

HAWAI'I

LEGAL REFERENCE:

Section 171-55, Hawai'i Revised Statutes (HRS).

APPLICANT:

K & S Helicopters, Inc. dba Paradise Helicopters (KSH), whose business address
P.O. Box 5371, Kailua-Kona, Hawai'i 96745.

LOCATION AND TAX MAP KEY:

Portion of Waimea-Kohala Airport, Kamuela, Island of Hawai'i, identified by
Tax Map Key: (3) 6-7-001: Portion of 08.

AREA:

Area/Space No. 103-102, containing an area of approximately 84 square feet, as shown and
delineated on the attached Exhibit A; and,
Area/Space No. 300-111B, containing an area of approximately 105 square feet, as shown
and delineated on the attached Exhibit B.

ZONING:

State Land Use District:
County of Hawai'i:

Agricultural District
A-40A Agriculture

BLNR – ISSUANCE OF A REVOCABLE PERMIT FOR THE PURPOSE OF A TICKET COUNTER AND OFFICE SPACE, K & S HELICOPTERS, INC.
WAIMEA-KOHALA AIRPORT
Page 2

LAND TITLE STATUS:

Section 5(a) lands of the Hawai‘i Admission Act: Non-Ceded
DHHL 30% entitlement lands pursuant to Hawai‘i Admission Act YES___ NO X

CURRENT USE STATUS:

Airport and aeronautical purposes.

CHARACTER OF USE:

KSH will use the spaces for a ticket counter and an office as part of its commercial helicopter operations.

COMMENCEMENT DATE:

Upon execution of the revocable permit.

MONTHLY RENTAL:

\$138.55 (25% of comparable space at Ellison Onizuka Kona International Airport at Keahole per 2016 Airport appraisal plus \$73.71 for electricity).

SECURITY DEPOSIT:

\$415.65 or three times the monthly rental in effect.

DCCA VERIFICATION:

Place of business registration confirmed:	YES <u>X</u>	NO _____
Registered business name confirmed:	YES <u>X</u>	NO _____
Good standing confirmed:	YES <u>X</u>	NO _____

CHAPTER 343, HRS - ENVIRONMENTAL ASSESSMENT:

The State of Hawaii, Department of Transportation, Airports Division (DOTA), has determined that the subject land use is covered by the Waimea-Kohala Airport Final Environmental Assessment (EA), published by the Office of Environmental Quality Control (OEQC) in the November 8, 1999, issue of The Environmental Notice. Accordingly, all relevant mitigation from the EA and best management practices will be implemented to address the minimum impacts of this action.

BLNR – ISSUANCE OF A REVOCABLE PERMIT FOR THE PURPOSE OF A TICKET
COUNTER AND OFFICE SPACE, K & S HELICOPTERS, INC.
WAIMEA-KOHALA AIRPORT

Page 3

REMARKS:

In accordance with Section 171-55 HRS, relating to Permits, the Department of Transportation proposes to issue a month-to-month revocable permit to KSH for a ticket counter and office space to support their commercial helicopter operations.

RECOMMENDATION:

That the Board authorize the Department of Transportation to issue a month-to-month revocable permit to KSH, subject to: (1) terms and conditions herein outlined, which are by reference incorporated herein; and (2) such additional terms and conditions as may be prescribed by the Director of Transportation to best serve the interests of the State.

Respectfully submitted,

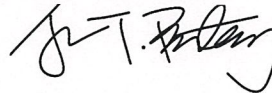

JADE T. BUTAY
Director of Transportation

APPROVED FOR SUBMITTAL:

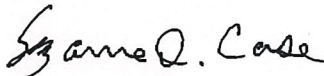

SUZANNE D. CASE
Chairperson and Member

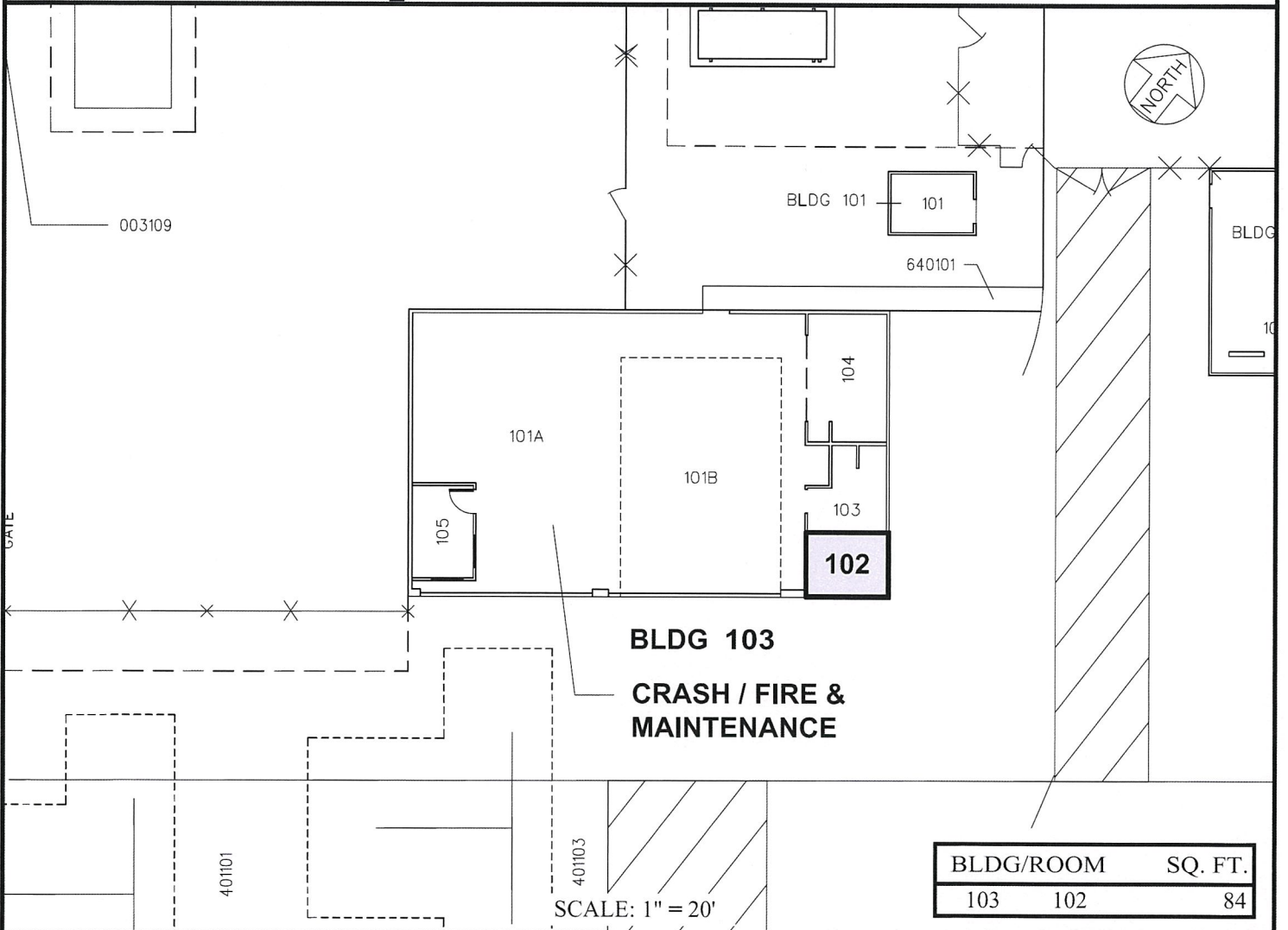
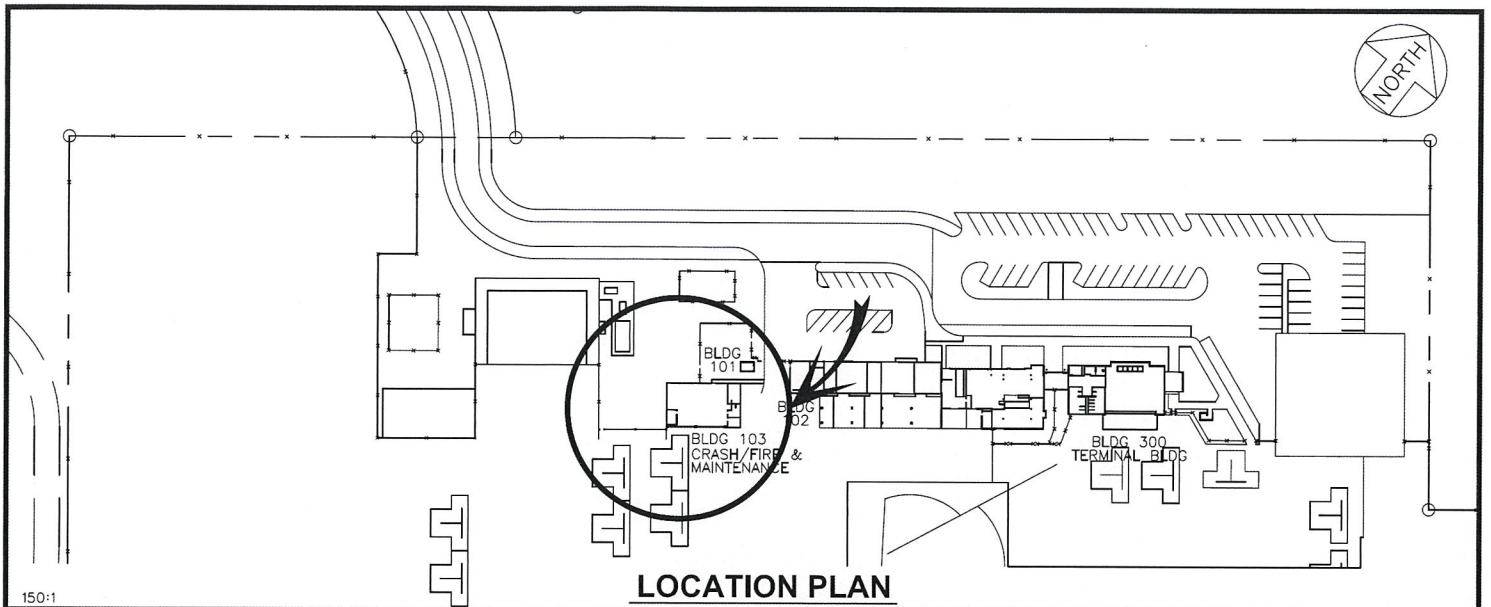

RP-9021

DATE : OCTOBER 2019

EXHIBIT: **A**





Airports Division

K & S HELICOPTERS, INC.

BUILDING 103
CRASH FIRE & MAINTENANCE
GROUND LEVEL

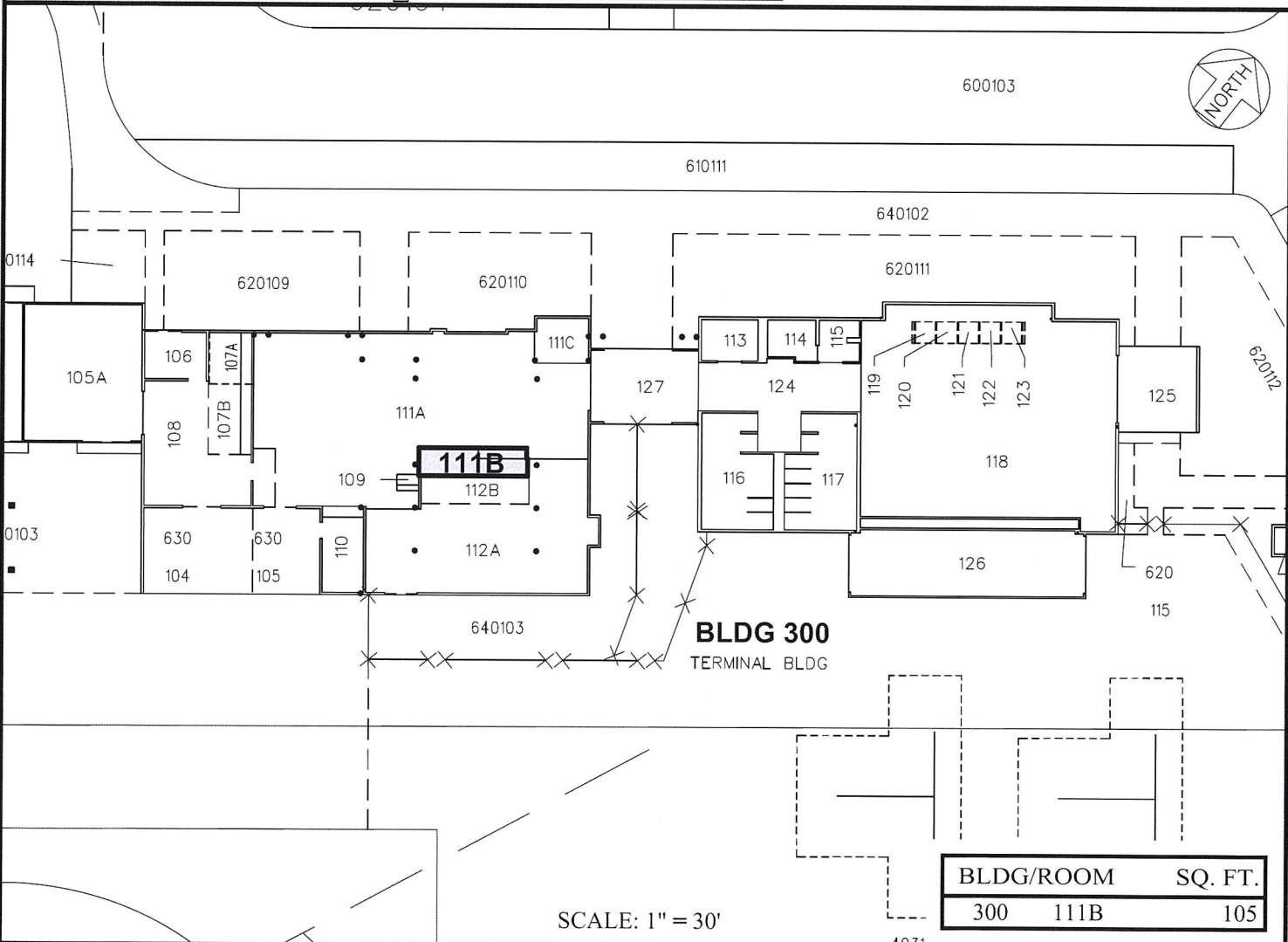
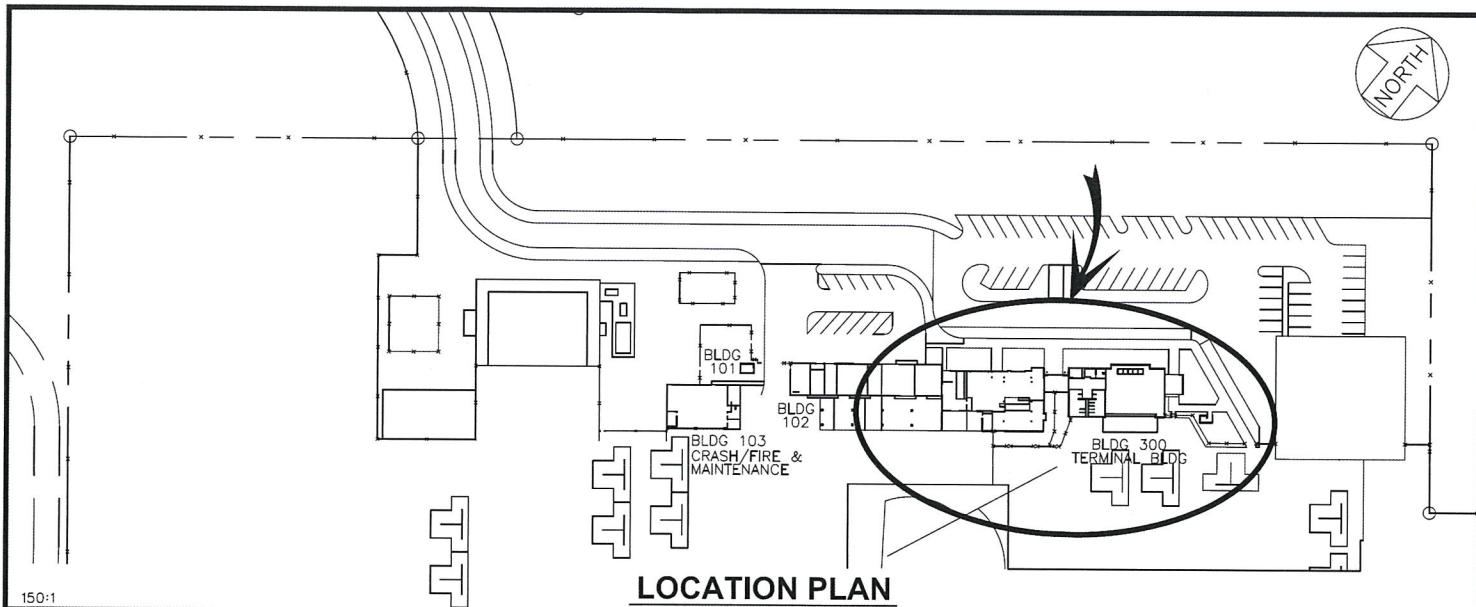
103102
PLAT A1, 41



RP-9021		DATE : FEBUARY 2020	EXHIBIT: B
 <u>Airports Division</u>	K & S HELICOPTERS, INC.	BUILDING 300 TERMINAL BUILDING GROUND LEVEL	300111B PLAT A1, 41