

DAVID Y. IGE
GOVERNOR



STATE OF HAWAII
DEPARTMENT OF TRANSPORTATION
869 PUNCHBOWL STREET
HONOLULU, HAWAII 96813-5097

JADE T. BUTAY
DIRECTOR

Deputy Directors
LYNN A.S. ARAKI-REGAN
DEREK J. CHOW
ROSS M. HIGASHI
EDWIN H. SNIFFEN

IN REPLY REFER TO:

Board of Land and
Natural Resources
State of Hawai'i
Honolulu, Hawai'i

ISSUANCE OF A REVOCABLE PERMIT FOR OFFICE SPACE
AVAIRPROS SERVICES, INC.
ELLISON ONIZUKA KONA INTERNATIONAL AIRPORT AT KEĀHOLE
TAX MAP KEY: (3) 7-3-43: PORTION OF 33

HAWAII

LEGAL REFERENCE:

Section 171-55, Hawai'i Revised Statutes.

APPLICANT:

AvAirPros Services, Inc. (ASI), whose business address is 3555 Kraft Road, Suite 300,
Naples, Florida 34105.

LOCATION AND TAX MAP KEY:

Portion of Ellison Onizuka Kona International Airport at Keāhole (KOA), Kailua-Kona,
Island of Hawai'i, identified by Tax Map Key: 3rd Division, 7-3-43: Portion of 33.

AREA:

Building/Room No. 344-111, containing an area of approximately 108 square feet, as
shown and delineated on the attached Exhibit A.

ZONING:

State Land Use District:
County of Hawai'i:

Urban & Conservation
Industrial (MG-1a) and Open

ITEM M-8

BLNR – ISSUANCE OF A REVOCABLE PERMIT FOR OFFICE SPACE
AVAIRPROS SERVICES, INC.

Page 2

LAND TITLE STATUS:

Section 5(a) lands of the Hawai'i Admission Act: Ceded
DHHL 30% entitlement lands pursuant to Hawai'i Admission Act YES ___ NO X

CURRENT USE STATUS:

Airport and aeronautical purposes.

CHARACTER OF USE:

ASI will use the space as an office as part of its oversight and management of the KOA baggage handling system.

COMMENCEMENT DATE:

Upon execution of the revocable permit.

MONTHLY RENTAL:

\$155.52 (\$97.20 as determined from comparable Old ARFF Building No. 347 and the DOTA schedule of rates and charges established by appraisal of Airports property statewide, plus \$42.12 for electricity and \$16.20 for janitorial services).

SECURITY DEPOSIT:

\$466.56, or three times the monthly rental in effect.

HOLDOVER:

\$5.18

DCCA VERIFICATION:

Place of business registration confirmed:	YES <u>X</u>	NO _____
Registered business name confirmed:	YES <u>X</u>	NO _____
Good standing confirmed:	YES <u>X</u>	NO _____

CHAPTER 343, HRS - ENVIRONMENTAL ASSESSMENT:

The State of Hawai'i, Department of Transportation, Airports Division, has determined that the subject land areas are covered by the Keāhole Airport Master Plan Final Environmental Impact Statement (EIS), published by the Office of Environmental Quality Control (OEQC) in the November 8, 1988, issue of the OEQC Bulletin and

BLNR – ISSUANCE OF A REVOCABLE PERMIT FOR OFFICE SPACE
AVAIRPROS SERVICES, INC.

Page 3

accepted by the Governor on December 19, 1988. Accordingly, all relevant mitigation from the EIS and best management practices will be implemented to address the minimum impacts of this action.

REMARKS:

In accordance with Section 171-55 HRS, relating to Permits, the Department of Transportation proposes to issue a month-to-month revocable permit to ASI for office space as part of its oversight and management of the KOA baggage handling system.

RECOMMENDATION:

That the Board authorize the Department of Transportation to issue a month-to-month revocable permit to ASI, subject to: (1) terms and conditions herein outlined, which are by reference incorporated herein; and (2) such additional terms and conditions as may be prescribed by the Director of Transportation to best serve the interests of the State.

Respectfully submitted,

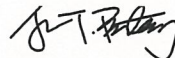

JADE T. BUTAY
Director of Transportation

APPROVED FOR SUBMITTAL:

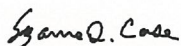

SUZANNE D. CASE
Chairperson and Member

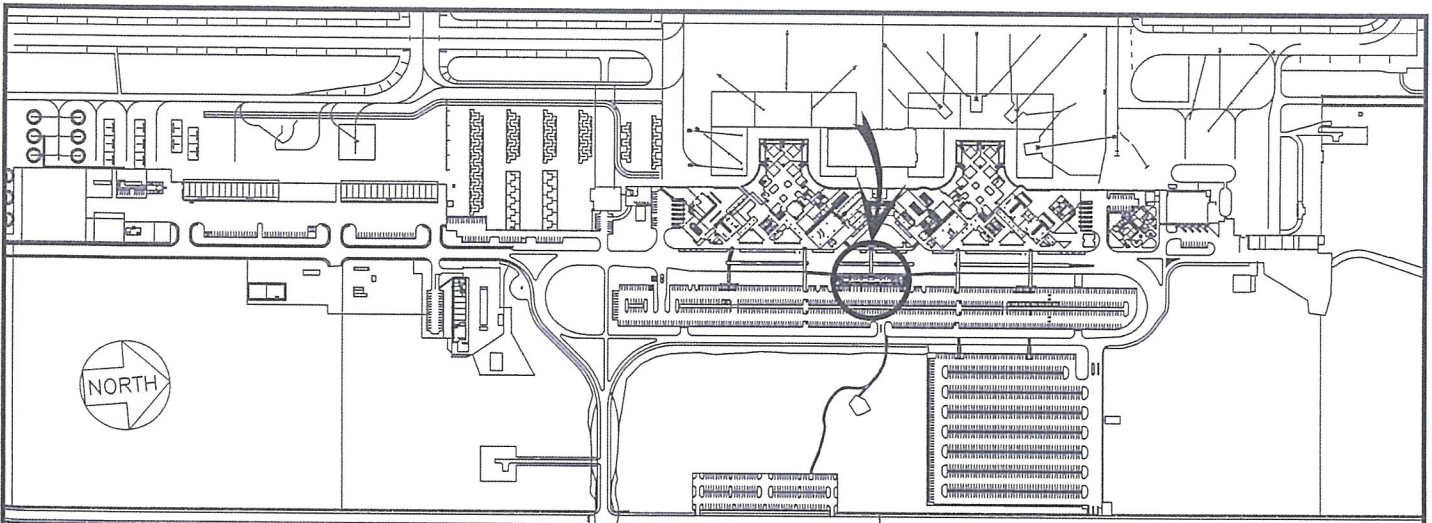

600:1 **LOCATION PLAN**

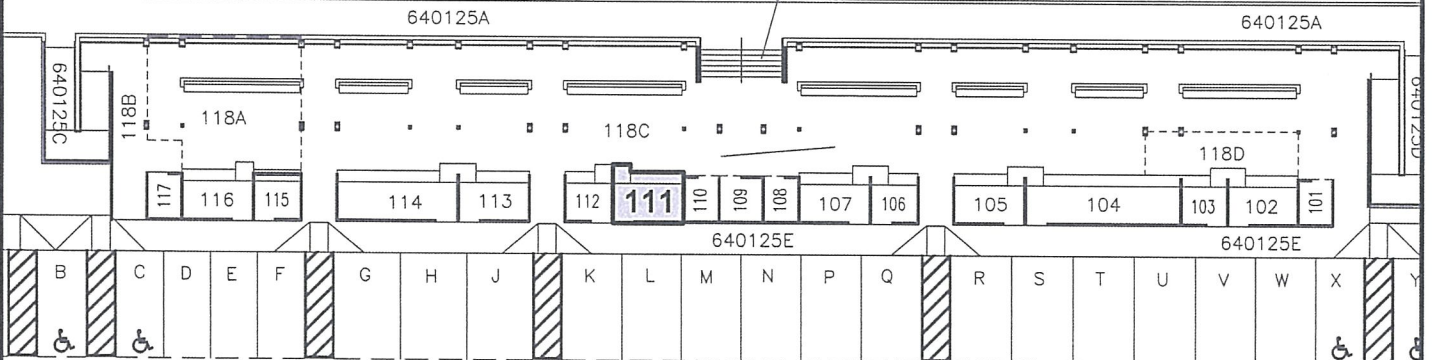
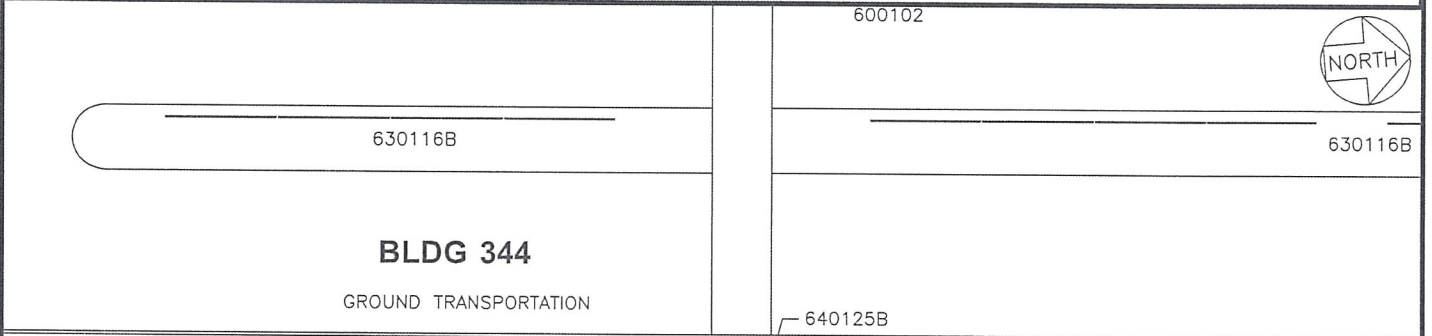

610106												600114												
610114												610114												
M	N	P	Q	R	S	T	U	V	W	X	Y	Z	A	B	C	D	E	F	G	H	BLDG/ROOM		SQ. FT.	
																				344	111	108		

SCALE: 1" = 30' 620111

DATE : JULY 2019 EXHIBIT: **A**

	Airports Division	AVAIRPROS SERVICES, INC.	BUILDING 344 GROUND TRANSPORTATION GROUND LEVEL	344111 PLATS E1, 58

ELLISON ONIZUKA KONA INTERNATIONAL AIRPORT AT KEAHOLE

N:\AIRPORTS\KOA_Kona\CAD\PM\Exhibit_2019\koo_344111-02.dwg