

DAVID Y. IGE
GOVERNOR

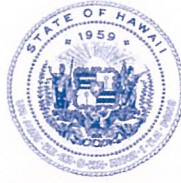

STATE OF HAWAII
DEPARTMENT OF TRANSPORTATION
869 PUNCHBOWL STREET
HONOLULU, HAWAII 96813-5097

JADE T. BUTAY
DIRECTOR

Deputy Directors
LYNN A.S. ARAKI-REGAN
DEREK J. CHOW
ROSS M. HIGASHI
EDWIN H. SNIFFEN

IN REPLY REFER TO:

Board of Land and
Natural Resources
State of Hawai'i
Honolulu, Hawai'i

ISSUANCE OF A REVOCABLE PERMIT FOR CONSTRUCTION
STAGING AREA
NAN, INC.
DANIEL K. INOUYE INTERNATIONAL AIRPORT
TAX MAP KEY: (1) 1-1-003: 001 (PORTION)

O'AHU

LEGAL REFERENCE:

Section 171-55, Hawai'i Revised Statutes ("HRS").

APPLICANT:

Nan, Inc., whose mailing address is 636 Laumaka Street, Honolulu, Hawai'i 96819.

LOCATION:

A portion of Ewa Service Court, Ground Level at Daniel K. Inouye International Airport, Island of O'ahu, State of Hawai'i, identified by Tax Map Key: 1st Division, 1-1-003: 001 (Portion).

AREA:

Area/Space No. 601-104, containing an area of approximately 3,025 square feet, as shown and delineated on the attached map labeled Exhibit "A".

ZONING:

State Land Use District: Urban
City and County of Honolulu LUO: Industrial (I-2)

ITEM M-1

BLNR- ISSUANCE OF A REVOCABLE PERMIT FOR CONSTRUCTION STAGING AREA,
NAN, INC.

Page 2

LAND TITLE STATUS:

Section 5(b) lands of the Hawai'i Admission Act: Ceded
DHHL 30% entitlement lands pursuant to Hawai'i Admission Act YES ___ NO X

CURRENT USE STATUS:

Land presently encumbered by Governor's Executive Order No. 3201, dated June 8, 1983, setting aside 3,152.177 acres designated as Daniel K. Inouye International Airport under the control and management of the State of Hawai'i, Department of Transportation, Airports Division ("DOTA") for Airport Purposes.

CHARACTER OF USE:

Nan, Inc. will use the space for a construction staging area to store a rubbish bin and equipment and supplies, free of rent, as specifically stated under Contract No. 68996, State Project No. AO1037-31, HNL Restroom Improvements - Phase II, Daniel K. Inouye International Airport, Honolulu, Hawai'i.

COMMENCEMENT DATE:

To be determined by the Director of Transportation at a later date.

MONTHLY RENTAL:

Not applicable (N/A)

SECURITY DEPOSIT:

N/A

DCCA VERIFICATION:

Place of business registration confirmed:	YES <u>X</u>	NO ___
Registered business name confirmed:	YES <u>X</u>	NO ___
Good standing confirmed:	YES <u>X</u>	NO ___

CHAPTER 343, HRS - ENVIRONMENTAL ASSESSMENT:

The environmental impacts of the proposed action to the subject land area is covered by the Honolulu International Airport, Airport Modernization Program Environmental Assessment (EA), State Project No. AO1030-13. The EA is a joint State and Federal document dated, January 2013, and published in the February 8, 2013 issue of the OEQC

BLNR- ISSUANCE OF A REVOCABLE PERMIT FOR CONSTRUCTION STAGING AREA,
NAN, INC.

Page 3

Bulletin. Accordingly, the actions have been determined to have little or no impact upon the environment.

REMARKS:

The Department of Transportation proposes to issue a permit to Nan, Inc. for the use of the space for a construction staging area, free of rent, as specifically stated under Contract No. 68996, State Project No. AO1037-31, HNL Restroom Improvements - Phase II, Daniel K. Inouye International Airport, Honolulu, Hawai'i. Section 1.11 Provisions for Field Office/Storage Space: "Pending the availability of space on airport property, the STATE will issue a permit to the CONTRACTOR for the use of the space, at no charge, to be used specifically for a field office and/or storage of materials and equipment...."

RECOMMENDATION:

That the Board authorize the Department of Transportation to issue a month-to-month revocable permit to Nan, Inc., subject to: (1) terms and conditions herein outlined, which are by reference incorporated herein; and (2) such additional terms and conditions as may be prescribed by the Director of Transportation to best serve the interests of the State.

Respectfully submitted,

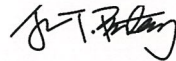

JADE T. BUTAY
Director of Transportation

APPROVED FOR SUBMITTAL:

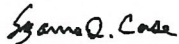

SUZANNE D. CASE
Chairperson and Member

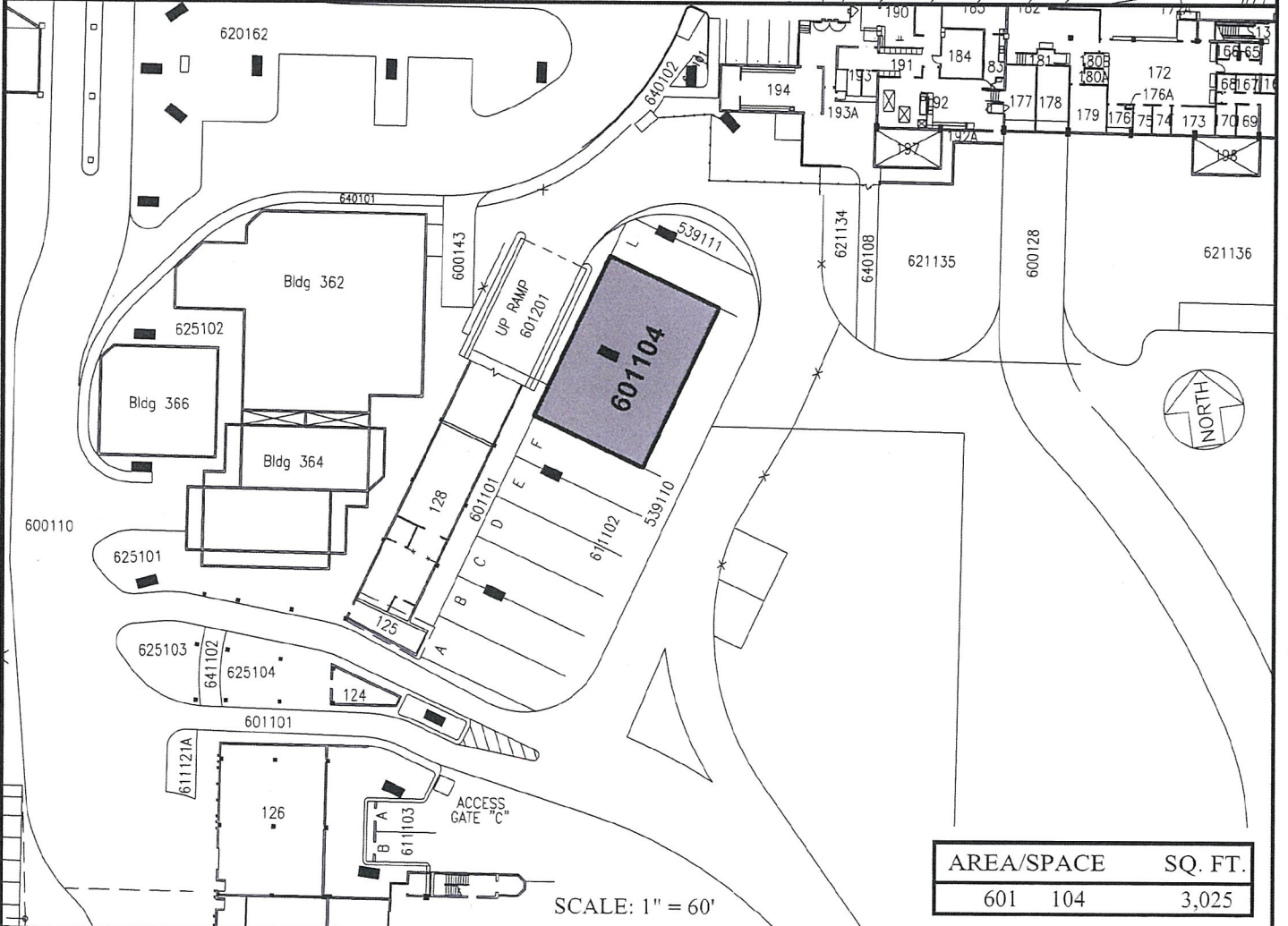
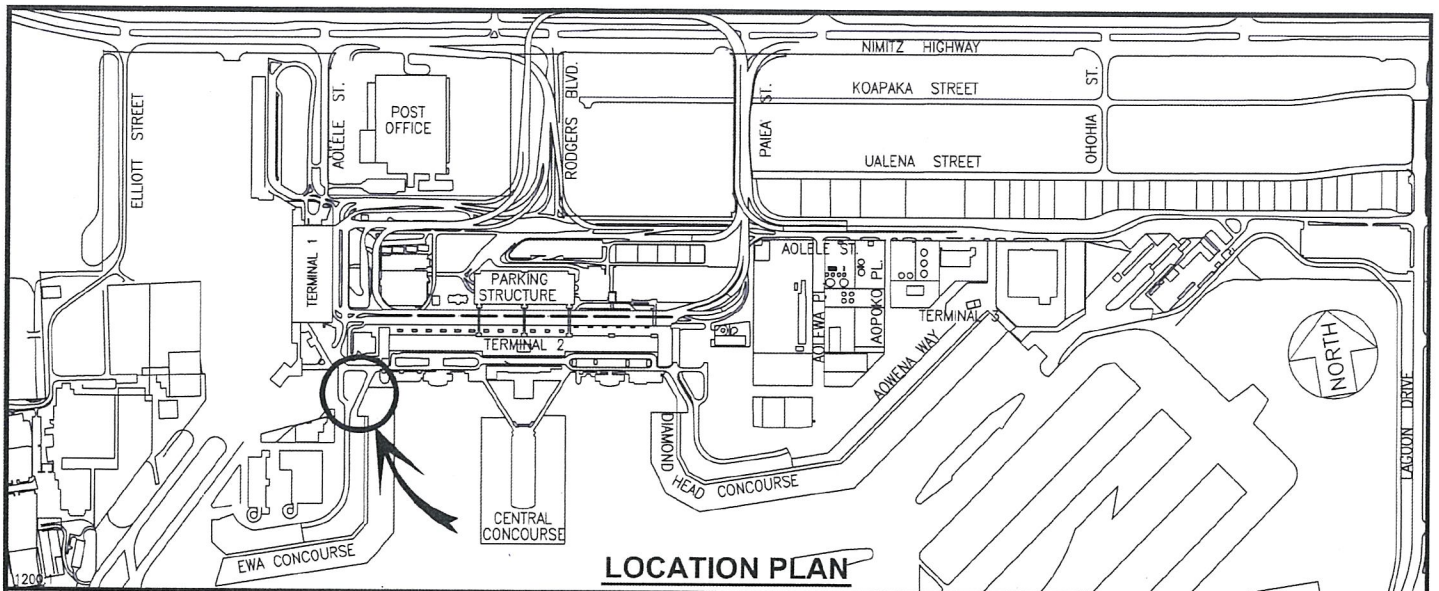

RP-9059

DATE : FEBRUARY 2021

EXHIBIT: **A**



NAN, INC.

EWA SERVICE COURT
ROADS AND STREETS
GROUND LEVEL

601104

PLAT D1

DANIEL K. INOUE INTERNATIONAL AIRPORT

N:\AIRPORTS\HNL\HONOLULU\CAD\PM\HNL_601104-01.DWG