

DAVID Y. IGE
GOVERNOR

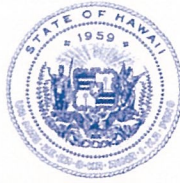

STATE OF HAWAII
DEPARTMENT OF TRANSPORTATION
869 PUNCHBOWL STREET
HONOLULU, HAWAII 96813-5097

JADE T. BUTAY
DIRECTOR

Deputy Directors
LYNN A.S. ARAKI-REGAN
DEREK J. CHOW
ROSS M. HIGASHI
EDWIN H. SNIFFEN

IN REPLY REFER TO:

Board of Land and
Natural Resources
State of Hawai'i
Honolulu, Hawai'i

ISSUANCE OF A REVOCABLE PERMIT FOR A T-HANGAR
FOR STORAGE AND MAINTENANCE OF AIRCRAFT
PACIFIC FLIGHT ACADEMY LLC
DANIEL K. INOUYE INTERNATIONAL AIRPORT
TAX MAP KEY: (1) 1-1-76: PORTION OF 21

O'AHU

REQUEST:

Issuance of a revocable permit for a T-Hangar for storage and maintenance of aircraft to Pacific Flight Academy LLC, situated at Daniel K. Inouye International Airport.

LEGAL REFERENCE:

Section 171-55, Hawai'i Revised Statutes (HRS).

APPLICANT:

Pacific Flight Academy LLC, whose mailing address is 1200 Queen Emma Street, #2404, Honolulu, Hawai'i 96813.

LOCATION AND TAX MAP KEY:

A portion of Daniel K. Inouye International Airport, Island of Oahu, State of Hawai'i, identified by Tax Map Key: 1st Division, 1-1-76: portion of 21.

AREA:

Small Plane Hangar Unit No. 421-105, containing an area of approximately 1,462 square feet, as shown and delineated on the attached map labeled Exhibit "A".

ITEM M-2

BLNR – ISSUANCE OF A REVOCABLE PERMIT FOR A T-HANGAR FOR STORAGE AND MAINTENANCE OF AIRCRAFT, PACIFIC FLIGHT ACADEMY LLC

Page 2

ZONING:

State Land Use District: Urban
City and County of Honolulu LUO: Industrial (I-2)

LAND TITLE STATUS:

Non-Ceded - Section 5(a) lands of the Hawai'i Admission Act
DHHL 30% entitlement lands pursuant to Hawai'i Admission Act YES ___ NO X

CURRENT USE STATUS:

Land presently encumbered by Governor's Executive Order No. 3201, dated June 8, 1983, setting aside 3,152.177 acres designated as Daniel K. Inouye International Airport under the control and management of the State of Hawai'i, Department of Transportation, Airports Division (DOTA) for Airport Purposes.

CHARACTER OF USE:

T-Hangar for storage and maintenance of aircraft (2019 Vashon Ranger R7, Tail No. N-420VR).

COMMENCEMENT DATE:

To be determined by the Director of Transportation at a later date.

MONTHLY RENTAL:

\$1,809.40 (\$1,754.40, as determined from the DOTA schedule of rates and charges, Commercial Rate for T-Hangar, established by appraisal of Airports property statewide plus \$55.00 for electricity).

SECURITY DEPOSIT:

\$5,428.20 or three (3) times the monthly rental in effect.

CHAPTER 343, HRS - ENVIRONMENTAL ASSESSMENT:

The environmental impacts of the proposed action to the subject land area is covered by the Honolulu International Airport Master Plan Update and Noise Compatibility Program Environmental Assessment (EA), State Project No. AO1011-033. The EA is a joint State and Federal document, dated September 1989 and published in the October 23, 1989

BLNR – ISSUANCE OF A REVOCABLE PERMIT FOR A T-HANGAR FOR STORAGE AND MAINTENANCE OF AIRCRAFT, PACIFIC FLIGHT ACADEMY LLC

Page 3

issue of the OEQC Bulletin. Accordingly, relevant mitigation from the EA and DOT-A environmental best management practice will address minimal impacts from this action.

REMARKS:

The issuance of a revocable permit to Pacific Flight Academy LLC for a T-Hangar for storage and maintenance of aircraft for a commercial flight school at Daniel K. Inouye International Airport complies with Chapter 343, Hawai'i Revised Statutes, as amended, relating to Environmental Impact Statements, and is in accordance with Section 171-55, HRS, relating to Permits.

RECOMMENDATION:

That the Board authorize the Department of Transportation to issue a month-to-month revocable permit to Pacific Flight Academy LLC, subject to: (1) terms and conditions herein outlined, which are by reference incorporated herein; and (2) such additional terms and conditions as may be prescribed by the Director of Transportation to best serve the interests of the State.

Respectfully submitted,

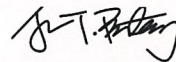

JADE T. BUTAY
Director of Transportation

APPROVED FOR SUBMITTAL:

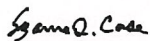

SUZANNE D. CASE
Chairperson and Member

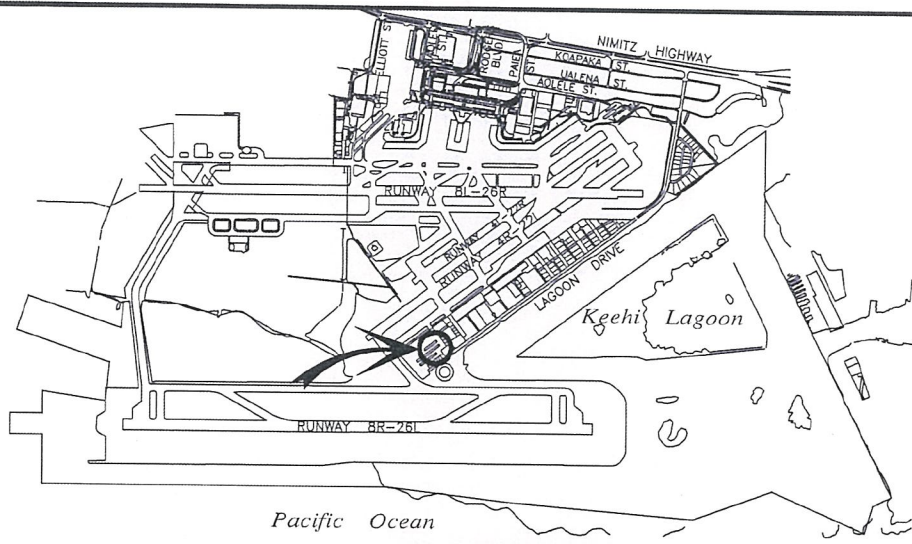

5000:1

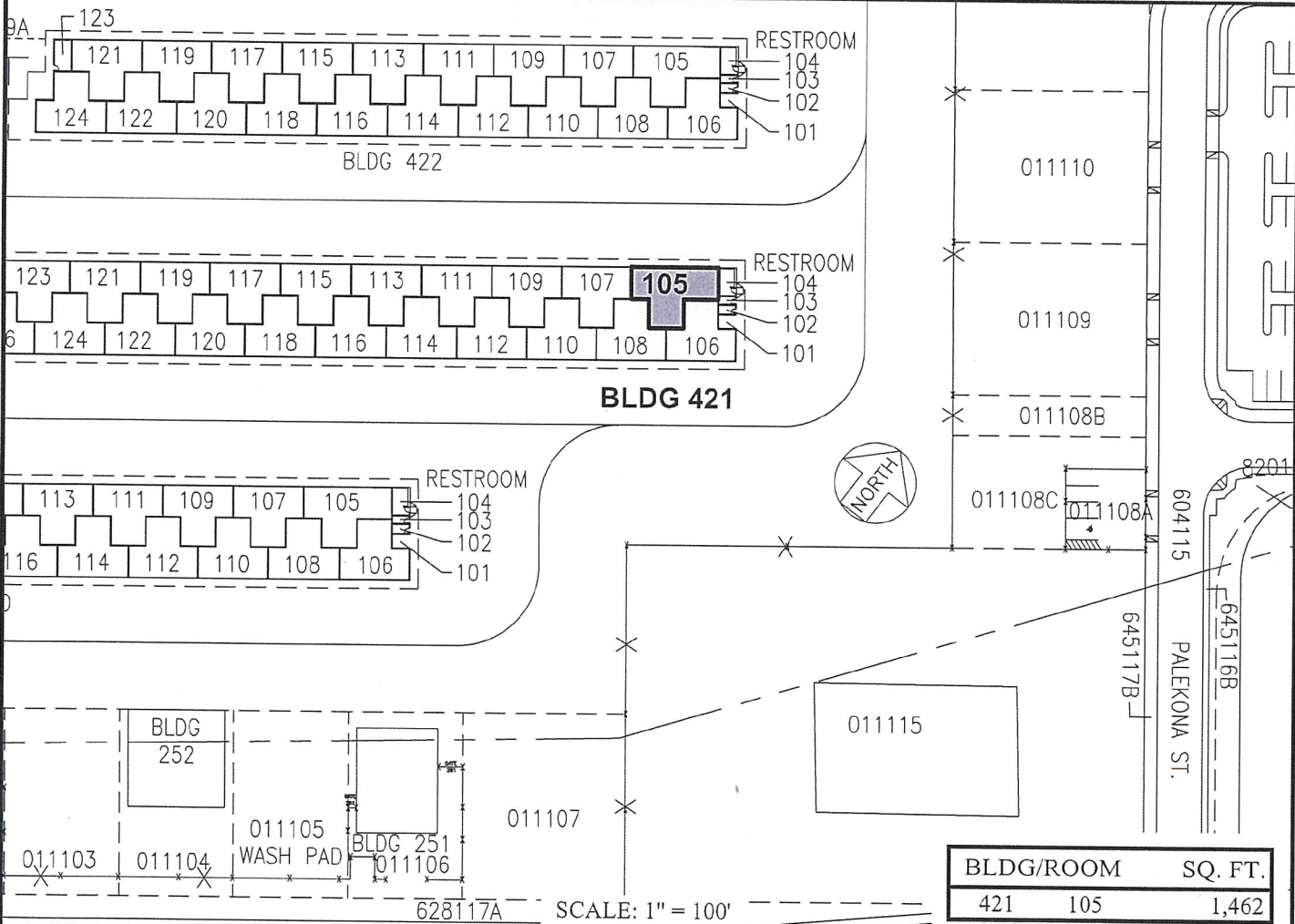

BLDG/ROOM	SQ. FT.
421 105	1,462

RP-9044

DATE : FEBRUARY 2021

EXHIBIT: **A**



PACIFIC FLIGHT ACADEMY LLC

T-HANGAR
GENERAL AVIATION
SOUTH RAMP

421105
PLAT 45

DANIEL K. INOUE INTERNATIONAL AIRPORT

N:\AIRPORTS\HNL_HONOLULU\CAD\PM\HNL_421105-01.DWG