

DAVID Y. IGE  
GOVERNOR

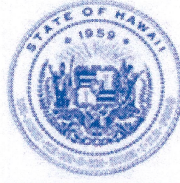

STATE OF HAWAII  
DEPARTMENT OF TRANSPORTATION  
869 PUNCHBOWL STREET  
HONOLULU, HAWAII 96813-5097

JADE T. BUTAY  
DIRECTOR

Deputy Directors  
LYNN A.S. ARAKI-REGAN  
DEREK J. CHOW  
ROSS M. HIGASHI  
EDWIN H. SNIFFEN

IN REPLY REFER TO:

Board of Land and  
Natural Resources  
State of Hawai'i  
Honolulu, Hawai'i

ISSUANCE OF A REVOCABLE PERMIT FOR AIRCRAFT PARKING  
DAVID BLANCETT-MADDOCK  
ELLISON ONIZUKA KONA INTERNATIONAL AIRPORT AT KEĀHOLE  
TAX MAP KEY: (3) 7-3-43: PORTION OF 003

HAWAII

REQUEST:

Issuance of a Revocable Permit for Aircraft Parking (Parking Permit) to David Blancett-Maddock situated at Ellison Onizuka Kona International Airport at Keāhole.

LEGAL REFERENCE:

Section 171-55, Hawai'i Revised Statutes (HRS).

APPLICANT:

David Blancett-Maddock, whose mailing address is 76-101 Kamehamalu Street, Kailua-Kona, Hawai'i 96740.

LOCATION AND TAX MAP KEY:

Portion of Ellison Onizuka Kona International Airport at Keāhole (KOA), Kailua-Kona, Island of Hawai'i, identified by Tax Map Key: 3rd Division, 7-3-43: Portion of 003.

AREA:

Area/Space No. 425-101, containing an area of approximately 1,659 square feet, as shown and delineated on the attached Exhibit A.

ZONING:

State Land Use District:  
County of Hawai'i:

Urban & Conservation  
Industrial (MG-1a) and Open

**ITEM M-1**

BLNR – ISSUANCE OF A REVOCABLE PERMIT FOR AIRCRAFT PARKING  
DAVID BLANCETT-MADDOCK  
Page 2

LAND TITLE STATUS:

Section 5(a) lands of the Hawai‘i Admission Act: Ceded  
DHHL 30% entitlement lands pursuant to Hawai‘i Admission Act YES \_\_\_ NO X

CURRENT USE STATUS:

Airport and aeronautical purposes.

CHARACTER OF USE:

Aircraft tie-down (1966 Piper Cherokee PA-28-140/160, N6326R).

COMMENCEMENT DATE:

Upon complete execution of the parking permit.

MONTHLY RENTAL:

\$126.00 (as determined from the Department of Transportation, Airports Division schedule of rates and charges established by appraisal of Airports property statewide).

SECURITY DEPOSIT:

\$378.00, or three (3) times the monthly rental in effect.

CHAPTER 343, HRS - ENVIRONMENTAL ASSESSMENT:

The State of Hawai‘i, Department of Transportation, Airports Division (DOTA), has determined the subject land areas are covered by the Final Environmental Assessment (EA)/Finding of No Significant Impact (FONSI), Airfield, Terminal, and Facility Improvements for the Kona International Airport at Keāhole, published by the Office of Environmental Quality Control (OEQC) in the March 23, 2013, issue of The Environmental Notice. Accordingly, all relevant mitigation from the EA and best management practices will be implemented to address the minimum impacts of this action.

REMARKS:

In accordance with Section 171-55 HRS, relating to Permits, the Department of Transportation proposes to issue a month-to-month Parking Permit to David Blancett-Maddock for aircraft parking at KOA.

RECOMMENDATION:

That the Board authorize the Department of Transportation to issue a month-to-month Parking Permit to David Blancett-Maddock, subject to: (1) terms and conditions herein outlined, which are by reference incorporated herein; and (2) such additional terms and conditions as may be prescribed by the Director of Transportation to best serve the interests of the State.

Respectfully submitted,



JADE T. BUTAY  
Director of Transportation

APPROVED FOR SUBMITTAL:



SUZANNE D. CASE  
Chairperson and Member

Pacific Ocean

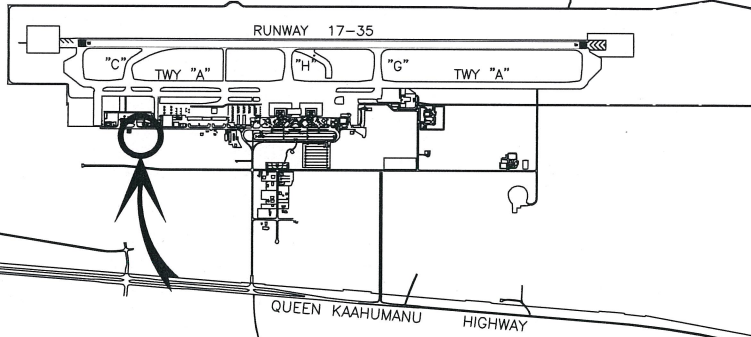

**LOCATION PLAN**

4000:1  
620113B 641111 620113A 641110 620196B

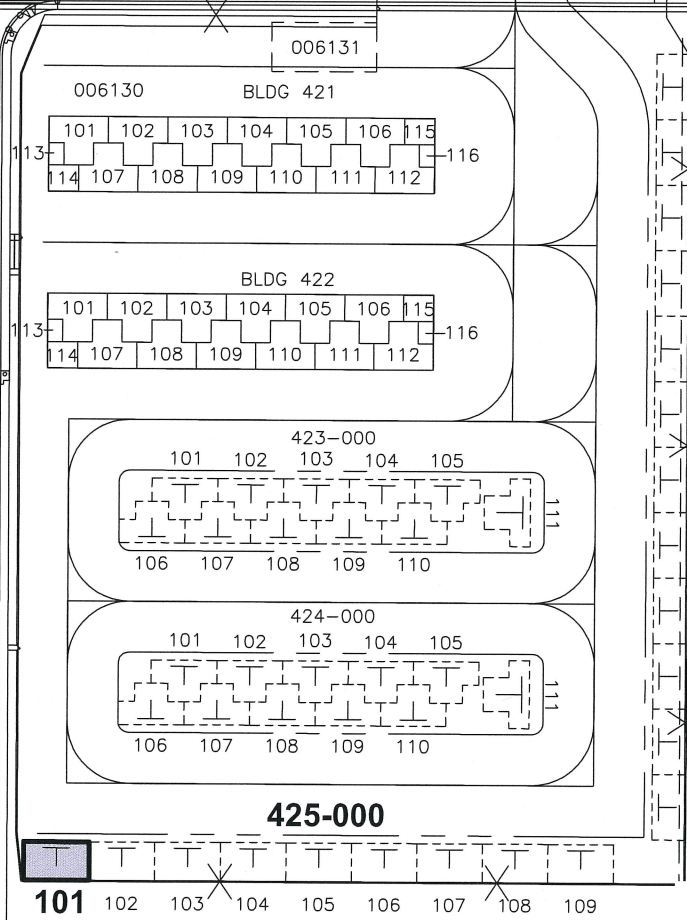
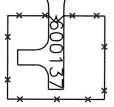

820104B

623103  
671101  
604101

SCALE: 1" = 200'

AREA/SPACE	SQ. FT.
425 101	1,659

DATE : NOVEMBER 2020

EXHIBIT: **A**



Airports Division

DAVID  
BLANCETT-MADDOCK

TIE DOWN  
AND T-HANGARS

425101

PLAT 40

Adobe Sign Transaction Number: CB1CHPCAABA8AuGSIQ5IM3UsNoPm5eodRy00K5IKHd

N:\AIRPORTS\KOA\_Kona\CAD\PM\koa\_425101-01\_draft.dwg

**ELLISON ONIZUKA KONA INTERNATIONAL AIRPORT AT KEAHOLE**