

DAVID Y. IGE  
GOVERNOR



STATE OF HAWAII  
DEPARTMENT OF TRANSPORTATION  
869 PUNCHBOWL STREET  
HONOLULU, HAWAII 96813-5097

JADE T. BUTAY  
DIRECTOR

Deputy Directors  
LYNN A. S. ARAKI-REGAN  
DEREK J. CHOW  
ROSS M. HIGASHI  
EDWIN H. SNIFFEN

IN REPLY REFER TO:

Board of Land and  
Natural Resources  
State of Hawai'i  
Honolulu, Hawai'i

ISSUANCE OF A REVOCABLE PERMIT FOR OFFICE  
SPACE AND CHECK-IN COUNTERS  
K & S HELICOPTERS, INC.  
HILO INTERNATIONAL AIRPORT  
TAX MAP KEY: (3) 2-1-12: PORTION OF 09

HAWAII

LEGAL REFERENCE:

Section 171-55, Hawai'i Revised Statutes.

APPLICANT:

K & S Helicopters, Inc. (KSH), a Hawai'i corporation, whose mailing address is  
P.O. Box 5371, Kailua-Kona, Hawai'i 96745.

LOCATION AND TAX MAP KEY:

Portion of Hilo International Airport (ITO), Hilo, Island of Hawai'i, identified by  
Tax Map Key: 3<sup>rd</sup> Division, 2-1-12: Portion of 09.

AREA:

Building/Room No. 307-111A, containing an area of approximately 87 square feet,  
Building/Room No. 307-111B, containing an area of approximately 137 square feet, and  
Building/Room No. 307-112, containing an area of approximately 533 square feet, as  
shown and delineated on the attached map labeled Exhibit "A".

ZONING:

State Land Use District: Urban  
City and County of Honolulu: Industrial (ML-20)

**ITEM M-10**

BLNR – ISSUANCE OF A REVOCABLE PERMIT FOR OFFICE SPACE AND TICKET COUNTERS, K & S HELICOPTERS, INC.

Page 2

LAND TITLE STATUS:

Section 5(a) lands of the Hawai'i Admission Act: Ceded

DHHL 30% entitlement lands pursuant to the Hawai'i Admission Act: YES  NO

CURRENT USE STATUS:

Land presently encumbered by Governor's Executive Order No. 2653, setting aside a portion of General Lyman Field under the control and management of the State of Hawai'i, Department of Transportation, Airports Division for Airport Purposes.

CHARACTER OF USE:

KSH will use the spaces as an office and ticket counters in support of its commercial helicopter tour operations at ITO.

COMMENCEMENT DATE:

Upon execution of the revocable permit.

MONTHLY RENTAL:

\$3,267.71 (as determined from the Airports Division Non-Signatory Carrier Rates and Charges Hawai'i Airports System, effective July 1, 2019).

The Airports Division Non-Signatory Carriers Rates and Charges, Hawai'i Airports System for Fiscal Year 2020 is \$51.80 per square foot, per annum.

SECURITY DEPOSIT:

\$9,803.13, or three times the monthly rental in effect

DCCA VERIFICATION:

|   |              |                             |
|---|--------------|-----------------------------|
| Place of business registration confirmed: | YES <u>X</u> | NO <input type="checkbox"/> |
| Registered business name confirmed:       | YES <u>X</u> | NO <input type="checkbox"/> |
| Good standing confirmed:                  | YES <u>X</u> | NO <input type="checkbox"/> |

CHAPTER 343, HRS - ENVIRONMENTAL ASSESSMENT:

The State of Hawaii, Department of Transportation, Airports Division (DOTA), has determined that the subject land use is covered by the Final Environmental Impact

BLNR – ISSUANCE OF A REVOCABLE PERMIT FOR OFFICE SPACE AND TICKET COUNTERS, K & S HELICOPTERS, INC.

Page 3

Statement (EIS), New Passenger Terminal, General Lyman Field, Hilo, Hawaii, published by the Office of Environmental Quality Control (OEQC) in the October 17, 1973, issue of The EIS Newsletter. Accordingly, all relevant mitigation from the EIS and best management practices will be implemented to address the minimum impacts of this action. On July 1, 1989, General Lyman Field was renamed Hilo International Airport.

REMARKS:

In accordance with Section 171-55 HRS, relating to Permits, the Department of Transportation proposes to issue a month-to-month revocable permit to KSH for office space and ticket counters in support of its commercial helicopter tour operations at ITO.

RECOMMENDATION:

That the Board authorize the Department of Transportation to issue a month-to-month revocable permit to KSH, subject to: (1) terms and conditions herein outlined, which are by reference incorporated herein; and (2) such additional terms and conditions as may be prescribed by the Director of Transportation to best serve the interests of the State.

Respectfully submitted,



JADE T. BUTAY  
Director of Transportation

APPROVED FOR SUBMITTAL:

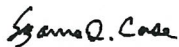

SUZANNE D. CASE  
Chairperson and Member

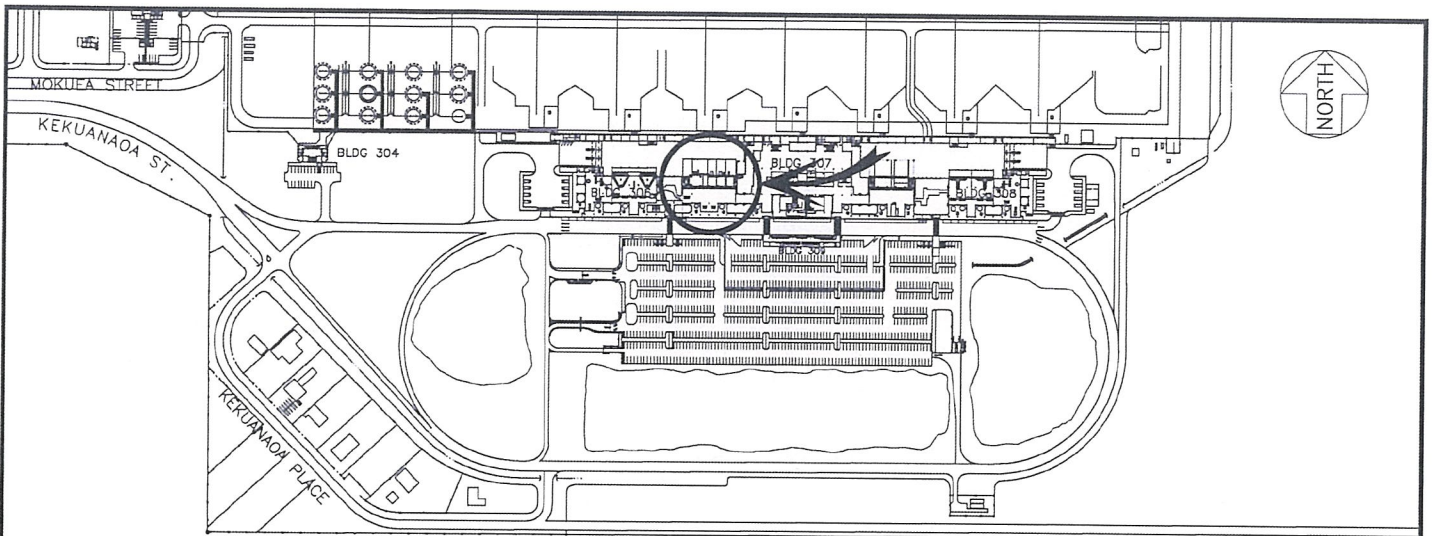

**LOCATION PLAN**

500:1  
631103

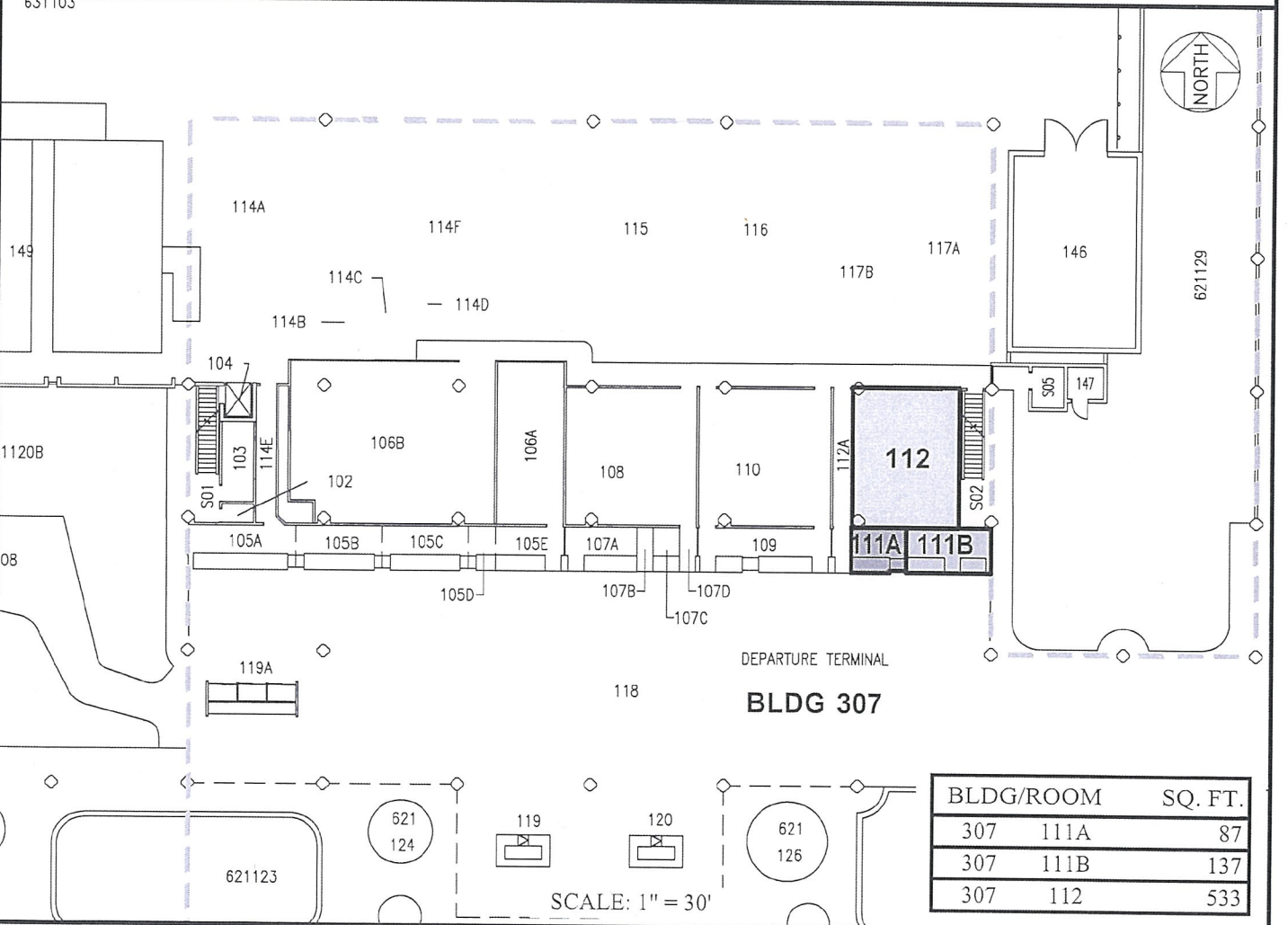

| BLDG/ROOM | SQ. FT. |
|-----------|---------|
| 307 111A  | 87      |
| 307 111B  | 137     |
| 307 112   | 533     |

SCALE: 1" = 30'

RP-9061

DATE : MARCH 2021

EXHIBIT: **A**



K & S HELICOPERS, INC.

BUILDING 307  
DEPARTURE TERMINAL  
GROUND LEVEL

307111A&B  
307112  
PLAT G1, 32

**HILO INTERNATIONAL AIRPORT**

N:\AIRPORTS\ITO\_Hilo\CAD\PM\to\_307111A-01.dwg