

DAVID Y. IGE
GOVERNOR



STATE OF HAWAII
DEPARTMENT OF TRANSPORTATION
869 PUNCHBOWL STREET
HONOLULU, HAWAII 96813-5097

JADE T. BUTAY
DIRECTOR

Deputy Directors
LYNN A.S. ARAKI-REGAN
DEREK J. CHOW
ROSS M. HIGASHI
EDWIN H. SNIFFEN

IN REPLY REFER TO:

Board of Land and
Natural Resources
State of Hawai'i
Honolulu, Hawai'i

ISSUANCE OF A REVOCABLE PERMIT FOR AIRCRAFT PARKING
FOR AIRLINE CARRIER OPERATIONS
SOUTHERN AIRWAYS EXPRESS, LLC
ELLISON ONIZUKA KONA INTERNATIONAL AIRPORT AT KEĀHOLE HAWAI'I
TAX MAP KEY: (3) 7-3-43: PORTION OF 003

REQUEST:

Issuance of a Revocable Permit for Aircraft Parking (Parking Permit) to Southern Airways Express, LLC for four (4) aircraft tie-down spaces situated at Ellison Onizuka Kona International Airport at Keāhole.

APPLICANT:

Southern Airways Express, LLC, whose business address is 101 N. Riverside Drive, Suite 211, Pompano Beach, Florida 33062.

LEGAL REFERENCE:

Section 171-55, Hawai'i Revised Statutes (HRS).

LOCATION AND TAX MAP KEY:

Portion of Ellison Onizuka Kona International Airport at Keāhole (KOA), Kailua-Kona, Island of Hawai'i, identified by Tax Map Key: 3rd Division, 7-3-43: Portion of 003.

AREA:

Area/Space No. 414-103, containing an area of approximately 1,925 square feet,
Area/Space No. 414-104, containing an area of approximately 1,925 square feet,
Area/Space No. 417-103, containing an area of approximately 1,925 square feet, and
Area/Space No. 417-104, containing an area of approximately 1,925 square feet,
as shown and delineated on the attached Exhibit A.

ITEM M-11

BLNR – ISSUANCE OF A REVOCABLE PERMIT FOR AIRCRAFT PARKING FOR
AIRLINE CARRIER OPERATIONS, SOUTHERN AIRWAYS EXPRESS, LLC
Page 2

ZONING:

State Land Use District: Urban & Conservation
County of Hawai'i: Industrial (MG-1a) and Open

LAND TITLE STATUS:

Section 5(a) lands of the Hawai'i Admission Act: Ceded
DHHL 30% entitlement lands pursuant to Hawai'i Admission Act YES ___ NO X

CURRENT USE STATUS:

Land presently encumbered by Governor's Executive Order No. 3074, dated August 20, 1981, setting aside 4,204.01 acres designated as KOA under the control and management of the State of Hawai'i, Department of Transportation, Airports Division for Airport Purposes.

CHARACTER OF USE:

Four (4) aircraft tie-down spaces for various aircraft.

COMMENCEMENT DATE:

Upon execution of the revocable permit.

MONTHLY RENTAL:

\$504.00 (\$126.00 per tie-down space, as determined from the Department of Transportation, Airports Division schedule of rates and charges established by appraisal of Airports property statewide).

SECURITY DEPOSIT:

\$1,512.00, or three (3) times the monthly rental in effect.

DCCA VERIFICATION:

Place of business registration confirmed:	YES <u>X</u>	NO _____
Registered business name confirmed:	YES <u>X</u>	NO _____
Good standing confirmed:	YES <u>X</u>	NO _____

CHAPTER 343, HRS - ENVIRONMENTAL ASSESSMENT:

The State of Hawai'i, Department of Transportation, Airports Division (DOTA), has determined the subject land areas are covered by the Final Environmental Assessment (EA)/Finding of No Significant Impact (FONSI), Airfield, Terminal, and Facility Improvements for the Kona International Airport at Keāhole, published by the Office of Environmental Quality Control (OEQC) in the March 23, 2013, issue of The Environmental Notice. Accordingly, all relevant mitigation from the EA and best management practices will be implemented to address the minimum impacts of this action.

REMARKS:

In accordance with Section 171-55, HRS, relating to Permits, the Department of Transportation proposes to issue a month-to-month Parking Permit to Southern Airways Express, LLC for four (4) aircraft parking spaces for their commercial airline carrier operations at KOA.

RECOMMENDATION:

That the Board authorize the Department of Transportation to issue a month-to-month Parking Permit to Southern Airways Express, LLC, subject to: (1) terms and conditions herein outlined, which are by reference incorporated herein; and (2) such additional terms and conditions as may be prescribed by the Director of Transportation to best serve the interests of the State.

Respectfully submitted,

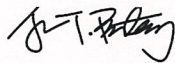

JADE T. BUTAY
Director of Transportation

APPROVED FOR SUBMITTAL:

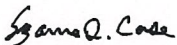

SUZANNE D. CASE
Chairperson and Member

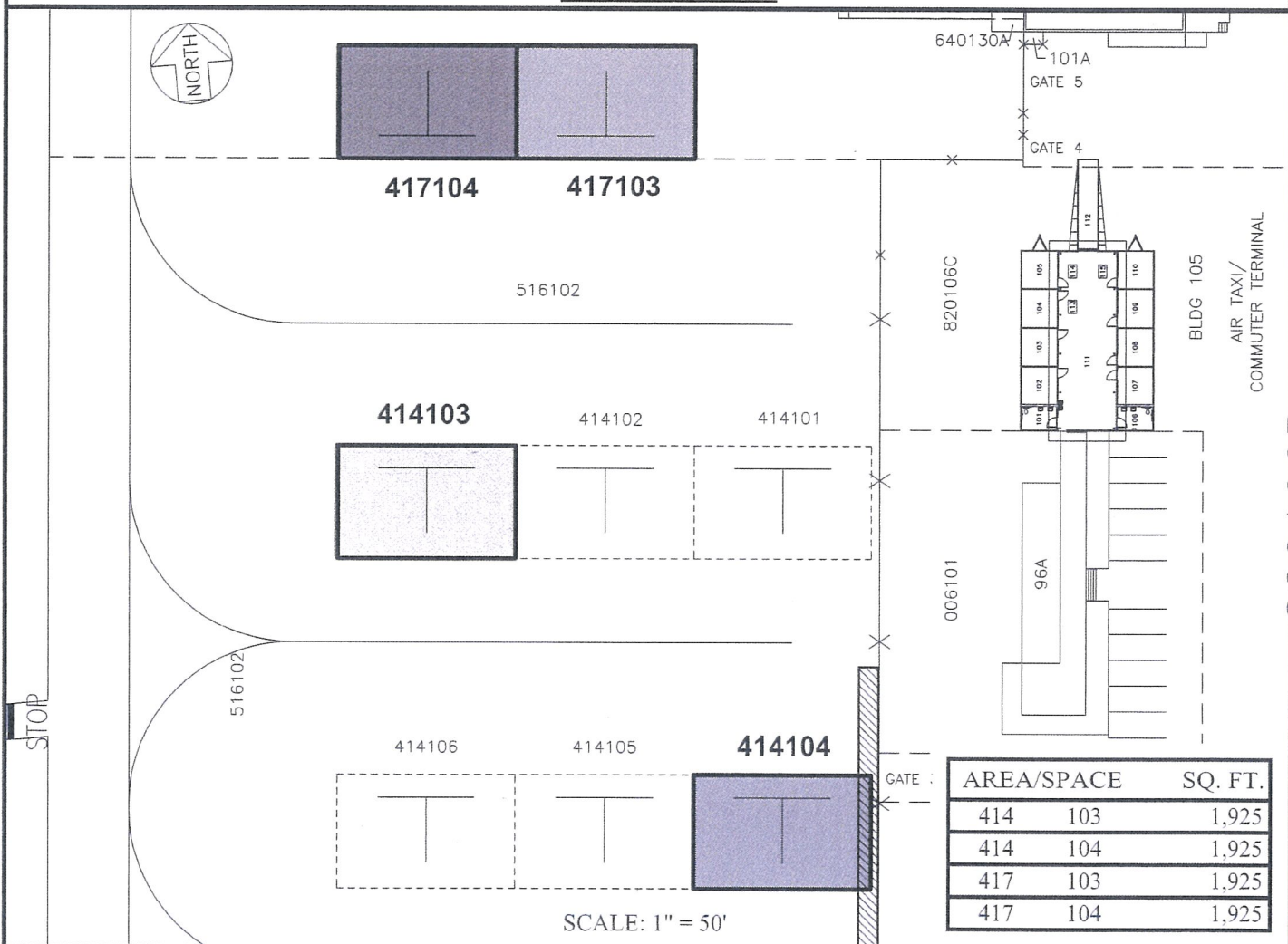
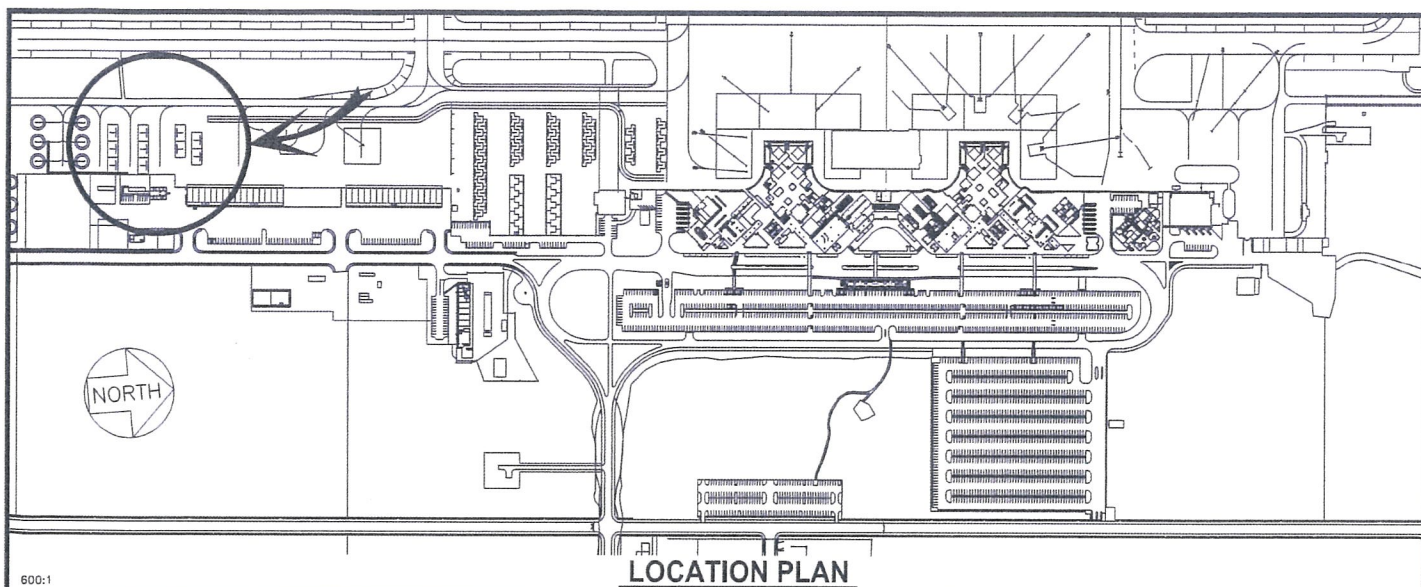

AREA/SPACE		SQ. FT.
414	103	1,925
414	104	1,925
417	103	1,925
417	104	1,925

PP-21-N003

DATE : APRIL 2021

EXHIBIT: **A**



Airports Division

**SOUTHERN AIRWAYS
EXPRESS, LLC**

TIE-DOWNS

**414103,104
417103,104**

PLAT B1, 39

ELLISON ONIZUKA KONA INTERNATIONAL AIRPORT AT KEAHOLE

N:\AIRPORTS\KOA_Kona\CAD\PM\koa_414103-01.dwg