

DAVID Y. IGE  
GOVERNOR



STATE OF HAWAII  
DEPARTMENT OF TRANSPORTATION  
869 PUNCHBOWL STREET  
HONOLULU, HAWAII 96813-5097

JADE T. BUTAY  
DIRECTOR

Deputy Directors  
LYNN A.S. ARAKI-REGAN  
DEREK J. CHOW  
ROSS M. HIGASHI  
EDWIN H. SNIFFEN

IN REPLY REFER TO:

Board of Land and  
Natural Resources  
State of Hawai'i  
Honolulu, Hawai'i

ISSUANCE OF A REVOCABLE PERMIT FOR SPACES IN THE TERMINAL  
TO PERFORM AIRLINE CARRIER OPERATIONS  
SOUTHERN AIRWAYS EXPRESS, LLC  
MOLOKA'I AIRPORT  
TAX MAP KEYS: (2) 5-2-04: PORTION OF 8, (2) 5-2-04: PORTION OF 106

MAUI

APPLICANT:

Southern Airways Express, LLC, whose business address is 101 N. Riverside Drive,  
Suite 211, Pompano Beach, Florida 33062.

LEGAL REFERENCE:

Section 171-55, Hawai'i Revised Statutes.

LOCATION AND TAX MAP KEY:

Portions of Moloka'i Airport, Hoolehua, Island of Moloka'i, County of Maui,  
identified by Tax Map Keys: 2<sup>nd</sup> Division, 5-2-04: Portion of 8 and 5-2-04: Portion of 106.

AREAS:

Building/Room No. 301-110A, containing an area of approximately 148 square feet,  
Building/Room No. 301-110B, containing an area of approximately 70 square feet,  
Building/Room No. 301-111A, containing an area of approximately 161 square feet,  
Building/Room No. 301-111B, containing an area of approximately 148 square feet,  
Building/Room No. 301-111C, containing an area of approximately 92 square feet, and  
Area/Space No. 611-101B, containing an area of approximately 181 square feet, as shown  
and delineated on the attached Exhibit A.

**ITEM M-16**

BLNR – ISSUANCE OF A REVOCABLE PERMIT FOR SPACES IN THE TERMINAL TO PERFORM AIRLINE CARRIER OPERATIONS, SOUTHERN AIRWAYS EXPRESS, LLC  
Page 2

ZONING:

State Land Use District: Agricultural  
County of Maui: Interim Zoning Provisions of the Maui County Zoning Code

LAND TITLE STATUS:

Section 5(b) lands of the Hawai'i Admission Act: Ceded  
DHHL 30% entitlement lands pursuant to Hawai'i Admission Act YES \_\_\_ NO X

CURRENT USE STATUS:

Land presently encumbered by Governor's Executive Order No. 1019, dated May 10, 1943, setting aside 153.270 acres designated as Moloka'i Airport to be under the control and management of the State of Hawai'i, Department of Transportation for Public Purposes.

CHARACTER OF USE:

Southern Airways Express, LLC will use the spaces for offices, ticket counters and baggage make-up areas in the Terminal, as part of its commercial airline carrier operations at Moloka'i Airport.

COMMENCEMENT DATE:

Upon complete execution of the revocable permit.

MONTHLY RENTAL:

\$1,954.42 (\$1,522.42, as determined from the Department of Transportation, Airports Division schedule of rates and charges established by appraisal of Airports property statewide, plus \$312.00 for utilities and \$120.00 for maintenance).

SECURITY DEPOSIT:

\$5,863.26, or three (3) times the monthly rental in effect.

DCCA VERIFICATION:

Place of business registration confirmed:	YES <u>X</u>	NO ___
Registered business name confirmed:	YES <u>X</u>	NO ___
Good standing confirmed:	YES <u>X</u>	NO ___

CHAPTER 343, HRS - ENVIRONMENTAL ASSESSMENT:

The State of Hawaii, Department of Transportation, Airports Division (HDOT-A), has determined that the subject areas are covered by the Moloka'i Airport Improvements Environmental Assessment (EA), published by the Environmental Quality Commission (EQC) in the December 23, 1981 issue of the EQC Bulletin. Accordingly, all relevant mitigation from the EA and best management practices will be implemented to address the minimum impacts of this action.

REMARKS:

In accordance with Section 171-55, HRS, relating to Permits, the Department of Transportation proposes to issue a month-to-month revocable permit to Southern Airways Express, LLC for offices, ticket counters and baggage make-up areas in the Terminal, as part of its airline carrier operations at Moloka'i Airport.

RECOMMENDATION:

That the Board authorize the Department of Transportation to issue a month-to-month revocable permit to Southern Airways Express, LLC, subject to: (1) terms and conditions herein outlined, which are by reference incorporated herein; and (2) such additional terms and conditions as may be prescribed by the Director of Transportation to best serve the interests of the State.

Respectfully submitted,



JADE T. BUTAY  
Director of Transportation

APPROVED FOR SUBMITTAL:

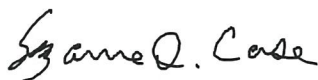

SUZANNE D. CASE  
Chairperson and Member

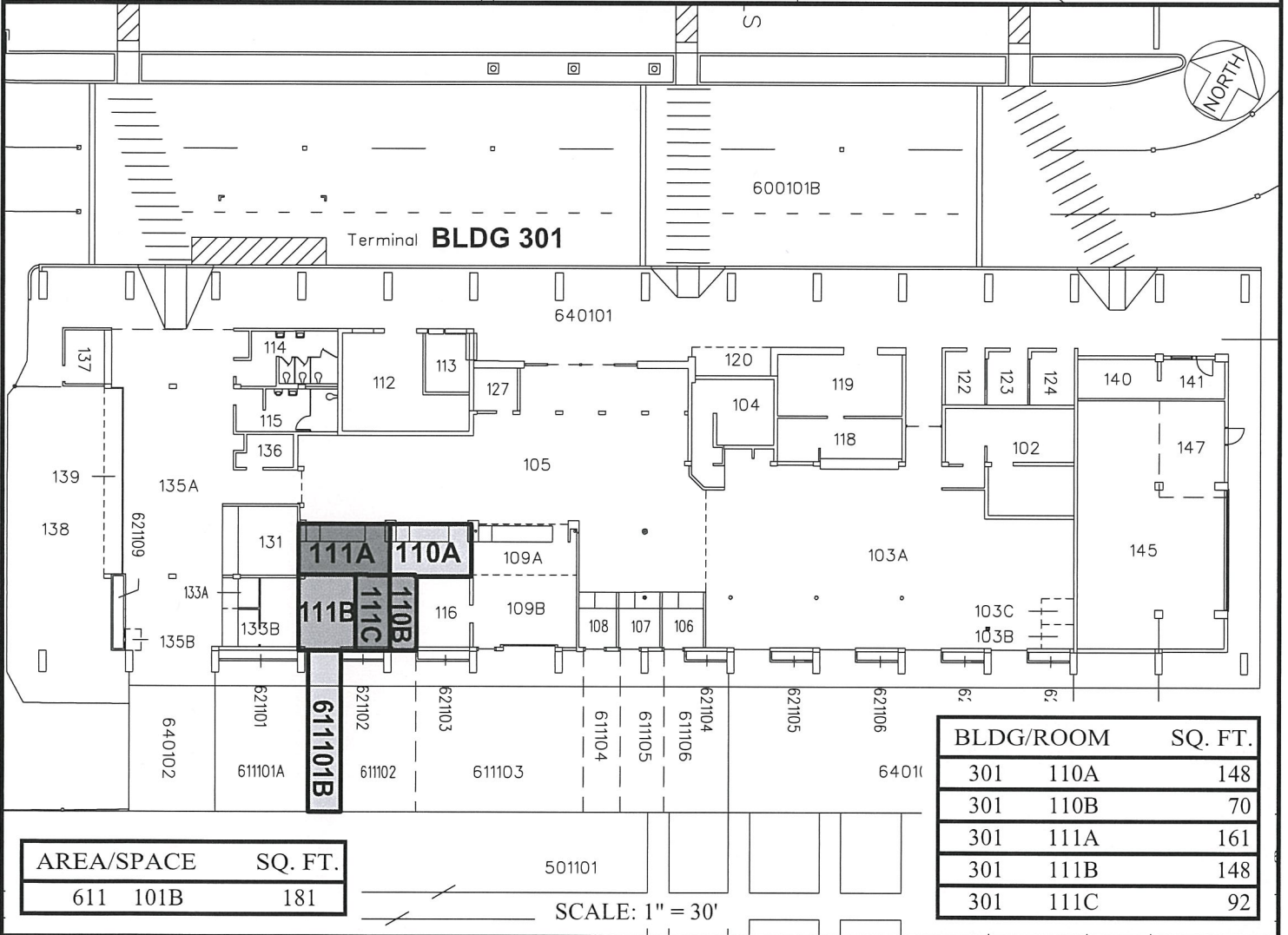
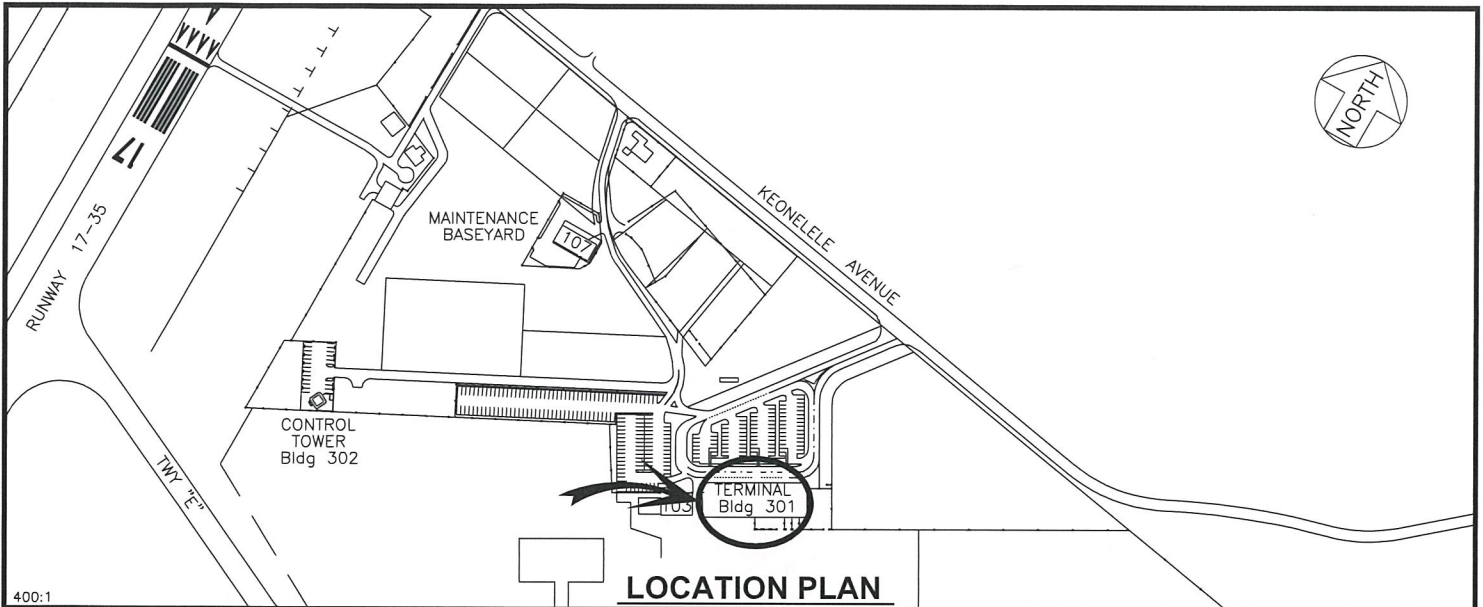

AREA/SPACE	SQ. FT.
611 101B	181

BLDG/ROOM	SQ. FT.
301 110A	148
301 110B	70
301 111A	161
301 111B	148
301 111C	92

SCALE: 1" = 30'

RP-9092

DATE : APRIL 2021

EXHIBIT: **A**



SOUTHERN AIRWAYS  
EXPRESS, LLC

BUILDING 301  
TERMINAL BUILDING  
GROUND LEVEL

301110A,110B  
301111A,B,C  
611101B  
PLAT A1, 33

**MOLOKAI AIRPORT**