

DAVID Y. IGE
GOVERNOR



STATE OF HAWAII
DEPARTMENT OF TRANSPORTATION
869 PUNCHBOWL STREET
HONOLULU, HAWAII 96813-5097

JADE T. BUTAY
DIRECTOR

Deputy Directors
LYNN A.S. ARAKI-REGAN
DEREK J. CHOW
ROSS M. HIGASHI
EDWIN H. SNIFFIN

IN REPLY REFER TO:

Board of Land and
Natural Resources
State of Hawai'i
Honolulu, Hawai'i

ISSUANCE OF A REVOCABLE PERMIT FOR THE PURPOSE OF GSE PARKING
AND EQUIPMENT STORAGE, AT THE INTER-ISLAND MAUKA TERMINAL
HAWAIIAN AIRLINES, INC.

DANIEL K. INOUE INTERNATIONAL AIRPORT
TAX MAP KEY: (1) 1-1-003: 001 (PORTION)

O'AHU

APPLICANT:

Hawaiian Airlines, Inc. (Hawaiian Airlines), whose business address is 3375 Koapaka
Street, Suite G350, Honolulu, Hawai'i 96819.

LEGAL REFERENCE:

Section 171-55, Hawai'i Revised Statutes (HRS).

LOCATION AND TAX MAP KEY:

Portion of the Inter-Island Terminal, Mauka Extension, Daniel K. Inouye International
Airport (Airport), Island of O'ahu, State of Hawai'i, identified by Tax Map
Key: 1st Division, 1-1-003: 001 (Portion).

AREA:

Area/Space No. 617-112, consisting of approximately 276 square feet;
Area/Space No. 617-113, consisting of approximately 276 square feet;
Area/Space No. 617-114, consisting of approximately 276 square feet;
Area/Space No. 617-115, consisting of approximately 276 square feet; and
Area/Space No. 617-116, consisting of approximately 276 square feet, as shown and
delineated on the attached map labeled Exhibit "A".

ITEM M-4

BLNR – ISSUANCE OF A REVOCABLE PERMIT FOR THE PURPOSE OF GSE PARKING AND EQUIPMENT STORAGE, AT THE INTER-ISLAND MAUKA TERMINAL HAWAIIAN AIRLINES, INC.

Page 2

ZONING:

State Land Use District: Urban
City and County of Honolulu LUO: Industrial (I-2)

LAND TITLE STATUS:

Non-Ceded - Section 5(a) lands of the Hawai'i Admission Act
DHHL 30% entitlement lands pursuant to Hawai'i Admission Act YES ___ NO X

CURRENT USE STATUS:

Land presently encumbered by Governor's Executive Order No. 3201, dated June 8, 1983, setting aside 3,152.177 acres designated as the Airport under the control and management of the State of Hawai'i, Department of Transportation, Airports Division (DOTA) for Airport Purposes.

CHARACTER OF USE:

Hawaiian Airlines will use the space for GSE parking and equipment storage.

COMMENCEMENT DATE:

Upon execution of the revocable permit.

MONTHLY RENTAL:

\$8,495.05 (based on a rate of \$73.87 per square foot, per annum, as determined from the Airports Division Signatory Rates and Charges, Hawai'i Airports System).

SECURITY DEPOSIT:

Three (3) times the monthly rental in effect.

DCCA VERIFICATION:

Place of business registration confirmed: YES X NO ___
Registered business name confirmed: YES X NO ___
Good standing confirmed: YES X NO ___

CHAPTER 343, HRS - ENVIRONMENTAL ASSESSMENT:

The environmental impacts of the proposed action to the subject land area is covered by the Honolulu International airport Master Plan Update and Noise Compatibility Program

BLNR – ISSUANCE OF A REVOCABLE PERMIT FOR THE PURPOSE OF GSE PARKING AND EQUIPMENT STORAGE, AT THE INTER-ISLAND MAUKA TERMINAL HAWAIIAN AIRLINES, INC.

Page 3

Environmental Assessment (EA), State Project No. AO1011-033. The EA is a joint State and Federal document, dated September 1989 and published in the October 23, 1989 issue of the OEQC Bulletin. Accordingly, relevant mitigation from the EA and DOTA environmental best management practice will address minimal impacts from this action.

REMARKS:

In accordance with Section 171-55 HRS, relating to Permits, the Department of Transportation proposes to issue a month-to-month revocable permit to Hawaiian Airlines, for GSE parking and equipment storage, as part of their signatory airline operations at the Airport.

RECOMMENDATION:

That the Board authorize the Department of Transportation to issue a month-to-month revocable permit to Hawaiian Airlines, subject to: (1) terms and conditions herein outlined, which are by reference incorporated herein; and (2) such additional terms and conditions as may be prescribed by the Director of Transportation to best serve the interests of the State.

Respectfully submitted,



JADE T. BUTAY
Director of Transportation

APPROVED FOR SUBMITTAL:

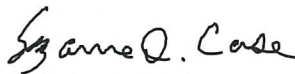

SUZANNE D. CASE
Chairperson and Member

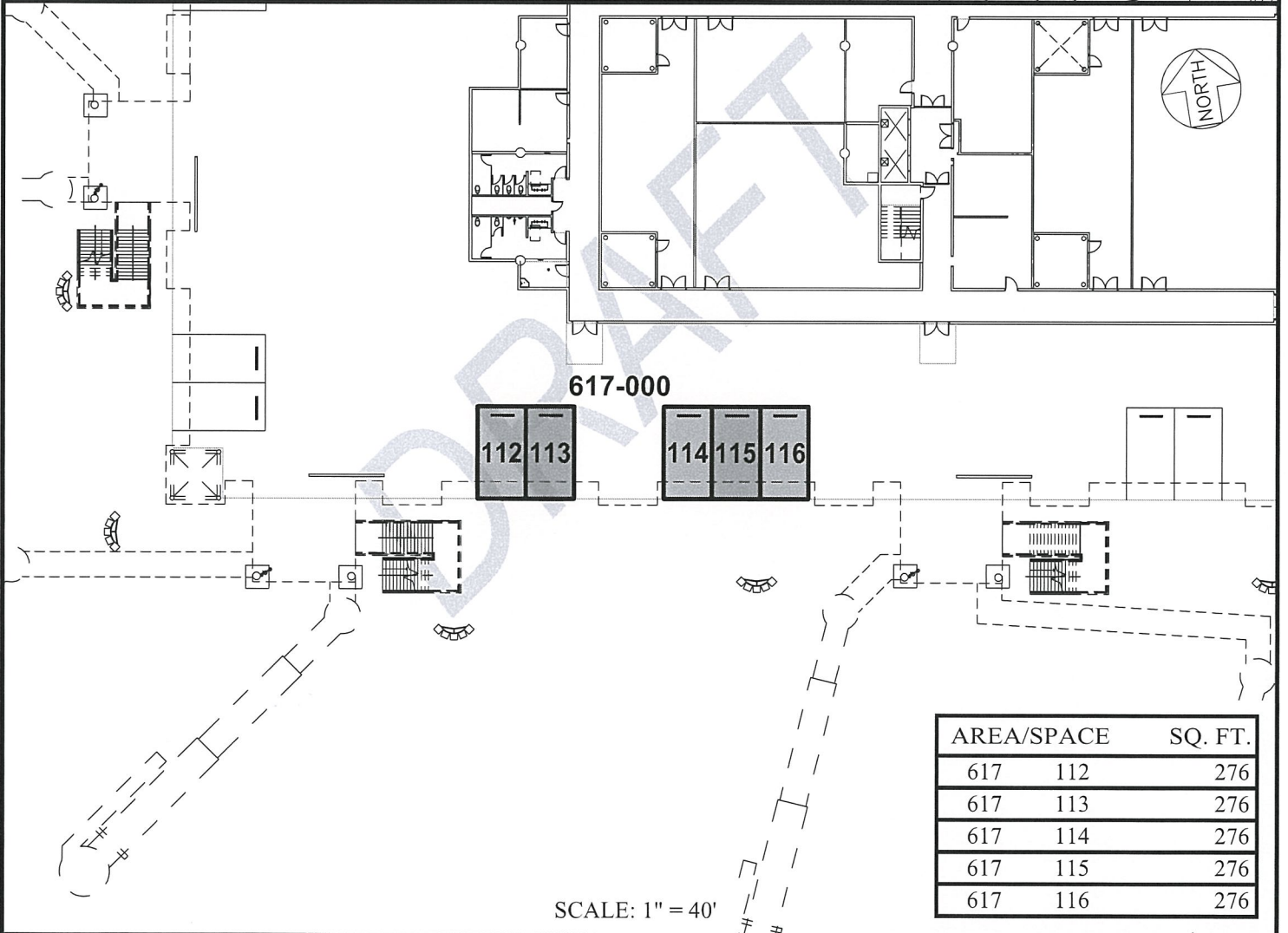
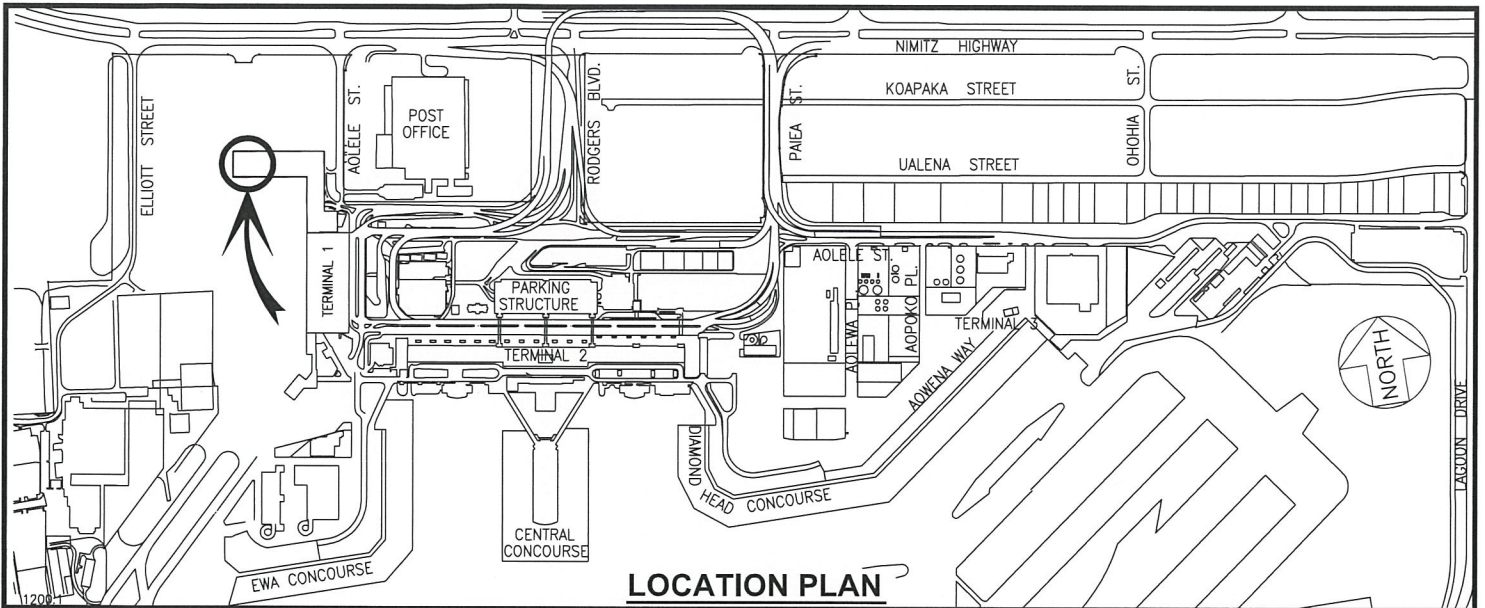

AREA/SPACE	SQ. FT.
617 112	276
617 113	276
617 114	276
617 115	276
617 116	276

SCALE: 1" = 40'

DATE : APRIL 2021 EXHIBIT: **A**



HAWAIIAN AIRLINES, INC.

PARKING
IIT MAUKA EXTENSION
GROUND LEVEL

617112 -
617116

PLAT A1