

DAVID Y. IGE  
GOVERNOR

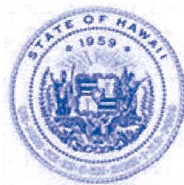

STATE OF HAWAII  
DEPARTMENT OF TRANSPORTATION  
869 PUNCHBOWL STREET  
HONOLULU, HAWAII 96813-5097

JADE T. BUTAY  
DIRECTOR

Deputy Directors  
LYNN A.S. ARAKI-REGAN  
DEREK J. CHOW  
ROSS M. HIGASHI  
EDWIN H. SNIFFEN

IN REPLY REFER TO:

Board of Land and  
Natural Resources  
State of Hawai'i  
Honolulu, Hawai'i

ISSUANCE OF A REVOCABLE PERMIT FOR A CONSTRUCTION  
STAGING AREA FOR MATERIALS  
PAUL'S ELECTRICAL CONTRACTING, LLC  
DANIEL K. INOUE INTERNATIONAL AIRPORT  
TAX MAP KEY: (1) 1-1-003: PORTION OF 01

O'AHU

REQUEST:

Issuance of a Revocable Permit for a Construction Staging Area for materials to  
Paul's Electrical Contracting, LLC, situated at Daniel K. Inouye International Airport.

LEGAL REFERENCE:

Section 171-55, Hawai'i Revised Statutes (HRS).

APPLICANT:

Paul's Electrical Contracting, LLC, whose mailing address is 99-1400 Koaha Place, Aiea,  
Hawai'i 96701.

LOCATION AND TAX MAP KEY:

A portion of ARFF No. 2 Area, at Daniel K. Inouye International Airport, Island of O'ahu,  
State of Hawai'i, identified by Tax Map Key: 1st Division, 1-1-003: portion of 01.

AREA:

Area/Space No. 820-110, containing an area of approximately 2,500 square feet, as shown  
and delineated on the attached maps labeled Exhibit "A".

ZONING:

State Land Use District: Urban  
City and County of Honolulu LUO: Industrial (I-2)

**ITEM M-4**

BLNR – ISSUANCE OF A REVOCABLE PERMIT FOR A CONSTRUCTION STAGING  
AREA FOR MATERIALS, PAUL’S ELECTRICAL CONTRACTING, LLC  
Page 2

LAND TITLE STATUS:

Section 5(a) lands of the Hawai‘i Admission Act: Non-Ceded  
DHHL 30% entitlement lands pursuant to Hawai‘i Admission Act YES \_\_\_ NO X

CURRENT USE STATUS:

Land presently encumbered by Governor’s Executive Order No. 3201, dated  
June 8, 1983, setting aside 3,152.177 acres designated as Daniel K. Inouye International  
Airport under the control and management of the State of Hawai‘i, Department of  
Transportation, Airports Division (DOTA) for Airport Purposes.

CHARACTER OF USE:

Paul’s Electrical Contracting, LLC will use the space for a construction staging area for  
materials, as part of Contract No. 69172, State Project No. AO1022-17, Reef Runway  
Taxiway Signage Improvements, Daniel K. Inouye International Airport.

COMMENCEMENT DATE:

To be determined by the Director of Transportation at a later date.

MONTHLY RENTAL:

\$25.00 (as stated in Contract No. 69172, State Project No. AO1022-17, Reef Runway  
Taxiway Signage Improvements, Daniel K. Inouye International Airport).

SECURITY DEPOSIT:

\$75.00, or three (3) times the monthly rental in effect.

DCCA VERIFICATION:

Place of business registration confirmed:	YES <u>X</u>	NO ___
Registered business name confirmed:	YES <u>X</u>	NO ___
Good standing confirmed:	YES <u>X</u>	NO ___

CHAPTER 343, HRS - ENVIRONMENTAL ASSESSMENT:

The environmental impacts of the proposed action to the subject land area is covered by  
the Honolulu International Airport, Airport Modernization Program Environmental  
Assessment (EA), State Project No. AO1030-13. The EA is a joint State and Federal  
document dated, January 2013, and published in the February 8, 2013 issue of the OEQC  
Bulletin. Accordingly, the actions have been determined to have little or no impact upon  
the environment.

BLNR – ISSUANCE OF A REVOCABLE PERMIT FOR A CONSTRUCTION STAGING  
AREA FOR MATERIALS, PAUL’S ELECTRICAL CONTRACTING, LLC

Page 3

REMARKS:

In accordance with Section 171-55, HRS, relating to Permits, the DOTA proposes to issue a permit to Paul’s Electrical Contracting, LLC for the use of the space for a construction staging area for materials, as specifically stated in Contract No. 69172, State Project No. AO1022-17, Reef Runway Taxiway Signage Improvements at Daniel K. Inouye International Airport, Provisions for Field Office/Storage Space: “Pending the availability of space on airport property, the State will issue Revocable Permit(s) to the Contractor for the use of the space, assessed at a monthly fee of \$25 for each Revocable Permit issued.”

RECOMMENDATION:

That the Board authorize the Department of Transportation to issue a month-to-month revocable permit to Paul’s Electrical Contracting, LLC, subject to: (1) terms and conditions herein outlined, which are by reference incorporated herein; and (2) such additional terms and conditions as may be prescribed by the Director of Transportation to best serve the interests of the State.

Respectfully submitted,



JADE T. BUTAY  
Director of Transportation

APPROVED FOR SUBMITTAL:

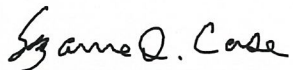

---

SUZANNE D. CASE  
Chairperson and Member



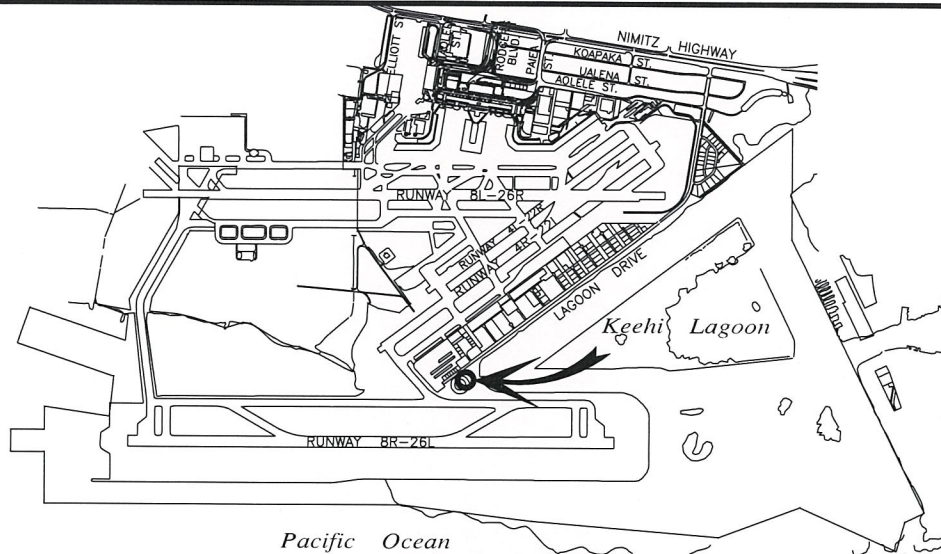

# **LOCATION PLAN**

5000:1

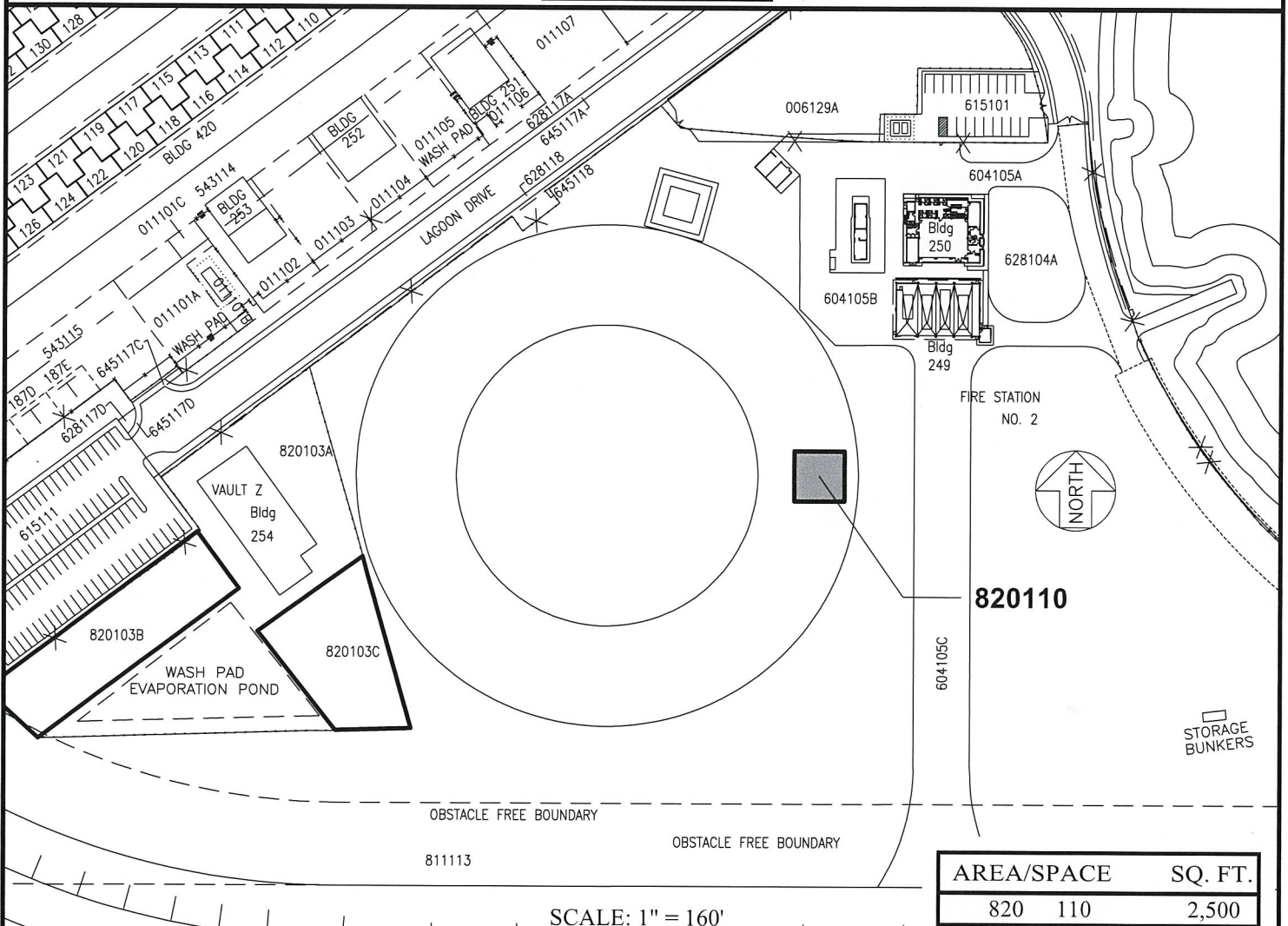

SCALE: 1" = 160'

AREA/SPACE	SQ. FT.
820 110	2,500

RP-9052

DATE : FEBRUARY 2021

EXHIBIT: **A**



Airports Division

PAUL'S ELECTRICAL  
CONTRACTING, LLC

ARFF NO. 2 AREA  
SOUTH RAMP

820110

PLAT 45

Adobe Sign Transaction Number: CB1CH8CAABAARsl.xb29161WKTFzuB1Om4mGeTo356su

N:\AIRPORTS\HNL\_HONOLULU\CAD\PM\HNL\_820110-01DRAFT.DWG

**DANIEL K. INOUE INTERNATIONAL AIRPORT**