

DAVID Y. IGE
GOVERNOR



STATE OF HAWAII
DEPARTMENT OF TRANSPORTATION
869 PUNCHBOWL STREET
HONOLULU, HAWAII 96813-5097

JADE T. BUTAY
DIRECTOR

Deputy Directors
LYNN A.S. ARAKI-REGAN
DEREK J. CHOW
ROSS M. HIGASHI
EDWIN H. SNIFFEN

IN REPLY REFER TO:

Board of Land and
Natural Resources
State of Hawai'i
Honolulu, Hawai'i

ISSUANCE OF A REVOCABLE PERMIT FOR AIRCRAFT PARKING
JEREMY MENDOZA
DANIEL K. INOUE INTERNATIONAL AIRPORT
TAX MAP KEY: (1) 1-1-76: PORTION OF 23

O'AHU

REQUEST:

Issuance of a Revocable Permit for Aircraft Parking (Parking Permit) to Jeremy Mendoza, situated at Daniel K. Inouye International Airport.

LEGAL REFERENCE:

Section 171-55, Hawai'i Revised Statutes.

APPLICANT:

Jeremy Mendoza, whose mailing address is 747 Wiliwili Street, Apt. 802, Honolulu, Hawai'i 96826.

LOCATION:

A portion of Daniel K. Inouye International Airport, identified as South Ramp, identified by Tax Map Key: 1st Division, 1-1-76: portion of 23.

AREA:

Area/Space Nos. 423-131, containing an area of approximately 990 square feet, as shown and delineated on the attached map labeled Exhibit A.

ITEM M-2

BLNR – ISSUANCE OF A REVOCABLE PERMIT FOR AIRCRAFT PARKING,
JEREMY MENDOZA
PAGE 2

ZONING:

State Land Use District: Urban
City and County of Honolulu LUO: Industrial (I-2)

LAND TITLE STATUS:

Non-ceded - Section 5(a) lands of the Hawai'i Admission Act
DHHL 30% entitlement lands pursuant to Hawai'i Admission Act YES ___ NO X

CURRENT USE STATUS:

Land presently encumbered by Governor's Executive Order No. 3201, dated June 8, 1983, setting aside 3,152.177 acres designated as Daniel K. Inouye International Airport under the control and management of the State of Hawai'i, Department of Transportation, Airports Division (DOTA) for Airport Purposes.

CHARACTER OF USE:

Aircraft Tie-Down (1968 Piper PA-28-140, Tail No. N-318FC).

COMMENCEMENT DATE:

To be determined by the Director of Transportation at a later date.

MONTHLY RENTAL:

\$126.00 (as determined from the DOTA schedule of rates and charges established by appraisal of Airports property statewide).

SECURITY DEPOSIT:

\$378.00, or three (3) times the monthly rental in effect

CHAPTER 343, HRS - ENVIRONMENTAL ASSESSMENT:

The environmental impacts of the proposed action to the subject land area is covered by the Honolulu International Airport Master Plan Update and Noise Compatibility Program Environmental Assessment (EA), State Project No. AO1011-033. The EA is a joint State and Federal document, dated September 1989 and published in the October 23, 1989 issue of the OEQC Bulletin. Accordingly, relevant mitigation from the EA and DOT-A environmental best management practice will address minimal impacts from this action.

BLNR – ISSUANCE OF A REVOCABLE PERMIT FOR AIRCRAFT PARKING,
JEREMY MENDOZA
PAGE 3

REMARKS:

The issuance of a Parking Permit to Jeremy Mendoza for aircraft parking at Daniel K. Inouye International Airport complies with Chapter 343, Exemption Class 1.D.10 as a continuing aeronautical use, and is in accordance with Section 171-55 HRS, relating to Permits.

RECOMMENDATION:

That the Board authorize the Department of Transportation to issue a month-to-month Parking Permit to Jeremy Mendoza, subject to: (1) terms and conditions herein outlined, which are by reference incorporated herein; and (2) such additional terms and conditions as may be prescribed by the Director of Transportation to best serve the interests of the State.

Respectfully submitted,



JADE T. BUTAY
Director of Transportation

APPROVED FOR SUBMITTAL:

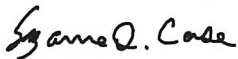

SUZANNE D. CASE
Chairperson and Member

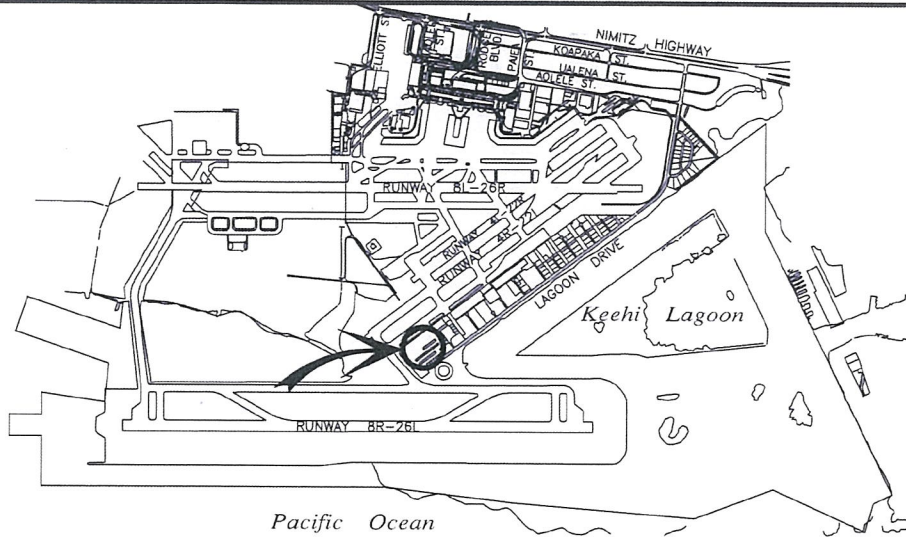

LOCATION PLAN

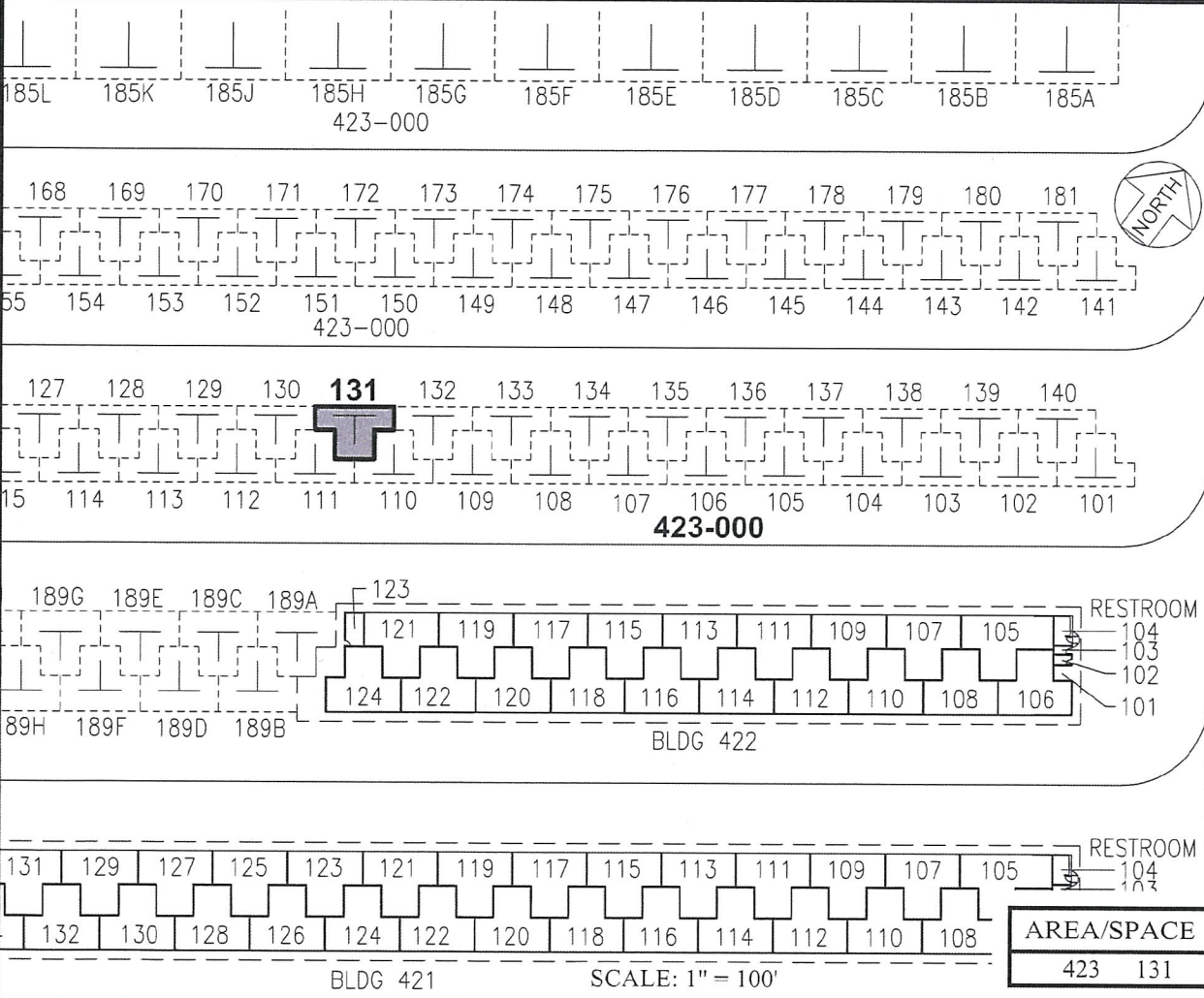

AREA/SPACE	SQ. FT.
423 131	990

PP-20-0023

DATE : MAY 2021

EXHIBIT: **A**



MENDOZA, JEREMY

TIE-DOWN
GENERAL AVIATION
GROUND LEVEL

423131

PLAT 45

DANIEL K. INOUE INTERNATIONAL AIRPORT

N:\AIRPORTS\HNL_HONOLULU\CAD\PM\HNL_423131-01.DWG